



Earth Insulator

Material
Operating temperature ; -40 to +140 C
Material ; BMC Bough Moulding Compound
Insert ; Brass, steel with Zinc Plating



391-020

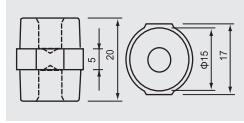

Tensile Strength (LBS)	300
Voltage Withstand (KV)	5
Tensile Strength (FT LBS)	4
Screw (mm)	5
Screw depth (mm)	7

391-040

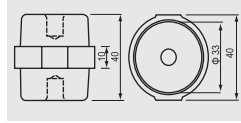

Tensile Strength (LBS)	550
Voltage Withstand (KV)	8
Tensile Strength (FT LBS)	8
Screw (mm)	8
Screw depth (mm)	11

391-051

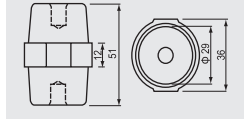

Tensile Strength (LBS)	1000
Voltage Withstand (KV)	15
Tensile Strength (FT LBS)	20
Screw (mm)	8
Screw depth (mm)	14

391-060

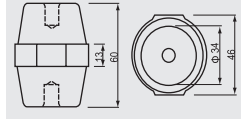

Tensile Strength (LBS)	1200
Voltage Withstand (KV)	20
Tensile Strength (FT LBS)	35
Screw (mm)	10
Screw depth (mm)	15

391-076

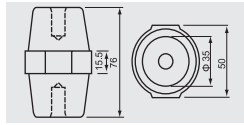

Tensile Strength (LBS)	1500
Voltage Withstand (KV)	25
Tensile Strength (FT LBS)	40
Screw (mm)	10
Screw depth (mm)	20

Marker Strip

Material
Nylon PA66
Operating temperature; -30 to +60C
Color; Black



Order No.	Dimension (mm)		Qty/Bag
	L	W	
392-065	65	9	100
392-100	100	9	100
392-135	135	9	100

