

## SLIM FRAME MIRROR 2000 x 1000

# MOOD

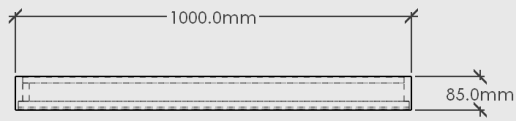

PLAN VIEW

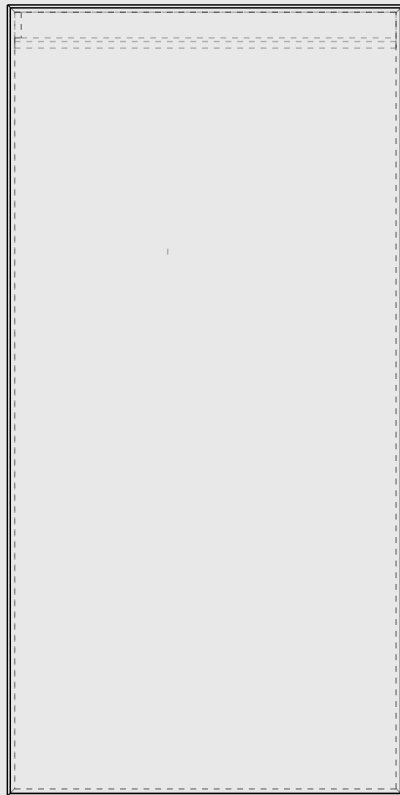

ELEVATION - FRONT

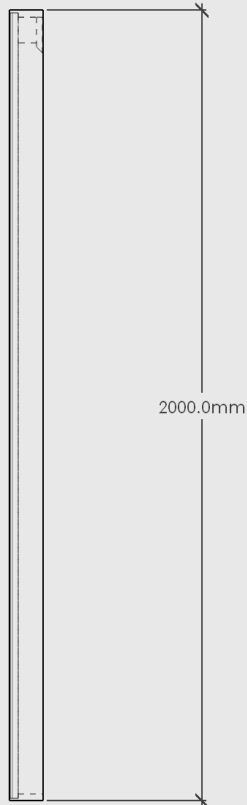

ELEVATION - SIDE

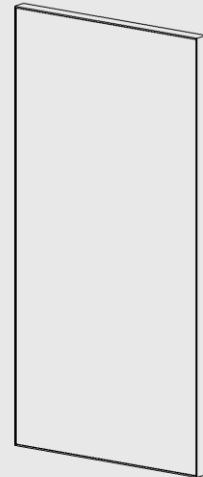

3D VIEW

Slim Frame Mirror 2000 x 1000

Dimensions: 2000mm High x 1000mm Wide x 85mm Deep

Shell: Chosen Timber Veneer on 18mm Birch Plywood. Stained Oiled Edges to match.

Fronts: 5mm Clear Mirror

Back: 16mm SupaBlack Carcass Grade Plywood

Hardware: N/A

Handle: N/A

Leg: N/A

Colour Options:

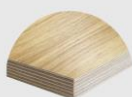

Oak

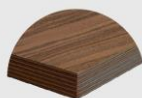

Walnut

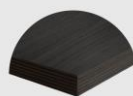

Black Oak

Designed to be floor or wall mounted. Mirror comes with timber fixing cleats and screws to install on wall.

When wall mounting the mirror, we recommend using a qualified builder or cabinet maker

Package Dimensions/Weight: 2010mm x 1010mm High x 85mm. Estimated 20kg

Proudly designed and made in NZ.