

SLIM FRAME MIRROR 1200 x 600

MOOD



PLAN VIEW



ELEVATION - FRONT

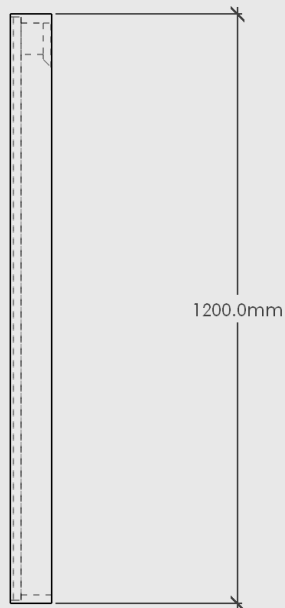

ELEVATION - SIDE

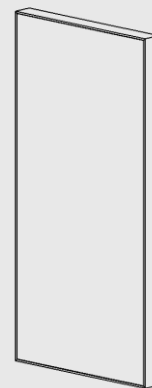

3D VIEW

Slim Frame Mirror 1200 X 600

Dimensions: 1200mm High x 600mm Wide x 85mm Deep

Shell: Chosen Timber Veneer on 18mm Birch Plywood. Stained Oiled Edges to match.

Fronts: 5mm Clear Mirror

Back: 16mm SupaBlack Carcass Grade Plywood

Hardware: N/A

Handle: N/A

Leg: N/A

Colour Options:



Oak

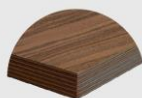

Walnut

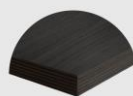

Black Oak

Designed to be floor or wall mounted. Mirror comes with timber fixing cleats and screws to install on wall.

When wall mounting the mirror, we recommend using a qualified builder or cabinet maker

Package Dimensions/Weight: 1210mm x 610mm High x 90mm. Estimated 20kg

Proudly designed and made in NZ.