

## FRAMED BENCH – 1.6M X 0.4M

# MOOD

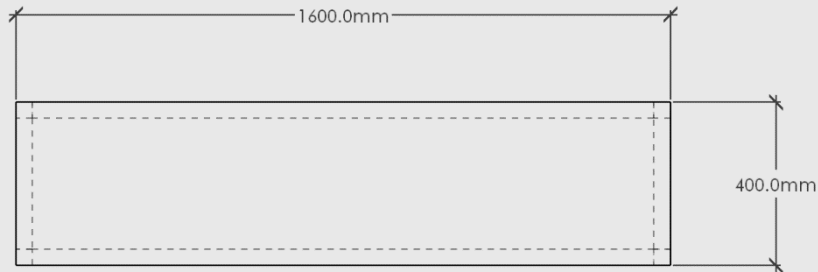

PLAN VIEW

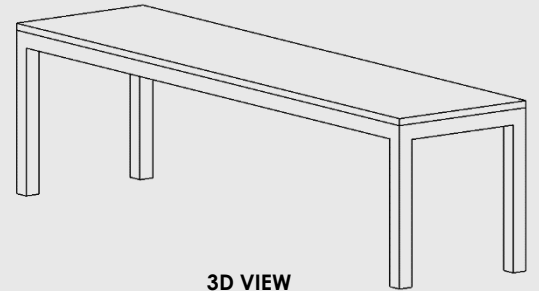

3D VIEW



ELEVATION - FRONT

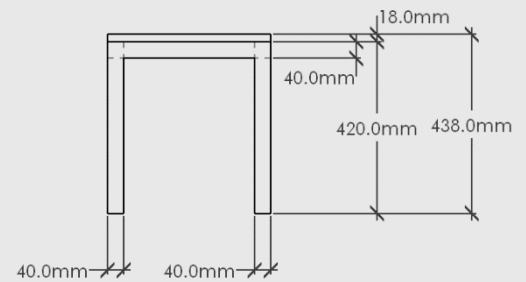

ELEVATION - SIDE

Framed Bench – 1.6m x 0.4m

Dimensions: 1600mm Long x 438mm High x 400mm Deep

Top Material: Chosen Timber Veneer on 18mm Birch Plywood. Stained Oiled Edges to match.

Leg: Framed Black or White Powder Coated Steel

Colour Options:

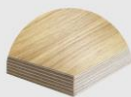

Oak

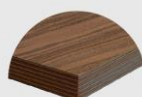

Walnut

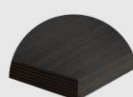

Black Oak

Weight: ~20kg

Proudly designed and made in NZ. Product comes assembled.

## FRAMED DINING TABLE – 1.8M X 0.4M

# MOOD



PLAN VIEW

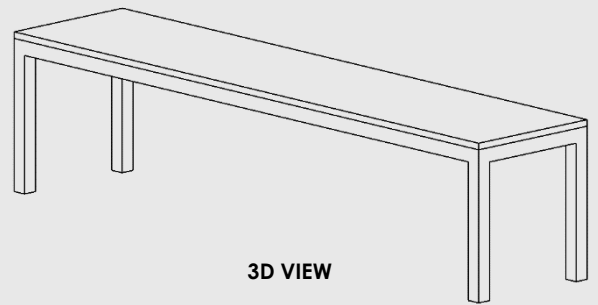

3D VIEW



ELEVATION - FRONT

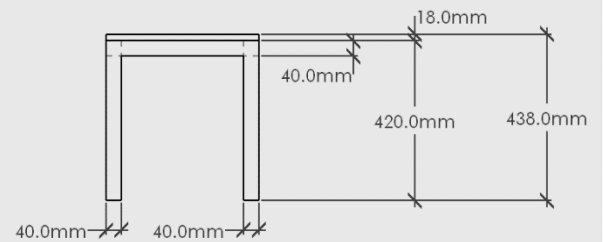

ELEVATION - SIDE

Framed Bench – 1.8m x 0.4m

Dimensions: 1800mm Long x 438mm High x 400mm Deep

Top Material: Chosen Timber Veneer on 18mm Birch Plywood. Stained Oiled Edges to match.

Leg: Framed Black or White Powder Coated Steel

Colour Options:



Oak



Walnut

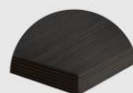

Black Oak

Weight: ~20kg

Proudly designed and made in NZ. Product comes assembled.

## FRAMED DINING TABLE – 2.2M X 0.4M

# MOOD

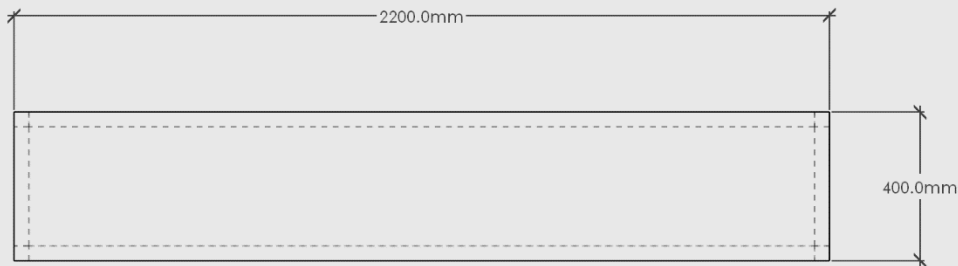

PLAN VIEW

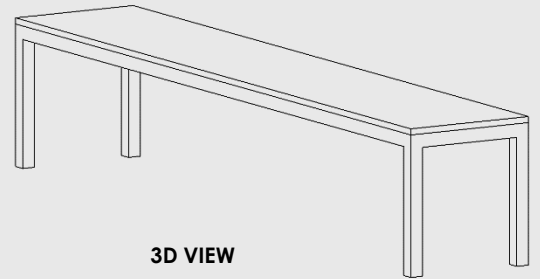

3D VIEW



ELEVATION - FRONT

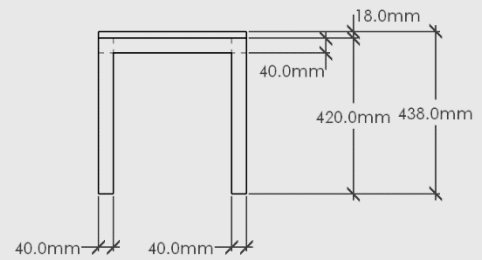

ELEVATION - SIDE

Framed Bench – 2.2m x 0.4m

Dimensions: 2200mm Long x 438mm High x 400mm Deep

Top Material: Chosen Timber Veneer on 18mm Birch Plywood. Stained Oiled Edges to match.

Leg: Framed Black or White Powder Coated Steel

Colour Options:

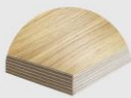

Oak



Walnut

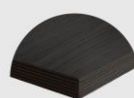

Black Oak

Weight: ~20kg

Proudly designed and made in NZ. Product comes assembled.