

BUSINESS CARD HOLDER

MOOD

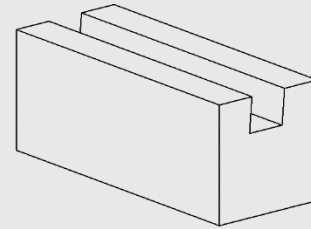

PLAN VIEW



3D VIEW

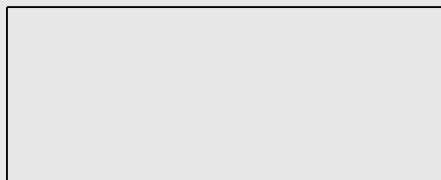

ELEVATION - FRONT

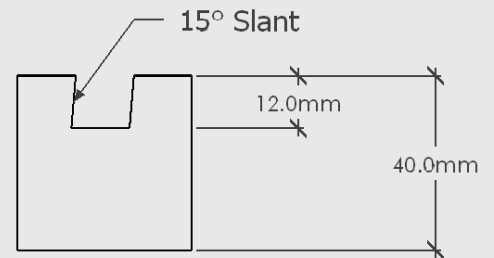

ELEVATION - SIDE

Business Card Holder

Dimensions: 100mm Long x 40mm x 40mm

Material: Natural Solid Oak



Estimated 0.5kg

Proudly designed and made in NZ.