

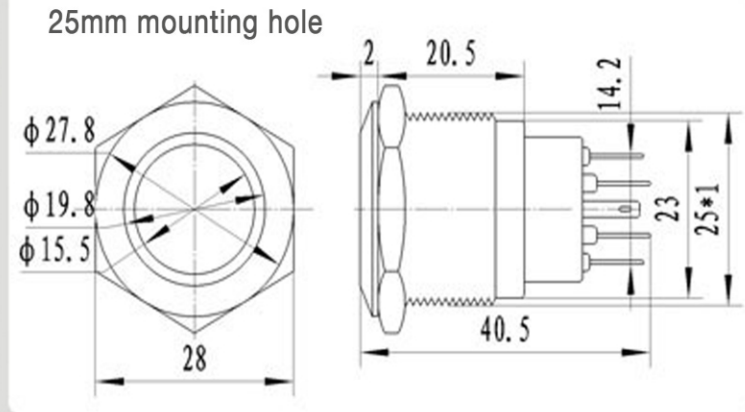

Premium Blue
Stainless Steel
LED Pushbutton

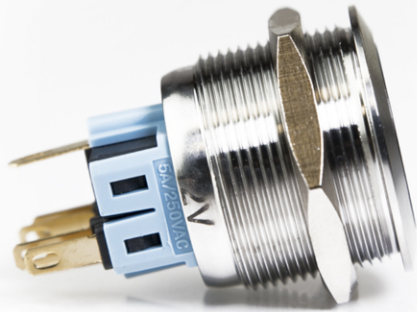

| | |
|-------------------------|--|
| Degree of Protection | Ip67 |
| Contact Type | 1 NO 1NC / 2NO 2NC 可定制 |
| Maximum Voltage | 5V/250VAC |
| Thermal Current | 5A |
| Minimum Applicable Load | 5V AC/DC, 1mA |
| Contact material | Silver plated |
| Terminal Style | .110" Solder/ Quick Connect |
| Operating Temperature | -25°C to +65°C |
| Operating Humidity | 45 to 85% RH |
| Contact Resistance | 5mΩ maximum |
| Insulation Resistance | 1000MΩ minimum (500V DC megger) |
| Vibration Resistance | 10 to 55Hz, amplitude 1.2mm p-p |
| Degree of Protection | >10g |
| Electrical Life | 200,000 operations minimum (at full rated load) |
| Mechanical Life | Maintained: 1000000 Momentary: 1000000 Selector/Keylock: 250000 |
| Dielectrical Life | Illumination Unit: 2,000V AC, 1 min. Between live part/ground |
| Soldering Temperature | 20W/5 seconds or 260°C/3 seconds |