

**magic  
bullet.®**

***user***  
**guide.**



# ***important* safeguards.**

Warning! To avoid the risk of serious injury, carefully read all instructions before operating your magic bullet®. When using any electrical appliance, basic safety precautions should always be observed, including the following important information.

## **! Save These Instructions!** **● FOR HOUSEHOLD USE ONLY**

### ***personal safety:***

**NEVER PUT HOT LIQUIDS IN ANY OF THE SEALED BLENDING CUPS BEFORE BLENDING.**

Start with cold or room temperature ingredients. Heated ingredients can create internal pressure in a sealed blending cup, which may erupt on opening and cause thermal injury.

Friction from the rotating blade will cause ingredients to heat and generate internal pressure in the sealed cup. Do not continuously operate for more than one minute. If the cup is warm to touch, allow to cool before carefully opening pointed away from your body.

Never permit any blended mixture to sit inside a sealed vessel without first releasing internal pressure. If storing blended ingredients, remove the blade from the cup and replace with the flip top lid.

Never store the extractor blade on the power base without a cup or vessel attached. Failure to do so may result in personal injury if the unit is accidentally turned on.

**NEVER** leave spoons or other foreign objects in the cup before blending. Failure to do so will result in damage to the cup and/or possible personal injury.

**Never** leave the magic bullet® unattended while it is in use. Close supervision is necessary when any appliance is used by or near children.

**Never** blend carbonated ingredients or liquids. Built-up pressure from released gases can cause the blade and cup to separate, possibly resulting in personal injury.

**VERY IMPORTANT: If there is a liquid spill, immediately disconnect the unit from the power source. If the spill is external only, clean with a warm soapy cloth and allow unit to dry completely before operating.**

**If the spill has leaked in to the internal components of the power base, cease use immediately. Unit must be checked by a Qualified Electrician and certified as electrically safe before using again. Failure to do so will result in a possible electric shock and/or personal injury.**

**To avoid risk of electric shock, never immerse the cord, plug, or power base of blender in water or other liquids.**

Switch off the appliance and disconnect from power supply before changing accessories or handling moving parts. At all times, avoid contact with moving parts. Keep hands and utensils away from the extractor blade.

**TO REDUCE THE RISK OF PERSONAL INJURY OR LEAKAGE,**

make sure the extractor blade is securely twisted (hand-tightened) onto the magic bullet® blending cup before placing it on the motor base.

Check to make sure the easy-twist extractor blade is aligned properly before placing it on the motor base and operating your magic bullet®.

The cup and blade are consumable components, over time, if the unit starts to get louder or make unusual noise or vibration, it indicates that these consumable parts may need replacing. The continued use of worn parts may result in part failure and/or personal injury.

This appliance is not intended for use by persons (including children) with reduced physical, sensory or mental capabilities, or lack of experience and knowledge, unless they have been given supervision or instruction concerning use of the appliance by a person responsible for their safety.

**warning:**

**If you are taking any medication, especially cholesterol-lowering medication, blood thinners, blood pressure drugs, tranquilizers, or antidepressants, please check with your physician before consuming any magic bullet® recipes.**

**The following list of seeds and pips contain chemicals that release cyanide into the body when ingested. Do not use: apple seeds, apricot seeds, cherry pips, plum pips, and peach pips in your magic bullet®.**

## **product safety:**

To prevent the overheating of the ingredients being blended, never allow the unit to run continuously for more than 1 minute.

If the motor stops for any reason, unplug the power base and let it cool for at least 15 minutes.

If the magic bullet® malfunctions or is dropped, or damaged in any manner, discontinue use and contact Customer Service for further assistance.

**NEVER USE THE MAGIC BULLET® WITHOUT ADDING LIQUID OR WHEN THE CUP IS EMPTY, AS DOING SO MAY DAMAGE THE BLADE.**

**TO AVOID LEAKAGE, DO NOT OVERFILL THE CUP.** Your magic bullet® cups are also marked with a MAX line. When filling the cup or pitcher, make sure your ingredients do not exceed their respective MAX lines.

The magic bullet® is not intended for use in microwave ovens. Do not place the magic bullet® cups, power base or any accessories in a microwave as this may result in damage to the appliance.

Extractor blades are sharp! Handle carefully.



Do not remove the seal from your blade attachment. The seal is not designed to be removed. If seal is removed, cease use immediately and purchase a replacement.

If, over time, the extractor blade becomes loose or damaged, you may order a new extractor blade at: [www.bulletbrands.com.au](http://www.bulletbrands.com.au) / [www.bulletbrands.co.nz](http://www.bulletbrands.co.nz) or contact customer service.

**We recommend replacing your extractor blade every 6 months (depending on use) or as needed for optimal performance.**

**Blade attachments should not be placed in the dishwasher for**

**cleaning. Exposure to hot water can cause damage to the seal in the outer rim of the attachment.**

Always inspect your blades before each use.

Use of adapters and converters is considered an unauthorized modification of the product and as such will void the warranty.

The use of attachments not recommended or not sold by the manufacturer will void warranty and may cause fire, electric shock, or injury.

Use of this product in locations with different electrical specifications may result in damage to the product.

## **warning:** **ventilation caution**

Always operate the magic bullet® on a level surface, leaving unobstructed space beneath and around the power base to permit proper air circulation. Slots and openings on the bottom of the product are provided for ventilation to ensure reliable motor operation and to prevent over-heating.

To prevent fire hazard, power base openings should be free of dust or lint and never obstructed with flammable materials such as newspapers, tablecloths, napkins, dishtowels, or place mats.

## **caution:**

In order to avoid a hazard due to inadvertent resetting of the thermal cut-out, this appliance must not be connected to an external switching device, such as a timer, or connected to a circuit that is regularly switched on and off by the utility.

Periodically inspect cord and plug for damage. Do not operate any appliance with a damaged cord or plug. If damaged, it must be replaced by the manufacturer, its service agent, or similarly qualified persons in order to avoid a hazard.

Do not allow the cord to hang over the side of the counter or table. Do not allow the cord to touch hot surfaces, including stove.

The cyclonic action of your magic bullet® requires the use of liquids to make smoothies and other nutritious beverages. The magic bullet® is not intended to be used as an ice crusher and not intended to be used without liquids. To make a delicious cold smoothie, we suggest that you use frozen fruit and chilled liquids. Alternatively, you may add crushed ice, up to 25% of the total cup volume, with water or other liquid filled up to the "MAX" line. Do not crush ice or other hard items without liquid, as such prolonged use over time may dull or damage the blades.

Unplug the magic bullet® when it is not in use. Make sure the power base is unplugged before assembling, disassembling, adding additional parts, or cleaning.

Do not use magic bullet® outdoors. If exposed to inclement weather elements such as rain or other wet conditions, discontinue use.

Unplug the magic bullet® when it is not in use. Make sure the power base is unplugged before assembling, disassembling, adding additional parts, or cleaning.

Periodically inspect your magic bullet® cups for damage or wear that may impair proper function. Discontinue use and replace components if you detect cracking,

crazing or cloudiness/discolouration, or other damage to the plastic cups, or tabs (on the side of the cup). You may purchase new cups and cross blades at [www.bulletbrands.com.au](http://www.bulletbrands.com.au), [www.bulletbrands.co.nz](http://www.bulletbrands.co.nz) or contact Customer Service:

**Australian Consumers:**

**1300 285 538**

**New Zealand Consumers:**

**0800 232 633**

**! Save these  
• instructions!**

**FOR HOUSEHOLD  
USE ONLY**

## **what's included.**

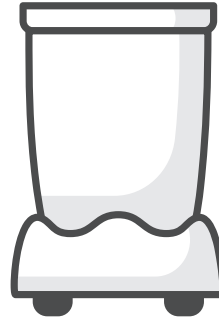

**motor base**

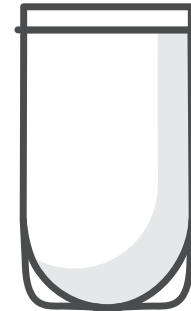

**tall cup**



**stainless steel  
cross blade**

Product configurations may vary.

To see our full list of magic bullet® accessories please visit:

[www.bulletbrands.com.au](http://www.bulletbrands.com.au) / [www.bulletbrands.co.nz](http://www.bulletbrands.co.nz)

# Using the magic bullet®

Using the magic bullet® is as easy as 1, 2, 3:

- 1** Before first use, review all warning and caution statements in the **Important Safeguards** section (pages 1–8). Clean **Blending Cups** and **Cross Blade** with hot, soapy water before use.

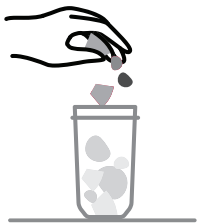

- 2** Load the ingredients into the **Cup** (do not exceed the MAX line).



- 3** Twist on the **Cross Blade** until the blade and **Cup** are tightly sealed.

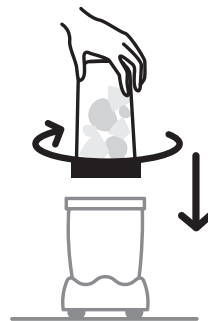

- 4** Line up the tabs on the **Cup** and with the tabs on the **Motor Base**. Press the **Cup** down onto the base to turn on the machine.

**Here's how it works:** The magic bullet® will blend for as long as you press the **Cup** down onto the **Motor Base**. To stop blending, simply release pressure on the **Cup**.

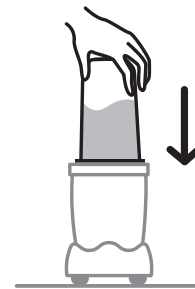

## “Lock-on” mode:

For hands-free operation, press down and gently turn the **Cup** clockwise until the tabs lock under the lip of the **Motor Base**. Once you are in lock-on mode, the motor will run continually (do not run for longer than a minute!). To stop blending, simply twist the **Cup** counter-clockwise to release.

## **caution:**

Before using the **Cross Blade**, check the gasket to make sure it is not damaged and it is completely seated in the **Cross Blade Unit** before each use.

Never put your hands or utensils near the moving **Cross Blade** and never use your hands or utensils to press the activator buttons down while the **Motor Base** is plugged in.

If the **Cross Blade** stops spinning while in lock on mode, immediately unplug the magic bullet®. Hard ingredients like carrots or celery can get stuck in the **Cross Blade** and stop it from turning. If this happens, **unplug the magic bullet® right away**. Remove the blade/cup assembly from the **Motor Base**, and give ingredients a good shake to unblock the **Cross Blade**. If the **Cross**

**Blade** still remains obstructed, twist the **Cross Blade** attachment off of the **Cup** and carefully spin the metal blades using a utensil (not your fingers) to release the blockage. Reattach the **Cross Blade** to the **Cup**, plug in the magic bullet® and try again. It should spin normally.

**Never run the magic bullet® for more than one minute at a time, as it can cause permanent damage to the motor.** If the motor stops working, unplug the **Motor Base** and let it cool for a few hours before attempting to use it again. Your magic bullet® has an internal thermal breaker that shuts the unit off when it overheats. Letting the thermal breaker cool down should allow it to reset.

# care & maintenance.

Cleaning the magic bullet® is easy. Simply place any of the parts (except for the Motor Base and Cross Blade) on the top rack of the dishwasher or hand wash with warm, soapy water and rinse.

**step 1:** Always power off and unplug the Motor Base from the outlet when it is left unattended, before assembling, disassembling, changing accessories or approaching parts that move in use or when cleaning. Do not attempt to handle the appliance until all parts have stopped moving!

**step 2:** Make sure the Blending Cup/Cross Blade is not attached to the Motor Base.

**step 3:** Clean the individual components (Motor Base, Cross Blade, magic bullet® Blending Cups).

## **motor base:**

- To avoid risk of injury, **never** use your hands or utensils to clean the White Actuator Tabs while the magic bullet® is plugged in.
- **Never** submerge the Motor Base in water or put in the dishwasher.
- Do not remove the rubber or plastic liners inside the Motor Base.



- Use a sponge or dish cloth dampened with warm soapy water to wipe down the inside and outside of the Motor Base until clean.
- Pay particular attention to the actuator tabs on the inside of the Motor Base to loosen any stuck or sticky debris from drips and spills. If necessary you may use a small brush to scrub the area to ensure it is kept clean.

### ***cross blade:***

**DO NOT REMOVE THE GASKET AS THIS MAY PERMANENTLY DAMAGE THE CROSS BLADE AND CAUSE LEAKAGE.**

- If after washing as indicated additional disinfecting is desired,

you may rinse with a 10% vinegar/water solution. If, over time, the gasket becomes loose or damaged, you may order a new Cross Blade at:

**[www.bulletbrands.com.au](http://www.bulletbrands.com.au) or [www.bulletbrands.co.nz](http://www.bulletbrands.co.nz).**

- Dry the Cross Blade completely. It is helpful to turn the blade on its side in your dish drainer to ensure **both sides** of the Cross Blade are completely dried.
- We recommend replacing your magic bullet® Cross Blade every 6 months or as needed for optimal performance. To order replacement Cross Blades, simply visit: **[www.bulletbrands.com.au](http://www.bulletbrands.com.au) or [www.bulletbrands.co.nz](http://www.bulletbrands.co.nz).**

### ***blending cups*** (cups, lids and lip rings):

- These items are all **Top Rack** dishwasher safe. We recommend rinsing them and giving them a quick brush with a dish brush to remove any dried debris before washing them in the dishwasher. **Never** use the sanitize cycle to wash the blending cups as this may warp the plastic.
- Regularly check the tabs (3) on the sides of the Cups for damage (cracking, crazing, breakage or rounding). If the tabs are damaged, discontinue use and replace immediately to prevent possible personal injury.

### ***storing leftovers in the magic bullet® cups***

The magic bullet® includes **Stay Fresh Resealable Lids** that twist directly onto your **magic bullet® Cups**, allowing you to prep food ahead of time, keep leftovers fresh, or take your meal on the go without dirtying an extra storage container.

## ***replacement parts.***

To order additional parts and accessories, please visit our website at:

**[www.bulletbrands.com.au](http://www.bulletbrands.com.au) or [www.bulletbrands.co.nz](http://www.bulletbrands.co.nz).**



**ONE (1) YEAR  
LIMITED REPLACEMENT WARRANTY STATEMENT**

If your product becomes defective due to faulty material or workmanship within a period of 1 year from the date of purchase, we warrant to do the following:

- For New Zealand Consumers: We will replace the product with a new product, free of charge, or repair the product at our cost, at our discretion.
- For Australian Consumers: Our goods come with guarantees that cannot be excluded under the Australian Consumer Law. You are entitled to a replacement or refund for a major failure and for compensation for any other reasonably foreseeable loss or damage. You are also entitled to have the goods repaired or replaced if the goods fail to be of acceptable quality and the failure does not amount to a major failure.

Your warranty is subject to the following conditions:

- DO NOT operate the appliance with a damaged plug or cord, or if the unit has been dropped, damaged or dropped in water. To avoid the risk of electric shock, do not disassemble or attempt to repair the appliance on your own. If the supply cord is damaged, it must be replaced by a qualified electrician in order to avoid a hazard. Incorrect re-assembly or repair can cause a risk of electric shock or injury to persons when the appliance is used.
- The item has not been misused, abused, neglected, altered, modified or repaired by anyone.
- The item has been subjected to fair wear and tear.
- The item has not been used for trade, professional or hire purposes.
- The item has not sustained damage through foreign objects, substances or accident.

Your warranty does not cover;

- Components that are subject to natural wear and tear caused by normal use in accordance with operating instructions.
- Unauthorised/improper maintenance/handling or overload is excluded from this warranty.
- For guarantee claims, you will need to submit a proof of purchase in the form of a valid receipt that displays date and place of purchase.

This warranty does not replace but is in addition to your statutory rights.

This warranty does not apply to accessories supplied with the item.

This warranty applies only to the original purchaser and may not be transferred.

Replacement items will be covered by the limited warranty for the balance of the warranty period from the date of the original purchase.

Please note:

Only the defective product or parts returned to place of purchase will be replaced under this warranty.



**NEW ZEALAND**

PO Box 100-707

NSMC

Auckland 0745

0800 232633

[www.bulletbrands.co.nz](http://www.bulletbrands.co.nz)

**AUSTRALIA**

PO Box 574

South Morang

Victoria 3752

1300 285538

[www.bulletbrands.com.au](http://www.bulletbrands.com.au)

**220-240V AC 50-60Hz 200W**

**Capital Brands Distribution, LLC | [bulletbrands.com.au](http://bulletbrands.com.au) / [bulletbrands.co.nz](http://bulletbrands.co.nz)  
All rights reserved.**

magic bullet® is the trademark of CapBran Holdings, LLC registered in the U.S.A. and worldwide.

Illustrations may differ from the actual product. We are constantly striving to improve our products, therefore the specifications contained herein are subject to change without notice.

**220708\_MBR-0307 (MB-1001B)**