

## NIVO Large G

by Böttcher & Kayser

Instruction

- ① Make markings on the walls according to the drawing.

Drill a 8 mm hole in each of the two markings.

Marker på væggen hvor de to skruer skal sidde.

Bor et 8 mm hul i hver af de to markeringer.

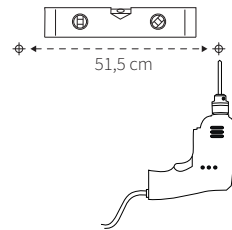

- ② Insert rawplugs in the two holes.

Indsæt rawplugs i de to huller.

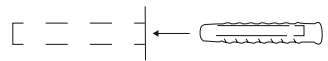

# GEJST

- ③ Fasten the screw 5 mm from the wall.

Skru skruen i, så den er 5 mm fra væggen.

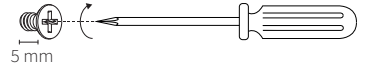

- ④ Place the poles on top of the screws and slide them downwards into place. Repeat with the other pole. Make sure the poles are facing the correct way.

Placer stolpen vertikalt over skruen og skub den ned til den ikke kan komme længere. Gentag med den anden stolpe. Sørg for at stolperne vender den rigtige vej.

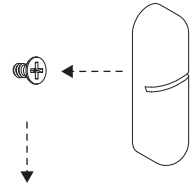

- ⑤ Place the shelf in the slits on the poles, so the holes in the shelf is covered by the center of the slits.

Placer hylden i rillen på stolperne, så hullerne i hylden er centreret i rillen.

