

Hand Dryer

w o r l d w i d e

• high performance

• maintenance free

• service free



HK-1800PA

a u t o m a t i c

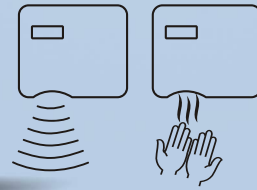

HK-1800PS

p u s h - b u t t o n

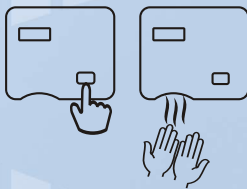

S u r f a c e M o u n t

Casing: Made of high grade fire retardant ABS, 3.0 mm thick.

Hand Dryer HK-1800PA HK-1800PS

Description: HK-1800PA

Automatic operation hand dryer.

Casing: Made of high grade fire retardant ABS, 3.0 mm thick.

Brushless motor : 80W, 2850 R.P.M. (50Hz)

3400 R.P.M. (60Hz)

Designed with 105°C (221°F) thermostat.

Heater assembly : Designed with 87°C (200°F) thermostat.

Designed with 141°C (323°F) thermal cut-off.

Dryer shall deliver 291 m³/h (171 CFM).-- 60Hz

255 m³/h (150 CFM).--50Hz.

Air speed : 16.5 m/s.--60Hz 14.5 m/s.--50Hz

Sound level : 55±3 dB.

Approximately 30-35 seconds drying time.

Adjustable sensitive distance of sensor from 10 to 30 cm.

Power cut off automatically in case of irregular use over 120 seconds.

Drip proof : IPX1

Weight: 3.8kgs (8.4 lbs) unpacked ; 4.5kgs (9.9 lbs) packed.



Description: HK-1800PS

Push-button operation hand dryer.

Casing: Made of high grade fire retardant ABS, 3.0 mm thick.

Brushless motor : 80W, 2850 R.P.M. (50Hz)

3400 R.P.M. (60Hz)

Designed with 105°C (221°F) thermostat.

Heater assembly : Designed with 87°C (200°F) thermostat.

Designed with 141°C (323°F) thermal cut-off.

Dryer shall deliver 291 m³/h (171 CFM).-- 60Hz

255 m³/h (150 CFM).--50Hz.

Air speed : 16.5 m/s.--60Hz 14.5 m/s.--50Hz

Sound level : 55±3 dB.

Approximately 30-35 seconds drying time.

Adjustable timer control range from 20 to 55 seconds.

Power cut off automatically in case of irregular use over 120 seconds.

Drip proof : IPX1

Weight: 3.8kgs (8.4 lbs) unpacked ; 4.5kgs (9.9 lbs) packed.



Specifications and Dimensions

Model	Volts	Watts	Amps	Housing Dimensions: mm (in)		
				L	W	H
HK-1800PA /PS	120Vac	1800W	15A	268(10 1/2)	220(8 3/4)	170(6 3/4)
	220Vac	1800W	8.2A	268(10 1/2)	220(8 3/4)	170(6 3/4)
	230-240Vac	1653-1800W	7.2-7.5A	268(10 1/2)	220(8 3/4)	170(6 3/4)

