

Order number: 01 220 06 99

SHELL electronic wash basin mixer VENUS E HD-M

(high pressure mixed water) mains operation, capable of being parameterised by SSC

Suitable for connection with SWS
vandal-resistant all-metal design
with transformer plug 100 - 240 V, 50 - 60 Hz

Scope of delivery:

- infrared sensor single hole tap with temperature regulator
- electronic module programmable
- 2 flexible connection hoses Clean-Fix S G 3/8 internal thread x 380 mm with integrated backflow preventer (BP, DIN EN 1717: EB) and pre-filter
- cartridge solenoid valve 6 V
- flow regulator
- wash basin mounting accessories

Field of application / Technical data:

- flow volume: max. 5 l/min, pressure independent
- flow pressure: 1 to 5 bar
- max. resting pressure 8 bar
- Water temperature max. 70°C (80°C permissible for 10 min./day)
- adjustable hand programming
 - sensor range: short, medium, long
 - stagnation flush program (duration of flow 30 s, 24 h after last use/ every 24 h)
 - flow time of continuous flush for thermal disinfection (duration of flow 300 s / duration of flow 120 s)
 - cleaning stop 60 s
- flow time adjustment via SWS/SSC

◦ max. flow time	1 - 360 s
◦ post-run time	0,6 - 60 s
◦ stagnation flush time	5 - 600 s
◦ stagnation flush intervals	1 - 240 h
◦ flow time for thermal disinfection	15 - 600 s
◦ duration of flow	15 - 600 s
◦ energy saving mode activated	1 - 254 h
◦ cleaning stop	60 - 360 s

Details:

- Material:

housing out of brass conform German drinking water regulation

- Surface: chrome
- Weight: 2.63 kg/pc.
- Packaging unit: 1

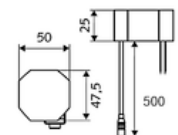
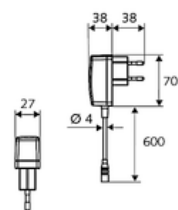
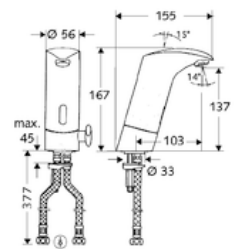

Recommended associated item:

SSC Bluetooth®-Module
extension cable 1,5 m
angle valve thermostat
Pressure Balance Valve PBV

Order No.: [00 916 00 99](#)
Order No.: [51 010 00 99](#)
Order No.: [09 406 06 99](#)
Order No.: [06 558 12 99](#)

angle valve with regulating function COMFORT with filter Order No.: [05 430 06 99](#)
