

### SELECT OUTLET POSITION:

Place the pump flat on its base. To get **Position 2**, **Position 3**, **Position 4** as shown below the body of the pump needs to rotate with the handle/stand and **Lock into Notches A, B or C** respectively located in the base of the handle/stand. To get **Position 1** rotate the pump into **Notch A** while the volute is removed and manually rotated Counter Clockwise into the desired position. To get **Position 5** rotate the pump into **Notch C** while the volute is removed and manually rotated clockwise into the desired position.



Position 1 Position 2 Position 3 Position 4 Position 5

### Label Notch - A, Notch - B, Notch - C



### Pump Maintenance:

This pump design features a water lubricated ceramic bearing and shaft for long lasting service. However, the rotor assembly is susceptible to failure if sand or extra fine grit is being pumped.

- CAUTION: Always disconnect the pump when performing any maintenance or handling.
- Check the circuit breaker and try another (GFCI) outlet to ensure the pump is getting electrical power.
- Check the pump discharge, impeller and tubing for obstructions.
- Check the inlet screen to ensure it is not clogged
- After removing the volute, rotate the impeller by hand to insure that it can spin freely.

5

### Cleaning the Impeller and Volute chamber:

To clean the volute chamber and impeller remove the volute by rotating it **counter clockwise**. This will expose the pump impeller. To clean the volute chamber and impeller use a garden hose to spray out any debris.

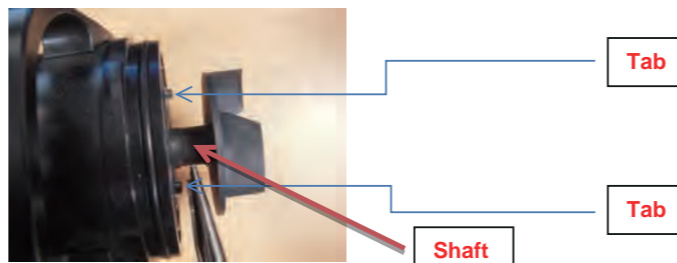

Figure - a

Figure - b

### Cleaning or Replacing the Impeller:

To clean or replace the impeller assembly, first remove the front housing by rotating it **counter clockwise** (See Figure - a and b). With the impeller exposed locate the three tabs.



Using a pair of needle-nose pliers, very gently grip the shaft with the tip of the pliers while also locking in one of the tabs at the same time. Gently turn the shaft counter-clockwise while pushing on the tab to unlock the impeller assembly. Pull the assembly straight out to remove from motor housing. See fig - c, d and e. Use only minimal force while doing this to avoid damaging the tabs on the pump or the impeller assembly. Visually inspect the impeller assembly for any damage. The impeller assembly for PG Pumps is one assembly as shown in **Figure - 4**

6



### Installing Impeller Assembly and Front Housing:

Before reinstalling the impeller assembly it is recommended to use Lifeguard Silicon lubricant on the ceramic shaft, metallic rotor of the impeller assembly and the o-ring on the pump body. After this is complete, reinstall all the components back into the pump by sliding the impeller assembly back into the motor housing.

Using a pair of needle-nose pliers, very gently grip the shaft and one of the tabs and at the same time and turn clockwise while gently pushing on the tab to lock the impeller assembly. When you hear a click sound it means the impeller is locked. Use only minimal force while doing this to avoid damaging the tabs on the pump or the impeller assembly.



Figure - f

O-ring Ceramic Shaft Metallic Rotor

Reinstalling the Front Housing by sliding it over the impeller chamber and rotating it **clockwise** until it locks at the desired position.

1

## Parts Breakdown

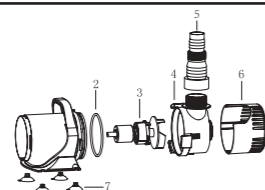

### PG PUMP PARTS

Item No.	Part No.	UFC	DESCRIPTION	Item No.	Part No.	UFC	DESCRIPTION
2	R800000	314927	O Ring, PG 1600	6	R800018	315054	Prefilter Screen, PG 1600
2	R800001	314934	O Ring, PGPG 2700	6	R800019	315061	Prefilter Screen, PG 2700
2	R800002	314941	O Ring, PGPG 4500 & PG 5300	6	R800020	315078	Prefilter Screen, PG4500 & PG 5300
2	R800003	314958	O Ring, PG 6600	6	R800021	315085	Prefilter Screen, PG6600
3	R800009	314965	Impeller Assembly, PG 1600	5	R800022	315092	Flexible Tube Fitting, PG 2700, 3/4" or 1" ID
3	R800010	314972	Impeller Assembly, PG 2700	5	R800023	315108	Flexible Tube Fitting, PG 1600, 1" or 1 1/2" ID
3	R800011	314989	Impeller Assembly, PG 4500	5	R800024	315115	Flexible Tube Fitting, PG 4500, & PG 5300, 1 1/4" or 1 1/2" ID
3	R800012	314996	Impeller Assembly, PG 5300	5	R800025	315122	Flexible Tube Fitting, PG 6000, 1 1/2" or 2" ID
3	R800013	315009	Impeller Assembly, PG 6600	7	R800026	315139	Suction Cups, PG Pumps (set of 4)
4	R800014	315016	Front Housing, PG 1600				
4	R800015	315023	Front Housing, PG 2700				
4	R800016	315030	Front Housing, PG 4500 & PG 5300				
4	R800017	315047	Front Housing, PG 6600				

### LIMITED WARRANTY

The Lifeguard PG pumps are warranted to the user against defective material and workmanship under normal use, for a period of 1 year from the date of purchase by the original purchaser. Replacement liability in all events is limited to the replacing or repairing at Lifeguard's sole discretion of any part or parts, which are defective in material or workmanship. Proof of purchase is required on all claims in the form of invoice copy, sales ticket, etc.

**APPLICATION:** Warranty covers only properly installed and maintained units. Warranty is limited to applications pumping fresh water at temperatures of 32°-86°F (0°-30°C), with a pH range of 5 to 9. Lifeguard Aquatics must approve other liquid applications and extreme temperature uses in advance in writing.

**INSTALLATION and/or REMOVAL CHARGES:** Warranty does not cover any costs associated with the installation or removal of products subject to warranty claims.

**DISPOSITION:** Lifeguard will make a good-faith effort for prompt disposition regarding any item in warranty, which proves to be defective. If products were damaged in transit, please file a claim with the carrier.

**DISCLAIMER:** Lifeguard Aquatics will not be liable for any labor cost of removing or replacing component parts. This shall be the responsibility of the original purchaser, as will be the shipping charge to Lifeguard Aquatics facility. Any oral statements about the product made by the seller, the manufacturer, the representatives or any other parties, do not constitute warranties, should not be relied upon by the user, and are not part of the contract for sale. Seller's and manufacturer's only obligation and buyer's and user's only remedy, shall be for the manufacturer to either replace and/

2

or repair at the manufacturer's sole discretion the Lifeguard product as described above. Neither seller nor the manufacturer shall be liable for any injury, loss or damage, direct, incidental or consequential (including, but not limited to, incidental or consequential damages for lost profits, lost sales, injury to person or property, or any other incidental or consequential loss), arising from any cause whatsoever, no matter whether based upon warranty, contract, negligence or other misuse, and the buyer and user agree that no other remedy shall be available to them. Damage or failure of any part of a unit covered by this warranty, which results from causes directly, or indirectly connected with the installation, operation, environment, use or willful abuse, including without limitations, improper repackaging and damage incurred in shipping is not covered by this warranty. Unless state law provides otherwise, the manufacturer will only be responsible for repair or replacement of any of its products or parts that are found to be defective, and will not bear any cost of any incidental or consequential damages arising out of the occurrence of such defect. Before using, the buyer and user shall determine the suitability of the product for the intended use, and assumes all risk and liability whatsoever in connection herewith. The warranty and remedy described in this limited warranty is an **EXCLUSIVE** warranty and remedy. IN LIEU of any other warranty or remedy, expressed or implied, which other warranties and remedies are hereby expressly **EXCLUDED**, including but not limited to any implied warranty of **MERCHANTABILITY OR FITNESS FOR A PARTICULAR PURPOSE**. This Warranty gives buyer and user specific legal rights, and buyer and user may also have other rights that vary from state to state. Some states do not allow the exclusion or limitations of incidental or consequential damages, so the above limitation or exclusion may not apply to you.

- Warranty period starts from date of purchase and must be validated with copy of original purchase receipt.
- Warranty requests by phone will not be honored.
- Warranty items returned without copy of original purchase receipt will not be honored.
- Products purchased from eBay, Craigslist, etc cannot be honored for warranty unless returned through original purchaser with proof of purchase.
- All items must first be returned to Lifeguard Aquatics for inspection, evaluation, and processing to determine if product qualifies for warranty replacement or repair. No warranty (repair, replacement, or credit) will be issued prior to inspection of product. **Please contact us first for warranty assistance. Many times the product can be repaired without the cost and time involved in sending it back to us.** If absolutely necessary, return product freight prepaid to the following address for warranty evaluation and processing.

Lifeguard Aquatics 16301 Carmenta Road Cerritos, CA 90703  
Tel (562)404-4129 Fax (562)404-4159 Email: info@lifeguardaquatics.com

- 3 year warranty** from date of purchase on **Quiet One Pump Motors Only**.
- 60 day warranty** from date of purchase on **Shatts and Impellers for All Types of Pumps**.
- 60 day warranty** from date of purchase on all **UltraViolet Bulbs**.
- 60 day warranty** from date of purchase on all **Test Strips**.
- 1 year warranty** from date of purchase on **All Other Products including PG Pumps, LED Lights, Heaters**.

- Pump Maintenance:**
- This pump design features a water lubricated ceramic bearing and shaft for long lasting service. However, the rotor assembly is susceptible to failure if sand or extra fine grit is being pumped.
  - CAUTION: Always disconnect the pump when performing any maintenance or handling.
  - Check the circuit breaker and try another (GFCI) outlet to ensure the pump is getting electrical power.
  - Check the pump discharge, impeller and tubing for obstructions.
  - Check the inlet screen to ensure it is not clogged
  - After removing the volute, rotate the impeller by hand to insure that it can spin freely.



Imported by Lifeguard Aquatics  
Cerritos, CA 90703 Tel: (562)404-4129 Fax: (562)404-4159  
www.lifeguardaquatics.com Email: info@lifeguardaquatics.com

3

# PG PUMP

## INSTRUCTION MANUAL



## PONDS FOUNTAINS WATERFALLS

Lifeguard PG Pump Instructions: High performance energy-efficient pumps designed for use in Ponds, Fountains, Waterfalls, Hydroponic Systems, Irrigation Systems and Water Features. For use in either wet or dry installations and features Wet Rotor/Wet Bearing Technology for cooler running. Pre-filter screen handles large particles for less maintenance. Multiple size inlet Fitting and Suction Cups included. Designed for Fresh water use only.



### PG 1600

Watts: 90 Amps: 0.8  
Voltage: 120V 60Hz  
Horse Power: 0.12HP  
Inlet/Outlet: 1"

FLOW RATE (gpm)	HEAD (ft)
1585	0.0
1506	0.7
1189	3.3
978	4.9
740	6.6
542	8.2
370	9.8
251	11.5
132	13.1
0	15.7

### PG 2700

Watts: 120 Amps: 1.1  
Voltage: 120V 60Hz  
Horse Power: 0.16HP  
Inlet/Outlet: 1 1/2"

FLOW RATE (gpm)	HEAD (ft)
2325	1.6
1982	3.3
1638	4.9
1295	6.6
978	8.2
700	9.8
462	11.5
264	13.1
0	15.7

### PG 4500

Watts: 210 Amps: 2.0  
Voltage: 120V 60Hz  
Horse Power: 0.26HP  
Inlet/Outlet: 1 1/2"

FLOW RATE (gpm)	HEAD (ft)
4491	0.0
4227	1.6
3831	3.3
3329	4.9
2814	6.6
2259	8.2
1783	9.8
1347	11.5
951	13.1
608	14.8
357	16.4
0	19.4

### PG 5300

Watts: 310 Amps: 2.7  
Voltage: 120V 60Hz  
Horse Power: 0.43HP  
Inlet/Outlet: 1 1/2"

FLOW RATE (gpm)	HEAD (ft)
5284	0.0
5020	1.6
4756	3.3
4412	4.9
4042	6.6
3620	8.2
3197	9.8
2721	11.5
2219	13.1
1717	14.8
1189	16.4
676	19.7
0	24.0

### PG 6600

Watts: 335 Amps: 2.90  
Voltage: 120V 60Hz  
Horse Power: 0.45HP  
Inlet/Outlet: 2"

FLOW RATE (gpm)	HEAD (ft)
6605	0.0
6300	1.6
5948	3.0
5548	4.9
5091	6.6
4620	8.2
4123	9.8
3605	11.5
3095	13.1
2523	14.8
1991	16.4
1480	18.2
991	20.3
264	20.3
0	22.6

### All Pro Series

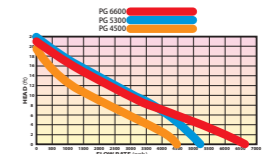
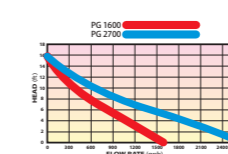

4