

AQUA-IONIZER PRO[®]

ionHealth™ Touch

WATER IONIZER



OWNER'S MANUAL

Read Carefully
Before Initial Use

Retain Manual for
Future Reference

Made in Korea

v. 1.0

Contents

Safety Suggestions	Safety Suggestions	(3)
	Installation	(4)
	Important Notice	(4)
	Electrical Safety	(5)

How to Use	Parts	(6)
	Controller / Indicator	(7)
	Instructions for use	(8-9)
	How to Operate	(10)
	Replacing Fuse	(11)
	Replacing Filter	(12)
	Installation	(13)
Installation Details	(14)	

Troubleshooting	(15)
-----------------	--------

Specifications	(16)
----------------	--------

Warranty Card	(17)
---------------	--------

Safety Suggestions

Additional Warnings



Do not use alkaline water in fish tanks or bowls,

Do not **allow** children to play with the unit.
Children shall not play with the appliance.
Cleaning and user maintenance shall not be **done** by children.

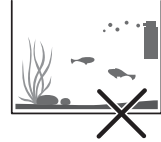

Tap Water as Source



Use only tap water.
Do not use with polluted water,
micro-biologically unsafe water.



General Issues 1



When first drinking water use setting 1 (Low pH).
Then gradually drink higher pH water as your body gets accustomed to it.



General Issues 2



Do not drink the acidic water,
Acidic water will be good for washing fruit and vegetables.



Installation

Install on a stable surface



Always level the device horizontally.
Install the **water ionizer** in a level position.
Do not install the device on a sloped or unstable surface. If the device is dropped or heavily impacted, it may be damaged.

Avoid heat & cold



Keep away from heat,
direct sunlight,
electrical heaters, etc.

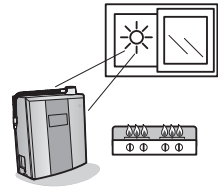

Water supply temperature



Do not allow hot water into the unit,
(+35 Celsius, 95 Fahrenheit)

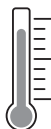

Cause of Electric shock, fire, damage



Do not place anything on the machine.
If the supply cord is damaged,
it must be replaced by the manufacturer.



Installation

Suitable for Alkaline / Acidic water



- Water supply (feed water) for electrolyzation should be from normal tap water, low hardness, etc. If over this amount, pre-filtration will be required.
- **Correct water hardness is key in generating good alkaline/acidic water.**



On the sink

Install on the counter and adjust the spout so that the water can be directed to the sink. If the spout is not adjusted properly, the water may flow over the sink.

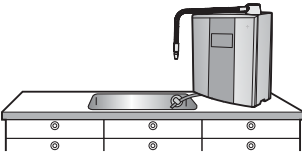

Hose height

The drainage hose product below 10cm.

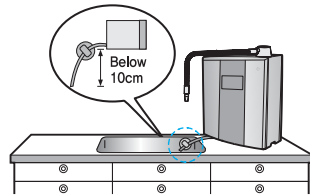

Undersink

Note: a SMART FAUCET Kit must be purchased seperately for undersink installation.
Call (888) 601-5886 to order.

Important note about drinking ionized water

Disclaimer



- Please ensure correct usage of this product and that you have read the instructions **thoroughly**.
- Please consult your healthcare professional if there are any adverse effects or pain after using the water.
- Due to quality improvement, specifications of the unit may be changed without prior notice.

Electrical Safety

Cause of Electric shock / Fire



Do not use if the electric cord or plug is damaged or if the outlet is loose. It may cause an electric shock, short circuit and / or cause a fire.

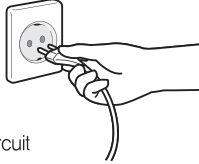

Do not bend electric cord



Do not damage, modify, bend, pull, or twist the electric cord. It may cause an electric shock, short circuit, and / or cause fire.

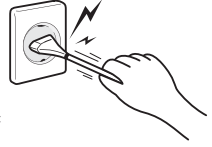

Cause of Electric Shock



Do not connect or disconnect the power plug with wet hands. It may cause an electric shock.

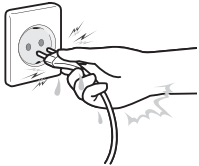

Do not use extension



Do not use extension cables to connect more than one device to a single outlet. It may cause fire.

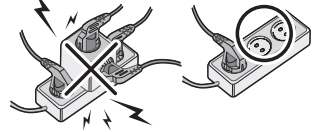

To Repair



For repair / maintenance or parts exchange, always disconnect power plug first. Otherwise it may cause an electric shock.

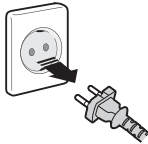

Never disassemble



Never disassemble or modify the device. It may cause an electric shock or fire.

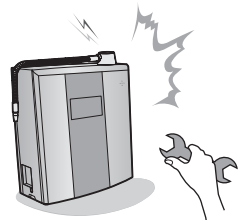

Cause of electric shock / leak



Do not use in humid places, such as bathrooms. Never spray water on the device or clean it with water. It may cause an electric shock or leak.

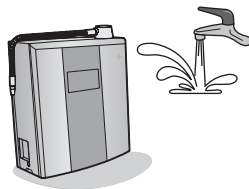

Parts

Front Surface

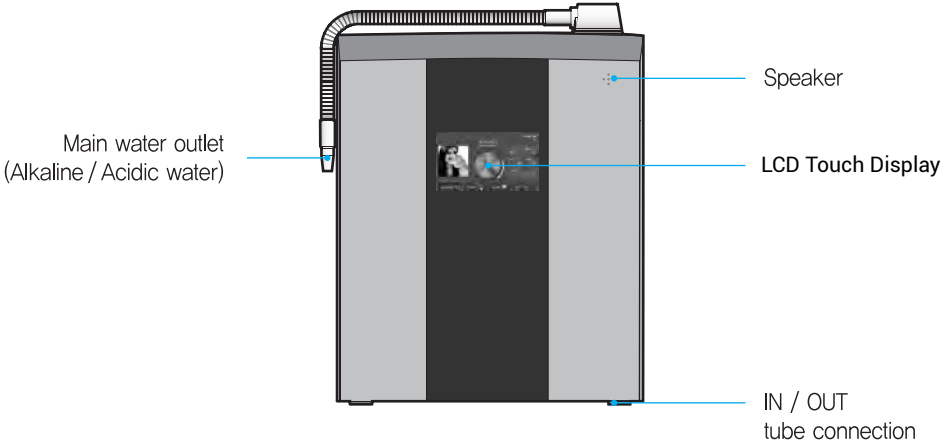

Rear Surface

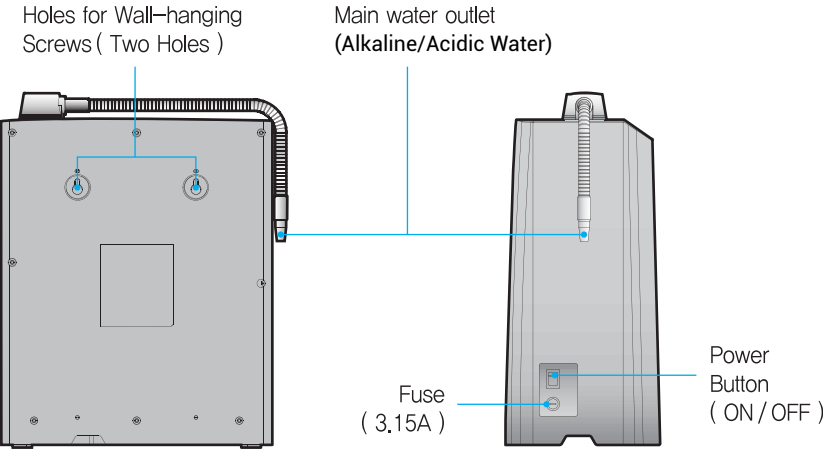

Controller / Indicator

Use of Controller / Indicator



Instructions for Use

Before Use

- Choose a safe place for the installation.
- Connect with tap water.
- Flush water for 2–3 minutes after installation completed.
Black water containing carbon powder may be coming out in initial time after installation, Please, throw away the water.
- Prepare plastic cup or glass container for collecting the drinking water,
Do NOT use metallic container.

Alkaline water generation



1. Touch the "Alkaline" button to select the desired level of alkaline water. Whenever you touch it, the Alkalinity is changed.
-



2. When the desired level is selected, touch the ON / OFF button and enjoy the alkaline water.

Purified water generation



1. Touch the "Purified" button to select the purified water.
-



2. Touch the ON / OFF button and enjoy purified water.

Instructions for Use

Acidic water generation

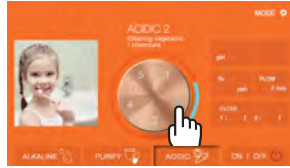

1. Touch the "Acidic" button to select the desired level of acidic water. Whenever you touch it, the Alkalinity is changed from 1 through 5.



2. If the acidic button is already selected, touch the ON / OFF button to produce acidic water.

How to enter into Administrator Mode

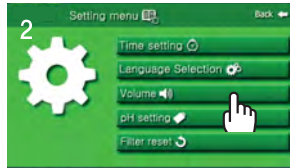
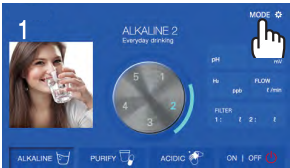

1. Touch the mode button to enter into administrator mode, and touch VOLUME.

How to adjust voice volume

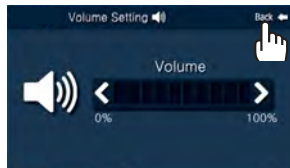
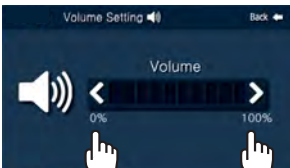

2. When you touch >, volume is increase and < is touched, volume is decreased.

3. When Back key is touched, setting is automatically saved.

How to Use

How to optimize pH

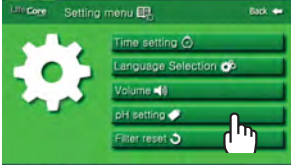

- Standard pH level is 4.
- If you want stronger pH, make 5, 6 or 7 level by touching > key.
- If you want weaker pH, make 1, 2 or 3 by touching < key.

How to clean electrolysis cell

- Clean the electrolysis cell to extend the lifetime of platinum electrode by producing acidic water.

IMPORTANT

- We recommend customers operate acidic water about two times per month for 10 minutes, **at low flow rate**.

How to store

- Must be moved **only** after the power is turned off.
- When **storing**, the product should be **clear of water, drain hoses, lines, and filters**.
- Outlet and inlet hose should be kept **clean**.
- Unplug when not in use for a long time.
- Do not store in a humid place.
- **Replace filters if stored for a long period of time.**

For better drinking

- Always discard the initial dispensed water as a precaution it will ensure the integrity of desired pH level selected.
- For first **time users of alkaline ionized water** always begin with the lowest pH level setting before gradually increasing it.
- Do not take medication with alkaline water to prevent compromising the integrity of prescribed medicine. Take your medication with purified water instead.

Replacing Fuse

Fuse change



Unplug unit from power source before replacing fuse.

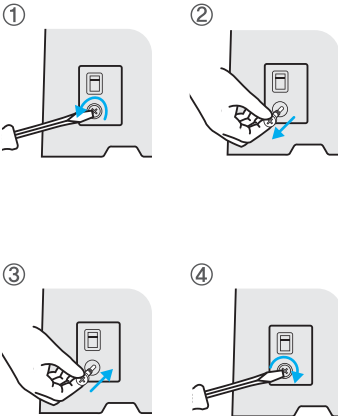

Fuse is located on the lower side part the body.

1. The fuse can be removed if rotated counter- clockwise with a screwdriver.
2. Please remove the fuse with finger.
3. Insert the new fuse (240V 3.15A).
4. Tighten the fuse rotating it clockwise with a screwdriver.

※ **Note:**

When changing the fuse, please make sure to unplug the power cord first. Not doing so, may cause electric shock.



Installation and Use conditions

- Please do not use inappropriate water for drinking.
- Please do not use in high temperatures or high humidity.
- Please do not use the machine where affected by atmospheric pressure, wind, sun, or salt.
- Do not use in places where gass is generated or in a chemical warehouse.
- Please do not use on a sloped or unstable surface.
- Do not use in low water pressure (under 14.2psi) and low flow rate (1L/min or less).

※ **Temperature:** + 5°C ~ + 30°C

※ **Humidity:** 70 ± 15%

※ **Atmospheric pressure:** 1013hPa ~ 877hPa

Replacing Filter

Replace the filter in the following order after unplugging the power source and closing the source water valve.

1. Open the front door cover as pictured.

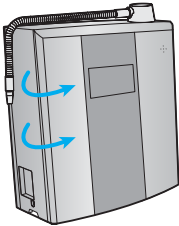

2. Press **down** the top part of filter and pull it
▷ Filter 1, Filter 2 will be separated in the same way.

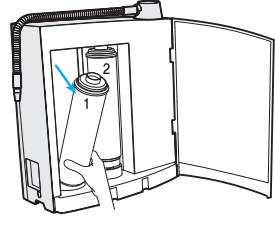
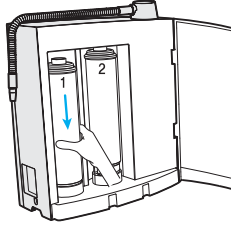

3. Remove plastic end caps on the filter, two caps per filter
4. Insert a new filter into the base hole and press the filter.
▷ Filter 1, Filter 2, will be mounted in the same way.

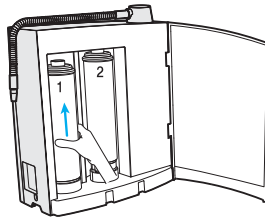
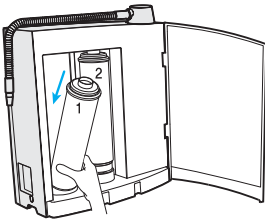

※ Please make sure the filter is locked upward to prevent any leaks.

5. Close the front door

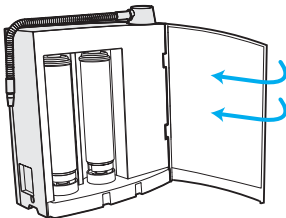

Installation

Connection Diagram

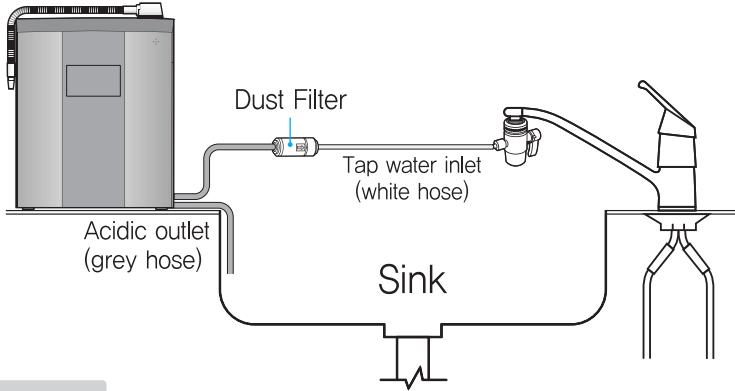

Component

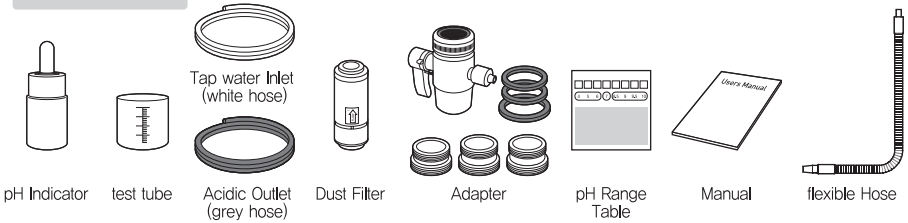

Option : Connection to Faucet

Faucet Type : External Screwed

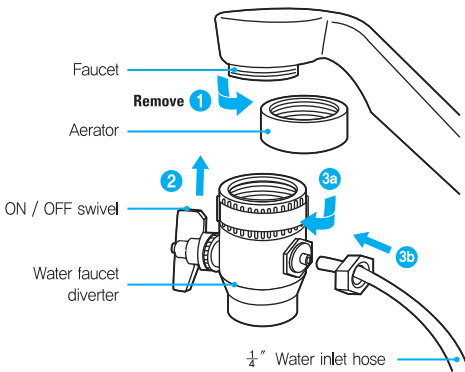

Faucet Type : Internal Screwed

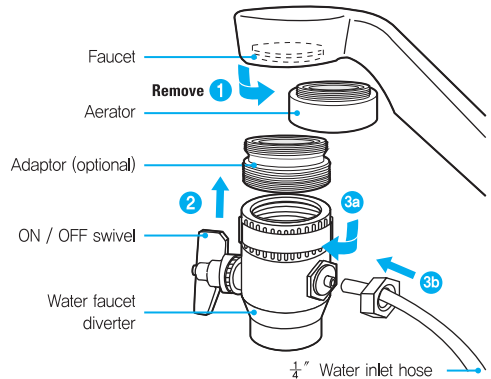

How to Install

Installation video: <https://aquaionizerpro.com/pages/install>

- Step 1: Please be sure to fully unpack your ionHealth™ Silver and Smart Faucet. Remove any stoppers on the water in/out lines. **Tools Needed: Scissors, Slip Joint Pliers.**
- Step 2: OPTIONAL: If your 5/16ths hose isn't long enough Install the 5/16ths COUPLER on the "IN" water line, between the cold water fitting and the "IN" water line.
- Step 3: Feed the hoses and black cable down the hole in the sink attached to the faucet. Mount the Smart Faucet into the hole.
- Step 4: Under the sink, take the white hoses and black cable attached to the faucet and feed them through the silver washer and brass nut.
- Step 5: Screw on the brass nut to the Smart Faucet and tighten.
- Step 6: Turn off the cold water and install the included Cold Water T Fitting. Unscrew the COLD WATER connected metal hose, and place the T fitting in between. Hand tighten, then re-install the COLD WATER metal hose.
- Step 7: Remove the blue clip on the T fitting. Install the white hose to the Cold Water T inlet by firmly pushing it in. Reinstall the blue clip. (Space before "Reinstall" & Spelling of Reinstall)
- Step 8: Take the hose we just connected to the T Fitting to the inlet, and insert it to the IN - closest to the back of the machine and closest to the yellow sticker. Be sure to push the hose in firmly for a secure connection.
- Step 9: Cut the hose connected from the Cold Water T inlet, and install the included Dust Filter with the Blue side closest to the T Fitting. Reconnect the loose hose to the White side. Ensure the Arrow on the Dust Filter follows the flow of water and make sure the hoses are connected securely to prevent any leaks.
- Step 10: Take the 1/4in the smaller loose hose from the Smart Faucet and install it into the OUT on the ionHealth™ Silver, next to the RED dot.
- Step 11: Plug the black cable from the Smart Faucet into the TOP BACK of the ionHealth™ Silver.
- Step 12: Take the included Male Fitting from the parts bag, and screw it into the TOP of the ionHealth™ Silver.
- Step 13: Connect the remaining hose (5/16th) from the Smart Faucet into the TOP of the ionHealth Silver.
- Step 14: Turn on the ionHealth™ Silver
- Step 15: Make sure your Smart Faucet is powered on and working.

Installation Method

Turn lever to open position
to allow water to flow

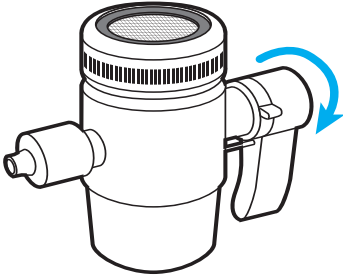

Check for leaks after installation

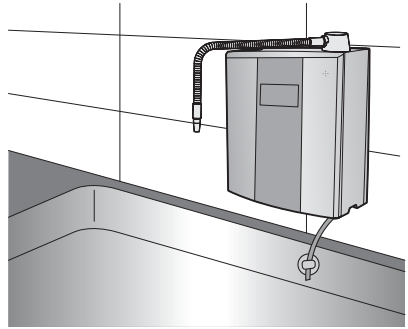

Turn the lever horizontal for
water to flow into the ionizer.

Turn the lever vertical for
water to flow though like
normal for your sink.

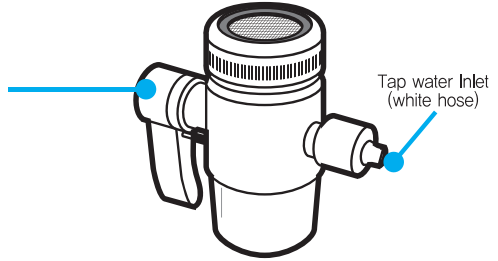

1/4 hose connection adapter,
and The other side Hose connection Water supply inlet.

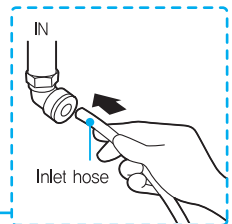
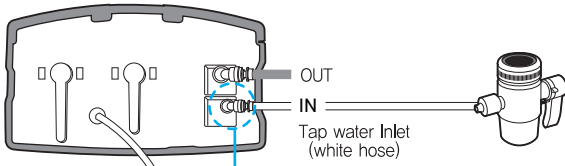

The Drainage Hose (**Acidic**) connection for Product Outlet.

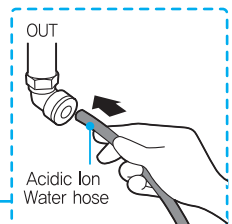
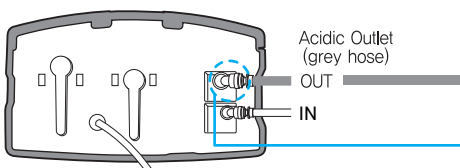

Troubleshooting

Troubleshooting

If there is ANY TROUBLE IN OPERATING this device, please read the instructions carefully and use the checklist below.

Symptoms	Things to Check for	Possible Solutions
No power to the unit or the On/Off Button does not illuminate	Is the power cord and plug properly connected?	Plug in properly and switch on the power to the unit.
	When you are satisfied that the unit is receiving power but the On/Off button does not illuminate, check the internal fuse.	If the fuse has blown, then replace the fuse. Please see "how to change the fuse."
There is power to the unit, the On/Off button illuminates but there is sporadic, or no water generation	Is the water supply cut/off valve open?	Open the water supply cut off valve.
	Check ALL water supply connections	Connect all pipes properly.
	Water supply hose bent or folded?	Ensure that the water hose is free from constrictions.
	Low water pressure? (Below 0.7 kg/cm ³)	The unit cannot be used in areas of low water pressure. Call (888) 601-5886.
	NO feed water supply or frozen?	Wait until water supply resumes.
	Filter blocked?	Replace filter.
NO Alkalinity?	Check if any figure appears on the screen.	see how to adjust machine according to feed water quality.
Low Alkalinity?	Do you reside in an area of high water hardness?	Alkalinity will be different depending on water hardness area and feed water quality.
	Over supply of water?	reduce the amount of feed water supply flow. (Normal : 2 ~ 3bar of 5)
	Not enough drainage?	Call (888) 601-5886.
Stops in the middle of operation	Has continuous operation time passed 10 minutes	The unit automatically stops after 10 minutes of continuous operation. Please wait for the on button on the screen to illuminate. The unit will then be ready to use.
Leakage from filter	Is it installed properly?	Replace the filter. If the problem persists then contact 1-888-601-5886 Stop operation
	Any leakage in the main body?	
There is a strange odor or the water tastes different.	Unused for a long time?	Flush water for more than 3-5 minutes. If the problem persists, replace the filter.
	Excess alkalinity?	Increase the water supply by opening the supply valve
	Filter change overdue?	Replace filter.
Water does not look clean	Is something deposited at the base of the container?	Calcium or other minerals can be present depending on area. No issue to drink water. Water has been cleaned by GAC(Granulated Activated Carbon) material.

Specifications

Specifications

※ The below specifications are subject to change without notice for performance improvement.

★ Home use only.

Specifications

Manufacturer	Aqua Ionizer Pro®
Product Name	Water Ionizer
Model	ionHealth™ Touch
Rated Voltage	110-240 Volts 50-60 Hz
Electric Consumption	170VA (7 plates)
Power Protector	Fuse 3,15A
Weight	About 6kg
Packaging Unit	1 EA
Required Water Pressure	0,05 – 0,5MPa
Instructions	Refer to User's Manual
Water Volume generated	2 – 3liters / min (0,53gallon – 0,79gallon / min)
Cleaning	Automatic Cleaning System
Filter Lifespan	2000-6000L depends on Water Quality

※ Filter life span depends on water quality. If filter is blocked before 6,000 liter use, please replace filters for your health.

Limited Lifetime Warranty:

Limited Lifetime Warranty:

Real Spirit USA, offers a Limited Lifetime Warranty on all its water ionizers to the original consumer purchaser under the following terms and conditions:

VIP Limited Lifetime Warranty:

By Purchasing the ionHealth™ your warranty period is extended beyond the 'Limited Lifetime Warranty' to a 'VIP Limited Lifetime Warranty' on parts and labor or a full unit replacement should your ionHealth™ fail at any time now or in the future while in use by the original purchaser.

Whether in the first 5 years or subsequently, upon discovery of a product defect, you should immediately notify Real Spirit USA via telephone or email the exact problem you are having to the best of your knowledge. If it is determined to need additional diagnostic inspection, then we will provide you a product return authorization and shipping instructions. You should ship or deliver the product to the designated service location, accompanied by your name, address and telephone number, proof of purchase date and a description of the defect. The customer is responsible for the cost of shipping the unit to the service facility. However, following repair or replacement, RealSpirit USA will cover the cost of shipping the unit back to the consumer within the continental United States. Customers outside the continental United States must also cover the cost of return shipping following repair or replacement.

The warranty does NOT include unusual wear, damage resulting from accident or unreasonable use and also does not include replacement filters nor other disposable parts and supplies. *Unreasonable use also includes using the unit outside of North America and in countries where the voltage may be higher than 110/120 Volts, which is the normal operating range of our products.** Additionally the warranty will become VOID should the case seal be broken and the tamper system activated which shall indicate the unit cabinet was opened for purposes other than authorized by the company. It should be noted that any electronic unit should be serviced only by an authorized service technician duly certified by Real Spirit USA, all warranties are non-transferable and remain registered to the original purchaser.

**Note: Please contact us for special 220/240 volt international models which may be available for use outside of North America.

Water Damage Liability Statement and Waiver

Aqua Ionizer Pro® water ionizers and filters are covered by our Limited Lifetime Warranty* Aqua Ionizer Pro® or its parent company Real Spirit USA, Inc accepts no liability, nor offers any warranty or remedy for damages of any kind in regard to water damage caused or reported to be caused by leaks from hoses, fittings or directly from any of our products.

Further Real Spirit USA does not warrant or accept any liability in regard to installing our Ionizer units, hoses, or additional valves or filters. Any such installation is at the sole responsibility of the owner or the third-party installer, plumber or contractor.

The customer/ user by purchasing our products accepts full responsibility for ensuring that the proper acceptable water pressure is present at the time of installation (as stated in the owner's manual). Water pressure is controlled by the supplier or the home owner and cannot be controlled or guaranteed by Real Spirit USA or its affiliates.

All installations should be approved by a nationally recognized P.I.P.E. or other certified contractor.

-P.I.P.E. is the parent company of the National Inspection Testing and Certification Corporation, known in the industry as National Inspection Testing Certification (NITC).

Once you have installed your unit, it is recommended that connections and connectors are inspected by the owner on a regular basis. It is also recommended that if you are away from the installation for longer than a 24-hour period that you turn off the water supply to your Water Ionizer system as well as turn off the supply power to your unit.

Basic care and maintenance by the owner/ user of this equipment is entirely the responsibility of the purchaser-owner/ user, as Real Spirit USA assumes no responsibility for misuse, faulty installation, or variations in water pressure or quality.

Other than what is expressed in our products warranty, Real Spirit USA assumes no additional liability for these foregoing statements or other 'Acts of God'.

By acceptance of delivery, and the installation the Real Spirit USA products (filters, ionizers, and accessories) you agree to hold Real Spirit USA harmless for any water damage caused by leaking water or for any other reason.

*See warranty on previous page

AQUA-IONIZER PRO

Any Questions?

(888) 601-5886

Produced and distributed exclusively by:



Aqua Ionizer Pro® is a division of Real Spirit USA, Inc.
320 South Rock Blvd Suite 210 • Reno NV 89502 • Ph 888.601.5886
www.AqualonizerPro.com • help@realspiritusa.com