

QUICK START GUIDE

Installation Help: (888) 601-5886

Here are 5 simple steps to installing your water ionizer. For more detailed steps please refer to the product manual. Please follow each of the steps in the boxes below starting with No. 1.

1 Identify Required Connector & Attach Faucet

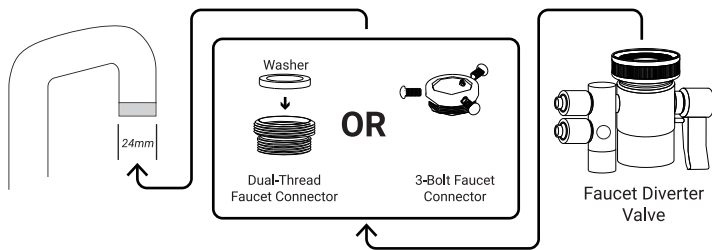

Home faucets typically fall into 1 of 3 categories

The type of faucet you have will determine whether the Faucet Diverter Valve fits directly to your faucet or which type of faucet connector(s) you will use to attach the Faucet Diverter Valve to your Faucet. There are three connectors included with your Ionizer:

A.) Threaded on Outside B.) Threaded on Inside C.) Unthreaded

IF THESE OPTIONS DO NOT WORK PLEASE CONTACT US.

2 Insert The Inner Carbon Filter

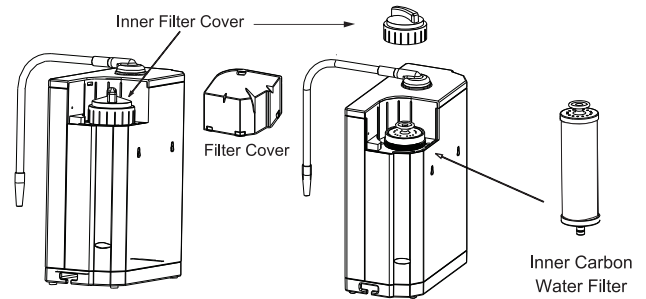

Remove the outer filter cover by pressing on top and pulling up. Twist the inner filter cover counter-clockwise to open. Prime a new inner filter by holding it under running water for 3-5 minutes with the water going into the side with the 2 black o-rings. Insert the inner carbon filter into the filter chamber and press firmly. Replace the inner filter cover and the filter cover.

3 Check Pre-installed Hoses

Your ionizer will come with two 1/4 inch white hose installed. The OUT hose will have a RED dot that will match up with the RED dot on the diverter in the next step.

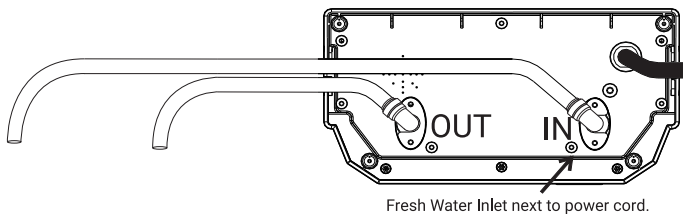

Important: You may need to cut the hoses shorter to fit your set up. Please wait until your installation is complete before cutting the hoses.

4 Connect Metal Spout & Faucet Diverter

1. Attach the flexible metal spout: Remove the rubber stopper and screw in the flexible metal spout on top of the ionizer.
2. Unscrew the caps on the diverter and slide the caps over the hoses. Connect the inlet water hose to the top faucet diverter valve and the acidic/residual water outlet hose into the bottom of the valve. Push each hose on firmly and screw on the caps to ensure a secure connection. These may require a good amount of force to prevent any leaks.

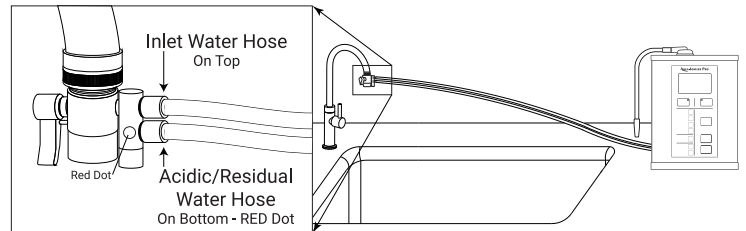

5 Plug In & Check For Leaks

Plug your water ionizer into a power outlet and turn the faucet diverter valve so water flows through the machine. If there are leaks, please recheck all connections for a secure fit.

FOR INSTALLATION VIDEOS & HELP

Visit:
www.aquaionizerpro.com/install
 OR

SCAN WITH YOUR SMART PHONE



CUSTOMER SERVICE

Toll Free: (888) 601-5886

Text Us: (775) 432-2861

Help@RealSpiritUSA.com