

# INSTALLATION INSTRUCTIONS



No. 940446



**CUSTOM MOLDED FRONT MUD GUARDS FOR  
FORD TAURUS**

**Included in Box**

- Front Mud Guards (for driver & passenger side)

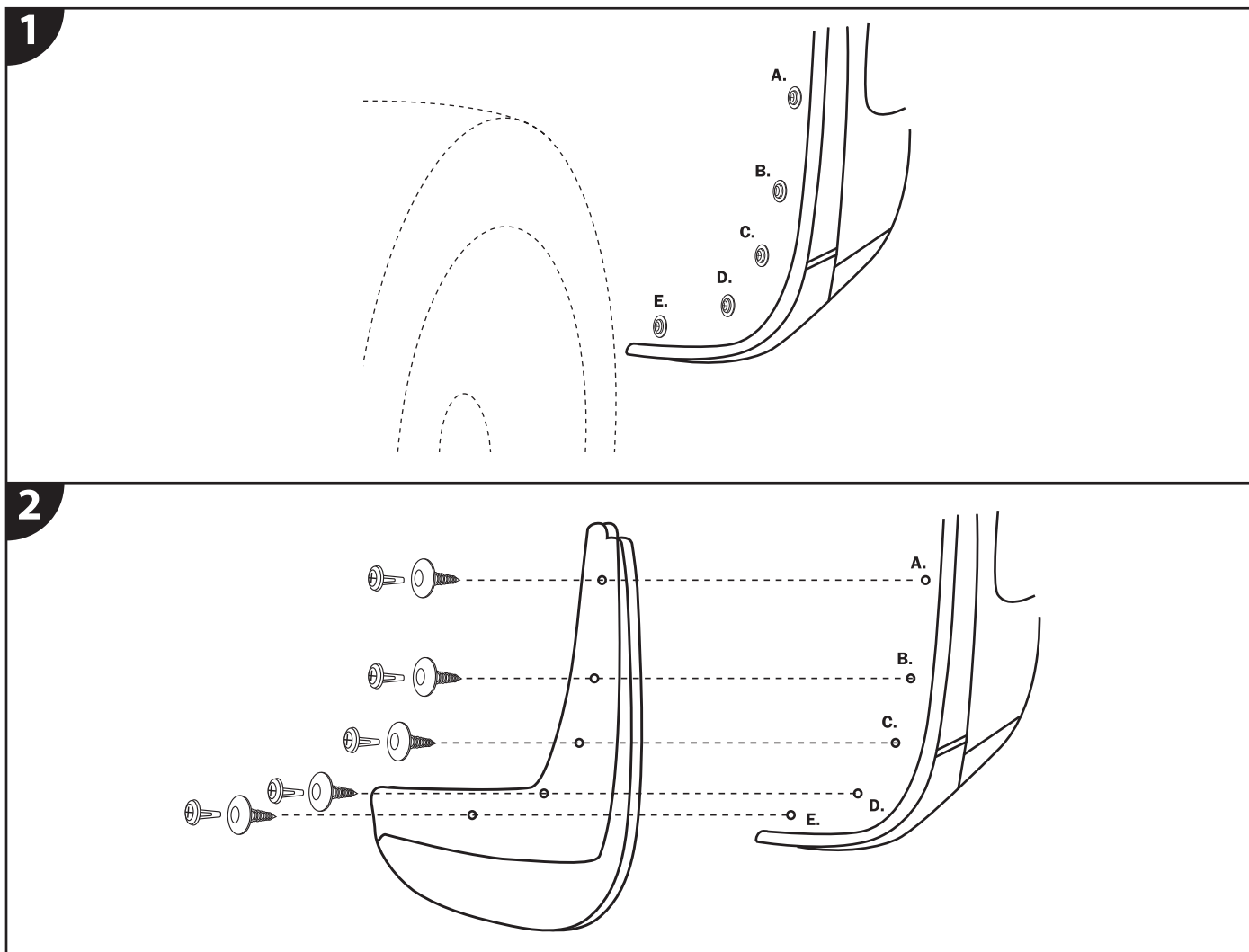

\*Repeat Steps 1-2 for Driver & Passenger Side\*

**STEP 1.** Remove existing fasteners.

- Remove existing fastener from locations A, B, C, D, and E. Save for next step.

**STEP 2.** Install mud guards.

- Attach mud guard using existing fastener at locations A, B, C, D, and E.

# INSTALLATION INSTRUCTIONS



No. 940447



## CUSTOM MOLDED REAR MUD GUARDS FOR FORD TAURUS

### Tools Needed

- Phillips head screwdriver
- Drill with 1/4" bit

### Included in Box

- Rear Mud Guards (for driver & passenger side)
- Screws (x2)
- U-Clips (x2)

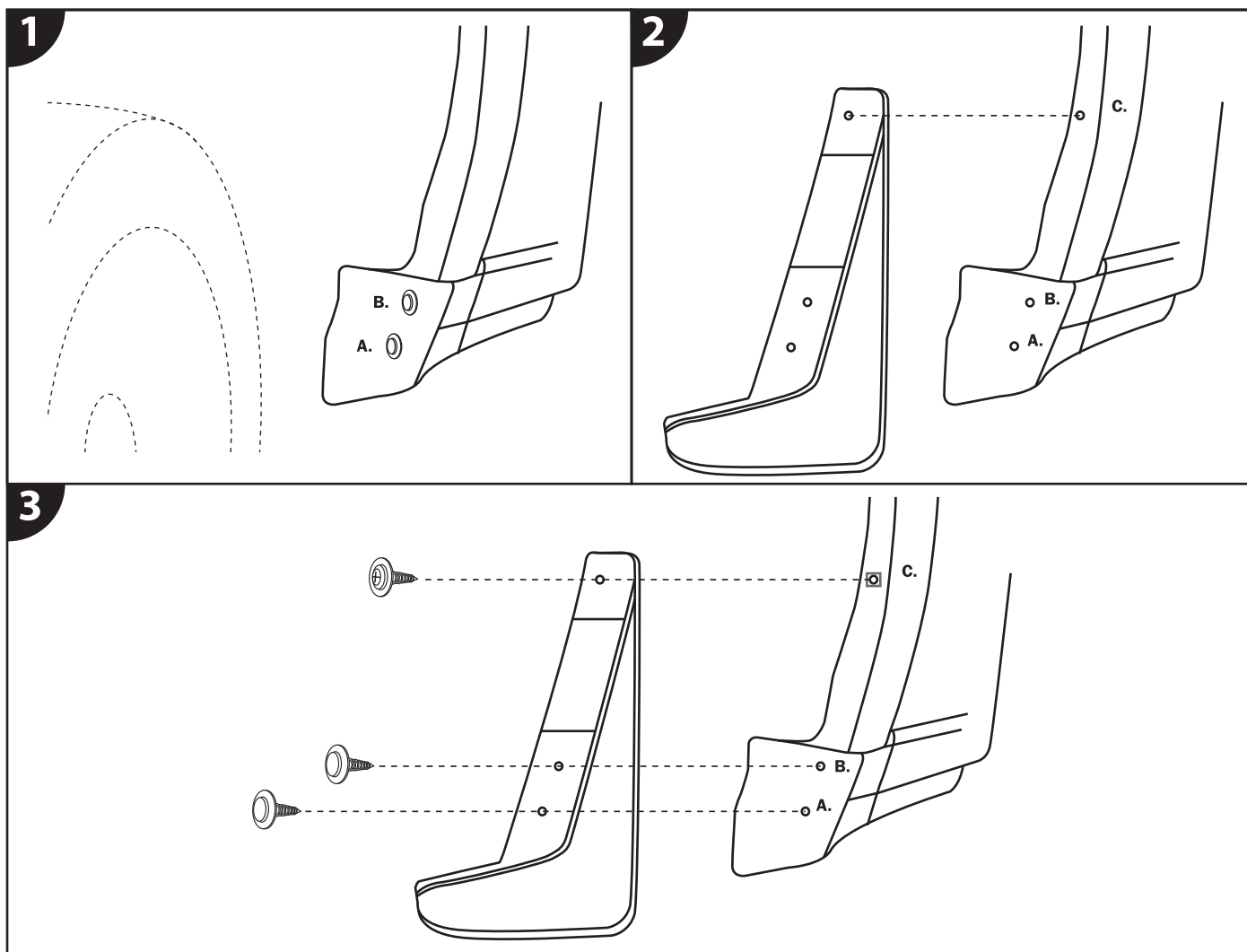

\*Repeat Steps 1-3 for Driver & Passenger Side\*

### STEP 1. Remove existing fasteners.

- a. Remove existing Fasteners from locations A and B. Save for later step.

### STEP 2. Drill new hole location.

- a. Using mud guard as a guide, mark and drill 1/4" hole at location C.

### STEP 3. Attach mud guards.

- a. Install U-Clip over the hole at location C.
- b. Attach mud guard using provided Screw at location C.
- c. Secure mud guard with existing fasteners, from Strep 1, at locations A and B.