

INSTALLATION INSTRUCTIONS



No. 940453



CUSTOM MOLDED REAR MUD GUARDS FOR TOYOTA CAROLLA

Tools Needed

- Phillips head screwdriver
- 8mm socket driver
- Drill with 1/4" bit

Included in Box

- Rear Mud Guards (for driver & passenger side)
- 15mm Screws (x6)
- 20mm Screws (x2)
- 19mm Hex Screws (x2)
- Small U-Clip (x6)
- Large U-Clip (x2)

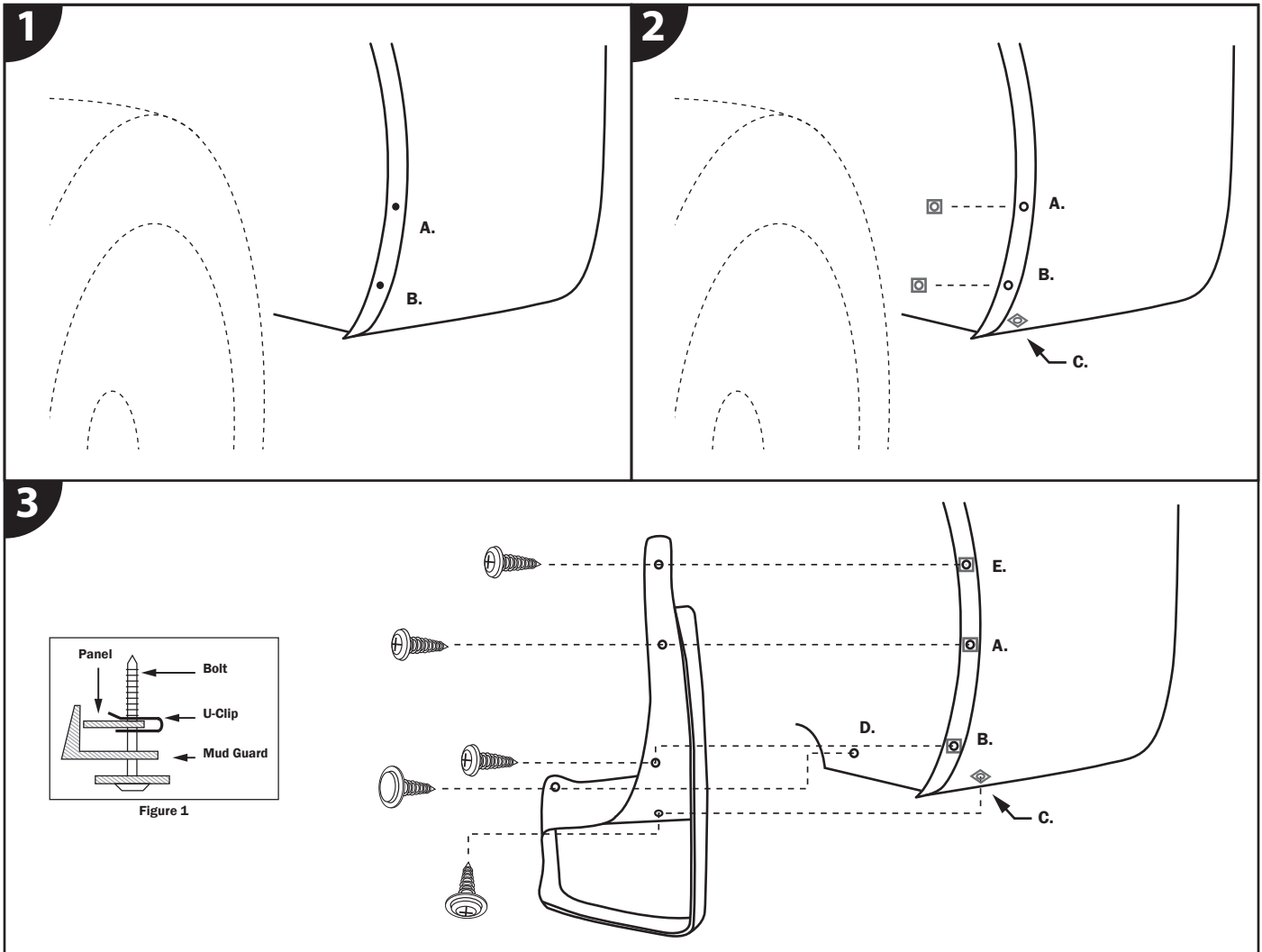

Repeat Steps 1-3 for Driver & Passenger Side

STEP 1. Pre-drill hole locations.

- Locate dimples in the panel and drill 1/4" hole through the plastic panel locations A and B.

STEP 2. Install U-Clips.

- Install Small U-Clips over the panel holes at locations A and B. (Figure 1)
- Install Large U-Clip over the existing panel hole at location C (underneath). (Figure 1) ***DO NOT REMOVE FACTORY FASTENER***

STEP 3. Install mud guard.

- Using provided 15mm Screws, attach mud guard at locations A and B.
- Install the 20mm Screw at location C (underneath).
- Install the 19mm Hex Screw at location D.
- Use mud guard as a guide, drill 1/4" hole through the plastic panel at location E.
- Place Small U-Clip over the new hole at location E (Figure 1) and Install 15mm Screw.