

INSTALLATION INSTRUCTIONS



No. 940420



CUSTOM MOLDED REAR MUD GUARDS FOR SUBARU FORESTER

Tools Needed

- Phillips head screwdriver
- Flat head screwdriver
- 20mm socket

Included in Box

- Rear Mud Guards (for driver & passenger side)
- 20mm Bolt and Washers (x4)
- U-Clip (x4)
- Small Rivets (x2)
- Long Rivets (x2)

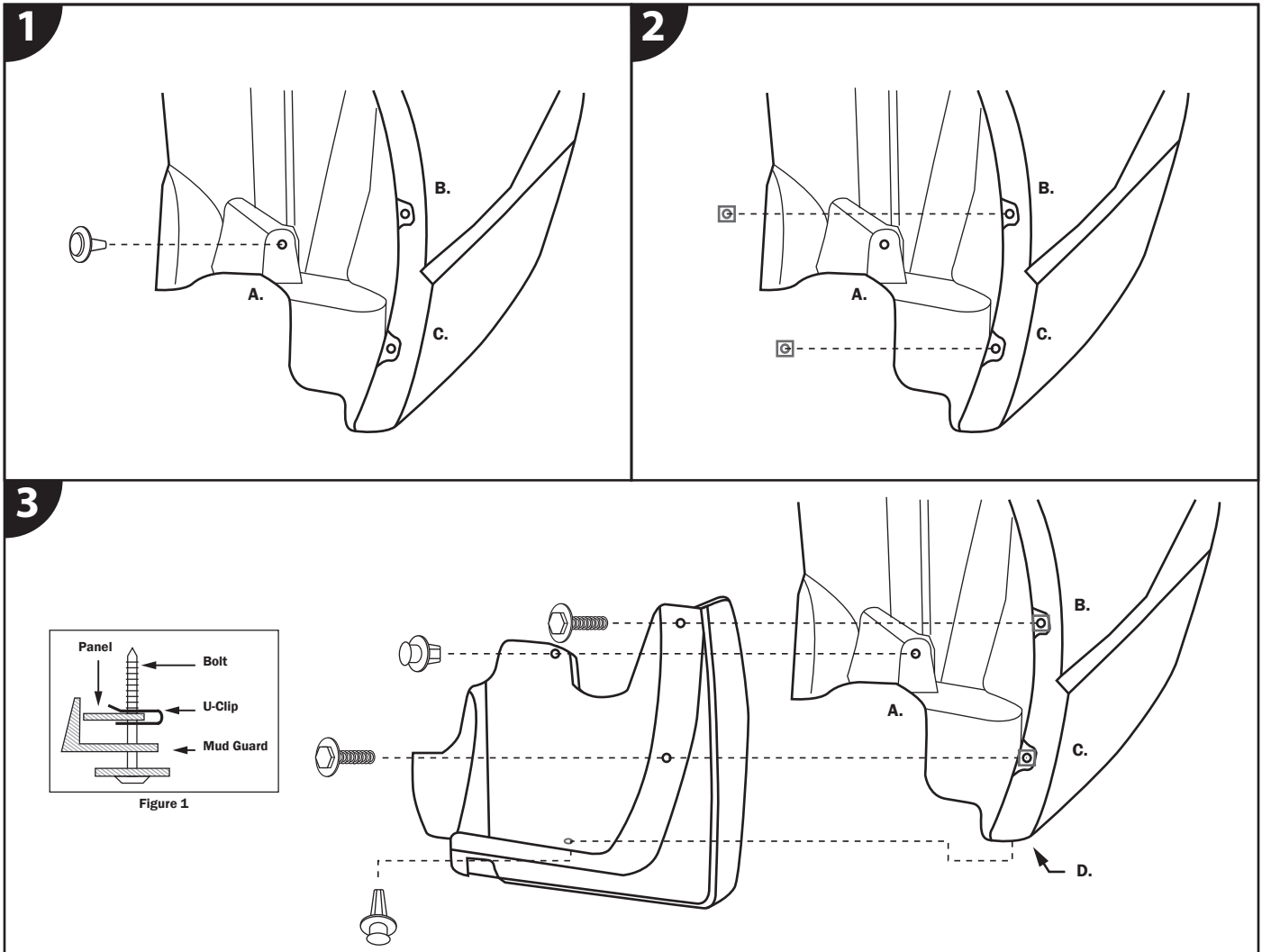

Repeat Steps 1-3 for Driver & Passenger Side

STEP 1. Remove existing fasteners.

- a. Remove and discard existing Fastener from location A.

STEP 2. Install U-Clips.

- a. Install U-Clips over the existing holes at locations B and C. (Figure 1)

STEP 3. Secure mud guards.

- a. Attach mud guard using 20mm Bolts and Washers at locations B and C.
- b. Install Small Rivet at location A.
- c. Install Long Rivet at location D (underneath).