

# INSTALLATION INSTRUCTIONS



No. 940310



## CUSTOM MOLDED REAR MUD GUARDS FOR TOYOTA CAMRY

### Tools Needed

- Drill with 1/4" bit
- Phillips head screwdriver
- 10mm Socket
- Driver/Ratchet

### Included in Box

- Rear Mud Guards (for driver & passenger side)
- M5 Spring Clips (x6)
- M5 x 15mm Screws (x6)

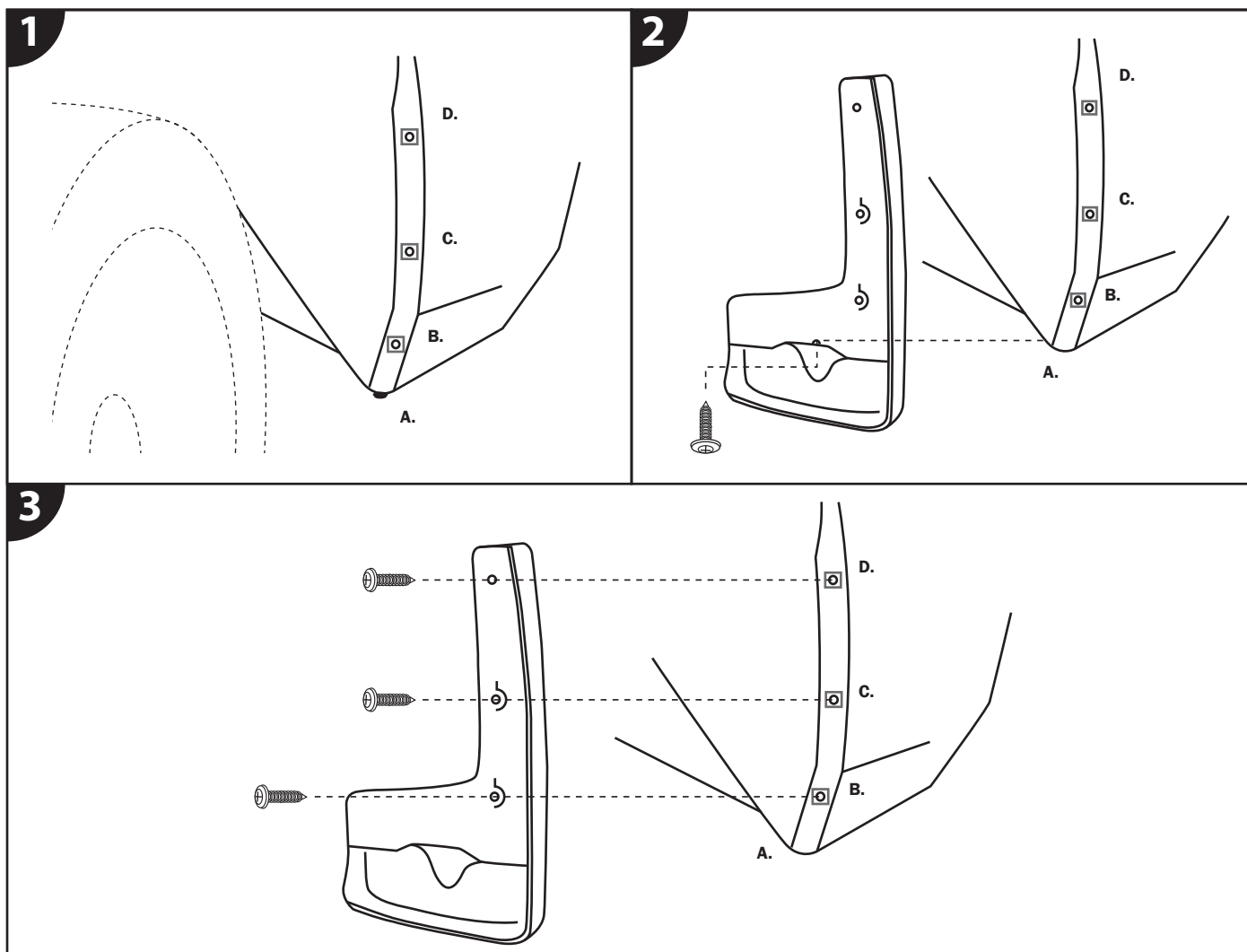

\*Repeat Steps 1-3 for Driver & Passenger Side\*

### STEP 1. Remove existing fasteners.

- Using the mud guard as a guide, mark area for holes at locations B, C, and D.
- Drill 1/4" holes at marked locations B, C, and D.
- Install M5 Spring Clips over panel edges at locations B, C, and D.
- Remove existing fastener at location A.

### STEP 2. Attach Mud Guard.

- Using existing fasteners removed in step 1, attach the mud guard at locations A.

### STEP 3. Fully Secure Mud Guard Fasteners.

- Install provided M5 Screws at locations B, C, and D.