

# **ROTOR RIOT**

The logo for Rotor Riot features the word "ROTOR" in a vertical, bold, sans-serif font on the left. To its right is the word "RIOT" in a large, bold, sans-serif font. The letter "O" in "RIOT" is replaced by a circular target symbol with a central bullseye. Inside the target is a stylized, black silhouette of a rioter's helmet with a visor and a small spike on top. The entire logo is rendered in black on a white background.

## SET UP GUIDE

Rotor Riot Controller for Android

# ENGLISH

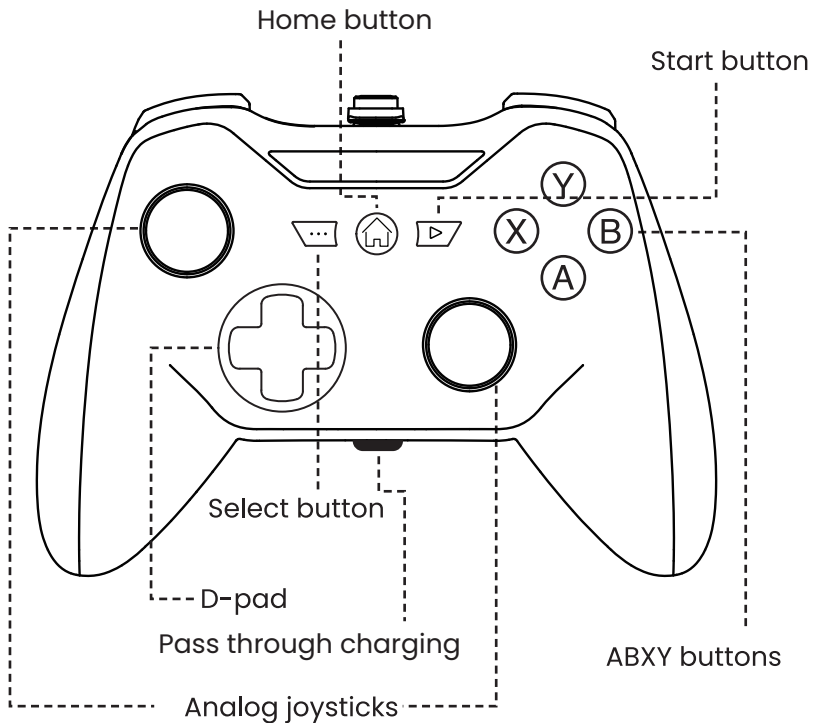

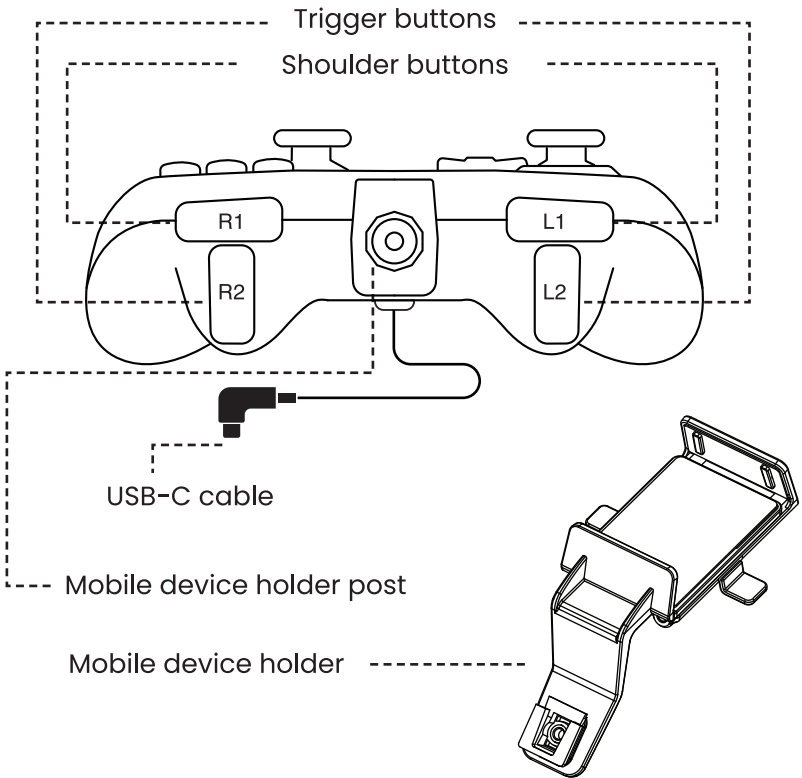

## **USB-C CONNECTION**

Ensure your phone is safe and secure in the provided mobile device holder, then connect your device using the built in USB-C connected cable. Alternatively you can connect the built in cable directly to a device without using the device holder. There are tabs on the mobile device holder for simple wire management.

## **DEVICE HOLDER POST**

Unscrew the the locking nut and remove. Place the mobile device holder so the rectangle opening is flush with the raised section. Replace nut and screw back on, be careful not to over tighten.

## **PASS THROUGH CHARGING**

While the controller is connected to your Android device, connect the power source via the USB-C receptacle on your controller to charge your phone or tablet while playing.

## **SUPPORT**

For customer support for your Rotor Riot controller please contact [support@RotorRiotPlay.com](mailto:support@RotorRiotPlay.com)

# LUDU MAPP

## **AFFILIATE APP**

Rotor Riot is the official controller of the Ludu Mapp app. There are hundreds of controller compatible games and uses available via the app. Additionally Ludu Mapp will share great offers, walkthroughs and tips for your favorite controller compatible games.

Download Ludu Mapp from The Google Play Store.