



DOLFINOS

# DOLFINOS System

Pure Edition N°

MADE IN SWITZERLAND



PLAY YOUR WAY  
WITH DOLFINOS

**IMPORTANT DISCLAIMER:**

DOLFINOS is not liable for damage to or from your DOLFINOS violin rest system or your instruments if you have not followed our instructions below.

Please consider following guidelines when using the product:

- careful use
- place in a dry environment and out of direct sunlight
- always use tools provided by DOLFINOS, replace them when worn out
- in case of doubt, please feel free to contact DOLFINOS

Dear \_\_\_\_\_

During the many years of this System's development, our aim was always to offer you a solution that enables you to PLAY YOUR WAY. We made this manual and the tutorial videos on our website for you to benefit most from your Pure Edition N°

Like a precise Swiss watch, a DOLFINOS still needs to be serviced from time to time in order to reach its whole lifespan. We wish that your DOLFINOS will become your long time companion.

In the name of the DOLFINOS team

Please share your thoughts with us via E-mail, Instagram or Facebook!

READY TO PLAY

# In just a few steps.

Reading this carefully allows you to benefit best from the Rest System as well as prolong the lifespan of your product.

## 1.

---

**Before you start using your DOLFINOS activate the built in lubrication in the hinge pin system by first turning both pin caps a few times and then pulling them slowly out while turning. Repeat this after longer periods of non-use.**

Loosen the screws of the adapter with the key **(a)** and pry the adapter open **(b)**. Please use only the supplied key.

### PLEASE NOTE

---

The access of the screws is designed in a user-friendly manner: The heads of the screws are aligned with the Os of the DOLFINOS brand marking. Be aware that the blade of the screwing tool is only held in the handle by a magnet.

Therefore:

1. All tools must be kept away from children and vulnerable people at all times.
2. If this piece falls out, it can damage the surface of your instrument.
3. Most airports accept this tool in the hand-luggage but DOLFINOS Ltd. cannot guarantee the accuracy of this information.

DOLFINOS declines any responsibility in connection with the use of a screwdriver that has not been provided by the company. This statement is valid for the entire user manual.

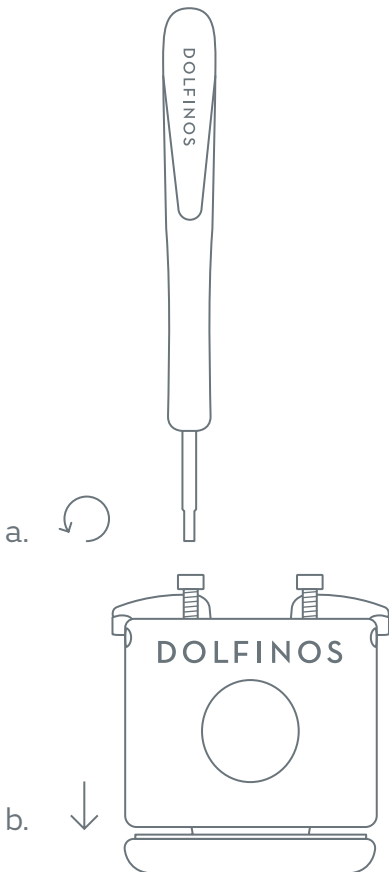

## 2.

---

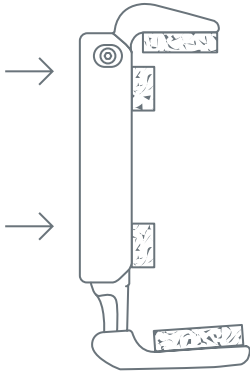

Place the open adapter onto your instrument following the drawing, making sure all four of the square corks touch the rib of the instrument or are aligned parallel to the rib and the end knob is centered.

## 3.

---

Once you have aligned the Adapter, push it together **(a)**. Use our key to close the adapter **(b)** by changing both screws alternatively after every full turn in order to keep the upper and the lower part of the adapter parallel. (You should avoid tightening one screw all the way followed by the other one.) Continue this until you feel it fits properly.

Please check the retaining force of the adapter regularly, especially after the first playing period. If the adapter moves while playing, it means you have to tighten the screws again.

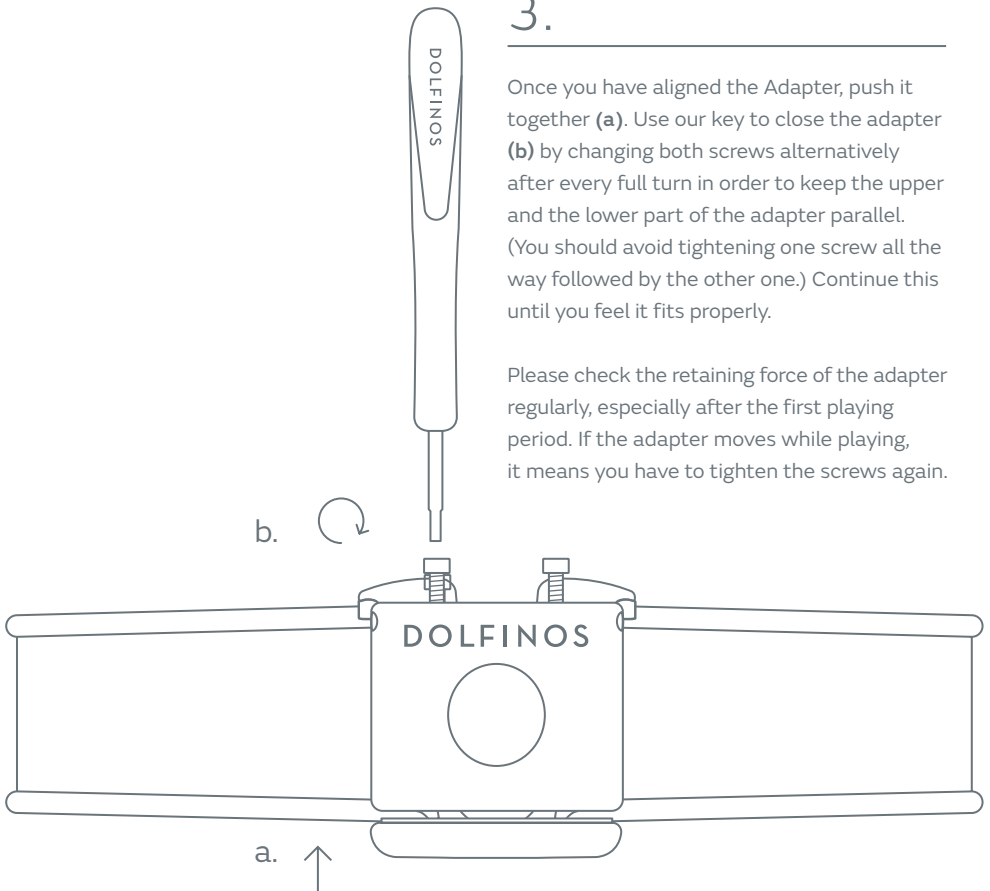

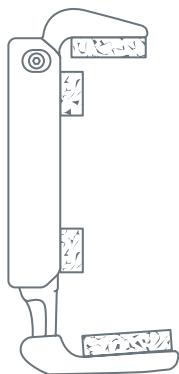

## PLEASE NOTE

---

Keep in mind that the cork is a natural material which reacts to pressure, friction, temperature and humidity. We therefore recommend to check regularly if the cork is still having its original full protective state.

In case you need to use sandpaper for adjusting the cork surface, make sure the dust does not fall in to the mechanical parts of the adapter. This may negatively influence or damage the functionality of your system.

## 4.

---

Now you can easily attach the chin rest in your adapter. Use the supplied key to tighten it. (Use the thin side of the blade.) Once you feel that the fixing screw is in contact with the titanium rod, a final half a turn is sufficient to keep the chin rest in place. The chin rest can be raised from the Adapter up to one cm. Keep in mind that with this system less force is required to control your instrument with your chin.

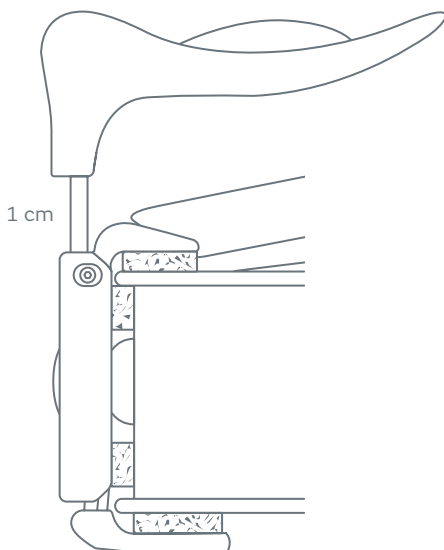

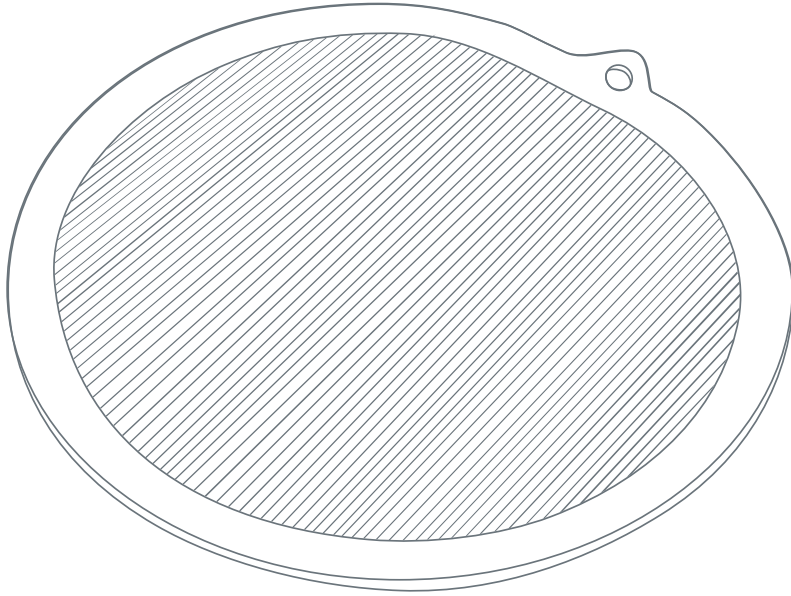

## 5. PLEASE NOTE

---

Preparing and cleaning the DOLFINOS Grip Pad

1. Remove foiles from the pad
2. Tear off the little black cones. (The proof that they come from fresh production.)
3. Wetten then DOLFINOS Grip Pad and rub the flat side of the DOLFINOS Grip Pad with a soft sponge and a mild soap.
4. Rinse the Grip Pad with clean water.
5. Repeat Step Nr. 3 and use some of the foam to wash also the other side of the Grip Pad (the micro lamella-side) without rubbing them.
6. Repeat Step Nr. 4
7. Rinse the Grip Pad, shake the water off and wipe it off with a clean micro fibre cloth.
8. Hang it on the hole of the Pad until it is completely dry. (You can use a pencil which you stick inside the hole, lay the pencil on the edge of a table and let the Pad hang in the air. To fix it in place put a heavy book on the pencil.)

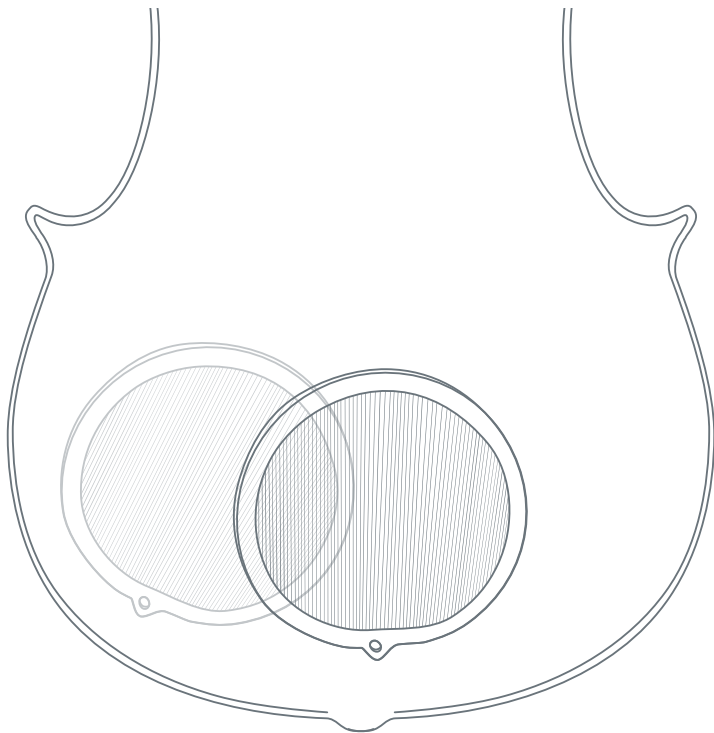

## 6. PLEASE NOTE

---

### Mounting of the DOLFINOS Grip Pad

1. Make sure the back of your instrument is dry and polished with a suitable cloth and varnish cleaner before mounting the Grip Pad.. (We recommend to use professional equipment, either from DOLFINOS or from another reliable brand.)
2. If your violin was recently varnished or you are in doubt about its condition please consult your luthier first.
3. Place the cleaned flat side of the Pad on the back of your instrument. The hole in the Pad normally looks towards the player.
4. Flatten the Pad and press it gently down to the back of your instrument.
5. To find the best playing position, the Grip Pad can be removed and replaced easily. Make sure the Lamellas act perpendicular to the direction where the instrument normally slips away during your performing.
6. Once the Grip Pad and the back of the instrument are smooth and free of dust, the **Van der Waals Force** will keep the Grip Pad in place without any residue or glue in between.



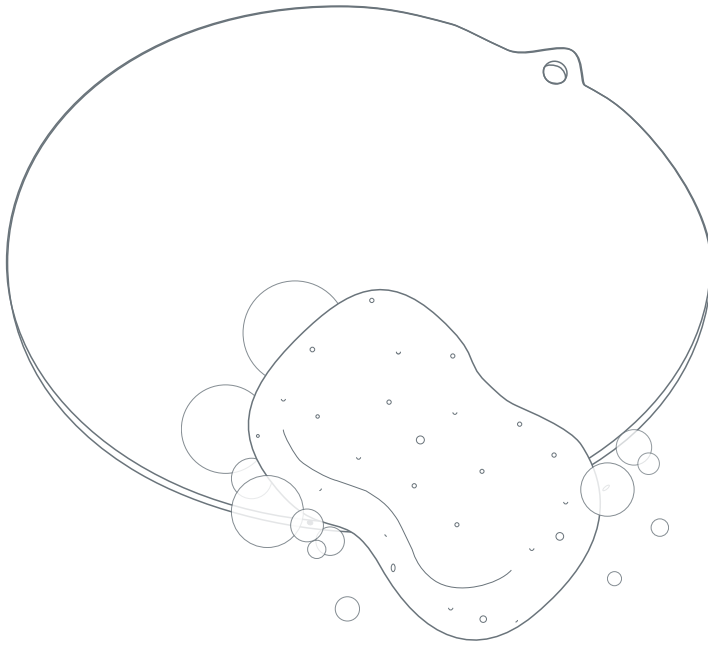

## 7. PLEASE NOTE

---

### Special remarks

1. In case the back of your instrument has a rather rough surface which may result in a less strong **Van der Waals Force**, you can order a special micro suction sheet to put in between the instrument and the Grip Pad.
2. The effect of the Grip Pad is not only a better hold whilst playing it is also protective to the normal abrasive impact of playing without a shoulderrest.
3. For replacing make sure to carefully and slowly remove the Grip Pad.
4. If you want to clean the Grip Pad Micro Lamella side from dust. You can either use a soft tooth brush or remove it, wash it as described and use the tooth brush and the soap foam to clean it perfectly.
5. Never forget to rinse it with clean plain water and dry it before reattaching it on your instrument. Brush always in line with the lamellas.

## CARE NOTE

---

Do not use alcohol or any aggressive liquid for cleaning.

If you want to remove the adapterbase cover:

The thickness of the adapterbase of the PURE Edition was already reduced in relation to the AIR Edition adapterbase.

To reduce the thickness of the adapterbase to appr. 1,7mm you are allowed to remove the base cover carefully with pliers without any loss of stability of the system.

(Only act from the edge of the smaller side of the cover which normally looks towards the player.) Further thickness reduction of the metal piece itself is possible but at your own risk and outside the warranty.

The adapter base cover can be reglued with superglue. Also a reorder of the adapter base



Would you like to  
get in touch with us:  
[sales@dolfinos.com](mailto:sales@dolfinos.com)  
+41 (0) 56 222 66 33

Visit us also on:

