



BOUJEE BEAUTY

2 Inch Infrared Ionic Hair Straightener Manual

## CUTTING EDGE TECHNOLOGY

Scientific research confirms that infrared heat, at the core of our flat iron, works its magic by gently heating your hair from the inside out. This process of even internal heating results in less heat damage compared to traditional methods. With quicker, more even heating, you can achieve those perfect looks without compromising your hair's health. Plus, the built-in infrared technology helps retain your hair's natural moisture, giving you shiny, frizz-free hair.

Built-in Ionic technology. Releasing active ions that surround your hair to give a shine boost with every pass, eliminating static and taming the dreaded frizz.



---

## PRODUCT INTRODUCTION

Congratulations on your purchase and thank you!

The infrared technology emits a soft infrared heat that penetrate in the hair without damage achieving the style you want with the maximum protection.

Negative ions close the cuticle layer to create a smooth, silky hair surface and seal in the hair's natural moisture. This provides ultimate shine, color and moisture protection for hair. Negative ions also eliminate static electricity on the hair surface so hair is left silky and frizz-free!

## SPECIFICATION

Heater Type : MCH

Variable Temp: 250-450°F

Plate Size: 2 inches

Dual Voltage for world travel:  
110-240V

## DISPOSAL

Whenever possible, recycle or discard the product according to your local recycling regulations. Check with your municipal recycling regulations for disposal of electronic devices.

## SAFETY

Keep away from water, moisture and wet surfaces. Never leave the hot tool unattended when turned on. When styling is complete always turn off and allow it to cool down before storing.



## GENERAL DESCRIPTIONS

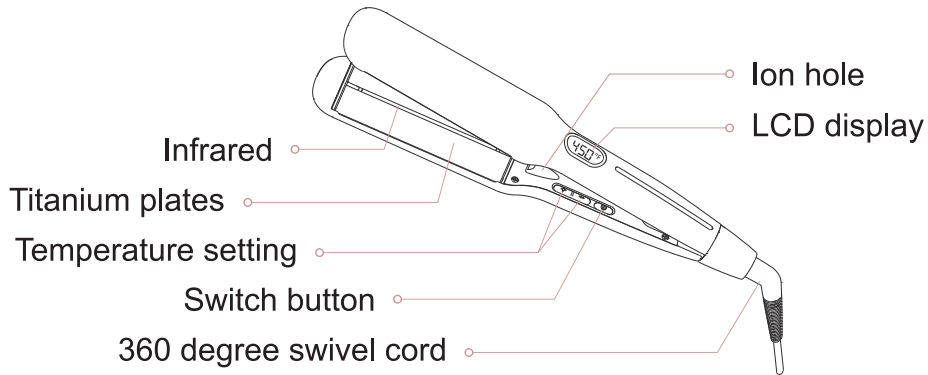



---

## WARNINGS

- Regularly check the power cord for any signs of damage, such as fraying, exposed wires or kinks. If the cord is damaged, discontinue use immediately.
- Unplug the product if not in use.
- Do not store the product on surfaces that are not heat resistant.
- Keep the product away from flammable materials.
- Do not allow the power cord to come into contact with the hot part of the tool.
- Keep away from children.



---

## NOTES

- The straightening plates will reach a high temperature quickly. Prevent the hot surface of the appliance from coming into contact with your skin directly.
- This product should not be used on wet hair.
- Do not use this product on synthetic hair.
- Unplug the product when not in use.
- Let the product cool down before storing.
- Auto shut-off will activate after one hour.

---

## HOW TO OPERATE

### BEFORE OPERATING

Wash hair and make sure your hair is dry. You will get the best results with clean, untangled hair. Do not attempt to straighten hair if it is wet.

### NOTE

- Do not keep the styler plugged into power when it is not in use.
- Please keep the styler on a heat-resistant surface when it is heating up.
- Please make sure you safely and correctly use the styler to avoid damage to your hair and remove plug after use.

### 1. Insert plug into socket

### 2. Turn power on

Styler will start to heat up. LCD will display temperature in real-time. When powered on, the default temperature is 350°F. For safety reasons, the straightener will automatically shut off after one hour.

### 3. Select a temperature setting that is suitable for your hair type.

- Use the + and - buttons to set the appropriate temperature setting.
- Always select a low setting when you use the straightener for the first time.
- For coarse, curly or hard to straighten hair, select a medium to high setting (350°F - 450°F).
- For fine, medium textured or softly waved hair, select a medium to low setting (250 -370°F).

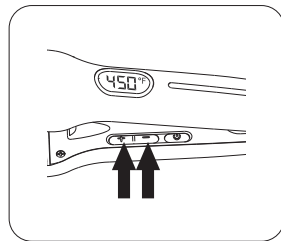
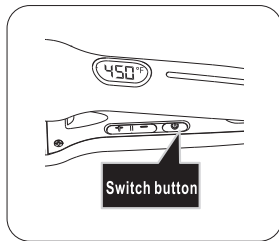
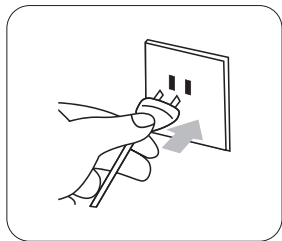

**4. Comb or brush your hair so it is untangled and use a heat protection spray.**

**5. Use a comb to divide the hair into sections.**

**6. Take a section of hair no wider than 2 inches. Place the hair between the styler plates and firmly press the handles until the plates touch.**

**7. Slide the straightener down the length of the hair, taking about 5-10 seconds from root to end, without stopping.**

TIP: If you want to create a curly style, rotate the styler starting a few inches from your scalp. For tight curls hold the iron vertically and move down your hair slowly. For looser curls move quickly, twisting away from your face.

**8. Repeat this process with each piece of hair until you have achieved your desired look.**

**9. After use, turn off the power and allow the curler to cool before storing.**



---

## CLEANING AND STORAGE

- Make sure the power is off and the product is unplugged.
- Put the product on a heat resistant surface to cool down.
- Clean with a slightly damp cloth after cooled.
- Never immerse the product in water.
- Do not use sharp or abrasive detergents.
- Do not wrap the power cord around the product.
- Store the product in a place that is dry and away from children.

## TROUBLESHOOTING

If the product is not working it may be the failure of the socket. Please check if the power supply has electricity by inserting another product into the outlet. Always check that the power cord is not damaged.

## WARRANTY

This warranty is for the original purchaser of the appliance and is non-transferable. The warranty is for 1 year from the date of purchase and does not include damage caused by misuse, accidents, or abuse. This warranty does not cover any shipping or handling charges. If the product is discontinued or no longer available a replacement may be made with a similar product of equal or greater value.

Please contact [warranty@boujee-beauty.com](mailto:warranty@boujee-beauty.com) for help.