

DUXOT

INSTRUCTION MANUAL

Vol. 1.27 EN



Tortuga CHRONOGRAPH WATCH

This watch is powered by a quartz Chronograph movement capable of split micro measurements of time.

With pin point accuracy you may use this watch to time separate periods of time elapsed even as you are able to read the current time simultaneously.

For more details on operating this timepiece please refer to the enclosed booklet or visit :

DUXOTWATCHES.COM

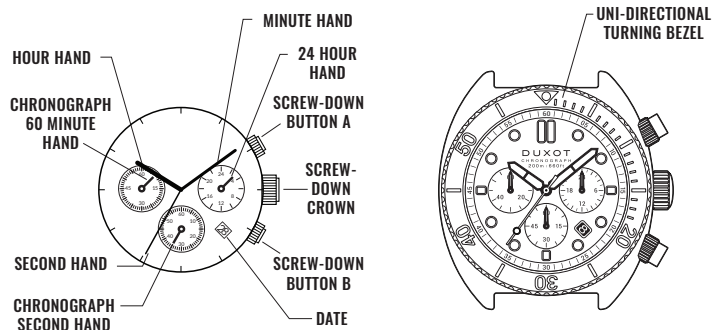

Remarks :

The measurement time indicated by the stopwatch hands move independently of the center hands.

PLEASE READ THE FOLLOWING BEFORE UNSCREWING THE CROWN:

SCREW-DOWN CROWN

Screw-down crowns are used to ensure water resistance. **ALWAYS** be certain that your crown is securely screwed down (Position **[0]** is secured. Positions **[1]**, **[2]** and **[3]** are not secured for water resistance).

Do **NOT** unscrew your crown while you are in any environment where moisture is present.

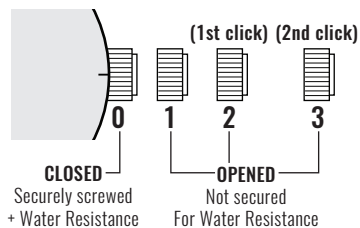

USING THE SCREW-DOWN CROWN

Do **NOT** PULL THE CROWN UNLESS IT IS **UNSCREWED** FIRST:

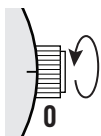

TO UNSCREW: Turn the crown anti-clockwise until it turns freely without tension. GENTLY pull the crown out to the other desired positions for watch setting (see specific operating instructions on the following pages).

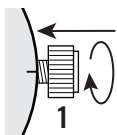

TO SCREW: Push the crown ALL THE WAY IN (towards the watch) THEN begin to turn clockwise until it is securely screwed down.

NOTE: Failure to SECURELY screw down the crown after setting the watch may affect its water resistance.

HOW TO SET THE TIME

1. Unscrew the crown and pull it out to position **[3]**-**(2nd click)**.
2. Turn the crown clockwise to set the correct time.
3. Push the crown in then screw it securely.

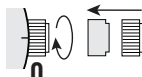
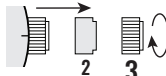

* Take a.m./p.m. into consideration when setting the hour and minute hands to the desired time.

* When the crown is at the position **[3]**, do not press any button, otherwise the chronograph hands will move.

HOW TO SET THE DATE AND TIME

*Before setting the time, check that the chronograph measurement is stopped.

1. Pull out the crown to the position **[2]**-**(1st click)**.
2. Turn the crown clockwise until the preview day's date appears.
3. Pull out the crown to the position **[3]**-**(2nd click)**, when the second hand is at the 12 o'clock position. It will stop on the spot. Set the hands to the desired time of the day (make sure AM/PM is set correctly) by turning the crown.

* When the crown is at the position **[3]**-**(2nd click)**, do not press any pusher. Otherwise the chronograph hands will move.

4. Push the crown back in the position **[1]** in accordance with a time signal.

* Do not set the date between 9:00 P.M. and 3:00 A.M. , otherwise the day may not change properly. If it is necessary to set the date during the time period, first change the time to any time outside it, set the date and then reset the correct time.

USING THE SCREW-DOWN PUSHERS

This watch is equipped with screw-down pushers. The pushers will not be able to be pressed until the pushers are unscrewed.

To **screw-down** the pusher – turn the washer around the pusher **clockwise** until you encounter resistance.



To **unscrew** the pusher – turn the washer around the pusher **anti-clockwise** until it is at its maximum height away from the case.

You will only be able to operate the functions of the chronograph when the pushers are unscrewed.

- The watch is only water resistant as marked to its specified depth if the pusher has been screwed down
- Pushers must never be unscrewed or be operated underwater.

5

6

STOPWATCH FUNCTION

- The measurement of time is indicated by the stopwatch hands that move independently of the center hands and 24-hour hand.
- The stopwatch can measure up to 60 minutes.

STANDARD MEASUREMENT

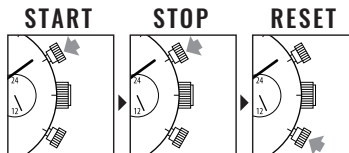

7

ACCUMULATED ELAPSED TIME MEASUREMENT

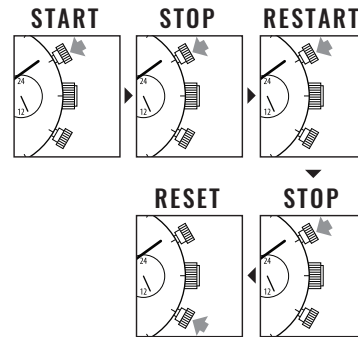

Restart and stop of the stopwatch can be repeated by pressing the button **A**.

8

SPLIT TIME MEASUREMENT

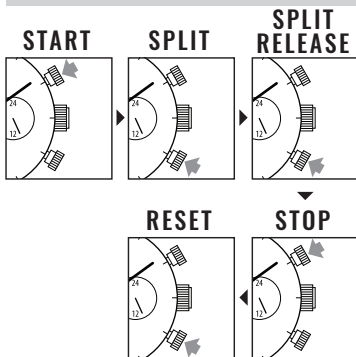

Measurement and release of split time can be repeated as many times as necessary by pressing the button **B**.

9

WATER RESISTANCE

Note that the water resistance chart serves only as a guide (please refer to the water resistance chart on the next page). Actual water resistance may vary depending on a number of factors including water temperature, water salinity, and use under water.

The water resistance of your timepiece may eventually be compromised over time with general wear and tear and use of your timepiece under adverse conditions.

Always remember to employ the screw down crown if available to maintain the water resistance of your timepiece. Warranty may be voided if the screw down crown has not been properly employed.

Note that you should **never** wear your watch in a jacuzzi or steam room where steam may enter the case despite the water tight seals used to protect your watch. This may cause condensation inside your watch which may effect and damage the inner workings of your watch.

WATER RESISTANCE CHART

WATER RESISTANCE CHART	30M/ 3ATM	50M/ 5ATM	100M/ 10ATM	150M/ 15ATM	200M/ 20ATM
SPLASH/ SHOWERING	☑	☑	☑	☑	☑
SWIMMING/ BATHING	☒	☑	☑	☑	☑
BRIEF SWIMMING/ WATER SPORTS	☒	☒	☑	☑	☑
PROLONGED SWIMMING/ FREE DIVING	☒	☒	☒	☑	☑
SCUBA DIVING	☒	☒	☒	☒	☒
PROFESSIONAL DEEP SEA DIVING	☒	☒	☒	☒	☒