

尺寸：55mm*55mm

折页

128g铜版纸

RAVPOWER

MODEL:RP-SHO27
MAGNETIC CAR PHONE MOUNT
User Guide

IMPORTANT



**No Touching
For One-time Use Only**

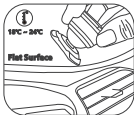

**Before mounting, regulate
the ambient temperature to
18°C - 24°C / 64.4°F - 75.2°F.**



**Press with 3kg / 6.6lbs
force for 30 seconds**



**Use after 24 hours
of installation**

! Important

1. This car phone mount uses high-performance **3M VHB™** adhesive. For the best results, **DO NOT TOUCH** the adhesive surface after the protective paper is removed.
2. Before mounting, regulate the ambient temperature to 18°C - 24°C / 64.4°F - 75.2°F.
3. To achieve the most stable mount, use the product after 24 hours of installation.
4. Please install the mount on flat surface.
5. To remove the metal plate, please warm it with a hair dryer, then use some dental floss to lift and detach it.

RAVPOWER
www.ravpower.com

NORTH AMERICA

E-mail: support@ravpower.com(US)
support.ca@ravpower.com(CA)
Tel: 1-888-456-8468 (Monday-Friday: 9:00 - 17:00 PST)
US Distributor: SUNVALLEYTEK INTERNATIONAL INC.
Address: 46724 Lakeview Blvd, Fremont, CA 94538

MANUFACTURER

Manufacturer: Shenzhen NearbyExpress Technology Development Co.,Ltd.
Address: 333 Bulong Road, Shenzhen, China, 518129

Learn more about the EU Declaration of Conformity:
<https://www.ravpower.com/downloads-RP-SHO27-CE-Cert.html>



20191009
RP-SHO27_V1.1 EN



Car Phone Mount*1



Spare Base Adhesive*2



Alcohol Prep Pad*2



Metal Sheet *2

Install the Metal Sheet



1. Wipe the back of your phone case with the included alcohol prep pad. Let dry.
2. Place the metal sheet between the phone and the case, or remove its protective paper and stick it onto phone case.

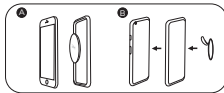

Caution

1. Don't stick the metal sheet on the back of phone with wireless charging functionality.
2. It is recommended to stick the metal sheet on your phone case. Remove the phone case before wireless charging.
3. To remove the metal plate, please warm it with a hair dryer, then use some dental floss to lift and detach it.

Install the Mount onto Your Car

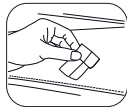

1. Wipe the target spot with the included alcohol prep pad and wait until it is fully dry.



3. Press the base with 3kg force onto the car dashboard and hold still for 30 seconds.



2. Remove the protective paper from the base adhesive or replace it with the spare one when needed.



4. Place your phone on the phone disc, adjust it for the best angle.

Caution

1. In cold weather, install the mount in a well-warmed car only.
2. Do not mount the product on the airbag.

Magnet Warning

This product contains strong magnet, which will not damage phones or tablets with solid state hard drivers. But we strongly recommend you to keep it away from credit cards, pacemakers, or hard drives.

Disclaimer

We do not recommend using this phone mount with older vehicles. The dashboard of older vehicles may have become brittle due to sun damage. We are not responsible for dashboard repair if any damage occurs.