

# RAVPower

E-TOUCH SERIES  
WIRELESS CHARGER CAR MOUNT  
**User Guide**

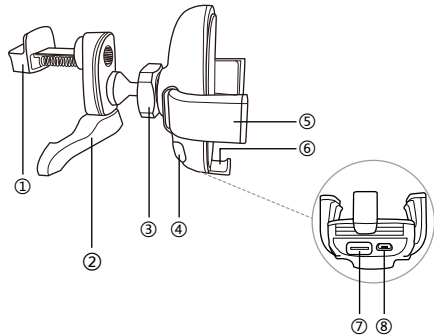

### Product Diagram

- |                                 |                    |
|---------------------------------|--------------------|
| 1. Spring Loaded Lever Hook     | 5. Cradles         |
| 2. Support Foot                 | 6. Tray            |
| 3. Ball Joint & Stabilizing Nut | 7. USB A Output    |
| 4. Sensor                       | 8. Micro USB Input |

### Mounting & Using the Phone Holder

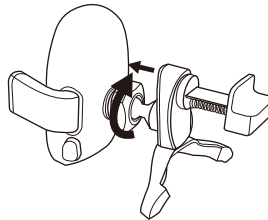

Click the ball into the connecting joint, screw the stabilizing nut to lock in place.

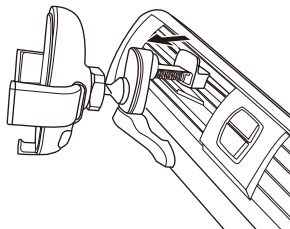

RP-SH016

**RAVPower**

[www.ravpower.com](http://www.ravpower.com)

### NORTH AMERICA

E-mail : [support@ravpower.com](mailto:support@ravpower.com)(US)

[support.ca@ravpower.com](mailto:support.ca@ravpower.com)(CA)

Tel : 1-888-456-8468 (Monday-Friday: 9:00-17:00 PST)

Address : 46724 Lakeview Blvd, Fremont, CA 94538

### EUROPE

E-mail:

[support.uk@ravpower.com](mailto:support.uk@ravpower.com)(UK)

[support.de@ravpower.com](mailto:support.de@ravpower.com)(DE)

[support.fr@ravpower.com](mailto:support.fr@ravpower.com)(FR)

[support.es@ravpower.com](mailto:support.es@ravpower.com)(ES)

[support.it@ravpower.com](mailto:support.it@ravpower.com)(IT)

EU Importer : ZBT International Trading GmbH

Address: Halstenbeker Weg 98C, 25462 Rellingen, Deutschland

### ASIA PACIFIC

E-mail : [support.jp@ravpower.com](mailto:support.jp@ravpower.com)(JP)

JP Importer: 株式会社SUNVALLEY JAPAN

Tel : 03-5542-0907 (10~17時/土日祝日を除く)

Address: 〒104-0032東京都中央区八丁堀3丁目18-6 PMO京橋東9F

### MANUFACTURER

Manufacturer: Shenzhen NearbyExpress Technology

Development Co., Ltd.

Address: 333 Bulong Road, Shenzhen, China, 518129



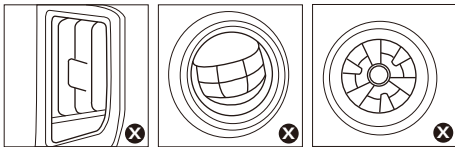

Push back the spring lever, clamp the hook onto your air vent blade, and release the spring to lock in place.

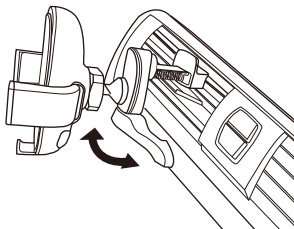

Revolve and adjust the support foot to stabilize the holder.

## Mounting and Removing Your Device

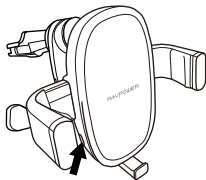

Touch the sensor to unlock the cradle and remove your device.

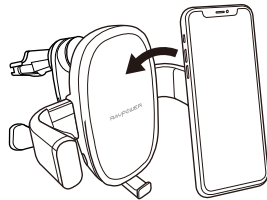

Place your phone onto the holder, the cradle will tighten and lock up automatically.

## Charging

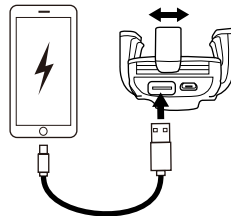

1. Charging Your Devices (The charging cable is not included)

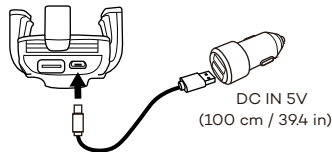

2. Charging the Mount (Micro USB Cable)

Note: Adjust the tray accordingly to avoid blocking of the charging port.

## Caution

1. Please charge the mount first when use it for the first time or reuse it after a long time.
2. For your safety, do not install or adjust the mount while driving.
3. Do not expose the product to long periods of sunshine, especially during high temperatures.
4. Please remove the mount and store it in a cool and shady area when not in use.
5. The cradles will close and open automatically when the sensors are touched. Don't pull with your hands.
6. Charge the mount with a DC 5V charger, the adapter (car charger) is not included in the package.
7. Do not knock, drop, or dismantle the product.
8. A beep sound will be heard when battery runs low, please charge the mount.

尺寸：70\*90mm

折页

材质：128克铜版纸