

# Vanguard Collapsible Cart for Holding C-stands (CT-VNGD-CS)

## Assembly Manual



### What's In The Box

Please inspect the contents of your shipped package to ensure you have received everything that is listed below.



1 x Base Part of Cart



1 x Top Part of Cart



4 x Bolts



2 x Side Extension



2 x Pneumatic wheels



1 x Spanner (13)  
1 x Allen key (6mm)

All rights reserved.

No part of this document may be reproduced, stored in a retrieval system, or transmitted by any form or by any means, electronic, mechanical, photo-copying, recording, or otherwise, except as may be expressly permitted by the applicable copyright statutes or in writing by the Publisher.

## Vanguard Cart Setup

- To attach the pneumatic wheels, remove the side bolt of the wheel shank on the base part with the help of an Allen key.



- Insert the wheel into the wheel shank and secure by inserting a bolt.



- Then tighten it properly with the help of an Allen key. Follow the same process to attach the other wheel as well.
- NOTE:** The C-stand cart rolls incredibly smooth and silent with reliable and lightweight two front Pneumatic wheels and two rear swivel caster wheels with brakes.



- Attaching the side extension to the base part, insert the bolt and secure with the help of a nut.

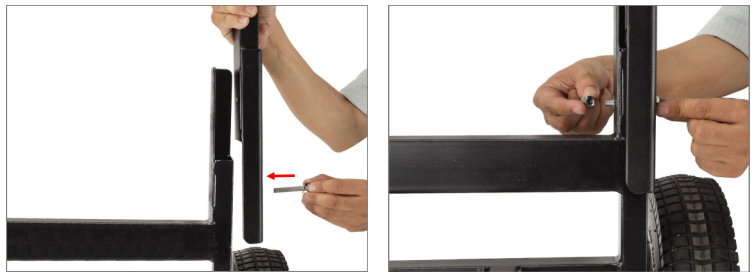

- Tighten the bolt properly from both the sides with the help of the spanner.



- Follow the same process on the other side- extension.



- Attach the top part matching both the side extensions.



- Then insert the nut & bolt and properly secure with the help of the spanner.



- Finally, the top part has been properly attached to the cart.

**NOTE:** It has two D-shaped sturdy handles on the top of the cart for a solid and comfortable hold.



## YOUR PROAIM VANGUARD CART FOR HOLDING C-STANDS ALL DRESSED UP AND READY TO GO!

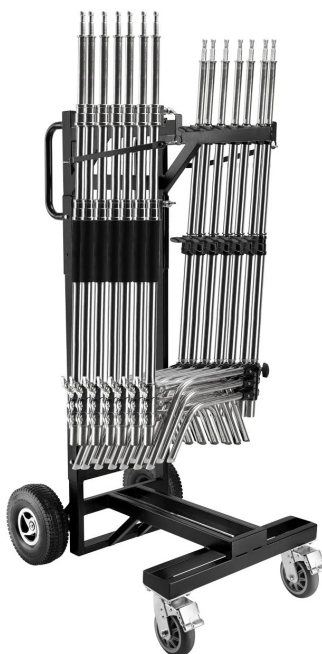

(SHOWN WITH OPTIONAL ACCESSORIES)

**Warranty:** We offer one year warranty for our products from date of purchase. Within this period of time, we will repair it without charge for labor or parts. Warranty doesn't cover transportation costs nor does it cover a product subjected to misuse or accidental damage. Warranty repairs are subjected to inspection and evaluation by us.

**Liability:** We are not liable for damage caused by products that we do not supply or from mishandling in transit, accident, misuse, neglect, lack of care of the product, or service by anyone other than our company.

**Contact Us:** In case of any kind of dissatisfaction, please Contact us immediately and we promise our utmost support and care until you use our product.