

Assembly Manual

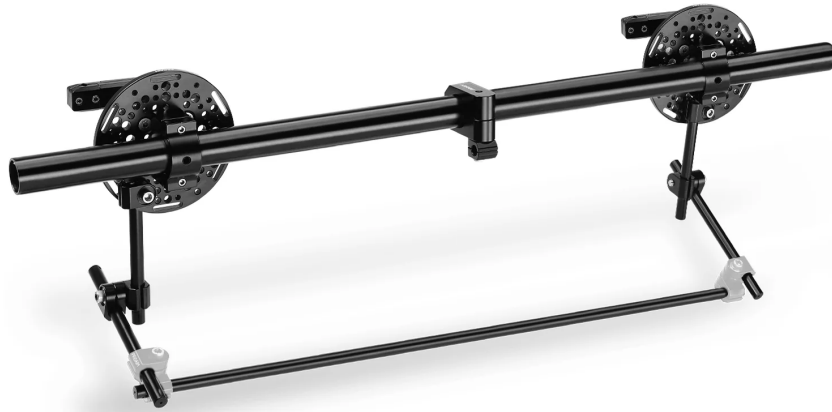

What's In The Box

Please inspect the contents of your shipped package to ensure you have received everything that is listed below.



All rights reserved.

No part of this document may be reproduced, stored in a retrieval system, or transmitted by any form or by any means, electronic, mechanical, photo-copying, recording, or otherwise, except as may be expressly permitted by the applicable copyright statutes or in writing by the Publisher.

Universal Backseat Setup

- Attach the Universal headrest mount on the back seat of the vehicle, as shown in the image.

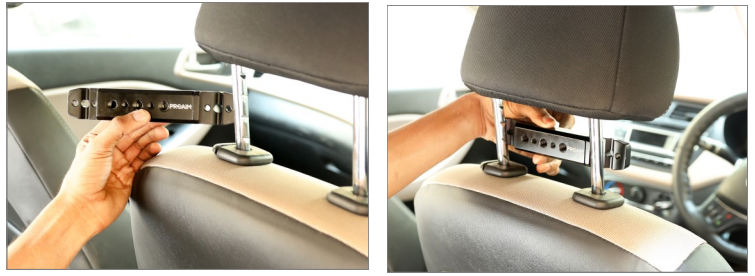

- After attaching the headrest, insert a bolt to secure it properly.

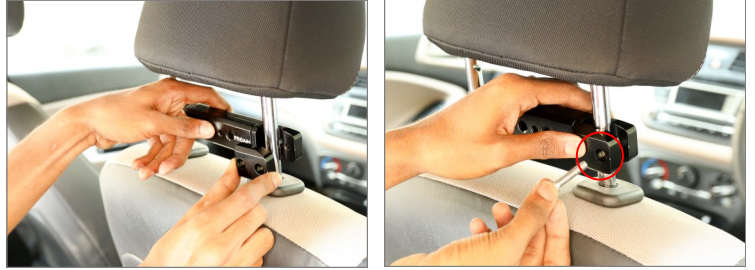

- After inserting the bolt, properly secure the headrest on the backseat with the help of the Allen key, and same step is to be followed on the other side as well, as shown in the image.

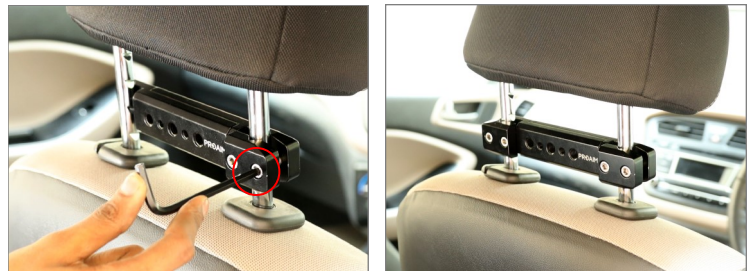

- Insert two Standoff pins into the Universal headrest mount by matching them with the threads of the Universal headrest, as shown in the image.



- Attach the round cheese plate properly by matching it with the threads of two standoff pins, and then insert the Allen bolt.



- Tighten the Allen Bolt with help of the Allen key.

Note: Easily connect the headrest mount with cheese plate which has multiple threads & holes for quick & easy mounting.



- Attach the Houdini speed rail clamp on the round cheese plate and insert the bolt into it.

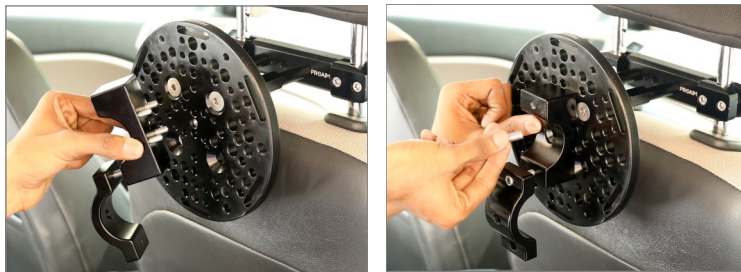

- After inserting the bolt, secure it properly with the help of the Allen key and then insert the rigging rod (4ft Length) into it.

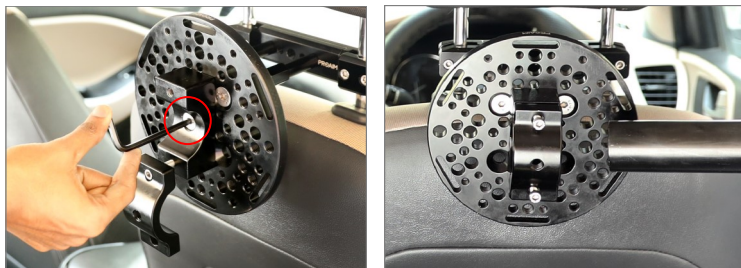

- Insert the Rigging rod (4ft Length) in both the Houdini speed rail clamps and secure it by properly tightening the bolt, as shown in the image.



- After inserting the rod, tighten the bolt with the help of the Allen key. Then attach the 360° Houdini speed rail rod clamp at the center of the 4ft length rod.



- Then secure the bolt properly with the help of the Allen Key and then insert the baby pin to mount the monitor.

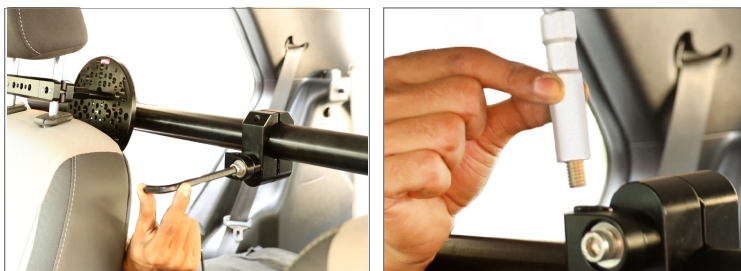

- After inserting the baby pin, secure it properly with the help of the Allen key, as shown in the image.



- Mount the monitor on the baby pin and secure it properly by tightening it with the help of the knob.



- Attach the rigging road clamp to the round cheese plate by matching it with the threads, then secure it properly with the help of Allen Key.



- To secure the rigging road clamp, insert the rigging rod 180mm in it and secure it with the help of Allen key.



- Then insert 360° Houdini Rod Clamp into the Rigging Rod (180mm) and secure it properly with the help of the Allen key, and then insert rigging rod (250mm) into it.



- After inserting the rigging rod (250mm), tighten it with the help of Allen Key. Then insert the 360° Houdini rod clamp into it, as shown in the image.



- After inserting the 360° Houdini Rod Clamp, insert black anodized speed rail (3ft length) and secure it properly with the help of the Allen key.

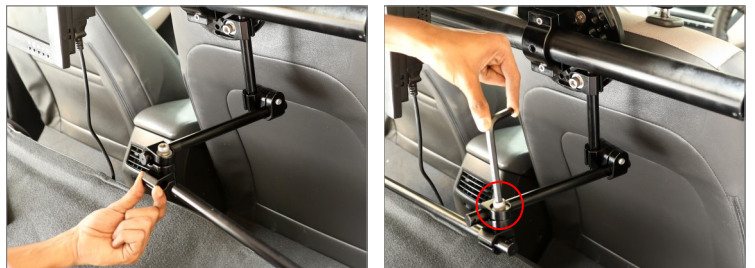

- Black anodized speed rail (3ft length) with 360° houdini rod clamp are properly secured, as shown in the image.

NOTE: To achieve the shown setup, you'll need two additional 360° Houdini rod clamps that can be purchased from our website.

Note: It is entirely modular & adjustable. You just need to set your control device, monitor, LCD, wheels, and joysticks behind the front seat in any desired position and focus only on your creative cinematic shots.

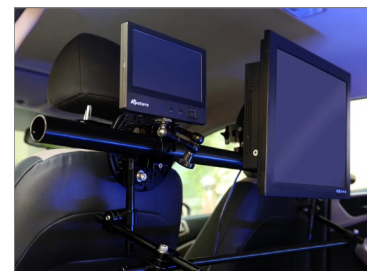

YOUR PROAIM UNIVERSAL BACKSEAT MONITOR CONTROL SYSTEM ALL DRESSED UP AND READY TO GO!



(SHOWN WITH OPTIONAL ACCESSORIES)

Warranty: We offer one year warranty for our products from date of purchase. Within this period of time, we will repair it without charge for labor or parts. Warranty doesn't cover transportation costs nor does it cover a product subjected to misuse or accidental damage. Warranty repairs are subjected to inspection and evaluation by us.

Liability: We are not liable for damage caused by products that we do not supply or from mishandling in transit, accident, misuse, neglect, lack of care of the product, or service by anyone other than our company.

Contact Us: In case of any kind of dissatisfaction, please Contact us immediately and we promise our utmost support and care until you use our product.