

Soundchief OG Professional Sound Cart (CT-SDCF-OG)

Assembly Manual



What's In The Box

Please inspect the contents of your shipped package to ensure you have received everything that is listed below.



Bottom Tray
(With Wheels)



Middle Tray



Top Tray



2 x Baby Pin Rods



2 x Rods



2 x Rack Mounts



2 x Wheels

All rights reserved.

No part of this document may be reproduced, stored in a retrieval system, or transmitted by any form or by any means, electronic, mechanical, photo-copying, recording, or otherwise, except as may be expressly permitted by the applicable copyright statutes or in writing by the Publisher.



2 x Handles



2 x Sanks

2 x Spanners
(Sizes: 13mm & 19mm)

Sound chief Cart Setup

Assembling of Rods

- Loosen the bolt with the help of an Allen key and then insert the baby pin rod.



- Tighten the bolt using the allen key and repeat the same process for the second rod.



- Loosen the bolt of the brake wheel and insert the rod.



- Tighten the bolts properly using the allen key. Repeat the same process for the second rod.



- Push the break wheel downward and lock it properly.



NOTE: The front wheels come with specially designed foot brakes to keep it completely steady, stable, and secure for reliable parking, even when you can not be close to the Cart.



Assembling of Wheels

- Loosen the bolts of the shank and insert it into baby pin rod.



- Properly tighten the bolts again, as shown in the image.

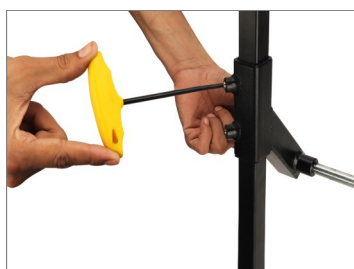

- Properly insert a wheel inside the shank, as shown in the image.

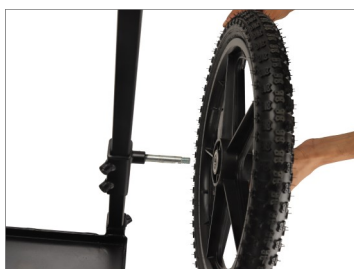

- Insert washer and bush & properly tighten them with the help of 19mm spanner (**Not Included**)



- Repeat the same process for the second wheel.

NOTE: These wheels ensure that the entire setup remains light, smooth, and robust.



Assembling of Middle Tray

NOTE: It is a fully collapsible cart for Audio/Sound Recordists, Production Sound Mixers, and other professionals.

- Loosen the bolt with the allen key and insert the Rack Mount rod.

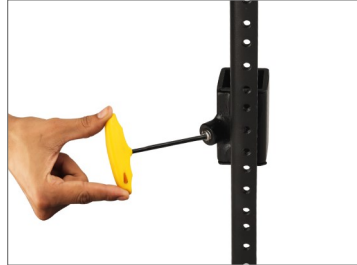

- Tighten the bolt using the allen key. Repeat the same process for the second rod.

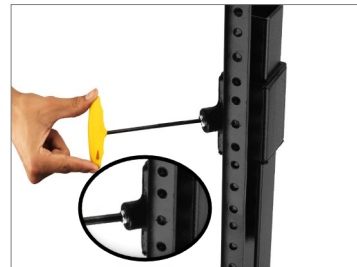

- Now insert the middle tray, as shown in the image.



NOTE: You can easily adjust the middle shelf to your desired height, making the cart even more convenient for you.



- After inserting the rack mounts, match the bolt threads and tighten them properly with the allen key.



Assembling of Top Tray

- Insert the top tray and tighten the bolts using the allen key.

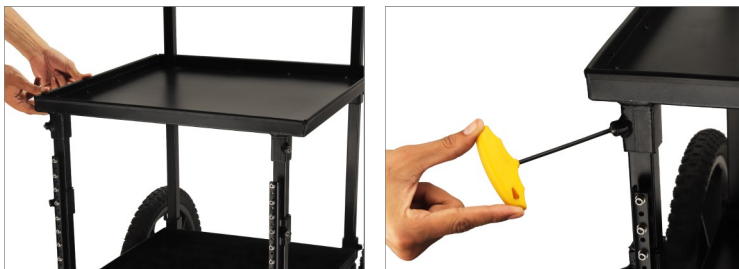

NOTE: The cart is connected to Bottom, Middle, and Top tray and has a sturdy rubber coating on its edges to avoid scratches and damage to your sound equipment.



Assembling of Handles

- Loosen the bolt of the handle using the allen key and mount it on the baby pin rod.

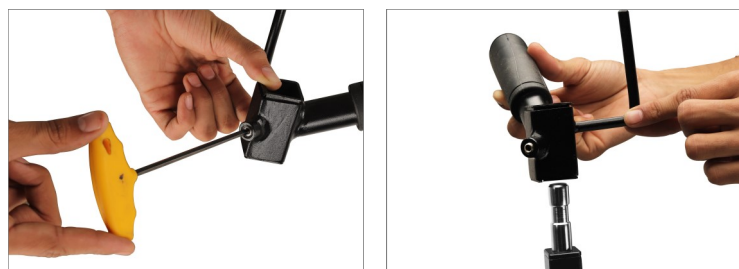

- Properly tighten the bolt with the allen key, as shown in the image.

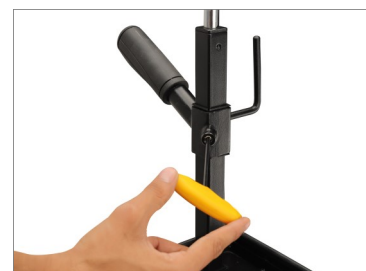

- Now insert the bolt and properly tighten it with the help of the allen key.



- Repeat the same process for the second handle.

NOTE: There are cable hooks near the handles. you can mount your cables & other accessories on it.



Height Adjustable of Middle Shelf



YOUR PROAIM SOUNDCHIEF OG PROFESSIONAL SOUND CART ALL DRESSED UP AND READY TO GO!



(SHOWN WITH OPTIONAL ACCESSORIES)

Warranty: We offer one year warranty for our products from date of purchase. Within this period of time, we will repair it without charge for labor or parts. Warranty doesn't cover transportation costs nor does it cover a product subjected to misuse or accidental damage. Warranty repairs are subjected to inspection and evaluation by us.

Liability: We are not liable for damage caused by products that we do not supply or from mishandling in transit, accident, misuse, neglect, lack of care of the product, or service by anyone other than our company.

Contact Us: In case of any kind of dissatisfaction, please Contact us immediately and we promise our utmost support and care until you use our product.