

Soundchief Channel Cart (CT-SDCF-CV4)

Assembly Manual



What's In The Box

Please inspect the contents of your shipped package to ensure you have received everything that is listed below.

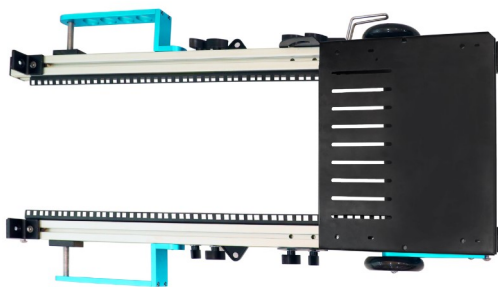

Proaim Soundchief CV4 Cart with
1 x Height Adjustable Shelf and
1 x Headphone Holder



2 x 16" Wheels



1 x Sliding Shelf



Bottom self



1 x Boom Pole Holder Kit



1 x Cup Holder



Wrench (10-11) & Allen key
(4mm, 5mm, 5/16")



2 x Safety Hook



2 x Antenna holder



1 x 4u 19" Rack Adapter Kit



Tablet
Holder

All rights reserved.

No part of this document may be reproduced, stored in a retrieval system, or transmitted by any form or by any means, electronic, mechanical, photo-copying, recording, or otherwise, except as may be expressly permitted by the applicable copyright statutes or in writing by the Publisher.

Soundchief Channel Cart Setup

- Loosen the bolts of the Sound chief channel cart with an Allen key 5/16" Allen key.

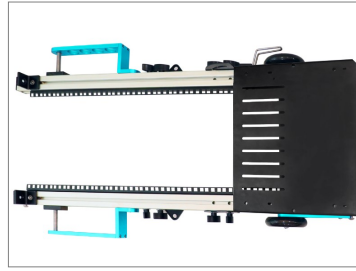

- Attach the wheel to the cart by removing the bolt.



- Match the center hole of the wheels and cart, and insert the bolt into the wheel.



- Properly tight the bolt with a 5/16" Allen key and follow the same process for the other side of the wheel.



- Both the wheels are properly attached to the Sound Chief Channel Cart, as shown in the image



Bottom Plate

- Remove the knob of the bottom shelf.

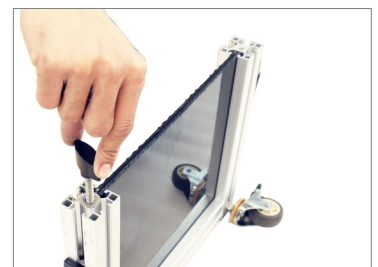

- Remove the bolts on both sides of the bottom plate with the help of a 5mm Allen key.

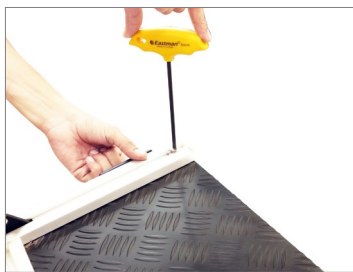

- Attach the bottom plate to the bottom of the cart, and insert the side bolt matching the hole of the cart panel and the plate.



- Then properly tight bolt with 5mm Allen key.

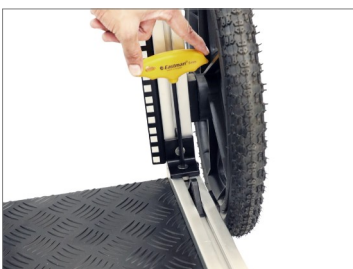

- For side security, firstly remove the button head with a 5mm Allen key and slide the Bottom Channel Support Plate to align it.



- Then insert the button head by tightening it properly with a 5mm Allen key.

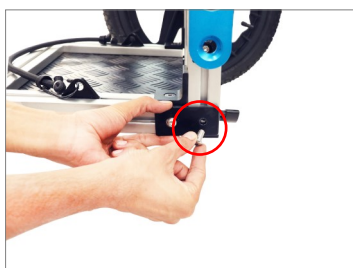

- To attach the bottom plate to the cart, secure it properly with the help of a knob.



- To attach the bottom plate to the cart, secure it properly with the help of a knob from the other side as well.



- The bottom plate is properly attached to Proaim Soundchief Channel Cart



Sliding Shelf

- Properly remove both the side knobs on the cart.



- Attach Sliding Shelf to Channel Cart.



- Then insert the knob on the plate of the sliding shelf.



- Tighten both the knobs of the sliding shelf properly from both sides.

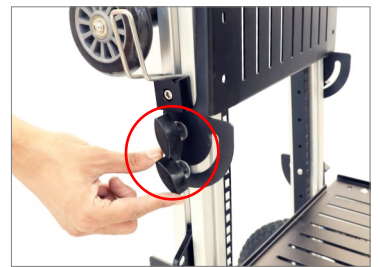

- The sliding shelf is properly attached to Proaim Soundchief Channel Cart.



Height Adjustable Shelf

- Loosen the knobs on both sides of the height adjustable shelf.

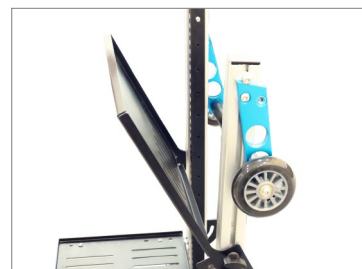
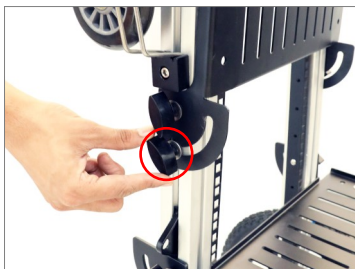

- Open the adjustable shelf and tighten it properly with the help of knobs on both sides.

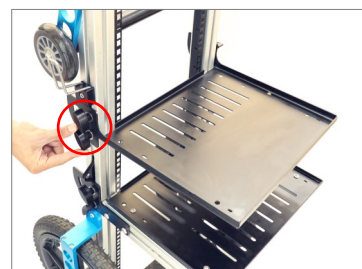

- The height-adjustable shelf is properly attached to Proaim Soundchief Channel Cart.



4u 19" Rack Adapter Kit

- Remove the button head of the rack adapter kit with the help of a 5mm Allen key, and set the position of the adapter kit according to your requirement.

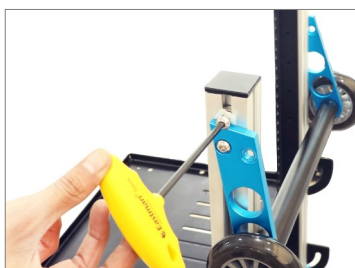

- Match the thread of the cart and rack adapter kit and insert the button head and tighten with the help of a 5mm Allen key from both sides.

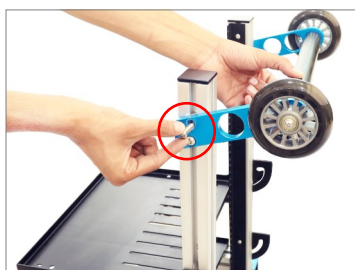

- Align the tablet holder to the cart, and secure it properly with the help of a 5mm Allen key

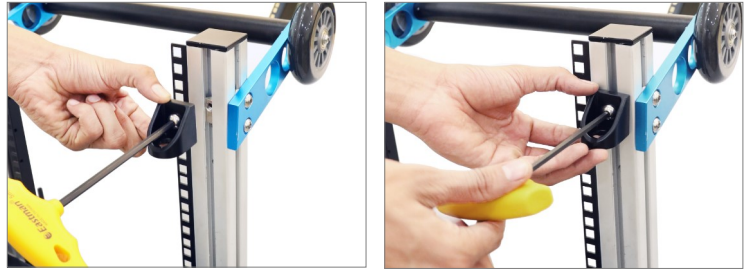

- Attach the Antenna Holder to the cart losing its knob and tighten it with the help of a 5mm Allen key; Follow the same process for attaching another holder.

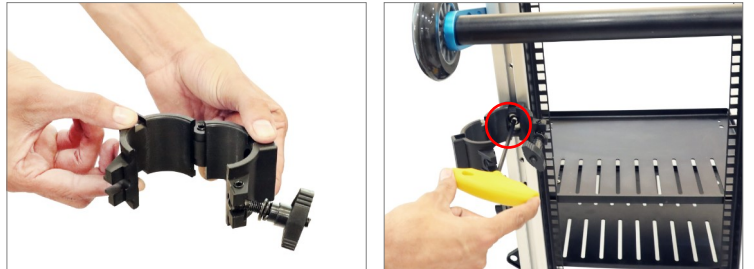

- Both the holders are properly attached to Proaim Soundchief Channel Cart, as shown in the image.



- Attach the Boom Pole Holder Kit to the cart and tighten it properly with a 5mm Allen Key.
NOTE: The boom pole holder kit consists of 3 parts: boom clamp, boom cup, and boom cup mount. All three parts are used to mount a boom pole to the cart.

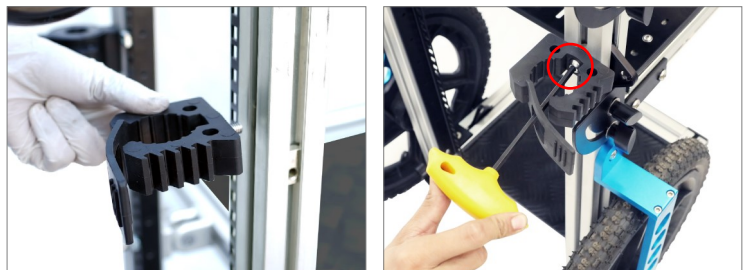

- Attach the boom cup mount to the cart, and secure it properly to the cart with a 5/16" Allen Key.



- Insert the boom cup into the boom cup mount.
NOTE: The bottom part of the boom pole rests in the boom cup.



- Attach the cup holder and secure it with a 5/16" Allen key, as shown in the image.

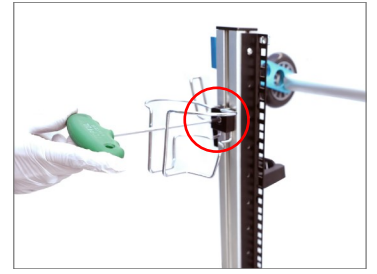
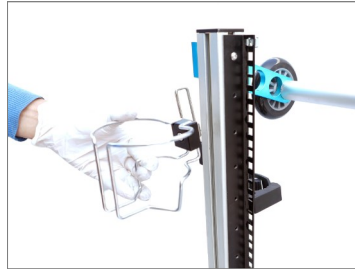

- Attach the Safety Hook to the bottom shelf as shown in the image.

NOTE: With the help of safety hooks, the gears/equipment do not fall and remain stable even while moving the cart.

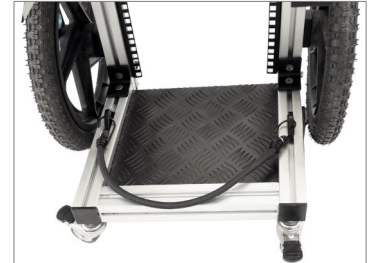

- Repeat the same process for attaching a hook to the sliding shelf.



NOTE: The whole cart is designed in the channel version so that you can fix the shelves wherever you want. The provided Rack Mount offers you the ease of accessorizing it.



**YOUR PROAIM SOUNDCHIEF CHANNEL CART
ALL DRESSED UP AND READY TO GO!**



(SHOWN WITH OPTIONAL ACCESSORIES)

Warranty: We offer one year warranty for our products from date of purchase. Within this period of time, we will repair it without charge for labor or parts. Warranty doesn't cover transportation costs nor does it cover a product subjected to misuse or accidental damage. Warranty repairs are subjected to inspection and evaluation by us.

Liability: We are not liable for damage caused by products that we do not supply or from mishandling in transit, accident, misuse, neglect, lack of care of the product, or service by anyone other than our company.

Contact Us: In case of any kind of dissatisfaction, please Contact us immediately and we promise our utmost support and care until you use our product.