

PR[→]AIM Quantum Shoulder Rig w VCT Mount (SR-SBP-01)

Assembly Manual



■ What's In The Box

Please inspect the contents of your shipped package to ensure you have received everything that is listed below.



Base Plate



2 x Handles



2 x 15mm & 8" Long 200mm Female Rods



2 x 15mm & 12" Long 300mm Female Rods

All rights reserved.

No part of this document may be reproduced, stored in a retrieval system, or transmitted by any form or by any means, electronic, mechanical, photo-copying, recording, or otherwise, except as may be expressly permitted by the applicable copyright statutes or in writing by the Publisher.

Quantum Shoulder Rig Setup

- Loosen the knob of the base plate and insert the 200mm long rod.

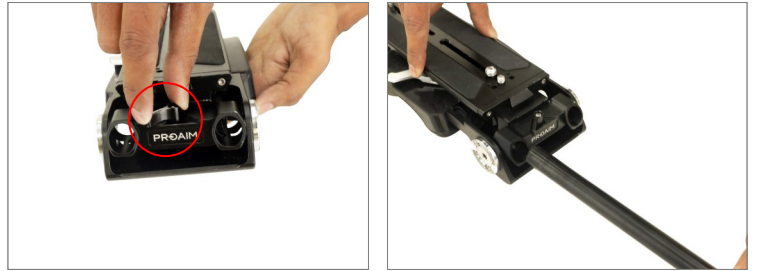

- Then insert the second 200mm long rod and tighten it properly with the knob, as shown in the image.



- Loosen the knob on the other side of the base plate and insert the 300mm long rod.



- Then insert the second 300mm long rod and tighten the knob properly, as shown in the image.

NOTE: There are 15mm(dia) rods on the front and back to accommodate more camera accessories.

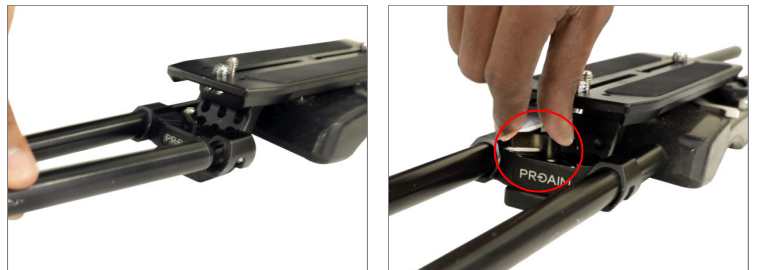

NOTE: It has dual slots that allows quick positioning of your camera & camera accessories.



- Now attach the handle and tighten the ratchet knob properly.



- Then attach the second handle and tighten it properly.



- By pressing the adjustment knob, the angle of the handle can be changed according to your requirement, as shown in the image.



NOTE: It allows your camera set up to sit comfortably on your shoulders by eliminating the discomfort caused by the camera's weight on your shoulder during shooting.



- Push the black pin upward by pressing the safety pin of the shoulder base plate.



- Then quickly slide the baseplate.

NOTE: This Universal Camera Baseplate allows quick attaching and detaching of your camera setup fastened by Safety Pins and Ratchet Knobs.



- Mount the camera (Not-Included) on the shoulder pad and tighten it properly with the help of a screwdriver.

NOTE: The shoulder plate has 1/4"-20 and 3/8"-16 threaded holes for storing additional screws.



- Then set the camera position and lock it properly by pushing the safety pin.



NOTE: Quantum Shoulder Rig also supports RED (DSMC2), Arri, Sony, Canon, Panasonic, Blackmagic (Ursa Mini), and many other camera models with interchangeable lenses.



YOUR PROAIM QUANTUM SHOULDER RIG W VCT MOUNT ALL DRESSED UP AND READY TO GO!



(SHOWN WITH OPTIONAL ACCESSORIES)

Warranty: We offer one year warranty for our products from date of purchase. Within this period of time, we will repair it without charge for labor or parts. Warranty doesn't cover transportation costs nor does it cover a product subjected to misuse or accidental damage. Warranty repairs are subjected to inspection and evaluation by us.

Liability: We are not liable for damage caused by products that we do not supply or from mishandling in transit, accident, misuse, neglect, lack of care of the product, or service by anyone other than our company.

Contact Us: In case of any kind of dissatisfaction, please Contact us immediately and we promise our utmost support and care until you use our product.