

PR◀AIM Professional Speech Teleprompter (TP-SPH-01)

Assembly Manual



What's In The Box

Please inspect the contents of your shipped package to ensure you have received everything that is listed below.



NOTE: The teleprompter glass has a different amount of reflectivity at both ends. If the glass is not installed in proper orientation than you may experience a "double image" or "text shadow" effect on the teleprompter. To eliminate this, we have applied a White sticker on the front side of the glass. Incase, the mark gets removed and you face this issue, simply flip the teleprompter glass.

All rights reserved.

No part of this document may be reproduced, stored in a retrieval system, or transmitted by any form or by any means, electronic, mechanical, photo-copying, recording, or otherwise, except as may be expressly permitted by the applicable copyright statutes or in writing by the Publisher.

■ Teleprompter Setup

- To keep the Stand Platform in a static position (non-movable), lock down the wheels using the provided brakes.
- Attach the main rod with a telescopic rod and secure it by twisting them.
- Now insert the main rod onto the Base Platform and tighten bolts with the Allen key's help.
- If you want to extend the stand's height, you can raise the 3rd section using a speed crank knob. Tighten the knob after getting the desired size.
- If you further need to increase the height, then loosen the bolt from the bottom of the telescopic rod, adjust as per the required height and tighten the bolt to secure.
- Loosen both the knobs of the iPad tray clamp and adjust as per the required height.

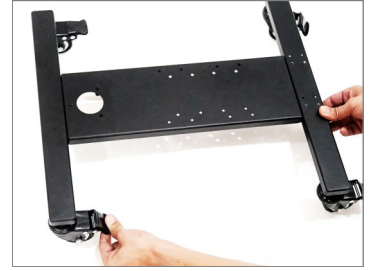

- Loosen the knobs of the iPad clamp to insert both rods & tighten the knobs to secure them.

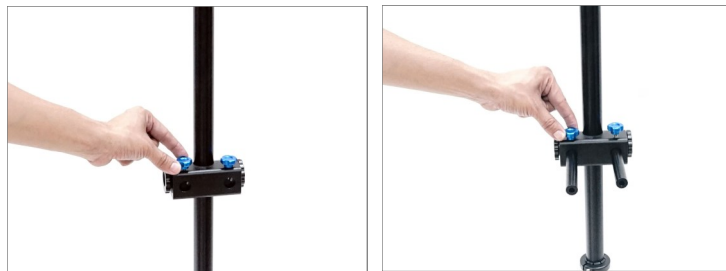

- Loosen the knob of iPad tray, Insert the iPad section & tighten the knob.



- Attach the iPad tray with clamp and tighten both side knobs to secure it.



- Centre align the glass and place in the glass holder and tighten the knob to secure.

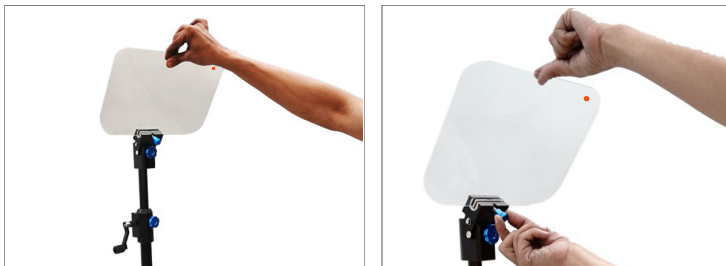

NOTE: You can adjust the angle of the glass by using the provided knob, as shown.

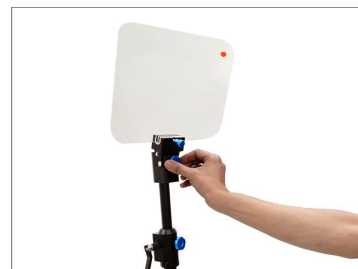

YOUR PROAIM PROFESSIONAL SPEECH TELEPROMPTER ALL DRESSED UP AND READY TO GO!



(SHOWN WITH OPTIONAL ACCESSORIES)

Warranty: We offer one year warranty for our products from date of purchase. Within this period of time, we will repair it without charge for labor or parts. Warranty doesn't cover transportation costs nor does it cover a product subjected to misuse or accidental damage. Warranty repairs are subjected to inspection and evaluation by us.

Liability: We are not liable for damage caused by products that we do not supply or from mishandling in transit, accident, misuse, neglect, lack of care of the product, or service by anyone other than our company.

Contact Us: In case of any kind of dissatisfaction, please Contact us immediately and we promise our utmost support and care until you use our product.