

Assembly Manual



■ What's In The Box

Please inspect the contents of your shipped package to ensure you have received everything that is listed below.

- 24.5ft Long Telescopic Camera Jib Crane
- 150mm Bowl Jib Stand (LW-150)
- D 33 Pro Camera Dolly
- Customized Storage Cases for Camera Jib Arm , Jib Stand & Accessories
- **Complimentary** Tools and Tool Pouch/Wrap

All rights reserved.

No part of this document may be reproduced, stored in a retrieval system, or transmitted by any form or by any means, electronic, mechanical, photo-copying, recording, or otherwise, except as may be expressly permitted by the applicable copyright statutes or in writing by the Publisher.

First Packing Includes

- Jib Sections

Second Packing Includes

- Jib Sections

Third Packing Includes

- Accessories of Jib Crane

Fourth Packing Includes

- Gravity Jib Stand

Fifth Packing Includes

- Dolly Pack



NOTE: We send the Jib sections in two boxes. One box has the sections with pipe packing and the other box (cardboard box) has the rest of the sections. **We only send one pipe packing for the jib sections.** We send the Dolly in cardboard box.

Packaging Material of Box 1 & 2: 7x Jib Sections

Packaging Material of Box 3: Accessories of Jib Crane



Joystick Controller Bracket



Hub Section



Head Platform with Bolt, Shaft Collars, Washers and Nut



6 x Shanks for Joining Arms



Levelling Cable



6 x Pins for Joining jibs



7 x Black Velcro



2 x pins



Shank



Hub Mounting knob



Turn buckle

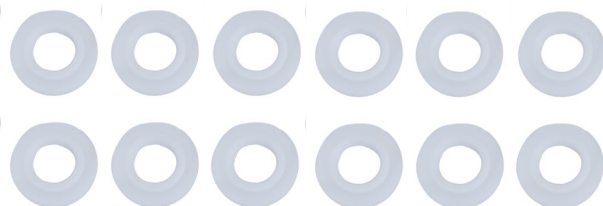

12 x Washers



Rear Frame Mounting Rod



Complimentary Tools Pouch

Packaging Material of Box 4: Gravity Stand



Packaging Material of Carton Box 5: Camera Dolly





Safety Hints

ATTENTION: PLEASE READ THIS BEFORE USING TO PREVENT DAMAGE TO EQUIPMENT & OPERATOR!

- The crane may not be assembled or operated under the influence of alcohol, drugs or any other intoxicating substances. Lack of attention while connecting the components can cause substantial damage to the equipment/operator.
- The crane may only be operated in levelled horizontal position. Make sure that the surface is stable.
- To prevent any harm or injury, properly join all sections of the crane. In addition, it is suggested to use the support stand while telescoping the complete length.
- Always connect the steel cables properly to provide stability to the system. They should not negatively impact the movements of the crane in any way.
- After the crane setup, the pan-tilt head/gimbal head shall be positioned under the central pivot section. In the assembled state, when the pan-tilt head/gimbal head is higher than the central pivot section, there should be someone to look after the crane system.
- The complete panning & lifting range around it must be kept free. Avoid anybody standing under the crane. No loose objects may be stored or placed on it. Be very careful while using indoors.
- Never operate the crane in the immediate vicinity of high-voltage power cables. It holds danger to life.
- Particular care is required when operating the crane in unfavourable weather conditions. The crane must be shut down in sufficient time. When it is used in a rainy day, the pan-tilt head / gimbal head and controlling bar shall be protected against rain.
- When you want to transport the crane, lock the Pan & Tilt Axis for safety. Make sure that the components do not rub together and cause any material wear.
- Before the counterweights are removed, ensure the remote head is resting on the support stand. Then gradually remove the counterweights before remote head, camera or other parts.
- In the interest of safe crane operation, avoid abruptly swivelling or stopping the crane, otherwise it may cause serious damage to equipment.

FOLLOWING THESE GUIDELINES WILL PROVIDE BETTER SHOTS AND TROUBLE FREE OPERATION.

SHOULD YOU NEED ADDITIONAL INFORMATION, TECHNICAL ASSISTANCE IS AVAILABLE 'ONLINE' BY CONTACTING THE SALES REPRESENTATIVE.

INDEX

Sr. No	Particulars	Page No.
1	Kite-22 Crane Starter Setup	7
2	Kite-22 Crane Starter Mounting On Dolly	7
3	D-33 Dolly Assembly	7-8
4	Tripod Holders Assembly	8
5	LW-150 Jib Stand Assembly	8-10
6	Hub Mounting Assembly	10-11
7	Jib Section Assembly	11-13
8	Section 7th & Section 6th Assembly	13-14
9	Head Platform Mounting	14-15
10	Turn Buckle mounting	15
11	Levelling Cable Assembly	15-16
12	Joystick controller Bracket assembly	16
13	Weight rod Assembly	16-17
14	Weight Mounting	17
15	Rear Frame Mounting Rod	17
16	(P-RB-SP) Spreader Assembly	18-19
17	LW-150 Jib Stand Mounting On Spreader	19-20
18	Shortening the length of jib	21-22
19	Different Shooting Lengths	23
20	Balancing	24
21	Balancing Tips	25
22	Final Setup	26

Kite-22 Crane Starter Setup

Kite-22 Crane Starter Mounting On Dolly

D-33 Dolly Assembly

- Loosen the side bolt of the D-33 Pro Camera Dolly using the 17mm Spanner.

FEATURE: This dolly has various holes for flexible mounting of Tripods



- Remove the bolt nut, washer and bolt.



- Repeat the same steps to remove the second side Bolt of the D-33 Dolly.



- Stretch out the legs of the D-33 Dolly and open them.



- After opening the Dolly, re- insert the Bolt, washer and Bolt nut.

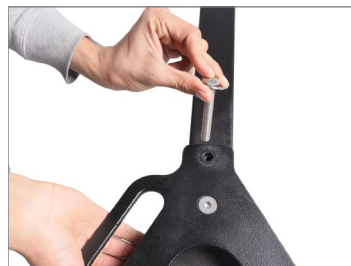

- Tighten the Bolt nut using the 17mm spanner.
- Repeat the same step to re-insert the second side Bolt.



Tripod Holders Assembly

- Remove the Allen bolt from the Tripod holder using a 3/16" T-Type Allen key and mount the holder on the Dolly.
- Carefully align the holes of the Tripod holder with the Dolly.
- Now, insert an Allen bolt and re-tighten it using a 3/16" T-Type Allen key.
- Repeat the same step to mount the remaining tripod holders.



LW-150 Jib Stand Assembly

- Stretch out the legs of the LW-150 Jib Stand and open the Stand.



- Loosen the knob and extend the Tripod leg.

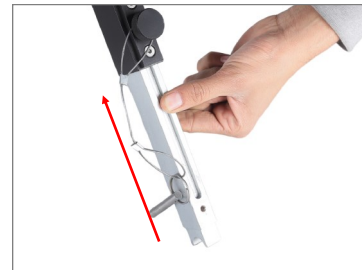

- Now, lock it using the locking pin once it is at the desired length.



- Tighten the knob.

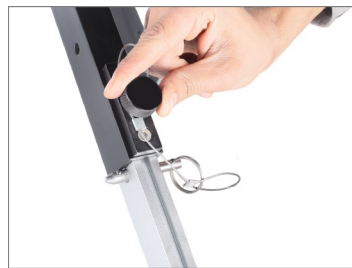

- Loosen the knob of the tripod holder and mount the Tripod Stand on the Dolly.



- Tighten the knob of all three Tripod legs after mounting the Tripod.



- Remove the pan-friction knob and plastic washer from the Stand.



- Remove the bolt on the base of the Tripod using the 21mm spanner.



- Repeat the same step to remove the second bolt.



Hub Mounting Assembly

- Mount the Hub Mounting on the Tripod.

FEATURE: The Hub Assembly has several mounting holes for attaching additional accessories like a LCD Monitor or a Joystick box.

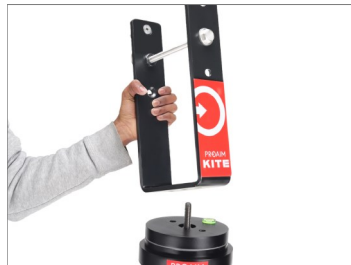

- Now, re-insert the bolts and tighten them using the 21mm spanner.

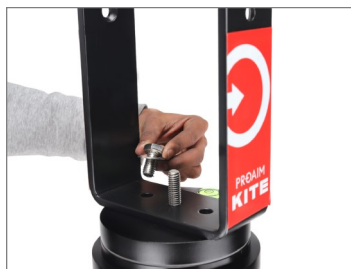

- Re-insert the plastic washer and pan friction knob.
- Tighten the knob properly to secure the assembly hub.



- Hub Mounting is now securely mounted on the jib Stand.



- Loosen the nut bolt using the 21mm spanner and remove the Hub mounting shank.



Jib Section Assembly

- Insert the 2nd Jib section into the 1st Jib section and mount them on the Hub mounting by aligning their threads.



- Insert Shank into the Hub mounting ensuring the holes of both the sections are aligned with the holes of the Hub mounting.



- Now, re-insert the washer and nut bolt into the Shank of the hub mounting.



- Tighten the nut bolt using the 21mm Spanner.

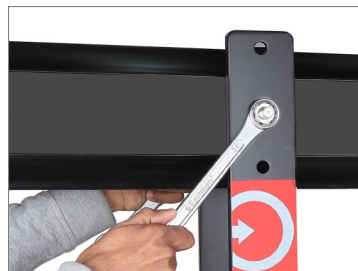

- Remove the black shank knob and plastic washer by loosening them.



- Now, insert the Shank into second hole of the 1st Jib section, as shown in the image.



- Re-insert the plastic washer and knob from the other side.



- Tighten the knob using the 4mm T-Type Allen key.



- Insert 3rd section into the 2nd section ensuring the holes are aligned.



- Insert the 4th, 5th & 6th section following the same steps.

- Insert the Shank in the section joint after ensuring alignment of the holes.



- Now, insert plastic washer and knob from the other side.



- Tighten the shank knob using the 4mm T-Type Allen key.



- Insert the locking pin into the 1st section from the top and lock it securely.



- Similarly, insert the locking pin into the 2nd section from the top and lock it securely.



- The 1st, 2nd and 3rd Section are securely attached.



- Repeat the same process for attaching the remaining sections.



Section 7th & Section 6th Assembly

- Insert 7th section into the 6th section and insert the shank ensuring the holes are aligned.



- Insert plastic washer and knob from the other side and tighten the knob.



- 7th section is securely attached.

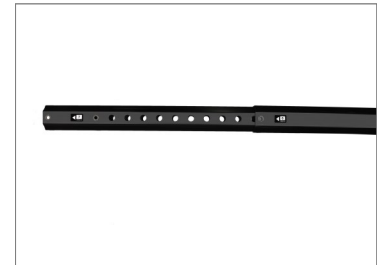

- Insert locking pin into the 6th section from the top and lock it.



Head Platform Mounting

- Loosen the bolt of the Head platform and remove it.
- Remove plastic washers, steel washers and shaft collars from the Shank.



- Mount Head Platform on the 7th section of the jib.



- Attach Head platform to the jib section.
- Now, insert the long bolt and plastic washer, as shown in the image.

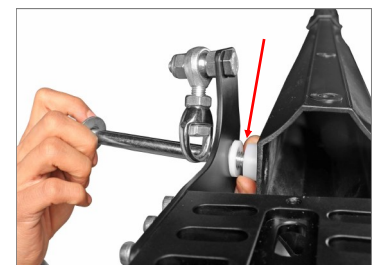

- Insert two Shaft collars inside the jib and insert plastic washer in the center of the Jib and Head platform.

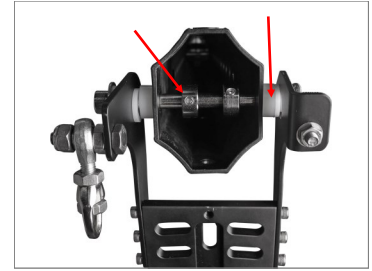
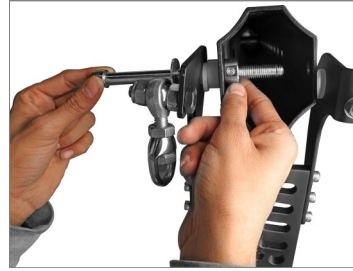

- Insert plastic washer and steel washer to the other side of the long bolt.



- After inserting washer, insert the nut and tighten it using a 19mm spanner.



- To tighten the bolt, tighten it using the 10mm Allen key from one side and using the 19mm spanner from the other side.



- Now, move both the Shaft collars to the sides and tighten them using a 3mm T-Type Allen key.



Turn Buckle Mounting

- Attach the Turn Buckle to the Hub mounting.



Leveling Cable Assembly

- Attach one end of the levelling cable to the Hub mounting.



- Insert the other end of the Leveling cable into the Turn Buckle and lock the cable.

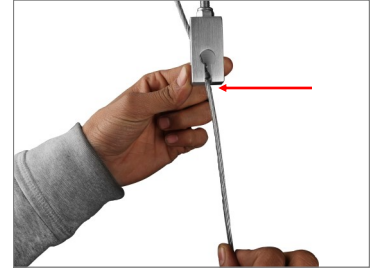

FEATURE: The levelling cable can be stretched per your requirement.



Joystick Controller Bracket Assembly

- Attach the Joystick Controller Bracket to the Jib and insert the Shank.

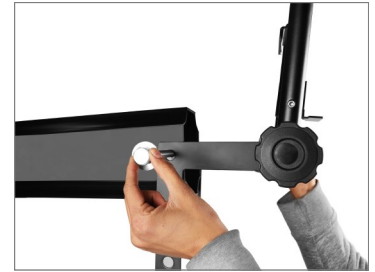

- Now, insert the washer and nut bolt to the other side of the Joystick Controller.



- Tighten the nut bolt using the 21mm Spanner.
- Joystick Controller Bracket is now attached to the Jib.



Weight Rod Assembly

- Insert the Weight rod into Joystick Controller Bracket.
- Now, insert the black tube to the center.



- Using the same step insert the black tubes to the weight rod on both the sides, as shown in the image.



Weight Mounting

- Put weights on the weight rods per your requirement.



- Now, put stoppers to secure the weights.



Rear Frame Mounting Rod

- Insert Rear Frame Mounting Rod into the Joystick Controller Bracket and tighten them securely.

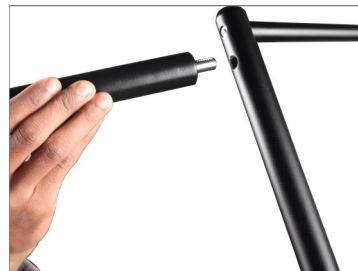

- The Jib is securely mounted on the Jib stand.



Kite-22 Crane Starter Mounting On Dolly



(P-RB-SP) Spreader Assembly

- Stretch out the legs of the Spreader and open them.



- Open the rubber foot of the Spreader.



- Repeat the same step to open the other two rubber feet.



- Unlock the Spreader's knob and extend the foot's length.
- Once the foot has been extended to the desired length, re-lock the knob to secure it.



- Repeat the same process to extend the length of the remaining two Spreader feet.

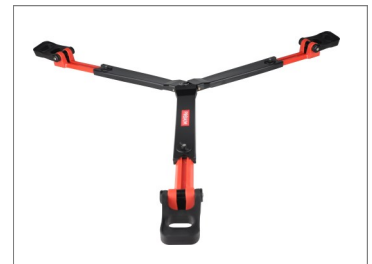

- Insert the stopper into the Jib Stand's leg and tighten it using a 4mm T-Type Allen key.

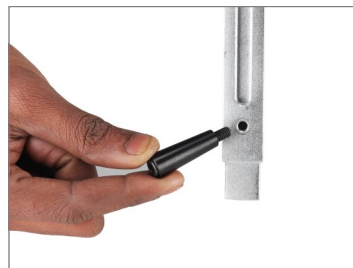

- Similarly, insert the stoppers into the other two Jib Stand legs.



LW-150 Jib Stand Mounting On Spreader

- Mount the Jib Stand on the Spreader and secure it using the stopper.



- Following the same process, secure the remaining legs of the Jib stand.



- Now, mount the Jib on the Jib Stand.

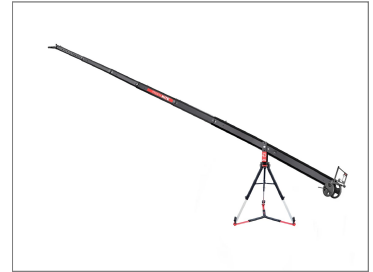

Kite-22 Crane Starter Mounting On Spreader



Shortening the length of Jib

- To shorten the length of the Kite crane, remove the Levelling cable from the Shank of the Hub section.
- Remove both locking pins from the 1st Section.
- Loosen and remove the knob of the shank using the 4mm T-Type Allen key.
- Now, remove the shank.
- Remove the nut bolt of the Hub section's shank using the 21mm spanner and remove the shank, as shown in the image.
- Slide 2nd Section into the 1st Section and insert the shank.
- Now, align the second hole of section 2 with the first hole of section 1 and insert the shank.

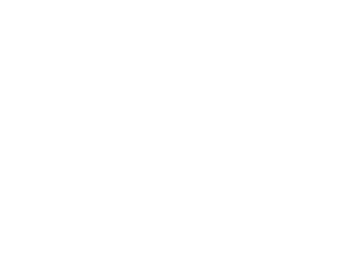
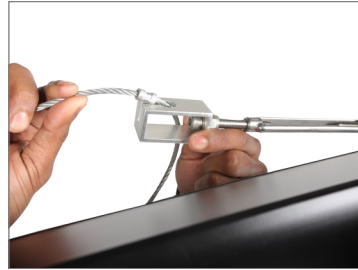

- Insert the nut bolt from the other side and tighten it using the 21mm spanner.



- Slide 3rd section into 2nd section and repeat the same step to insert the shank.

NOTE: Make sure to align the holes of both the sections.



- 3rd Section is now securely attached to the 2nd section .
- Repeat the same steps to insert Shank with knobs and locking pins.



NOTE: To shorten the length of the jib, insert 2nd section into 1st section, 3rd section into 2nd section, 4th section into 3rd section, 5th Section into 4th section, 6th section into 5th section, and 7th section into 6th section.

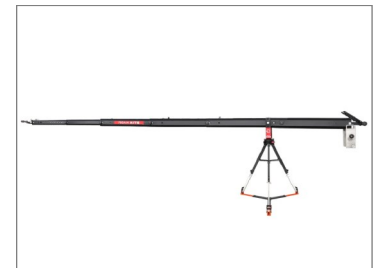

Different Shooting lengths

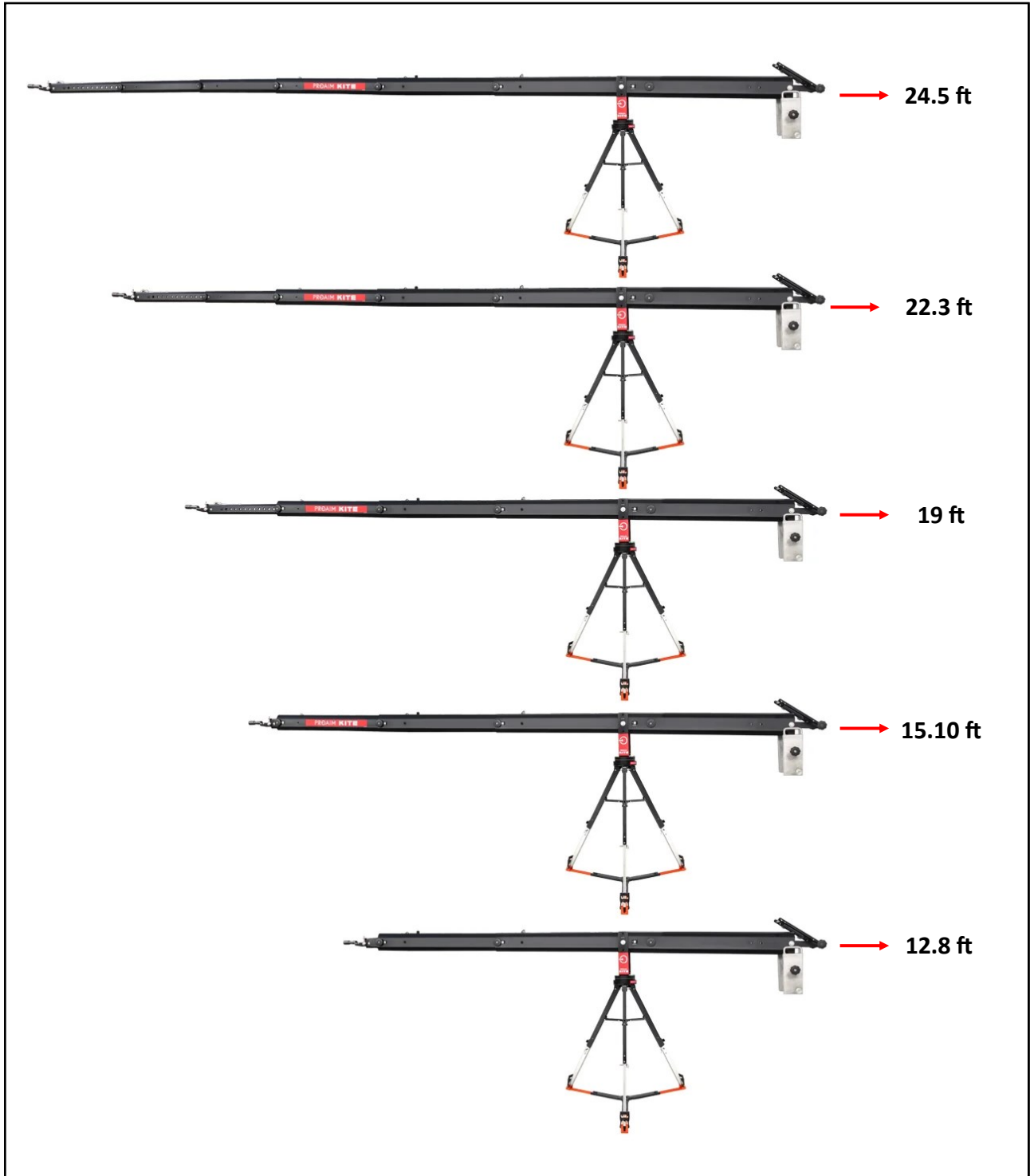

Balancing

Follow these steps to balance the head:-

- Find the horizontal balance point of your camera by using two fingers in one hand while holding the handle.
- Mark this point on the side of the camera with chalk or tape.
- Turn the unit on and move the tilt control until the camera plate is vertical.
- Loosen the two screws holding the tilt motor. (DO NOT REMOVE)
- Grasp the motor and turn slightly to disengage the gears.
- Mount the camera to the camera plate with the screw provided.
- Tighten it by securely threading the nut to the bottom of the camera plate.
- Ensure your balance point, previously marked with chalk or tape, is in the middle of the plate.
- Loosen the knob below the camera plate and slide the camera and plate up or down until the center line of your camera is about in the middle of the large gear. Now tighten the knob.
- If the camera is perfectly balanced, it stays in any position while motor gear remains unattached.
- Grasp the motor and turn it back until the gears mesh.
- Gently tighten motor screws.
- Secure the camera.

NOTE: All reduction boxes have a small amount of backlash. Balancing the camera will reduce the backlash to a minimum, making it feel at the top of the tilted arc.

OPERATION

- With the camera set up as previously described above, Power ON by pressing the RED Switch on the top of the Joystick control box.
- For inverted use, disconnect the leads to the motors, rotate the control box 180 degrees and re-install.

Balancing Tips

The sections collapse into each other

1. 24.5' Jib

Weights required for balancing only Jib (without camera & Pan Tilt) is: **55Kg (121.5 lbs)**

If the camera weight is 1kg, the jib is balanced with $55+5\text{kg}=60\text{kg}$

If the camera weight is 2kg the jib is balanced with $55+10\text{kg}=65\text{kg}$

2. 22.3' Jib

Weights required for balancing only Jib (without camera & Pan Tilt) is: **54Kg (119lbs)**

If the camera weight is 1kg, the jib is balanced with $54+4\text{kg}=58\text{kg}$

If the camera weight is 2kg the jib is balanced with $54+8\text{kg}=62\text{kg}$

3. 19' Jib

Weights required for balancing only Jib (without camera & Pan Tilt) is: **53Kg (116 lbs)**

If the camera weight is 1kg, the jib is balanced with $53+3\text{kg}=56\text{kg}$

If the camera weight is 2kg the jib is balanced with $53+6\text{kg}=59\text{kg}$

4. 15.10' Jib

Weights required for balancing only Jib (without camera & Pan Tilt) is: **52 Kg (114 lbs)**

If the camera weight is 1kg, the jib is balanced with $52+2\text{kg}=54\text{kg}$

If the camera weight is 2kg the jib is balanced with $52+4\text{kg}=58\text{kg}$

5. 12.8 ' Jib

Weights required for balancing only Jib (without camera & Pan Tilt) is: **51 Kg (112 lbs)**

If the camera weight is 1kg, the jib is balanced with $51+1\text{kg}=52\text{kg}$

If the camera weight is 2kg the jib is balanced with $51+2\text{kg}=53\text{kg}$

For some interesting compound shots try:

Moving the pan & tilt control in the same direction as you move the rear of the jib. This keeps your subject framed but changes the perspective of the camera.

**YOUR PROAIM KITE-22 CAMERA CRANE STARTER PACKAGE
ALL DRESSED UP AND READY TO GO!**



(SHOWN WITH OPTIONAL ACCESSORIES)

Warranty: We offer a one-year warranty for our products from the date of purchase. Within this period, we will repair it without charge for labor or parts. The warranty doesn't cover transportation costs, nor does it cover a product subjected to misuse or accidental damage. Warranty repairs are subject to inspection and evaluation by us.

Liability: We are not liable for damage caused by products we do not supply or from mishandling in transit, accident, misuse, neglect, or lack of care of the product or service by anyone other than our company.

Contact Us: If you are dissatisfied, please contact us immediately. We promise our utmost support and care until you use our product.