

# PROAIM Handheld Star Ring (P-STRG-01)

## Assembly Manual



### What's In The Box

Please inspect the contents of your shipped package to ensure you have received everything that is listed below.

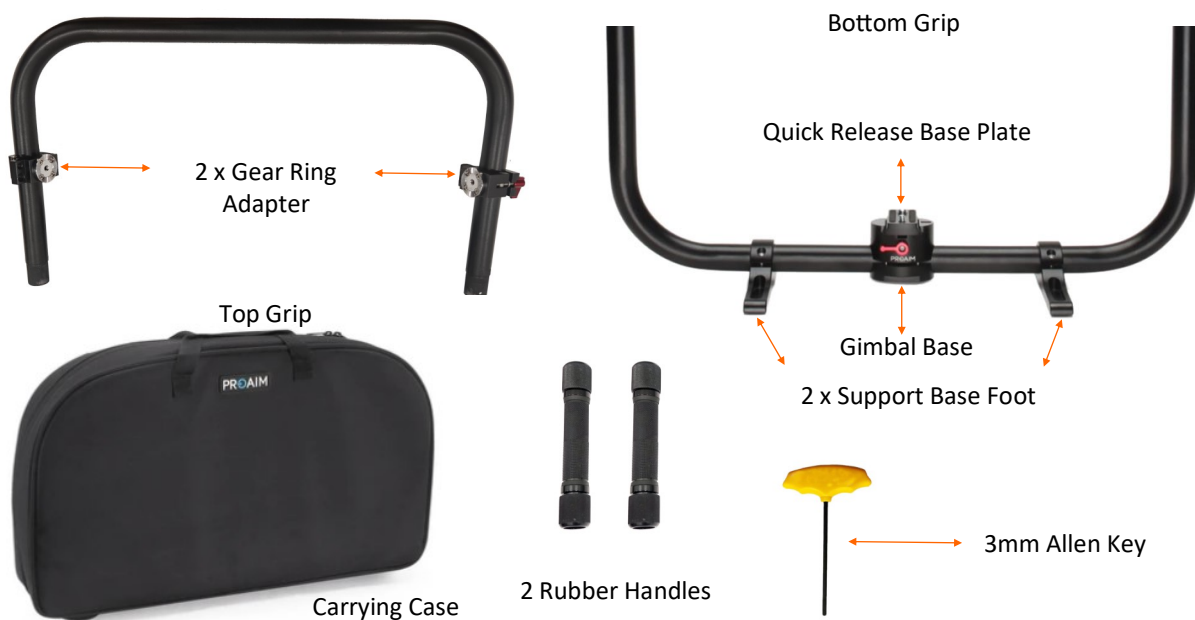

All rights reserved.

No part of this document may be reproduced, stored in a retrieval system, or transmitted by any form or by any means, electronic, mechanical, photo-copying, recording, or otherwise, except as may be expressly permitted by the applicable copyright statutes or in writing by the Publisher.

## Star Ring Setup

- Loosen the screw of the support base foot with an Allen key to stabilize the bottom grip. Then adjust the position of the support base foot.

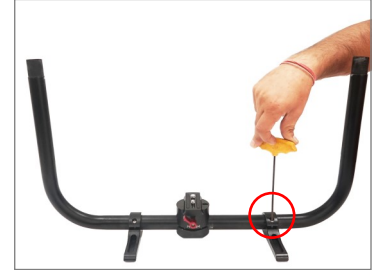

### Top & Bottom Grip Assembly

- Remove the rubber from the anti-slip connect handle.
- Attach the rubber on one end of the bottom grip, and then attach the anti-slip handle to it.
- Now, connect the top grip to the anti-slip handle. Following the same process, connect the other end of the top grip to the bottom grip.

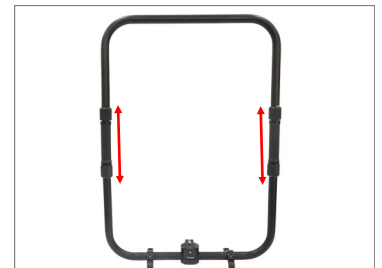

### Gear Ring Adapter Assembly

- Mount the gear ring adapter onto the grip. Adjust its position as per your needs and secure it with the help of a provided knob.
- Images show gear ring adapter adjusted to different positions.

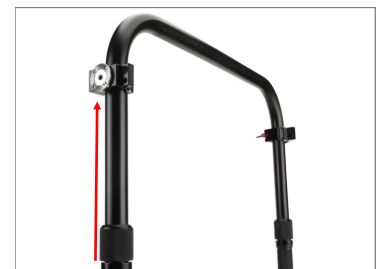
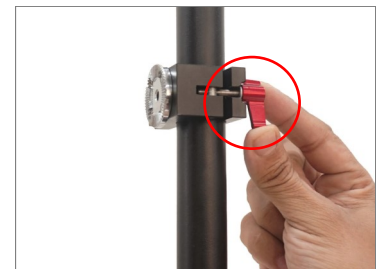
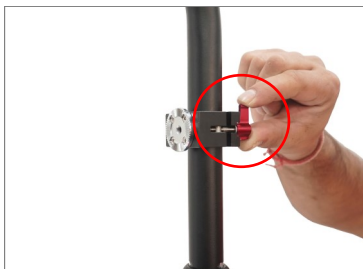

- To stabilize the position of the gimbal base, loosen the gimbal base screw using an Allen key.



## Gimbal Assembly

- To mount the gimbal to the gimbal base, loosen the screws on the gimbal quick release base plate using an Allen key.



- Attach the gimbal to the gimbal quick release plate.

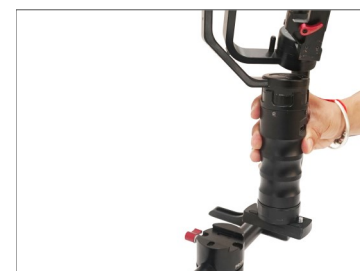

- Fix the gimbal into the gimbal base with the help of provided knob, as shown in the image.



- Loosen the knob of flycam flowline hook and mount onto the top grip then tighten with provided knob to ensure slip-free connection as shown in the image.

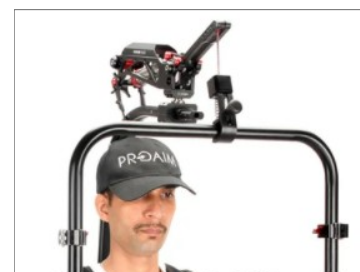

## YOUR PROAIM HANDHELD STAR RING FOR GIMBAL CAMERA STABILIZERS ALL DRESSED UP AND READY TO GO!



(SHOWN WITH OPTIONAL ACCESSORIES)

**Warranty:** We offer one year warranty for our products from date of purchase. Within this period of time, we will repair it without charge for labor or parts. Warranty doesn't cover transportation costs nor does it cover a product subjected to misuse or accidental damage. Warranty repairs are subjected to inspection and evaluation by us.

**Liability:** We are not liable for damage caused by products that we do not supply or from mishandling in transit, accident, misuse, neglect, lack of care of the product, or service by anyone other than our company.

**Contact Us:** In case of any kind of dissatisfaction, please Contact us immediately and we promise our utmost support and care until you use our product.