

Gladiator Action Dolly (DL-GDTR-01)

Assembly Manual



■ What's In The Box

Please inspect the contents of your shipped package to ensure you have received everything that is listed below.



2 x 16" Pneumatic Tires
 2 x Pull-out wheel ball pin



Seat



Left/Right Main Section



Square extension



2 x Side Boards

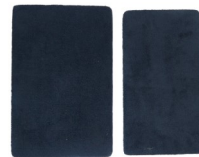

Floor Board



Upper wide Board



Back sport seat



Seat Arm



Seat riser



Knob



(3mm,4mm)Allen key
 & 10, 2 x 13 Spanner



Speed Rail



Wide round extension

All rights reserved.

No part of this document may be reproduced, stored in a retrieval system, or transmitted by any form or by any means, electronic, mechanical, photo-copying, recording, or otherwise, except as may be expressly permitted by the applicable copyright statutes or in writing by the Publisher.

Action Dolly Setup

- Remove the pull-out wheel ball pin attached to the Pneumatic Tires with the help of your hand.



- Attach the pneumatic wheels with the Right/ Left main section and insert the pull-out wheel ball pin.



- Then secure it properly with the pull-out wheel ball pin.



- Slide it open with the help of a push pin button fitted in a wide round extension.



- Then, Loosen the knob of the Pneumatic Wheels.



- Insert the wide round extension in the hole made in the right/left section.



- Then, loosen the knob on the right/left of the main section.



- Insert the wide round extension on the center part of the main section and tighten it properly with the help of a knob.



- Then attach the wide round extension on the top part of the section by following the same procedure.



- Attach both the left and right main sections together.



- Extend the length of the round extension by pressing the push pin button.



- Insert the side boards matching the holes of the main section.



- Place both the side boards on top of the main section.



- Attach the floorboard by sliding it on the bottom part of the section.



- Now, Attach the floorboard to the center part following the same process.

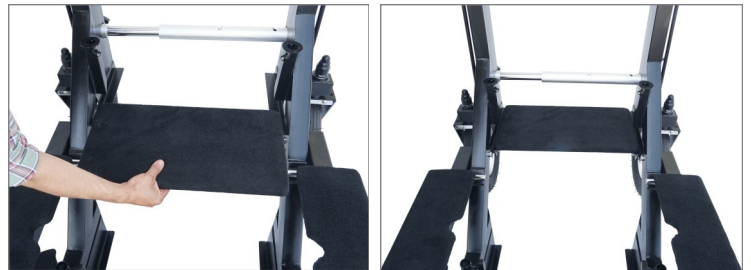

- Loosen the Provide knob in the main section.

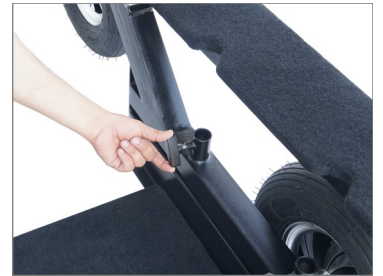

- Match the main section hole with the seat riser and insert and tighten the seat riser properly.



- Then insert the seat arm matching the hole of the seat riser and secure it properly with the help of its knob.



- Finally, the seat riser or seat arm is properly attached to the dolly.



- Remove the bolt in the seat arm with the help of a spanner and 4mm Allen key.

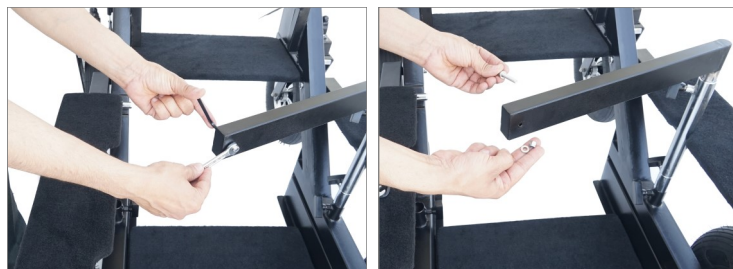

- Insert the seat into the seat arm and secure the seat properly with the help of its knob.



- Then insert the seat arm bolt into the seat arm.



- Then Tighten Properly with The Help of a Spanner And 4mm Allen Key.



- Insert the speed rail into the side hole of the main section, and tighten it properly with the help of a knob.

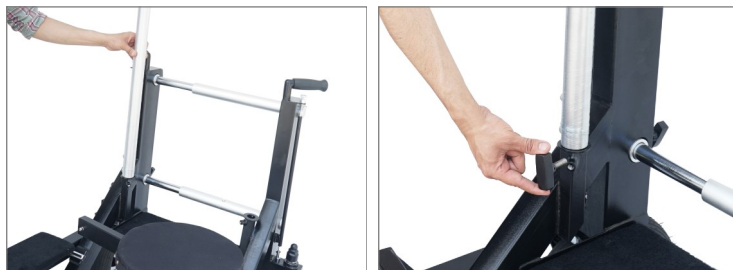

- Insert the square extension by sliding it into the speed rail and secure it with the extension knob by setting the position.



- Attach the back support seat to the square extension and tighten both the bolts of the back support seat with a 4mm Allen key.



- Insert the speed rail into the hole of the back-side of the main section and secure it properly with a knob.



- Pulling the rear steering will cause the wheels on the main section to rotate 360° or, releasing it will lock the wheel again.



- Manually lock and unlock the wheel brake of the main section with the help of a hand. As shown in the image.



- To narrow the size of the dolly, remove the floorboard.

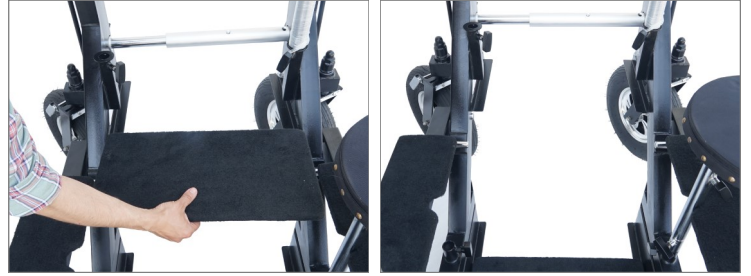

- Try using the push-pin button of the wide round extension, which will convert the size of the dolly to a slightly narrower size.

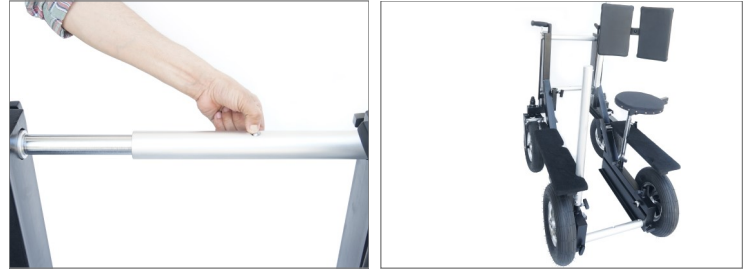

- After collapsing the round extension, slide the floor board and insert it, as shown in the image.

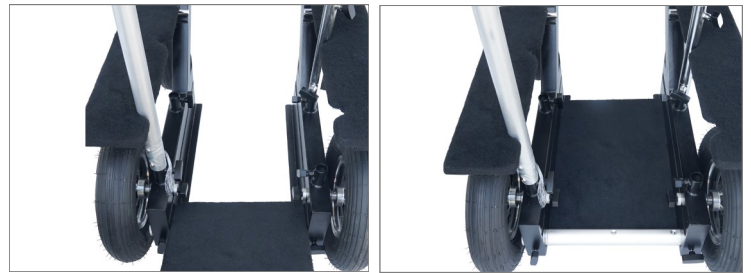

**YOUR PROAIM GLADIATOR ACTION DOLLY
ALL DRESSED UP AND READY TO GO!**



(SHOWN WITH OPTIONAL ACCESSORIES)

Warranty: We offer one year warranty for our products from date of purchase. Within this period of time, we will repair it without charge for labor or parts. Warranty doesn't cover transportation costs nor does it cover a product subjected to misuse or accidental damage. Warranty repairs are subjected to inspection and evaluation by us.

Liability: We are not liable for damage caused by products that we do not supply or from mishandling in transit, accident, misuse, neglect, lack of care of the product, or service by anyone other than our company.

Contact Us: In case of any kind of dissatisfaction, please Contact us immediately and we promise our utmost support and care until you use our product.