

# PR $\rightarrow$ AIM Dynamic Wedge Tilt Levelling Plate (P-MWP-D)

## Assembly Manual



### ■ What's In The Box

Please inspect the contents of your shipped package to ensure you have received everything that is listed below.

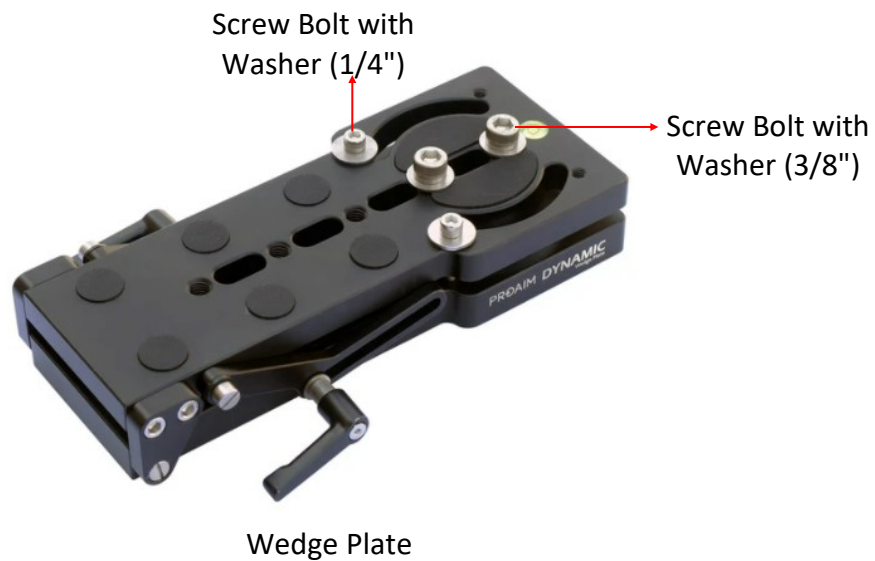

All rights reserved.

No part of this document may be reproduced, stored in a retrieval system, or transmitted by any form or by any means, electronic, mechanical, photo-copying, recording, or otherwise, except as may be expressly permitted by the applicable copyright statutes or in writing by the Publisher.

## ■ Wedge Plate Setup

- Remove all screw bolts on the wedge plate.



- To mount the wedge plate on the Orion geared head, join the thread of the plate with the screw bolt of the geared head. Secure the wedge plate by tightening the screw of the Orion geared head



- To position the wedge plate, loosen the knob on the plate and set the position as you desire.



- To mount the camera on the wedge plate, screw the bolt onto the wedge plate.



- Align together the wedge plate screw and the camera thread. Then, tighten it with the help of an Allen key.



- Image showing wedge tilt plate setup.



**YOUR PROAIM DYNAMIC WEDGE TILT LEVELLING PLATE  
ALL DRESSED UP AND READY TO GO!**



**(SHOWN WITH OPTIONAL ACCESSORIES)**

**Warranty:** We offer one year warranty for our products from date of purchase. Within this period of time, we will repair it without charge for labor or parts. Warranty doesn't cover transportation costs nor does it cover a product subjected to misuse or accidental damage. Warranty repairs are subjected to inspection and evaluation by us.

**Liability:** We are not liable for damage caused by products that we do not supply or from mishandling in transit, accident, misuse, neglect, lack of care of the product, or service by anyone other than our company.

**Contact Us:** In case of any kind of dissatisfaction, please Contact us immediately and we promise our utmost support and care until you use our product.