

# PROAIM Breeza Video/Film Camera Dolly Slider with Track Ends (DL-BRZA-01)

## Assembly Manual



### What's In The Box

Please inspect the contents of your shipped package to ensure you have received everything that is listed below.



All rights reserved.

No part of this document may be reproduced, stored in a retrieval system, or transmitted by any form or by any means, electronic, mechanical, photo-copying, recording, or otherwise, except as may be expressly permitted by the applicable copyright statutes or in writing by the Publisher.

## End Spacers Assembly

- To insert a track in the end spacers, first loosen the knobs of the clamp and then slide up the clamp to easily fit the track.
  - Insert a 4ft track into the clamp. Once the track is properly fitted into the clamp, tightly secure it with the knob, as shown in the image.
  - The same process is to be followed for the other track.
- NOTE:** It comes with track-ends for overall secure and smooth track running.



- The height of the end feet of the end spacers can be adjusted according to your setup requirement with the help of a knob.
- The end feet can be used in both, Hi-Hat and Low-Hat mode accordingly.



## Breeza Dolly Setup

- Now place the breeza dolly onto the 4ft track. The handles part of the dolly platform should be inside of the track as shown. Make sure all wheels are aligned correctly on the track and dolly runs smoothly.

**NOTE:** Proaim Breeza Compact Portable Slider Dolly integrates the latest technology with supreme quality to maximize your creative potential.



## Anti-Tilt Safety Brake Assembly

- Loosen the knob to properly open the safety brake.



- Mount the Safety Brake on side of the Breeza dolly platform. Adjust the position of the bracket so it goes under the track to prevent the platform from tilting out.



- Properly secure with a knob after mounting the safety brake. Follow the same process on the other side.

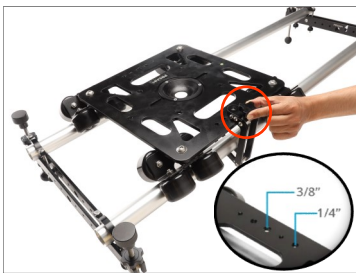

- The dolly platform already has a 100mm bowl adapter mount. To mount a 75mm bowl, first loosen the screws using an Allen key and remove the 100mm bowl.

**NOTE:** The Breeza dolly platform is designed with a Bowl mount 75mm, 100mm, and an flat base mount.



- Now mount a 75mm bowl adapter, insert the screws and properly secure the adapter with the help of an Allen key.



- The 75mm bowl adapter is mounted on the dolly platform, as shown in the image.

**NOTE:** It has a 16-wheel design with floating trucks that gives smooth, squeak-free move on a straight or curved track.



## Mount Fluid Head on the Bowl Adapter

- Insert the fluid head (**Not Included**) into the bowl through a screw.

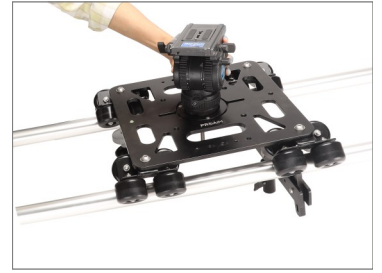
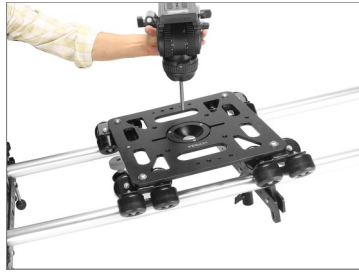

- After mounting the fluid head on the bowl, secure it properly by inserting the locking knob from the bottom side.



- After properly securing the fluid head (**Not Included**), mount a camera (**Not Included**) on it.

**NOTE:** Breeza Dolly Slider is sturdy enough to take a massive payload. And the end-clamps mount tripods and light stand in seconds. It also includes soft-grip rubber ball feet, support bracket, and safety wheels that give overall secure, leveled & greater performance.



- To mount the flat plate, first remove the 75mm bowl adapter from the dolly platform. For this, use an Allen key, loosen all the screws and then take out the 75mm bowl adapter.



- Mount the flat plate on the dolly platform, then insert the screws by aligning to the bottom and properly tighten.



- Mount the fluid head (**Not Included**) onto the flat plate and to properly secure, insert a bolt from the middle/centre of the bottom, as shown in the image.





- After properly securing the fluid head **(Not Included)**, mount a camera on it.



## 8ft Track Setup

- Mount the end spacers onto the stand **(Not Included)** and tighten with the help of a knob.

**NOTE:** If you need higher level shots, then you can put end spacers on Stands.



- Insert an 8ft track into the clamp. Once the track is properly fitted into the clamp, secure it with the help of a knob, as shown in the image. Follow the same process on the other side.



- Mount the Centre Support Spacer onto the stand. After mounting the spacer onto the stand **(Not Included)**, properly secure it with a knob.



- Attach the Centre Support spacer under the centre of the track system help of a Support stand **(Not Included)**.



- The 8ft track is now mounted on the centre support spacer.



- Now place the breeza dolly onto the 8ft track. The handles part of the dolly platform should be inside of the track as shown. Make sure all wheels are aligned correctly on the track and dolly runs smoothly.



- Mount the Safety Brake on side of the Breeza dolly platform. Adjust the position of the bracket so it goes under the track to prevent the platform from tilting out.

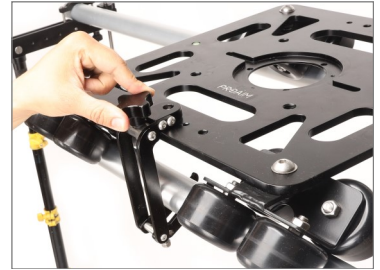

## ■ Underslung Camera Setup

- To mount the camera (Not Included) under-slung, attach the bowl adapter aligning the bottom threads, then insert the screws and properly tighten using an Allen key.

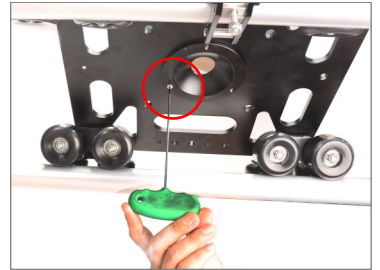
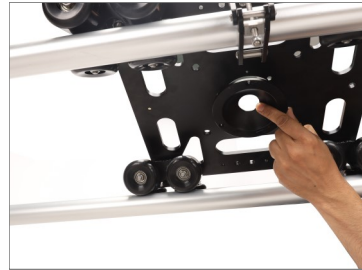

- Then attach the fluid head (Not Included) to the bowl adapter, as shown in the image.

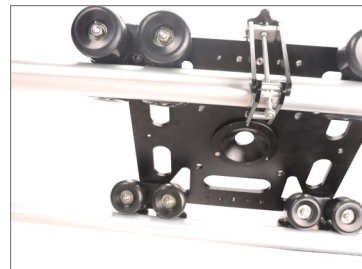

- To secure the fluid head (Not Included) from the bottom, insert the locking knob from the top and secure it properly.



**NOTE:** The whole dolly system is Quick & Easy to Set up for a steady workflow. It saves a lot of your valuable production time.



**YOUR PROAIM BREEZA VIDEO/FILM CAMERA DOLLY SLIDER WITH TRACK ENDS  
ALL DRESSED UP AND READY TO GO!**



**(SHOWN WITH OPTIONAL ACCESSORIES)**

**Warranty:** We offer one year warranty for our products from date of purchase. Within this period of time, we will repair it without charge for labor or parts. Warranty doesn't cover transportation costs nor does it cover a product subjected to misuse or accidental damage. Warranty repairs are subjected to inspection and evaluation by us.

**Liability:** We are not liable for damage caused by products that we do not supply or from mishandling in transit, accident, misuse, neglect, lack of care of the product, or service by anyone other than our company.

**Contact Us:** In case of any kind of dissatisfaction, please Contact us immediately and we promise our utmost support and care until you use our product.