

The Guide of **MAX BOAT PUMP**

FLEXTAIL™

— OP07-NR02 —

Catalogue

Catalogue	18
Function demonstration	19
Nozzle	20
Parameter information	21
Operation instructions	22-27
Product introduction	28-32
Guarantee card	33

Function demonstration

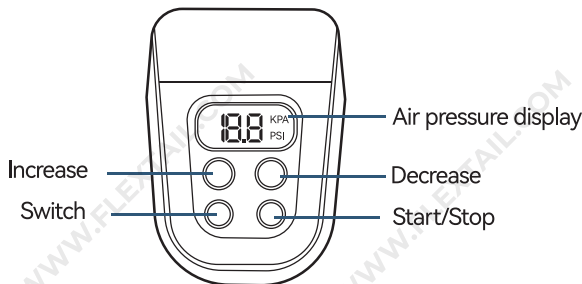
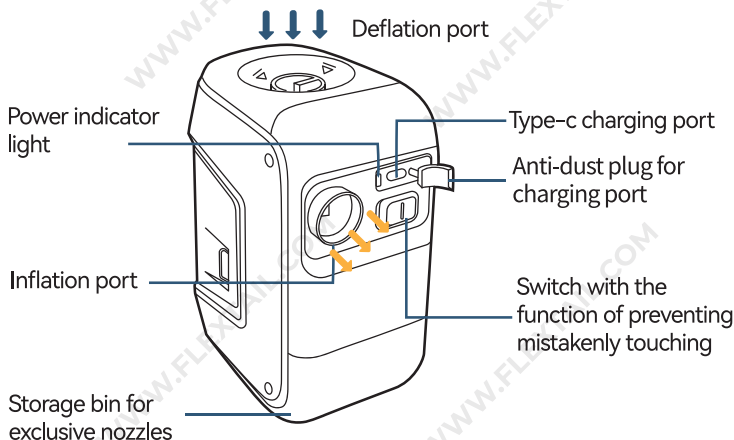

Nozzle

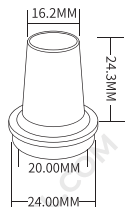
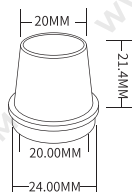
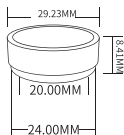
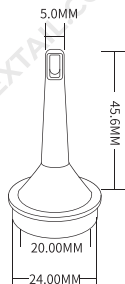
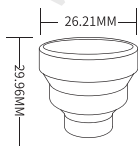

Parameter information

Weigh	455g±10
Dimension	68*95*128mm
Deflation pressure	10kPa
Inflation pressure	12kPa (1.7psi)
Inflation speed	142L/min
Rated power	72W
Rated current	6A
Endurance	25min
Battery capacity	2500mAh
Package content	MAX BOAT PUMP/ Type-C cable /Manual / Storage bag / Nozzles
	MAX BOAT PUMP / Type-C
Certification	CE , FCC , RoHS

Operation instructions

Operation instruction for switch with the function of preventing mistakenly touching

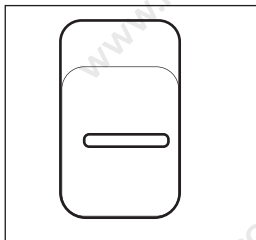

To prevent unintended activation, the switch adopts an anti-mistakenly touching design, please read the following instructions carefully before use.

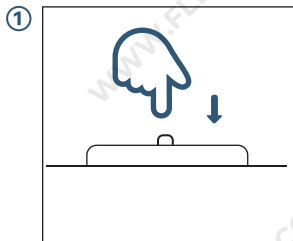

First press the unlock button.

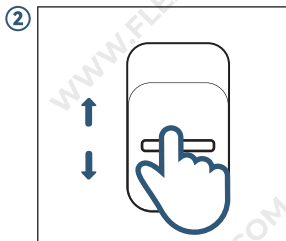

Then toggle the switch button.

Operation interface

①



Display area

0.1psi/1.0kPa-1.7psi/12.0kPa/ The default display is 1.0 psi.
The air pressure display range is (1.0kPa)-1.7psi(12.0kPa).

②

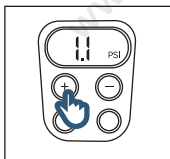

“+”

Short press to increase with 0.1psi (1kpa), and long press to increase with 0.1psi (1kpa) continuously.

③

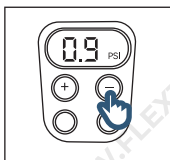

“-”

少/Short press to decrease with 0.1psi (1kpa), and long press to decrease with 0.1psi (1kpa) continuously.

④

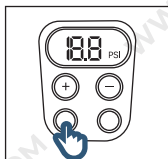

Switch, switch the pressure units kpa and psi.

⑤

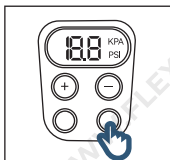

ON/OFF/
Start/Stop, Start or stop the pump core.

Storage bin for exclusive nozzles

Note: There are two exclusive air nozzles in the storage bin by default. There may be abnormal sounds caused by improper fitting when storing other air nozzles.

①

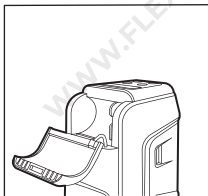

1. Open the storage bin.

②

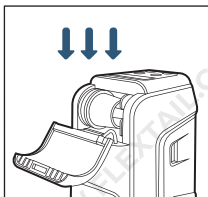

2. Pile the two air nozzles and put them into the storage bin.

③



3. Close the storage bin.

Inflate the inflatable boat

①

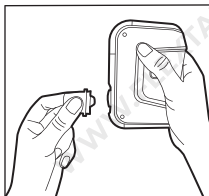

1. Choose a suitable nozzle and install it on the inflation port of the pump.

②

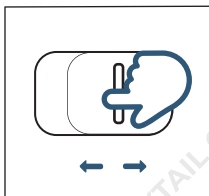

2. Turn on the switch with the function of preventing mistakenly touching.

③

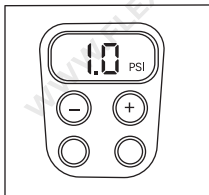

3. Set the desired air pressure.

④

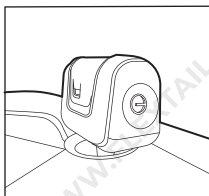

4. Connect to the air valve of the inflatable boat. Press the Start/Stop button to inflate. The pump will be off automatically when it reaches the preset air pressure.

Deflate the inflatable boat

①

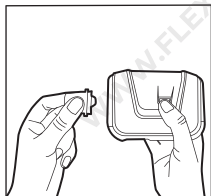

1. Choose a suitable nozzle and install it on the deflation port of the pump.

②

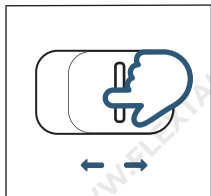

2. Turn on the switch with the function of preventing mistakenly touching.

③

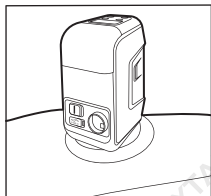

3. Connect to the air valve of the inflatable boat. Press the Start/Stop button to deflate. Please press the Start/Stop button to turn off the pump after finishing deflating.

Power indicator schematic

Low battery indication



When the red light is on, it means the pump needs to be charged.

Charging indication



<43°C (110°F)

>-17°C (0°F)

>0.1psi (0.69kpa) <1.4psi (9.7kpa)

Product introduction

MAX BOAT PUMP Pump for inflatable

Product (As shown in the drawing figures)

 Operation (As shown in the drawing figures)

 Storage and transportation (As shown in the drawing figures)

 Care and maintenance (As shown in the drawing figures)

Troubleshooting

If the product does not work:

- Please check if there is water or other liquid on the surface.
- Check whether the fan blade is stuck.
- Press the switch repeatedly.
- Other questions? Please contact FLEXTAIL Technology agents or contact us: service@flectailgear.com

Reserve piece

There are no user-replacement parts for this product other than the nozzles and charging cable.

Warnings

- Do not use it for more than 10 minutes. Begin the next work after 5 minutes.
- Do not put it under the water for a long time.
- Keep the inflation port or the deflation port clean.
- Do not put your finger into the inflation port or deflation port when the pump is working.
- Do not watch the inflation port or deflation port when the pump is working.
- Children under the age of 12 need to have adults' supervision when using the pump.
- Please check whether the air pump is functioning properly before use.

FLEXTAILGEAR shall not be liable for any direct, indirect, incidental or other damages arising out of or caused by the use of the products. Users are responsible for their own actions and all the consequences that result from these actions.

Warranty terms

For the defects in material and workmanship of the product, the original retail purchaser of this product will be provided a warranty service for one year based on purchase data by FLEXTAILGEAR.

If the Buyer discovers a covered defect, the buyer should return the product to the place of purchase. If this is not available, please return the product to the address specified by us. We will repair or replace the modified product at our discretion following the warranty terms.

We assume the above responsibilities in accordance with the essential guarantee terms during the warranty period. After the expiration of the warranty, the service will no longer be provided. We reserve the right to require proof of purchase for all warranty applications.

Warranties Exclusions

We do not warranty products against normal wear and tear, unauthorized modifications or alternations, improper use, improper maintenance, accident, misuse, negligence, damage, or if the Product is used for a purpose for which it was not designed. This warranty gives you specific rights, and you may also have other rights which vary from state to state. Except for expressly stated in this warranty, we shall not be liable for direct, indirect, incidental, or other types of damages arising out of, or resulting from the use of Product. This warranty is in lieu of all other warranties, expressed or implied, including, but not limited to, implied warranties of merchantability or fitness for a particular purpose (some states do not allow the exclusion or limitation of incidental or consequential damages or allow limitations on the duration of an implied warranty, so the above exclusions may not apply to you.)