

GLO24K

UNLEASH THE POWER OF GOLD
3D SPA Pro Massager+



TO MAXIMIZE RESULTS SCAN HERE
For more information about the product please visit
WWW.GLO24K.COM
Dist.by Y&E Ent.,LLC
Atlanta,GA 30338 USA
71-75 Shelton Street,London,UK
Hauptstrasse 22 Neugersdorf 02727,Germany

PRODUCT INTRODUCTION

GLO24K 3D SPA Pro Massager+ is an innovative 4 Head Beauty Massager designed to provide a luxurious SPA -like results at the comfort of your own home. With its 3D-shaped massage heads rotation system and advanced technological features, this cutting-edge beauty tool can assist in revitalizing and rejuvenating the skin on the face, neck, around the eyes, and other body parts for a radiant, youthful appearance. GLO24K 3D SPA PRO Massager+ is ergonomically designed, easy to use, and for all skin types. Use as needed, 5-10 minutes at a time.

Massage and Vibration technologies are widely used in the beauty industry and can help in accelerating blood circulation, improving skin conditions, battling fatigue and stiffness, and reviving and invigorating skin and muscles.

LED technology in multiple light colors means different wavelengths that each has different benefits to skincare. Overall, LED technology can help in accelerating skin metabolism, improving skin elasticity and flexibility, enhancing Collagen reproduction, and rejuvenating and firming the skin.Red LED light can assist with battling the visible signs of the aging process. Yellow LED light can help soothing and balancing the skin. Blue LED light can help in improving skin texture and tone.

EMS Micro-current technology can help in lifting, and tightening the skin.

Radio Frequency (RF) technology can help in improving overall skin' s health and appearance and reducing the visibility of wrinkles, fine lines, and sagging skin.

2/

ABOUT THE PRODUCT

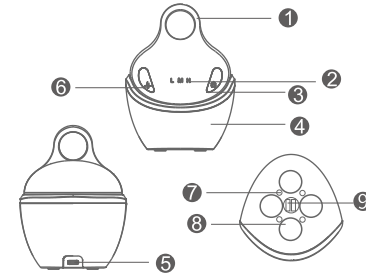

- 1 Finger Ring Holder
- 2 Modes Level Indication Light
- 3 On/Off Switch (Color Light Switch)
- 4 Charging Base
- 5 USB Socket
- 6 EMS/RF Switch
- 7 LED Lamp
- 8 Massage Heads
- 9 Charging Point

ELECTRICAL SCHEMATIC DIAGRAM

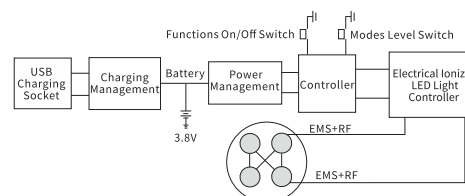

3/

FUNCTION PARAMETER TABLE

EMS (Micro -Current)	90Khz (L,M,H)
RF (RADIO FREQUENCY) MODES	1MHz, Thermal Massage (L,M,H)
LED Color Light Modes	Blue Light, Yellow Light, Red Light, Flash Light, All Lights on
Modes of Massage	High, Medium, Low Speeds Level

HOW TO USE

This product is suitable to use on the face and around the eyes. It is also suitable to use on the neck, shoulders, biceps, and other areas that will benefit from a body massage.

WHEN USED ON THE FACE WE RECOMMEND TO APPLY A FACIAL CREAM OR SERUM PRIOR AND TO LET IT ABSORB IN ORDER TO MAXIMIZE RESULTS.

1. Turn ON to get to MODE I of 4 Head Massage and LED Light. 4 Red LED lights will turn on and the massage heads will start working at low speed.

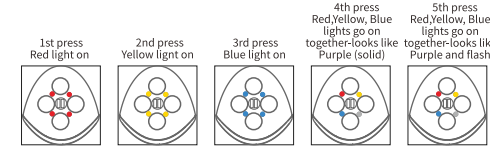

Notes:

- When press the 6th time the LED lights recycle back to red light
- When all LED lights are on together (looks like purple) and flash- it can assist in allowing the skincare absorbing deeper and better.
- EACH LED LIGHT HAS ITS OWN WAVELENGTH AND AS A RESULT DIFFERENT SKINCARE BENEFIT.

To turn to Mode II: 4 Head Massage + LED Light + EMS + RF -> press the EMS/RF button.

4/

The On/OFF button turns this product on and off and controls the LED lights for Mode I. The EMS/RF button controls the EMS/RF status and adjusts she speed and intensity of the massage heads, EMS, and RF between Low/Medium/High (L/M/H). When these letters are in Blue it indicates Mode I (LED & Massage) and when the letters are Red it indicated Mode II (LED, Massage, EMS, and RF).

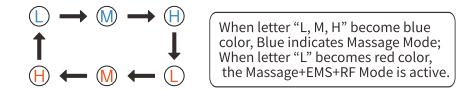

When letter "L, M, H" become blue color, Blue indicates Massage Mode; When letter "L" becomes red color, the Massage+EMS+RF Mode is active.

The methods to use this product can be referred as below:



Massage your skin in upward/downward, and circular motions. Recommended usage time is up to 10 minutes per application.

5/

Facial Care

Recommended usage time is up to 10 minutes per application and 2-3 minutes per each area.

Move



Stay

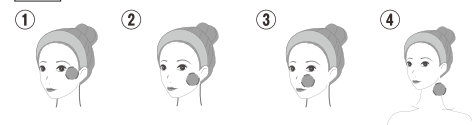

Reminder:

- * Please do not use on the larynx
- * Massage your skin in upward/ downward, and circular motions. Change modes as needed. Note that each individual reacts differently to massagers so adjust the application per your own personal comfort and joy.

Neck, Shoulder, and Body Care

Recommended usage time is up to 10 minutes per application and 2-3 minutes per each area.



Do not apply and press on the larynx area.

6/

Massage your skin in upward/ downward, and circular motions. Change modes as needed. Note that each individual reacts differently to massagers so adjust the application per your own personal comfort and joy.

SPECIFICATION

Product name	3D SPA Pro Massager+		
Input voltage	5V---	Model No.	
Battery capacity	1050mAh	Rated Power	8W
Net weight	227g	Charging time	5 hours
Product size	92×93×123mm	Working time	80 mins

TIPS:

1. We recommend applying a facial cream or serum prior and to let it absorb in order to maximize results.
2. Keep massage heads in touch with skin, and adjust the positions to utilize its utmost function.

7/

PRODUCT NOTES

MAINTENANCE

1. Please take off your jewelry or ornaments before massage.
2. Clean massage heads with a towel or cloth or wipe before or after any use.
3. Charging indication (M) : Red light in charging mode and green light after full charge.
4. This product is not water resistant. Keep it in a dry environment.

SPECIAL REMINDER

1. Do not press skin too hard, especially easily clamped parts like neck, chin and so on.
2. Apply gel or skin care products on the skin before massage.
3. In order to prevent injury, Please do not insert finger in the middle of massage heads while using.
4. This product is not for use for children.

8/

CAUTION

- * Do not use or store this product around wet environment or high temperature.
- * Please pull up your hair before using, and avoid getting your hair caught.
- * Please keep it away from children.
- * Do not disassemble or repair the product.
- * Do not use this product before consulting with your physician if you are pregnant, have fractures, injuries, or had plastic surgeries, have inflammation, allergies, have sensitive skin, undergoing any medical procedures, have heart condition.

IN THE RARE EVENT THAT YOU FEEL UNCOMFORTABLE, OR THE SKIN BECOMES IRRITATED PLEASE STOP USING THE PRODUCT AND CONTACT THE MANUFACTURER.

9/

GLO24K
UNLEASH THE POWER OF GOLD
3D SPA Pro Massager+

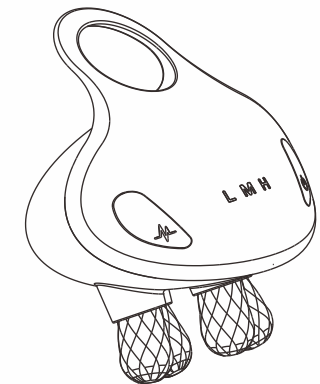

USER MANUAL
Please read this User Manual before using this Beauty Tool

70.00 mm

102.00 mm

尺寸: 102x70mm 材质:120g双胶纸

背面

封面