



Wing Handheld Steadycam (P-WNG)



Setup and Operational Manual

All rights reserved

No part of this document may be reproduced, stored in a retrieval system, or transmitted by any form or by any means, electronic, mechanical, photocopying, recording, or otherwise, except as may be expressly permitted by the applicable copyright statutes or in a writing by the publisher.

IT IS IMPORTANT THAT YOU READ AND UNDERSTAND THIS GUIDE BEFORE ATTEMPTING TO ASSEMBLE AND USE YOUR NEW PROAIM WING HANDHELD STEADYCAM. SHOULD YOU NEED ADDITIONAL INFORMATION, TECHNICAL ASSISTANCE IS AVAILABLE 'ON LINE' BY CONTACTING OUR SALES REPRESENTATIVE.

INTRODUCTION

The new HAND HELD PROAIM WING with new design of weight disc and gimbal. The PROAIM WING is a lightweight stabilizer for cameras up to 3.5kg. The Quick release plate of the PROAIM WING HANDHELD STEADYCAM is High quality quick release universal system for camera.

WHAT'S IN THE BOX

Please inspect the contents of your shipped package to ensure you have received all that is pictured and listed below. The grey foam shipping /storage container has been especially designed to protect your purchase while in transit and is a good place to keep your PROAIM WING HANDHELD STEADYCAM when not in use.

CONTENTS OF SHIPPING BOX :

- PROAIM Wing Handheld stabilizer
- Quick Release plate with adapter
- 4 x Counter Weight discs
- Weight Shank
- Docking stand
- Handle
- Accessory Mounting plate
- Adapter for Accessory Mounting plate
- Storage Case



ASSEMBLING THE PROAIM WING HANDHELD STEADYCAM

- Screw-in the handle to the stabilizer Arm.



- Now loosen the red knob as shown in the image, remove the camera mounting plate and secure your camera on it with the help of screw driver.



If you wish to attach provided Quick release on the wing steadycam, follow these steps:

- Loosen the ratchet knob and release the QR plate by pressing the pin. Attach the camera plate of Wing Stabilizer to the base of QR Adapter.



- Re-attach the camera plate to Stabilizer and secure it by tightening the red knob as shown in the image.



- Secure your camera on QR plate, insert the camera set up to QR Adapter and tighten the ratchet knob to secure.



- Now attach the weight disc to weight shank as per your requirement. then loosen the red knob, insert the weight shank to the base of stabilizer and tighten the knob to secure.

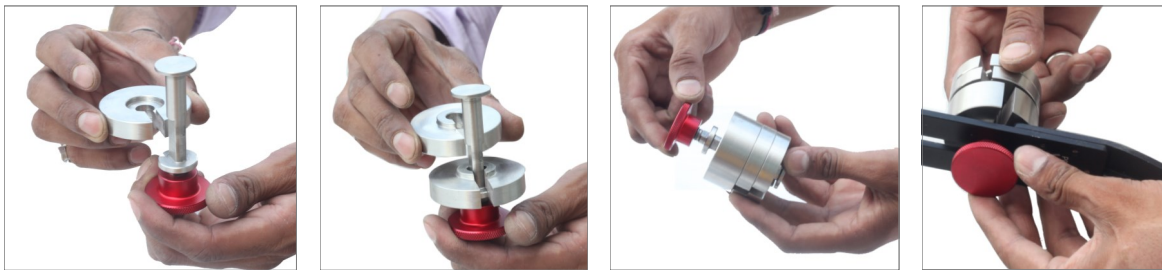

- Take the accessory mounting plate adapter & knob, attach accessory mount plate to stabilizer with the help of adapter and knob. Tighten it properly to secure.



- Place the handle of stabilizer on provided docking stand for balancing.



- You can adjust the handle back & forth for balancing.



- Camera plate has also back & forth adjustment for quick balancing.



MAINTENANCE

Bearing Maintenance

The Main Bearing on your PROAIM WING STABILIZER is of metal construction and partially enclosed by the Bearing assembly.

If after a period of time your bearings don't turn smoothly, lubricate with a minimum of light machine oil. Light lubricating oil can also be used on the Yoke and Handle Bearings.

Be sure to keep oil away from your camera, & clean up any over spill.

Cleaning

Do not use solvents or harsh cleaners of any kind on your PROAIM WING STABILIZER.

If the unit becomes dirty, use a damp soft cloth or sponge and a mild detergent to gently clean external parts.

Storage

Should you need to store your PROAIM WING STABILIZER for a long period of time then place the unit upright in a dry or low to normal humidity area whenever possible. If you are unable to find this kind of environment then we suggest you store the unit in an airtight plastic container or bag. Standing the unit upright is preferred as it alleviates stress on the system.

Practice makes perfect - Walking the line

Practice this simple exercise to master your PROAIM WING STABILIZER with professional results.

Using masking or gaffers tape, create a cross mark on a flat and even wall. The mark becomes your framing center. On the floor leading up to the cross mark, lay a straight tape line of about 20 feet. Practice walking the line, while keeping the cross mark center framed and in focus. With a bit of effort, dramatic fluid like movements will become second nature and provide production value to all your set ups.

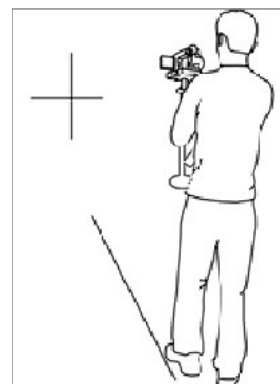
**Note:**

The PROAIM WING STABILIZER doesn't work under water, nor is it waterproof. Avoid direct exposure to rain, water spray or any harsh environment.

The bearings are not sand proof. Avoid getting dirt or sand in them.

**YOUR PROAIM WING HANDHELD STEADYCAM
ALL DRESSED UP AND READY TO GO****WARRANTY**

We offer a limited time warranty for our products. For Mechanical products we provide a 6 month warranty & for electronic products we provide a 3 month warranty from the date of purchase.

We will repair or replace your product, free of charge, in the event of a defect in materials or craftsmanship obtained during normal use or handling based on the user manual. Please note that we will not cover any shipping costs for returning the product to us. If any VAT or import duties are applied to the return, we will also charge these costs to the customer.

The warranty does not include, by the way of example, damage caused by products that we do not supply or from mishandling in transit, accident, misuse, neglect, lack of care of the product, or service by anyone other than our company.

We are not liable for incidental or consequential damages resulting from the use of the unit or occurring due to any breach of this warranty.

Replacement parts of the product will be provided at nominal cost (covering the cost price of the replacement parts only) to the customers after the Warranty Period has expired. We will cover the complete cost of sending replacement parts within the warranty period. After that, Nominal cost of the product & Actual shipping cost will be charged.

Do not send the unit to us without first getting a response and getting the approval to send back the item.

In case of any kind of dissatisfaction, we urge you to **Contact us** immediately and we shall do our best to help you out.

For any other assistance you can reach us via email.