



# ONE SMART BOX Twilight Struggle Organizer

TSOR01

Compatible with Twilight Struggle® including Twilight Struggle: Turn Zero expansion  
Assembly Guide



<https://smonex.com>

NOT A CHILDREN TOY  
**AGE 14+**

Created for:

- Twilight Struggle
- Twilight Struggle: Turn Zero

Twilight Struggle® is a registered trademark of GMT Games. Any mention of Twilight Struggle® is for reference purposes only. ALL RIGHTS RESERVED by their respective trademark holders. No challenge to any intellectual property rights is intended or implied by representations of compatibility and no endorsements of any of our products by any other company is implied or represented.



# ONE SMART BOX

## Twilight Struggle Organizer

TSOR01

Compatible with Twilight Struggle® including Twilight Struggle: Turn Zero expansion  
Assembly Guide

### Tips and tricks

- To assemble each tray you need a wood glue for extra strength. (We recommend Titebond 2 Wood Glue or Beacon 527)
- Please make sure you assembled each tray correctly before gluing it together.
- Use stationery knife to cut the bits that connect details to the frame.
- Remove the details from the frame with a rotational motion along the axis formed by the bits you just cut.
- Use stationery knife and sandpaper to remove all the remaining connection bits.
- You may fix the box with rubber bands after gluing it. This will save you time and simplify the assembly.
- Leave your finished insert overnight to dry completely.

### Assembly Supplies



Wood-glue



Stationery knife



Hammer



Cotton swab



Rubber bands

If something is damaged or broken, please do not return the whole set. Contact us directly on email [info@smonex.com](mailto:info@smonex.com) or our website [smonex.com](http://smonex.com). Any questions or issues with the Smonex products, we'll do our best to help you. We want our customers to be completely satisfied.

**IMPORTANT:** Assemble each tray one by one. Please DO NOT take out all the parts from the sheets and mix them. Even though some parts look similar, they are not interchangeable.



# ONE SMART BOX

## Twilight Struggle Organizer

TSOR01

Compatible with Twilight Struggle® including Twilight Struggle: Turn Zero expansion  
Assembly Guide

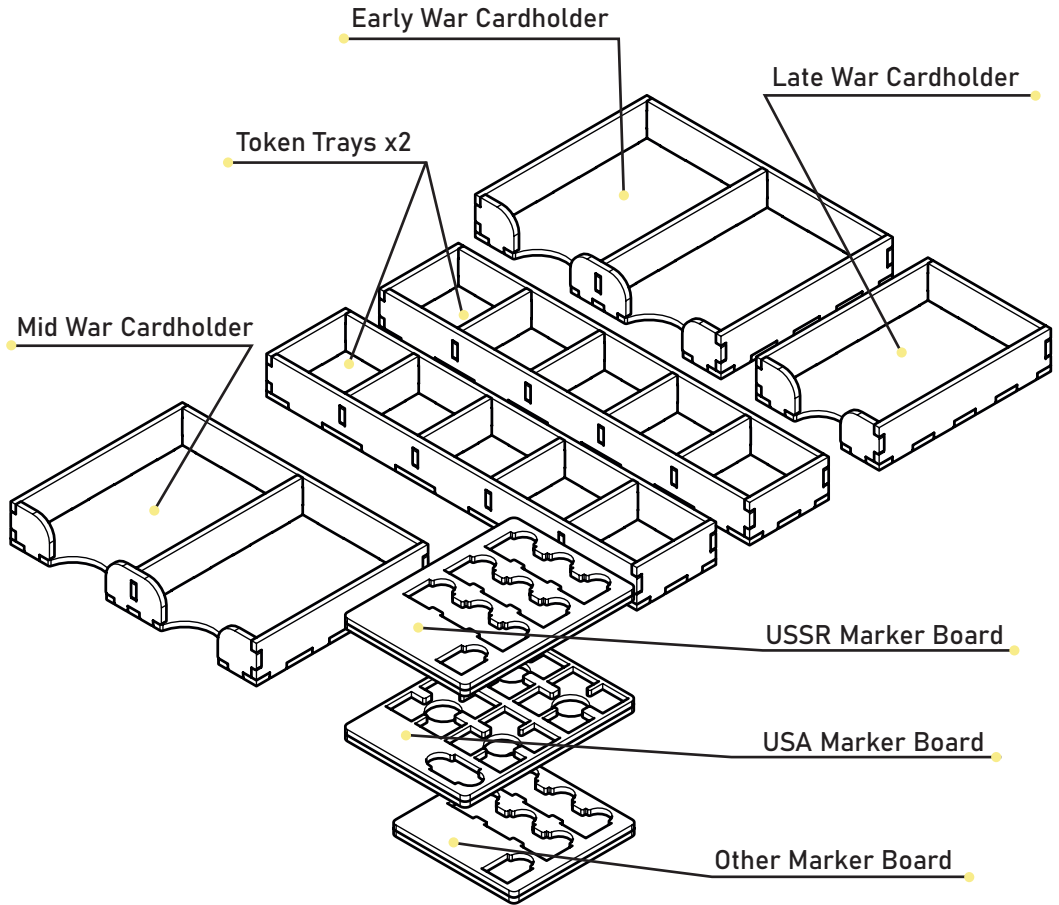



# ONE SMART BOX

## Twilight Struggle Organizer

TSOR01

Compatible with Twilight Struggle® including Twilight Struggle: Turn Zero expansion  
 Assembly Guide

- Brief assembly instructions:**
1. Unpack and arrange the sheets in order.
  2. Compare details on the sheets with details in the pictures of the guide.
  3. Study the pictures of unassembled product.
  4. Start your assembly, taking the necessary parts out of the sheets in a certain order.

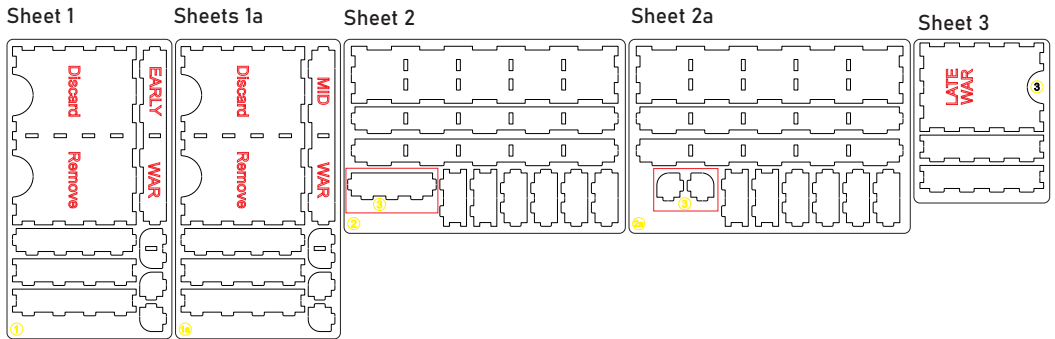

Board sheets

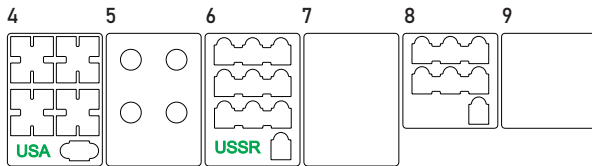

### Legend:

- Highlighted details to be extruded
- Details not used in this assembly
- Details to be connected without glue
- Details to be glued

### Components:

- 5 sheets extrusion molds
- 6 board sheets
- 1 sandpaper for stripping parts
- Assembly guide



# ONE SMART BOX

## Twilight Struggle Organizer

TSOR01

Compatible with Twilight Struggle® including Twilight Struggle: Turn Zero expansion  
Assembly Guide

### Early War Cardholder

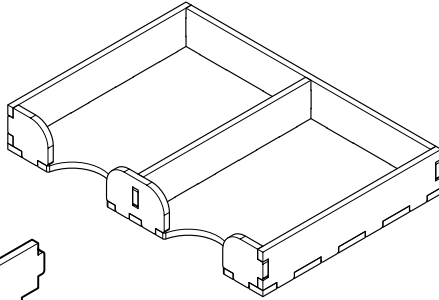

Sheet 1

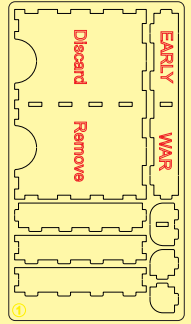

Step 1

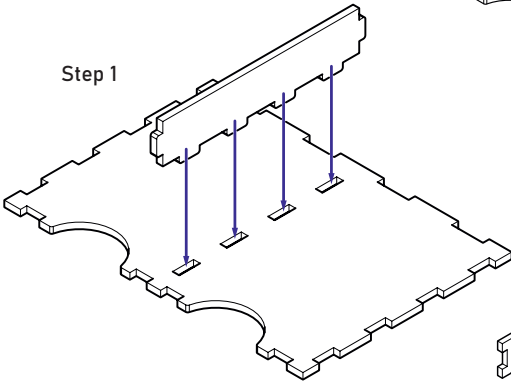

Intended for Early War cards.

Step 2

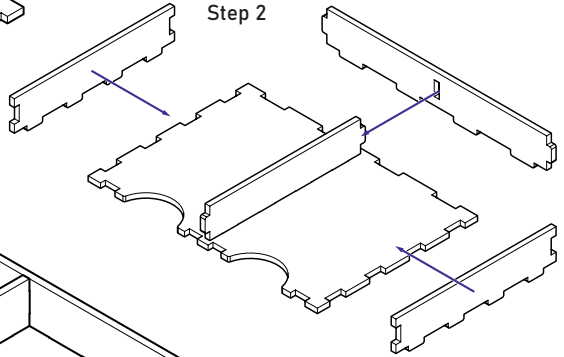

Step 3

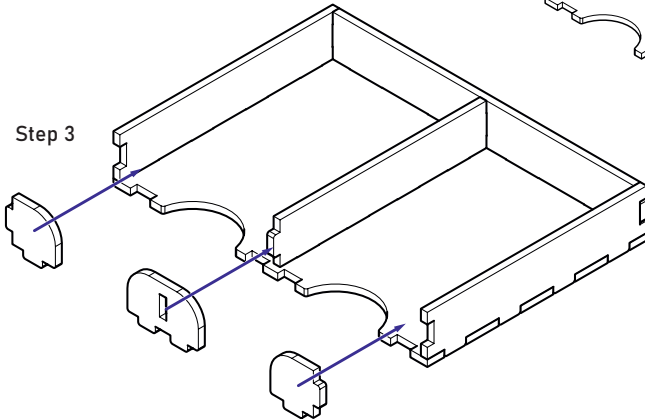



# ONE SMART BOX Twilight Struggle Organizer

TSOR01

Compatible with Twilight Struggle® including Twilight Struggle: Turn Zero expansion  
Assembly Guide

## Mid War Cardholder

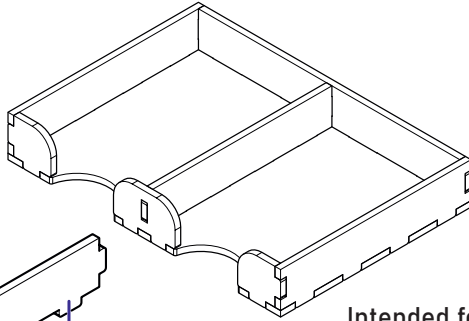

Sheet 1a

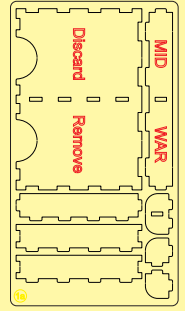

Step 1

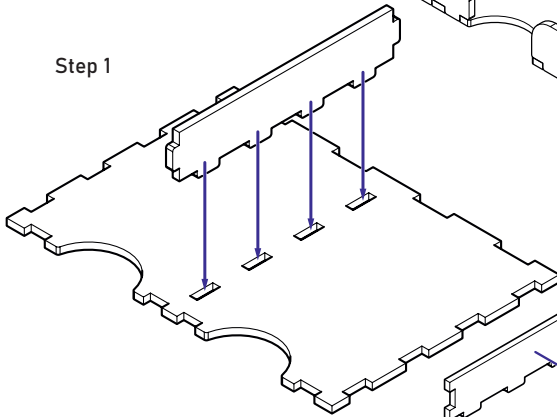

Intended for Mid War Cards.

Step 2

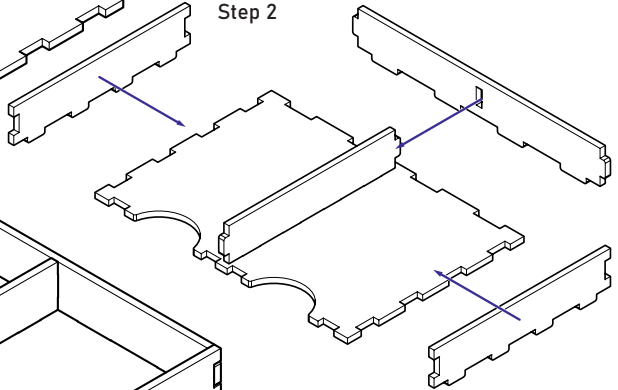

Step 3

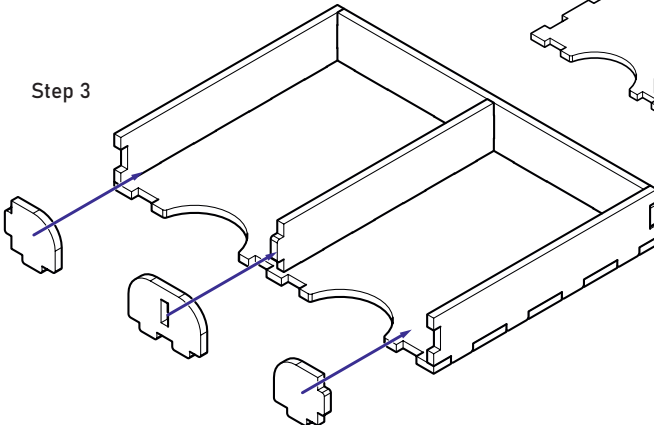



# ONE SMART BOX Twilight Struggle Organizer

TSOR01

Compatible with Twilight Struggle® including Twilight Struggle: Turn Zero expansion  
Assembly Guide

## Token Tray 1

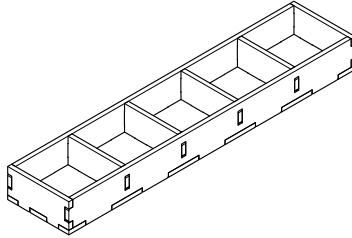

Sheet 2

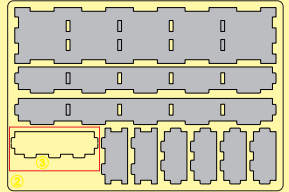

Intended for Markers.

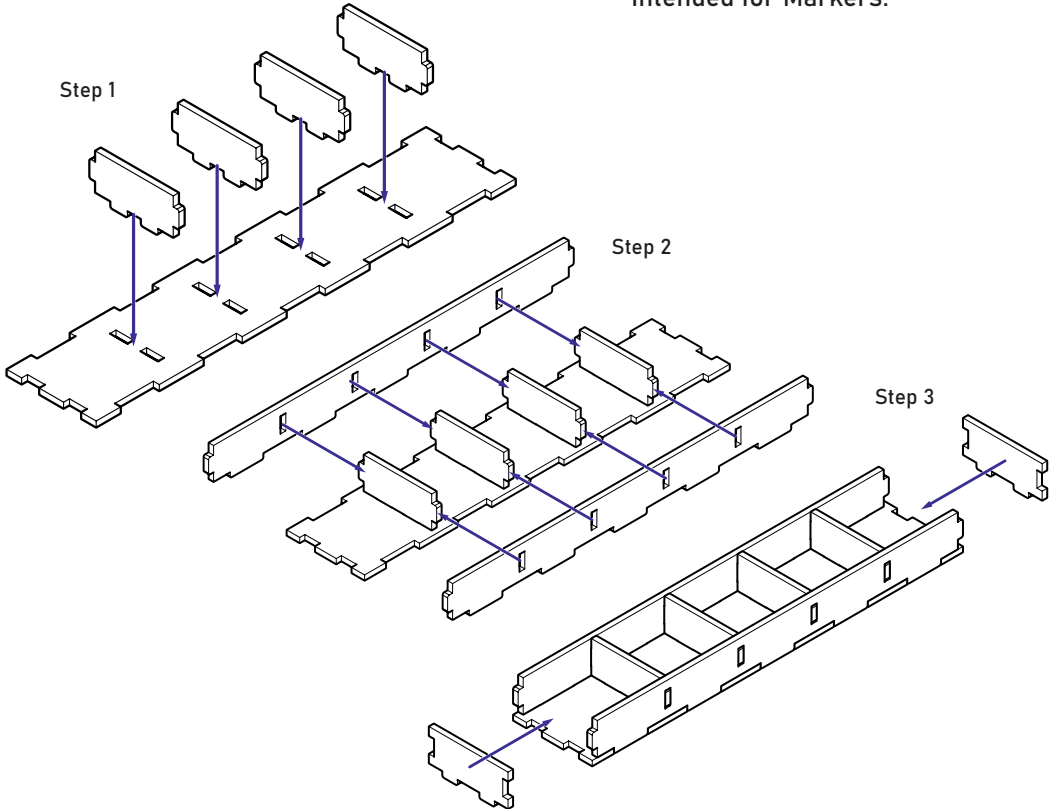



# ONE SMART BOX

## Twilight Struggle Organizer

TSOR01

Compatible with Twilight Struggle® including Twilight Struggle: Turn Zero expansion  
Assembly Guide

### Token Tray 2

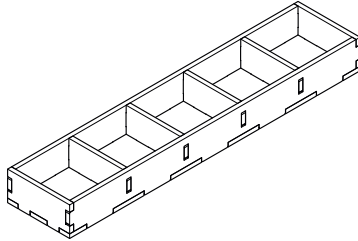

Sheet 2a

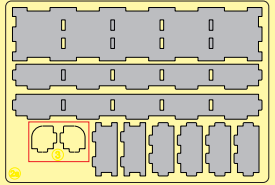

Intended for Markers.

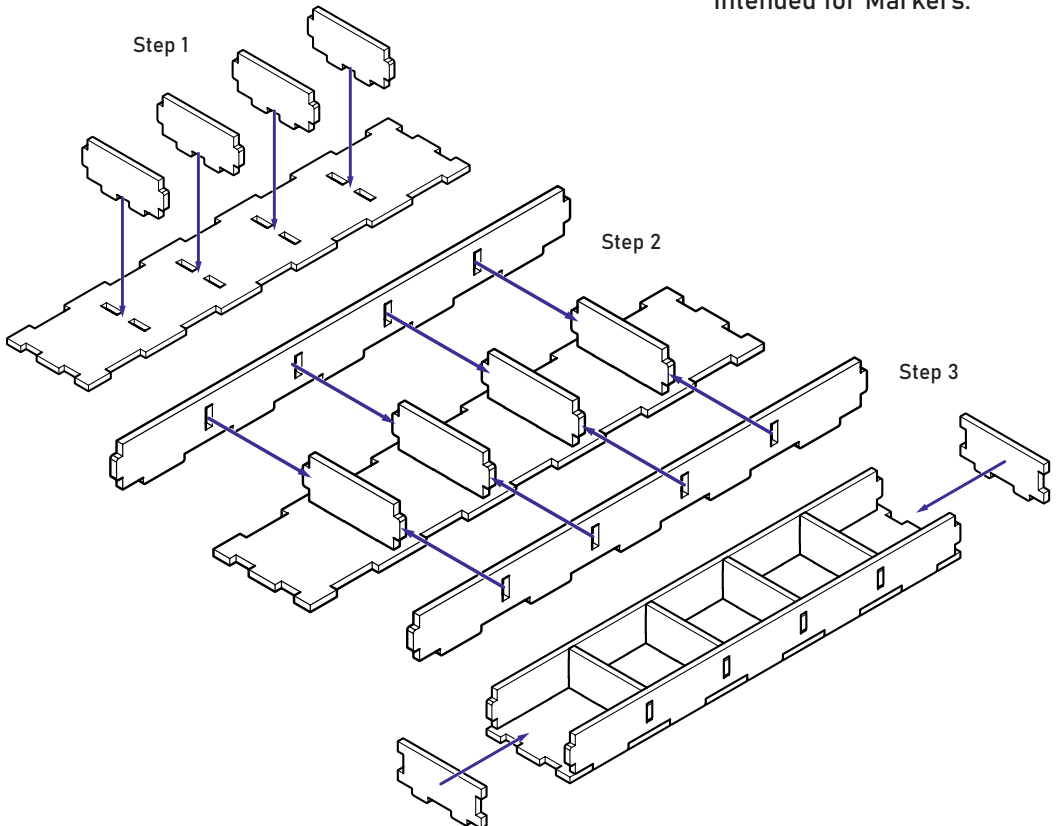





# ONE SMART BOX Twilight Struggle Organizer

TSOR01

Compatible with Twilight Struggle® including Twilight Struggle: Turn Zero expansion  
Assembly Guide

## Late War Cardholder

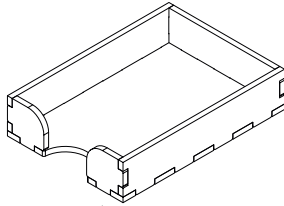

Sheet 3

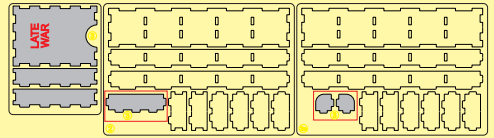

Step 1

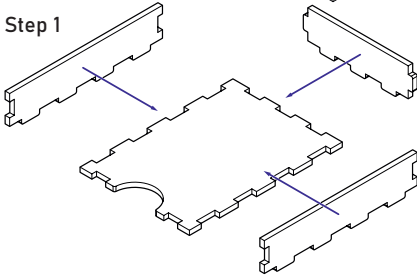

Intended for  
Late War  
Cards.

Step 2

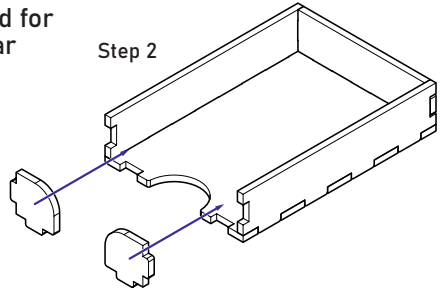

## USA Marker Board

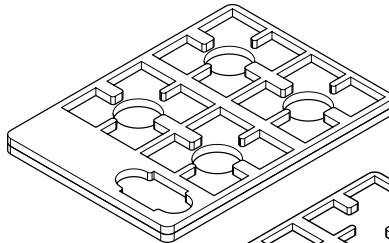

Sheets 4, 5

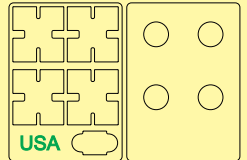

Step 1

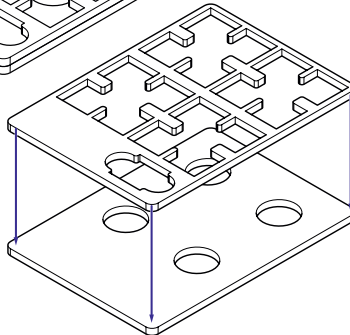

Intended for US player's  
markers.



# ONE SMART BOX Twilight Struggle Organizer

TSOR01

Compatible with Twilight Struggle® including Twilight Struggle: Turn Zero expansion  
Assembly Guide

## USSR Marker Board

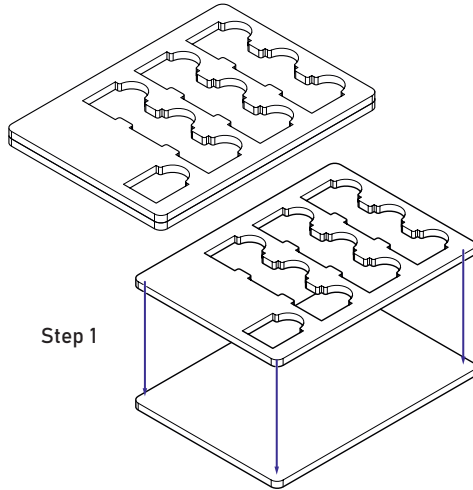

Sheets 6, 7

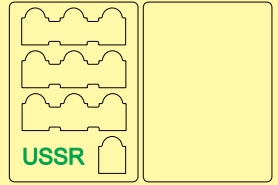

Step 1

Intended for USSR  
player's markers.

## Other Markers

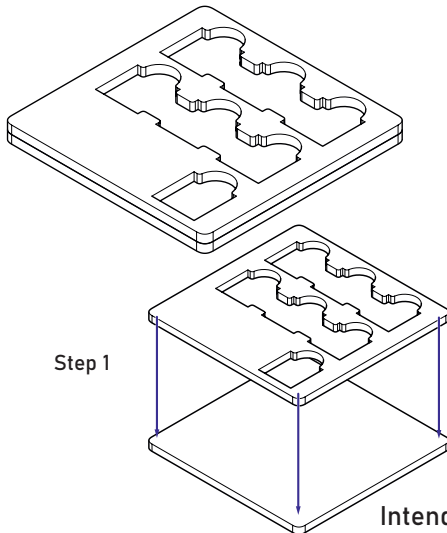

Sheets 8, 9

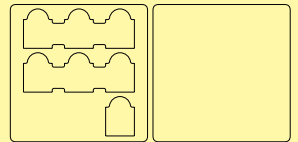

Step 1

Intended for other markers.



ONE SMART BOX

Some other SMONEX products:  
The Castles of Burgundy® (20th Anniversary Edition)  
Organizer CBOR01



Settlers of Catan® Game Board Set CNOR01





ONE SMART BOX

Welcome to <https://smonex.com>.

If something is damaged or broken, please do not return the whole set. Contact us directly on email [info@smonex.com](mailto:info@smonex.com) or our website [smonex.com](https://smonex.com).

Any questions or issues with the Smonex products, we'll do our best to help you. Your satisfaction of it is our top priority.

Thanks for choosing Smonex product. We would be grateful for your feedback, which inspires us and helps to develop further. We'll gladly help you on any matter if you contact us on [info@smonex.com](mailto:info@smonex.com).

Share your photos with #smonex and follow us for all the updates:

 <https://www.facebook.com/Smonexcom>

 [https://www.instagram.com/smonex\\_com/](https://www.instagram.com/smonex_com/)

 [https://twitter.com/Smonex\\_com](https://twitter.com/Smonex_com)

 [https://www.pinterest.com/smonex/\\_shop/](https://www.pinterest.com/smonex/_shop/)

 <https://www.youtube.com/c/SmonexSmartOneBox>



Scan QR-code to visit or follow Smonex.