



ONE SMART BOX Teotihuacan® Organizer

TNOR01

Compatible with Teotihuacan® board game and its expansions
Assembly Guide



<https://smonex.com>

Created for:

- Teotihuacan
- Teotihuacan: Shadow of Xitle
- Teotihuacan: Expansion Period
- Teotihuacan: Late Preclassic Period

NOT A CHILDREN TOY
AGE 14+

Teotihuacan® is a registered trademark of NSKN Games. Any mention of Teotihuacan® is for reference purposes only. ALL RIGHTS RESERVED by their respective trademark holders. No challenge to any intellectual property rights is intended or implied by representations of compatibility and no endorsements of any of our products by any other company is implied or represented.



ONE SMART BOX

Teotihuacan® Organizer

TNOR01

Compatible with Teotihuacan® board game and its expansions
Assembly Guide

Tips and tricks

- To assemble each tray you need a wood glue for extra strength. (We recommend Titebond 2 Wood Glue or Beacon 527).
- Please make sure you assembled each tray correctly before gluing it together.
- Please remember that the engravings should be on the outside of the boxes.
- Use stationery knife to cut the bits that connect details to the frame.
- Remove the details from the frame with a rotational motion along the axis formed by the bits you just cut.
- Use stationery knife and sandpaper to remove all the remaining connection bits.
- You may fix the box with rubber bands after gluing it. This will save you time and simplify the assembly.
- Leave your finished insert overnight to dry completely.

Assembly Supplies



Wood-glue



Stationery knife



Hammer



Cotton swab



Rubber bands

If something is damaged or broken, please do not return the whole set. Contact us directly on email info@smonex.com or our website smonex.com. Any questions or issues with the Smonex products, we'll do our best to help you. We want our customers to be completely satisfied.

IMPORTANT: Assemble each tray one by one. Please DO NOT take out all the parts from the sheets and mix them. Even though some parts look similar, they are not interchangeable.



ONE SMART BOX

Teotihuacan® Organizer

TNOR01

Compatible with Teotihuacan® board game and its expansions
Assembly Guide

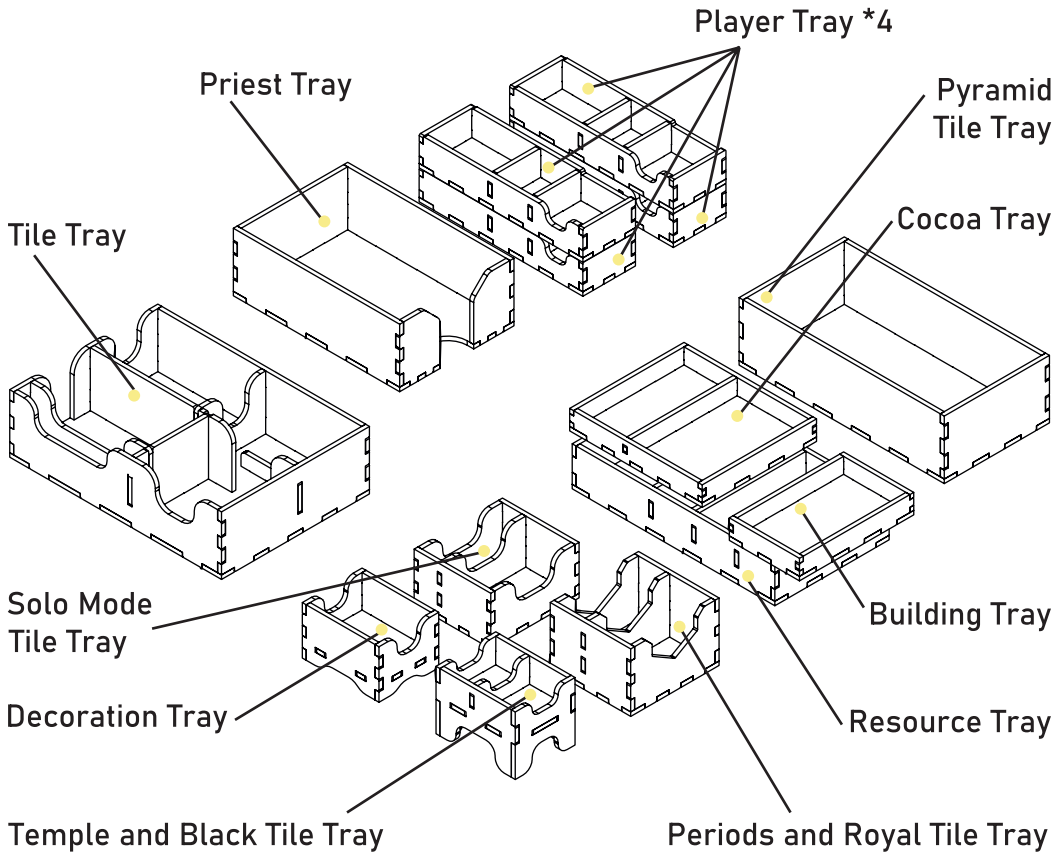



ONE SMART BOX

Teotihuacan® Organizer

TNOR01

Compatible with Teotihuacan® board game and its expansions
Assembly Guide

- Brief assembly instructions:**
1. Unpack and arrange the sheets in order.
 2. Compare details on the sheets with details in the pictures of the guide.
 3. Study the pictures of unassembled product.
 4. Start your assembly, taking the necessary parts out of the sheets in a certain order.

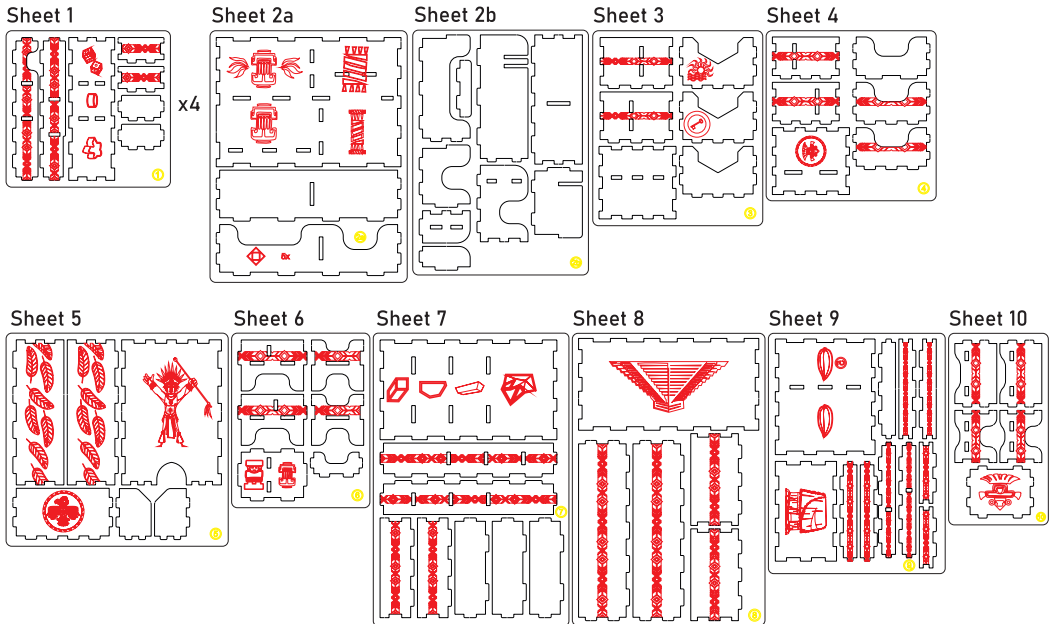

Legend:

- Details to be extruded
- Details not used in this assembly
- Details to be glued
- Details to be connected without glue

Components:

- 14 sheets extrusion molds
- 1 sandpaper for stripping parts
- Assembly guide



ONE SMART BOX

Teotihuacan® Organizer

TNOR01

Compatible with Teotihuacan® board game and its expansions
Assembly Guide

Player Tray *4



Intended for Dice, Player Color tokens, Action discs, Worshippers, Warriors and Shamans.

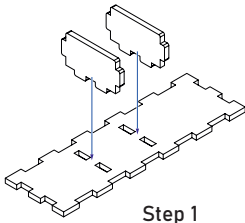
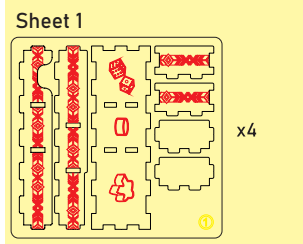
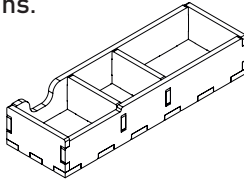

Step 1

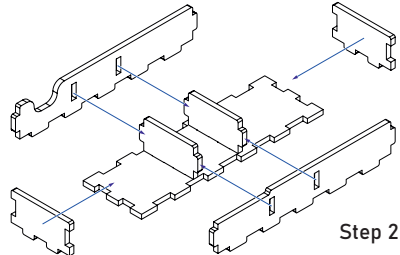

Step 2

Tile Tray



Intended for Technology tiles, Starting tiles, Discovery tiles, Major Discovery tiles, Player Order tokens and Multiplier tiles.

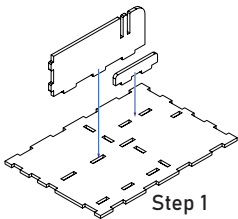
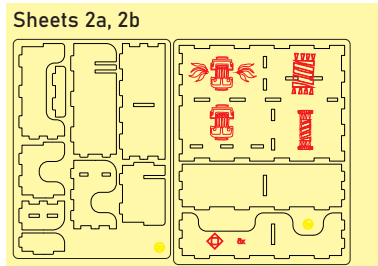
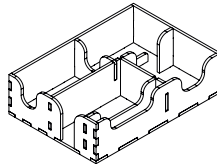

Step 1

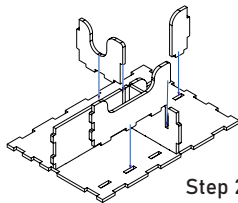

Step 2

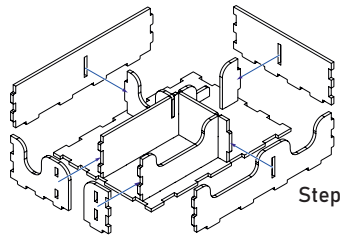

Step 3



ONE SMART BOX

Teotihuacan® Organizer

TNOR01

Compatible with Teotihuacan® board game and its expansions
Assembly Guide

Periods and Royal Tile Tray



Intended for Season tiles and Royal tiles.

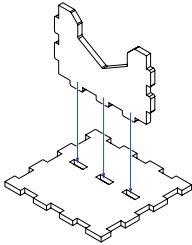
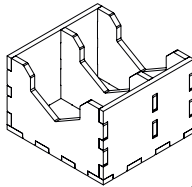

Step 1

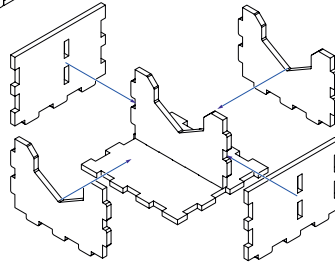

Sheet 3

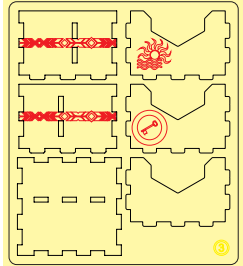

Step 2

Solo Mode Tile Tray



Intended for Action tiles,
Direction tiles and Path tiles.

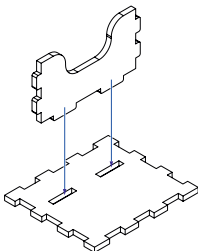
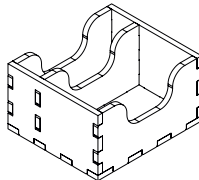

Step 1

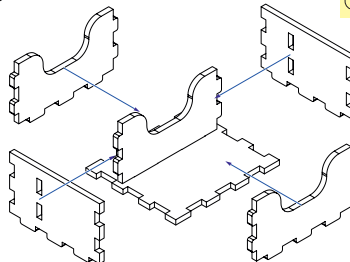

Sheet 4

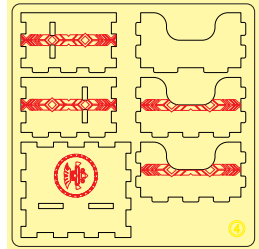

Step 2



ONE SMART BOX

Teotihuacan® Organizer

TNOR01

Compatible with Teotihuacan® board game and its expansions
Assembly Guide

Priest Tray



Intended for Priest tiles.

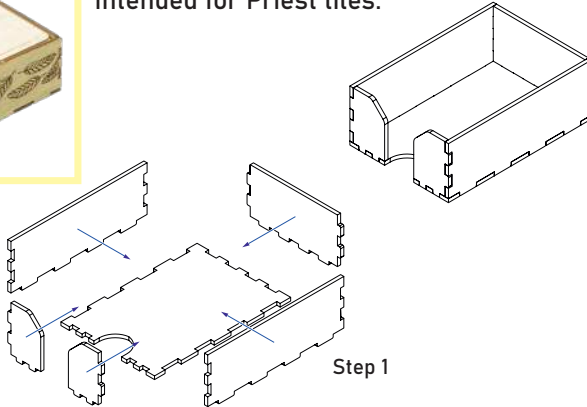

Sheet 5

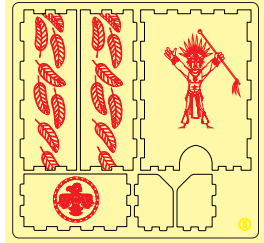

Temples and Black Tile Tray



Intended for Temple Bonus tiles,
Mansion Ownership tiles and
Mask tiles.

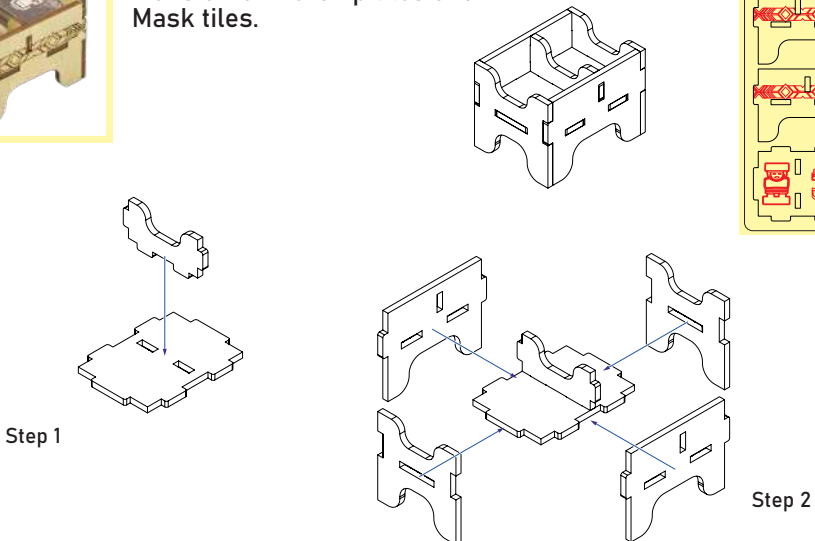

Sheet 6

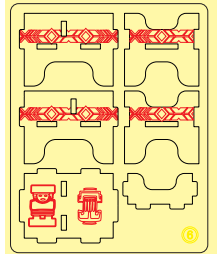



ONE SMART BOX

Teotihuacan® Organizer

TNOR01

Compatible with Teotihuacan® board game and its expansions
Assembly Guide

Resource Tray

Intended for Wood, Stone,
Gold and Obsidian tokens.

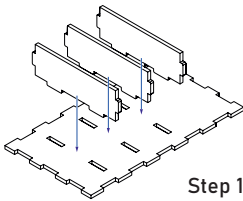

Step 1

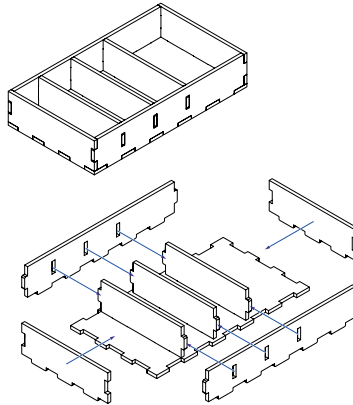

Step 2

Sheet 7

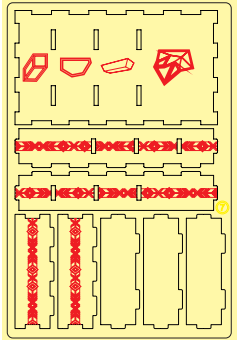

Pyramid Tile Tray

Intended for Pyramid tiles.

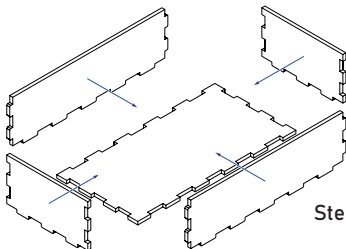

Step 1

Sheet 8

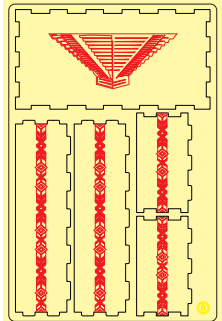



ONE SMART BOX

Teotihuacan® Organizer

TNOR01

Compatible with Teotihuacan® board game and its expansions
Assembly Guide

Building Tray



Intended for Building tokens and
Calendar discs.

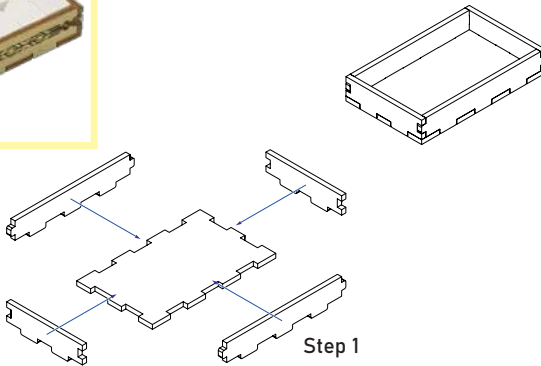

Sheet 9

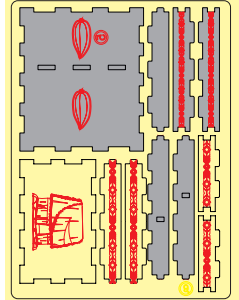

Cocoa Tray



Intended for Cocoa tokens.

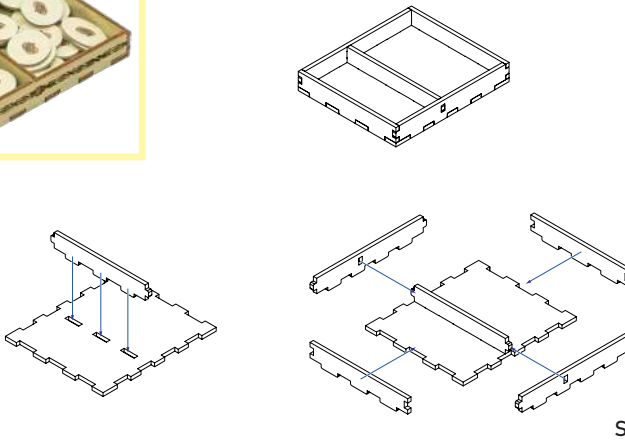

Sheet 9

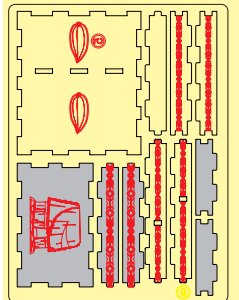



ONE SMART BOX

Teotihuacan® Organizer

TNOR01
Compatible with Teotihuacan® board game and its expansions
Assembly Guide

Decoration Tray



Intended for Decoration tiles.

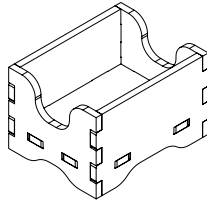

Sheet 10

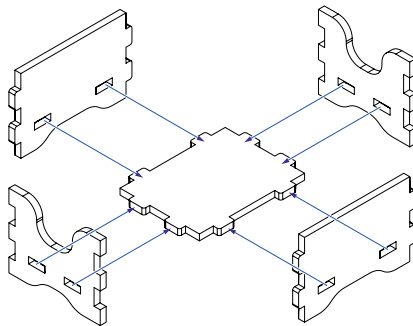
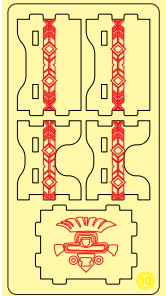

Step 1



ONE SMART BOX

Some other SMONEX products:

Settlers of Five Tribes® Organizer FETSOR01



Clans of Caledonia® Organizer COCOR01





Welcome to <https://smonex.com>.

If something is damaged or broken, please do not return the whole set. Contact us directly on email info@smonex.com or our website smonex.com.

Any questions or issues with the Smonex products, we'll do our best to help you. Your satisfaction of it is our top priority.

Thanks for choosing Smonex product. We would be grateful for your feedback, which inspires us and helps to develop further. We'll gladly help you on any matter if you contact us on info@smonex.com.

Share your photos with #smonex and follow us for all the updates:

 <https://www.facebook.com/Smonexcom>

 https://www.instagram.com/smonex_com/

 https://twitter.com/Smonex_com

 https://www.pinterest.com/smonex/_shop/

 <https://www.youtube.com/c/SmonexSmartOneBox>



Scan QR-code to visit or follow Smonex.