



# ONE SMART BOX Terra Mystica® Organizer

TAMOR01

Compatible with Terra Mystica® and its expansions  
Assembly Guide



<https://smonex.com>

Created for:

- Terra Mystica
- Terra Mystica: Bonus Card Shipping Value
- Terra Mystica: 4 Town Tiles
- Terra Mystica: Fire & Ice
- Terra Mystica: Merchants of the Seas

NOT A CHILDREN TOY

**AGE 14+**

Terra Mystica® is a registered trademark of Feuerland Spiele. Any mention of Terra Mystica® is for reference purposes only. ALL RIGHTS RESERVED by their respective trademark holders. No challenge to any intellectual property rights is intended or implied by representations of compatibility and no endorsements of any of our products by any other company is implied or represented.



# ONE SMART BOX Terra Mystica® Organizer

TAMOR01

Compatible with Terra Mystica® and its expansions  
Assembly Guide

## Tips and tricks

- To assemble each tray you need a wood glue for extra strength. (We recommend Titebond 2 Wood Glue or Beacon 527)
- Please make sure you assembled each tray correctly before gluing it together.
- Use stationery knife to cut the bits that connect details to the frame.
- Remove the details from the frame with a rotational motion along the axis formed by the bits you just cut.
- Use stationery knife and sandpaper to remove all the remaining connection bits.
- You may fix the box with rubber bands after gluing it. This will save you time and simplify the assembly.
- Leave your finished insert overnight to dry completely.

## Assembly Supplies



Wood-glue



Stationery knife



Hammer



Cotton swab



Rubber bands

If something is damaged or broken, please do not return the whole set. Contact us directly on email [info@smonex.com](mailto:info@smonex.com) or our website [smonex.com](http://smonex.com). Any questions or issues with the Smonex products, we'll do our best to help you. We want our customers to be completely satisfied.

**IMPORTANT:** Assemble each tray one by one. Please **DO NOT** take out all the parts from the sheets and mix them. Even though some parts look similar, they are not interchangeable.



# ONE SMART BOX Terra Mystica® Organizer

TAMOR01

Compatible with Terra Mystica® and its expansions  
Assembly Guide

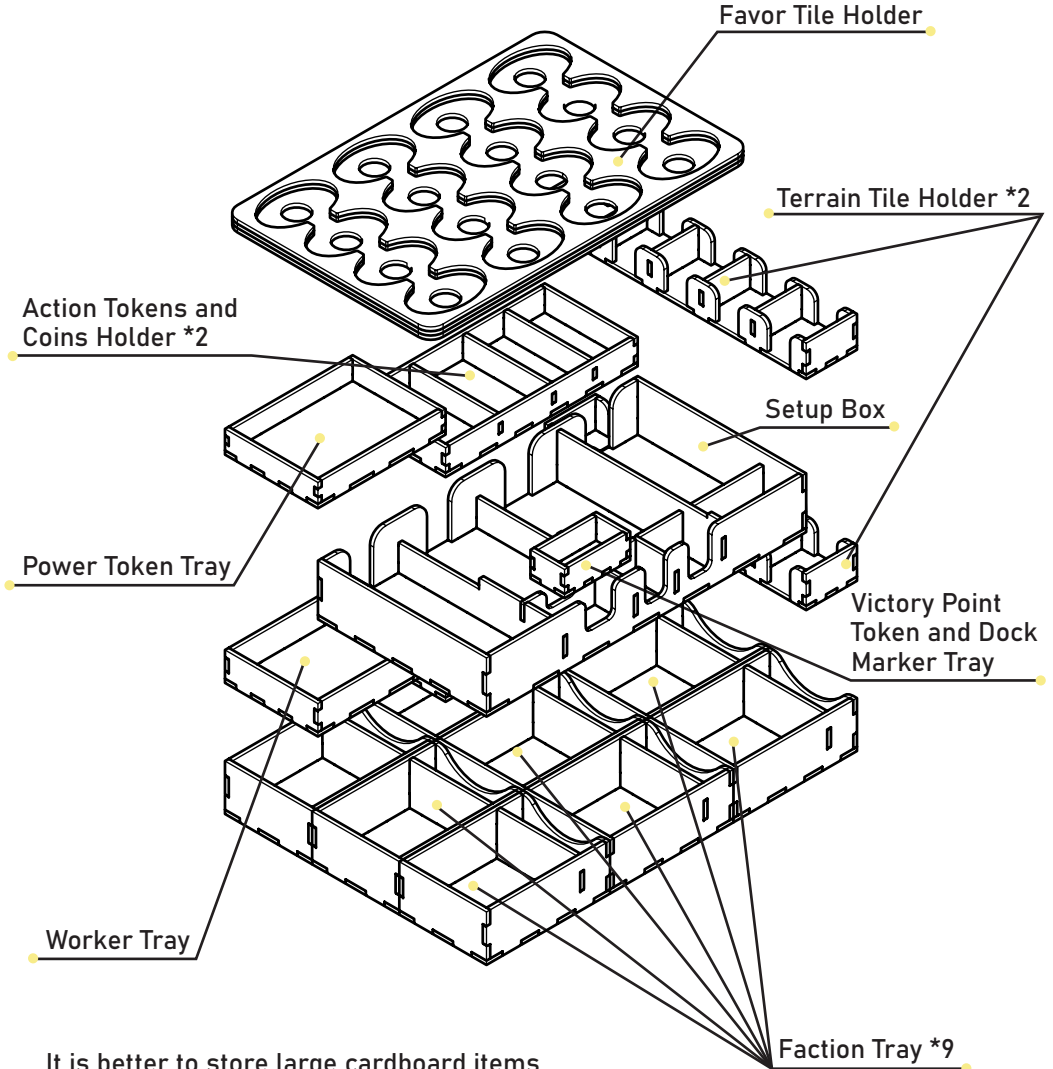

It is better to store large cardboard items separately in an expansion box.



# ONE SMART BOX Terra Mystica® Organizer

TAMOR01

Compatible with Terra Mystica® and its expansions  
Assembly Guide

- Brief assembly instructions:**
1. Unpack and arrange the sheets in order.
  2. Compare details on the sheets with details in the pictures of the guide.
  3. Study the pictures of unassembled product.
  4. Start your assembly, taking the necessary parts out of the sheets in a certain order.

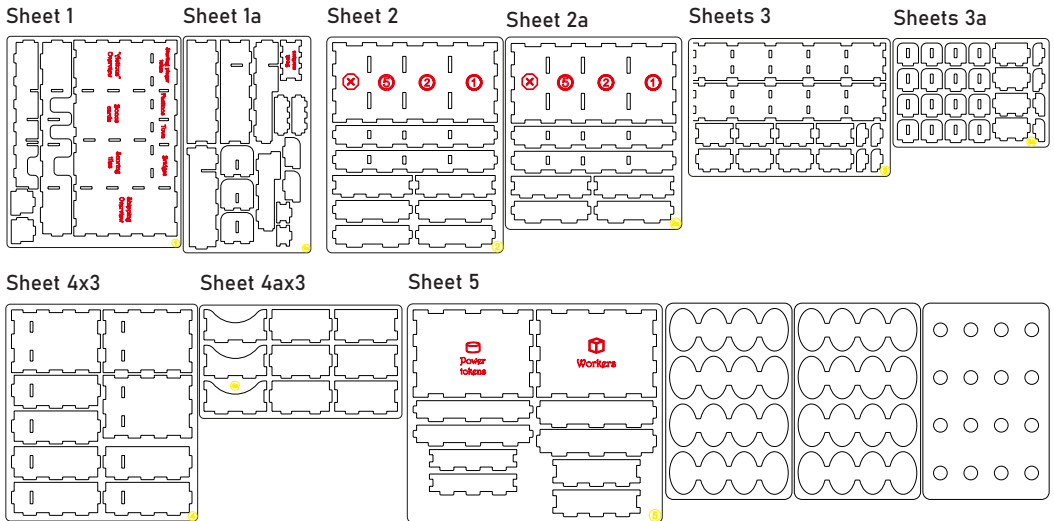

## Legend:

→ Details to be glued

## Components:

- 13 sheets extrusion molds
- 3 large parts
- 1 sandpaper for stripping parts
- Assembly guide



# ONE SMART BOX Terra Mystica® Organizer

TAMOR01

Compatible with Terra Mystica® and its expansions  
Assembly Guide

## Setup Box

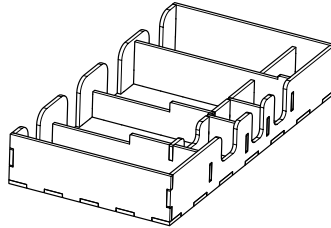

Sheets 1, 1a

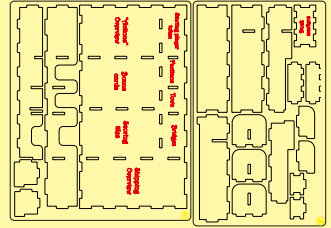

Step 1

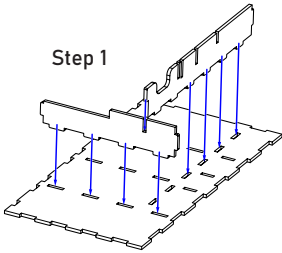

Step 2

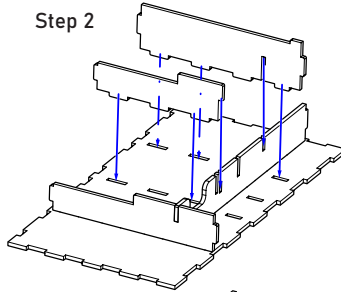

Step 3

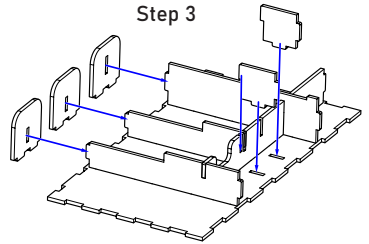

Step 4

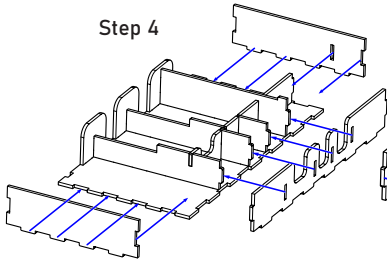

Step 5

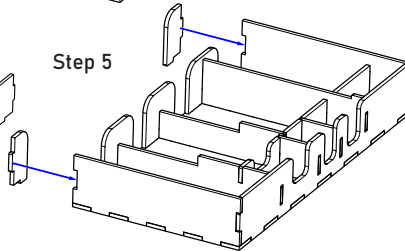

Intended for Town Tiles, Rang Tiles, Final Scoring Tiles, Bonus Cards, Shipping Overview Tiles, Shipyard Boards, Turn Order Board, etc.

## Victory Point Token and Dock Marker Tray

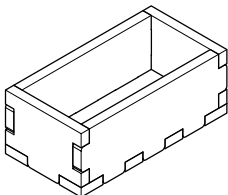

Step 1

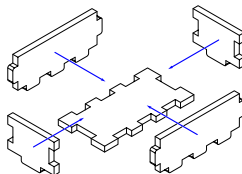

The tray should be put into the Setup Box.



# ONE SMART BOX Terra Mystica® Organizer

TAMOR01

Compatible with Terra Mystica® and its expansions  
Assembly Guide

## Action Tokens and Coins Holder \*2

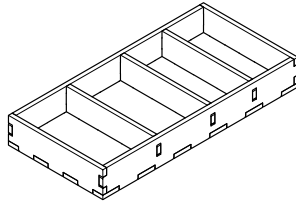

Sheets 2, 2a

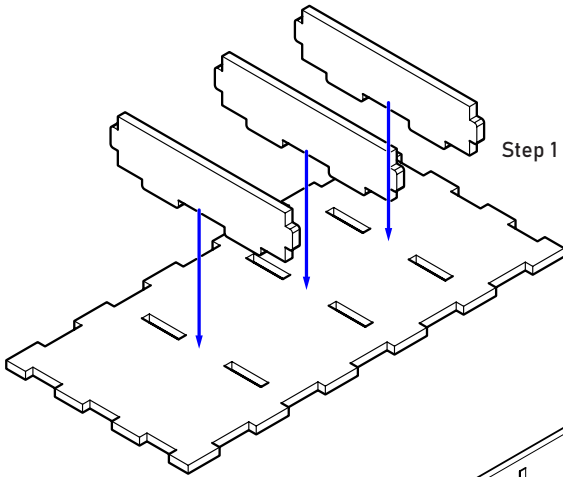
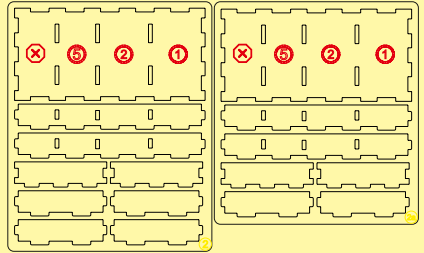

Step 1

Intended for Coins and  
Action Tokens.

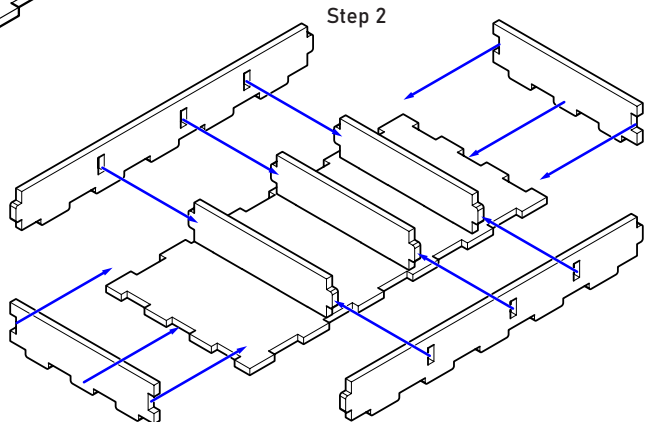

Step 2



# ONE SMART BOX Terra Mystica® Organizer

TAMOR01

Compatible with Terra Mystica® and its expansions  
Assembly Guide

## Terrain Tile Holder \*2

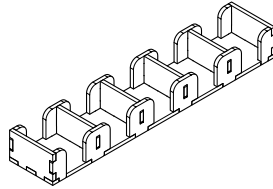

Sheets 3, 3a

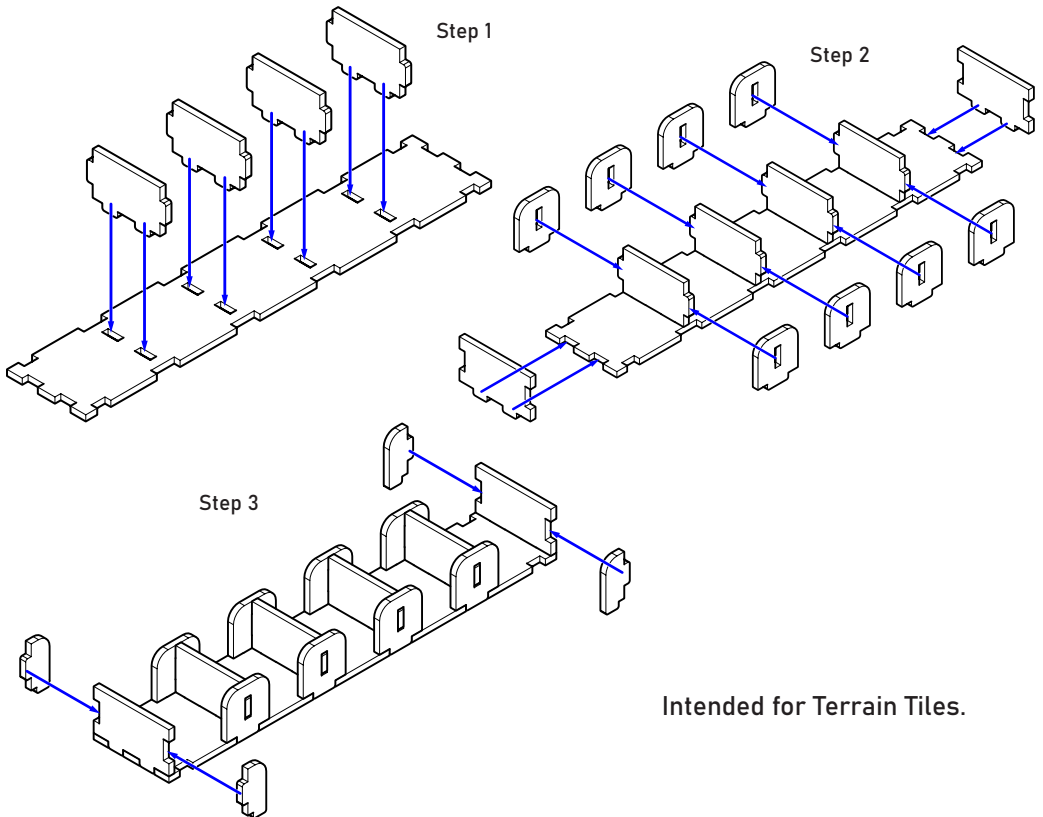
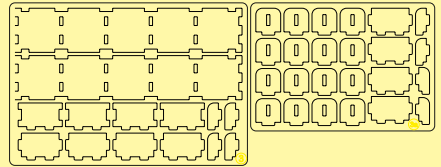

Intended for Terrain Tiles.



# ONE SMART BOX

## Terra Mystica® Organizer

TAMOR01

Compatible with Terra Mystica® and its expansions  
Assembly Guide

**Faction Tray \*9**

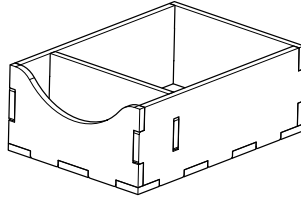

Sheets 4, 4a

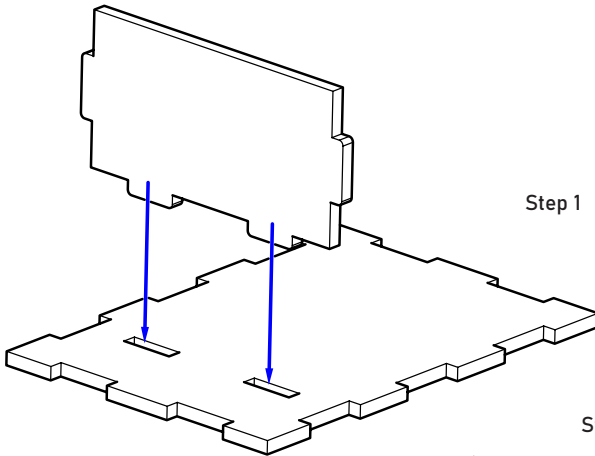
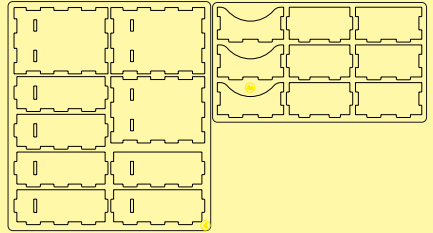

Step 1

Intended for colored  
Faction items.

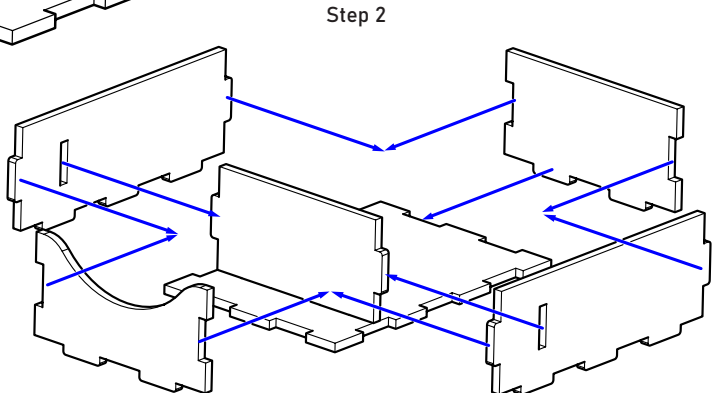

Step 2





# ONE SMART BOX Terra Mystica® Organizer

TAMOR01

Compatible with Terra Mystica® and its expansions  
Assembly Guide

## Worker Tray and Power Token Tray



Please note that the height of the trays is different.

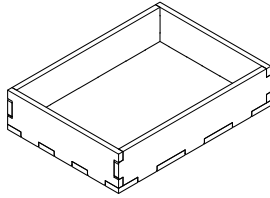

Sheets 5

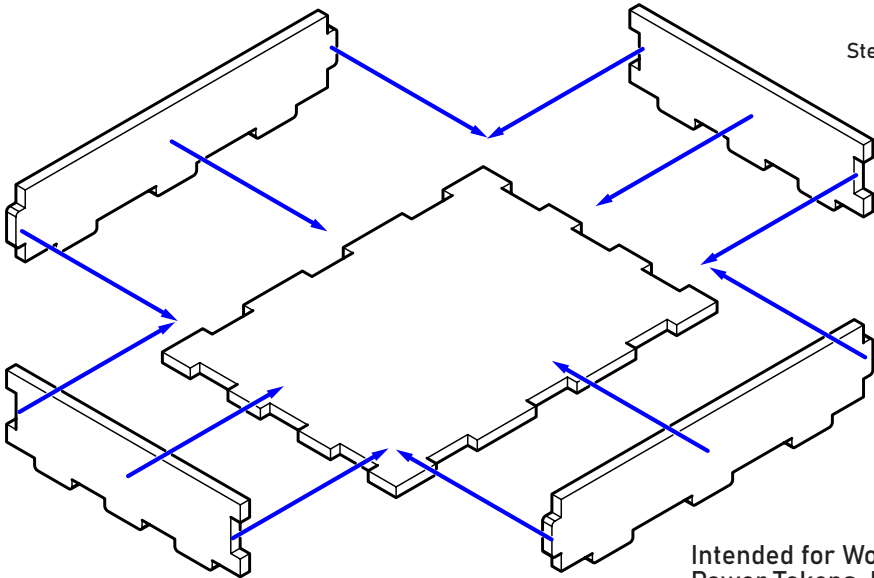
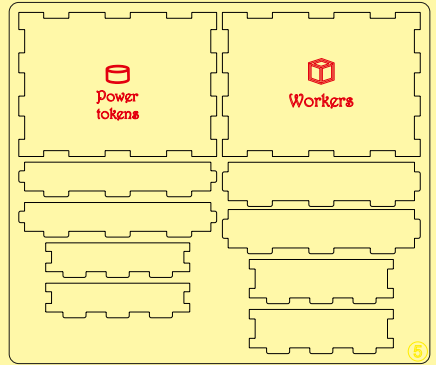

Step 1

Intended for Workers and Power Tokens. Follow the engraving.



# ONE SMART BOX Terra Mystica® Organizer

TAMOR01

Compatible with Terra Mystica® and its expansions  
Assembly Guide

## Favor Tile Holder

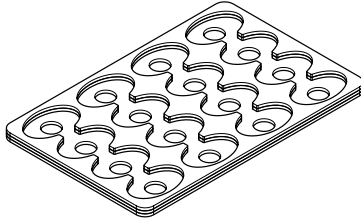
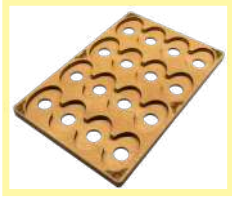

Sheets 6

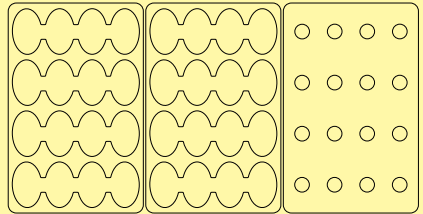

Intended for Favor Tiles.

Step 1

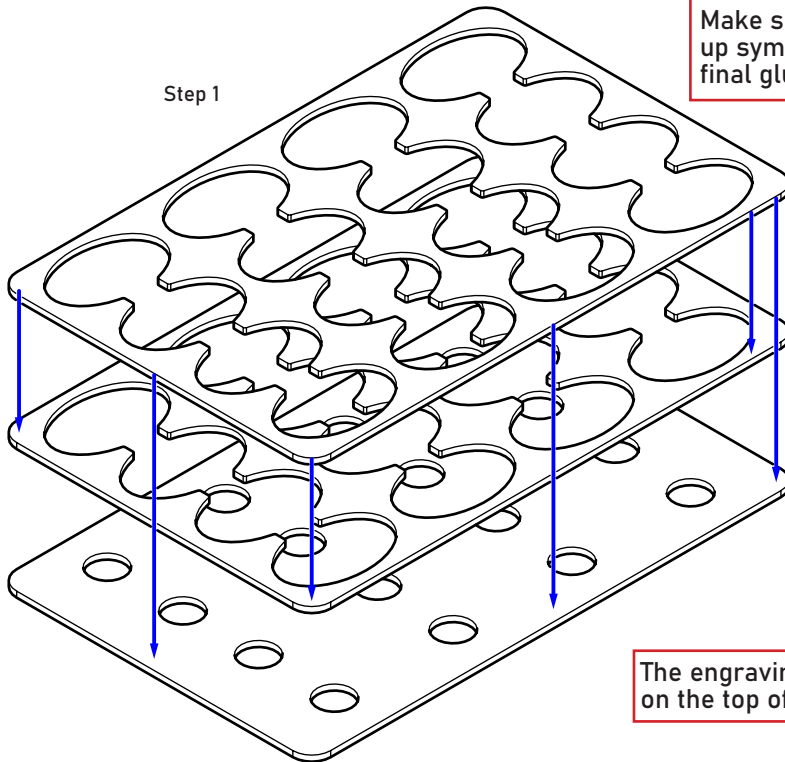

Make sure the holes line up symmetrically before final gluing.

The engraving should be on the top of the holder.



ONE SMART BOX

## Some other SMONEX products:

### Catan Wooden Game Board CNOR01



### 7 Wonders Organizer WSOR01









Welcome to <https://smonex.com>.

If something is damaged or broken, please do not return the whole set. Contact us directly on email [info@smonex.com](mailto:info@smonex.com) or our website [smonex.com](https://smonex.com).

Any questions or issues with the Smonex products, we'll do our best to help you. Your satisfaction of it is our top priority.

Thanks for choosing Smonex product. We would be grateful for your feedback, which inspires us and helps to develop further. We'll gladly help you on any matter if you contact us on [info@smonex.com](mailto:info@smonex.com).

Share your photos with #smonex and follow us for all the updates:

-  <https://www.facebook.com/Smonexcom>
-  [https://www.instagram.com/smonex\\_com/](https://www.instagram.com/smonex_com/)
-  [https://twitter.com/Smonex\\_com](https://twitter.com/Smonex_com)
-  [https://www.pinterest.com/smonex/\\_shop/](https://www.pinterest.com/smonex/_shop/)
-  <https://www.youtube.com/c/SmonexSmartOneBox>



Scan QR-code to visit or follow Smonex.