

smonex

# ONE SMART BOX

Gloomhaven® Player Board  
GNPB04

Compatible with Gloomhaven®  
Assembly Guide



NOT A CHILDREN TOY  
**AGE 14+**

Gloomhaven® is a registered trademark of Cephalofair Games. Any mention of Gloomhaven® is for reference purposes only. ALL RIGHTS RESERVED by their respective trademark holders. No challenge to any intellectual property rights is intended or implied by representations of compatibility and no endorsements of any of our products by any other company is implied or represented.

This Quick Start Player Board is compatible with Gloomhaven® and its expansions. This is a non-licensed product. ALL RIGHTS RESERVED by their respective trademark holders. No challenge to any intellectual property rights is intended or implied by representations of compatibility and no endorsements of any of our products by any other company is implied or represented.

smonex  
**ONE SMART BOX**

Gloomhaven® Player Board  
GNPB04  
Compatible with Gloomhaven®  
Assembly Guide

### Tips and tricks

- Wood-glue is required when assembling each tray, for extra strength. (We recommend Titebond 2 Wood Glue or Beacon 527)
- Please make sure you dry-assemble each tray correctly before gluing it together.
- Use stationery knife to cut the bits connecting the parts to the frame.
- Remove the parts from the frame with a rotating motion along the axis formed by the bits you just cut.
- Use stationery knife to remove any of the remaining connection bits.
- Allow your finished insert to dry overnight.
- For easier removal of the protective cover-up from acrylic use a hairdryer. Just heat the acrylic surface a little the cover-up will be removed much easier!

### Assembly Supplies



Wood-glue



Stationery knife



Hammer



Cotton swab



Hairdryer

**IMPORTANT:** Assemble each tray one by one. Please **DO NOT** take out all the parts from the sheets and mix them. Even though some parts look similar, they are not interchangeable.



# Gloomhaven® Player Board GNPB04 Compatible with Gloomhaven® Assembly Guide

- Brief assembly instructions:**
1. Unpack and arrange the sheets in order;
  2. Compare the details on the sheets with the details on the pictures in the instructions;
  3. Study the pictures with the disassembled product;
  4. Proceed with the assembly, taking out the necessary parts from the sheet in order.



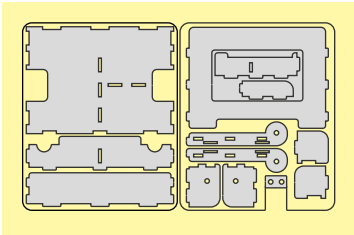

## Components:



## Components:

- 8 sheets extrusion molds
- 4 acrylic covers
- 8 screws
- manual
- 1 sandpaper for stripping parts

## Legend:

-  extrude details highlighted on the sheet
-  unused details in this assembly
-  details must be connected without glue
-  details must be glued
-  details must be screwed



# ONE SMART BOX

Gloomhaven® Player Board  
GNPB04  
Compatible with Gloomhaven®  
Assembly Guide

## Player board x4

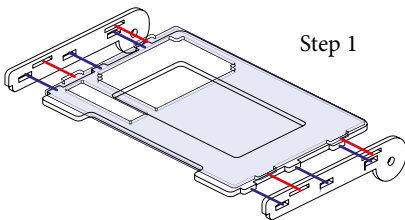
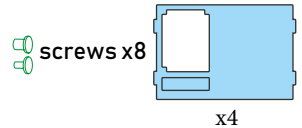
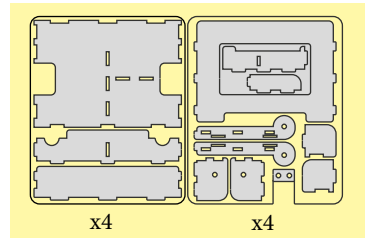
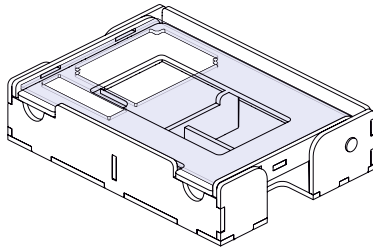

Intended for comfortable game and saving results between your games.

Before step 1 remove protective cover-up from the both sides of the cover.

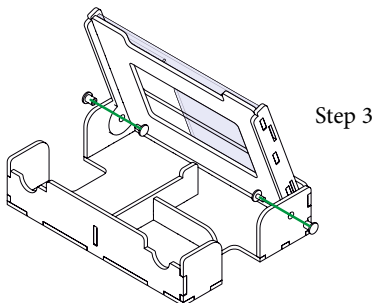
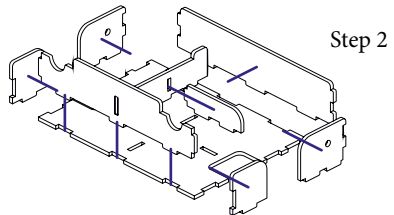

In the box you will find screws that need to be screwed in 2 units into each player board



# ONE SMART BOX

Gloomhaven® Player Board  
GNPB04

Compatible with Gloomhaven®  
Assembly Guide

Other smonex products:

XIA Organizer XAOR01



If you have any questions about assembly,  
feel free to contact us through our site:

[smonex.com](https://smonex.com)

This Quick Start Player Board is compatible with Gloomhaven® and its expansions. This is a non-licensed product. ALL RIGHTS RESERVED by their respective trademark holders. No challenge to any intellectual property rights is intended or implied by representations of compatibility and no endorsements of any of our products by any other company is implied or represented.

smonex

# ONE SMART BOX

Gloomhaven® Player Board

GNPB04

Compatible with Gloomhaven®

Other smonex products:

**Terraforming Mars Organizer TMOR01**



If you have any questions about assembly,  
feel free to contact us through our site:

[smonex.com](http://smonex.com)

This Quick Start Player Board is compatible with Gloomhaven® and its expansions. This is a non-licensed product. ALL RIGHTS RESERVED by their respective trademark holders. No challenge to any intellectual property rights is intended or implied by representations of compatibility and no endorsements of any of our products by any other company is implied or represented.



# OrganizerTMOR01

Gloomhaven® Player Board  
GNPB04

Other smonex products:

Gloomhaven® Organizer GNOR01



If you have any questions about assembly,  
feel free to contact us through our site:

[smonex.com](http://smonex.com)

This is a non-licensed product. ALL RIGHTS RESERVED by their respective trademark holders. No challenge to any intellectual property rights is intended or implied by representations of compatibility and no endorsements of any of our products by any other company is implied or represented.



# OrganizerTMOR01

Gloomhaven® Player Board  
GNPB04

Other smonex products:

Carcassonne® Organizer CEOR01



If you have any questions about assembly,  
feel free to contact us through our site:

[smonex.com](http://smonex.com)