



ONE SMART BOX Mansions of Madness® Organizer

MOMOR01

Compatible with Mansions of Madness® 2nd Edition board game with
Sanctum of Twilight and Beyond the Threshold expansions
Assembly Guide



<https://smonex.com>

Created for:

- Mansions of Madness: 2nd Edition
- Mansions of Madness: Sanctum of Twilight
- Mansions of Madness: Beyond the Threshold

NOT A CHILDREN TOY
AGE 14+

Mansions of Madness® is a registered trademark of Fantasy Flight Games. Any mention of Mansions of Madness® is for reference purposes only. ALL RIGHTS RESERVED by their respective trademark holders. No challenge to any intellectual property rights is intended or implied by representations of compatibility and no endorsements of any of our products by any other company is implied or represented.



ONE SMART BOX

Mansions of Madness® Organizer

MOMOR01

Compatible with Mansions of Madness® 2nd Edition board game with
Sanctum of Twilight and Beyond the Threshold expansions
Assembly Guide

Tips and tricks

- To assemble each tray you need a wood glue for extra strength. (We recommend Titebond 2 Wood Glue or Beacon 527).
- Please make sure you assembled each tray correctly before gluing it together.
- Use stationery knife to cut the bits that connect details to the frame.
- Remove the details from the frame with a rotational motion along the axis formed by the bits you just cut.
- Use stationery knife and sandpaper to remove all the remaining connection bits.
- Please note that the engraving must be on the outside of the boxes.
- You may fix the box with rubber bands after gluing it. This will save you time and simplify the assembly.
- Make sure to remove the protective covering from BOTH sides of the acrylic pieces. Use a hairdryer for easier removal of it if necessary. Just heat the acrylic surface a little to remove the covering much easier!
- Leave your finished insert overnight to dry completely.

Assembly Supplies



Wood-glue



Stationery knife



Hammer



Cotton swab



Rubber bands



Hairdryer

If something is damaged or broken, please do not return the whole set. Contact us directly on email info@smonex.com or our website smonex.com. Any questions or issues with the Smonex products, we'll do our best to help you. We want our customers to be completely satisfied.

IMPORTANT: Assemble each tray one by one. Please DO NOT take out all the parts from the sheets and mix them. Even though some parts look similar, they are not interchangeable.



ONE SMART BOX

Mansions of Madness® Organizer

MOMOR01

Compatible with Mansions of Madness® 2nd Edition board game with
Sanctum of Twilight and Beyond the Threshold expansions
Assembly Guide

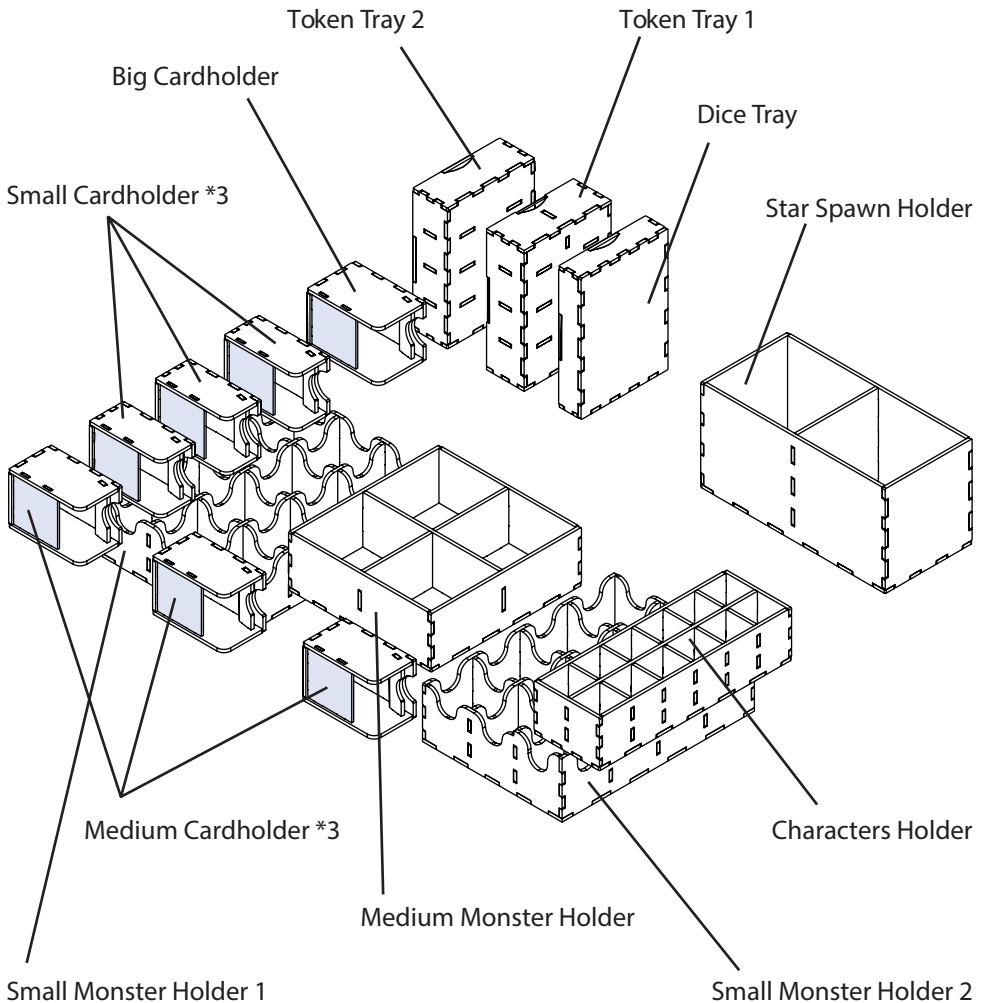



ONE SMART BOX

Mansions of Madness® Organizer

MOMOR01

Compatible with Mansions of Madness® 2nd Edition board game with Sanctum of Twilight and Beyond the Threshold expansions
Assembly Guide

- Brief assembly instructions:**
1. Unpack and arrange the sheets in order.
 2. Compare details on the sheets with details in the pictures of the guide.
 3. Study the pictures of unassembled product.
 4. Start your assembly, taking the necessary parts out of the sheets in a certain order.

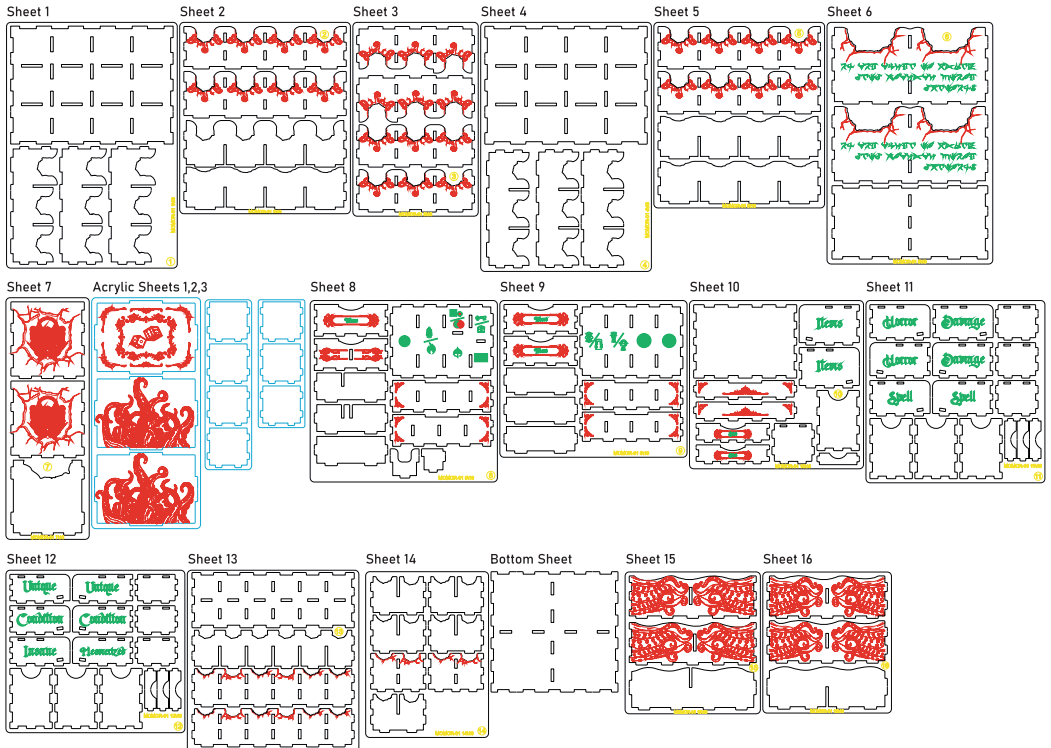

Legend:

- Details to be extruded
- Details not used in this assembly
- Details to be glued
- Details to be connected without glue

Components:

- 16 sheets extrusion molds
- 3 acrylic sheet extrusion mold
- 1 bottom sheet
- 1 sandpaper for stripping parts
- Assembly guide



ONE SMART BOX

Mansions of Madness® Organizer

MOMOR01

Compatible with Mansions of Madness® 2nd Edition board game with
Sanctum of Twilight and Beyond the Threshold expansions
Assembly Guide

Small Monster Holder 1

Intended for small monsters.



Sheets 1, 2, 3

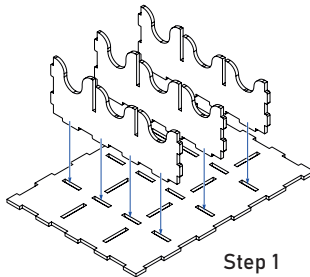
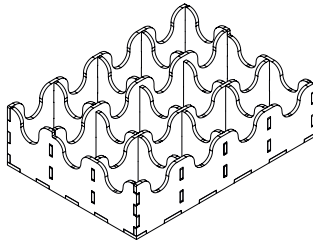
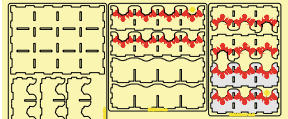

Step 1

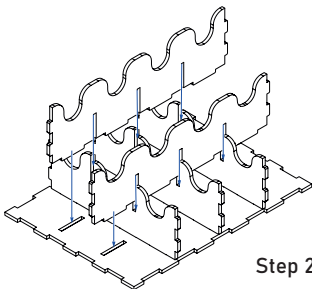

Step 2

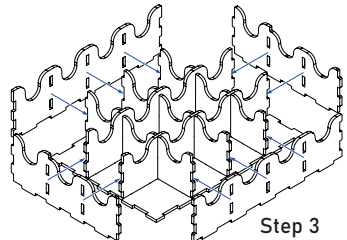

Step 3



ONE SMART BOX

Mansions of Madness® Organizer

MOMOR01

Compatible with Mansions of Madness® 2nd Edition board game with Sanctum of Twilight and Beyond the Threshold expansions
Assembly Guide

Small Monster Holder 2

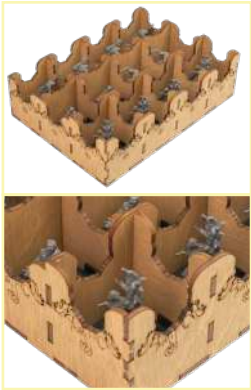

Intended for small monsters.

Please mind that one side of the tray is intended to be taller than the other one for convenient Thrall monsters storage.

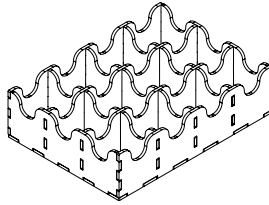

Sheets 3, 4, 5

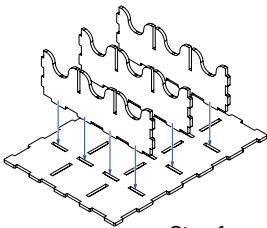
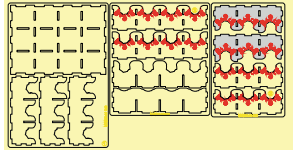

Step 1

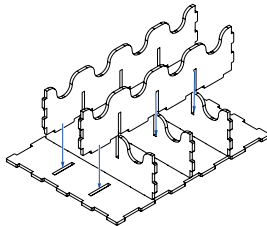

Step 2

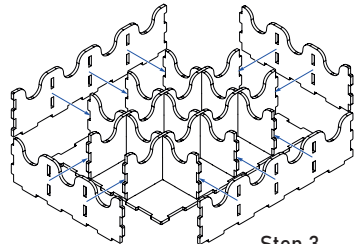

Step 3

Star Spawn Holder



Intended for Star Spawn monsters.

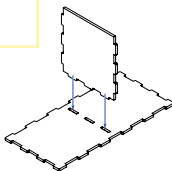

Step 1

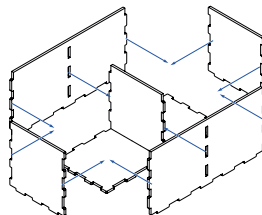
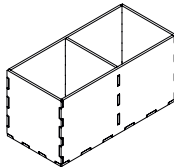

Step 2

Sheets 6, 7

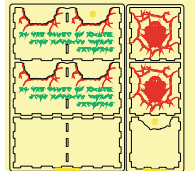



ONE SMART BOX

Mansions of Madness® Organizer

MOMOR01

Compatible with Mansions of Madness® 2nd Edition board game with
Sanctum of Twilight and Beyond the Threshold expansions
Assembly Guide

Token Tray 1



Intended for clue, fire/darkness, barricade, secret passage, ID, key, wall and restraint tokens.

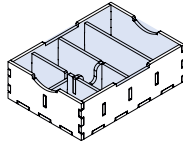

Sheet 8,
Acrylic Sheet 1

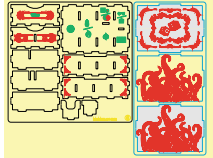

Until the glue has completely dried, make sure the lid fits the tray and can be easily removed. Put it back in its place on the tray. Only then carefully remove the protective covering.

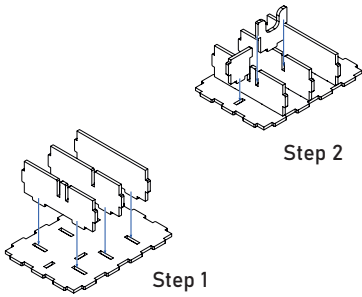

Step 1

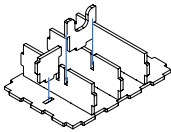

Step 2

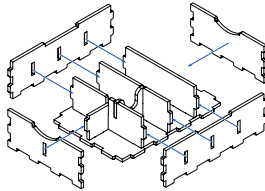

Step 3

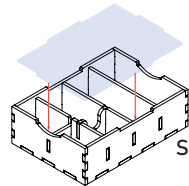

Step 4

Token Tray 2



Intended for person, explore/sight and search/interact tokens.

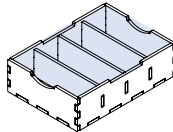

Sheet 9,
Acrylic Sheet 1

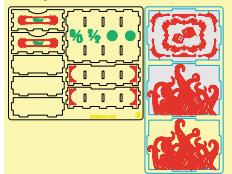

Until the glue has completely dried, make sure the lid fits the tray and can be easily removed. Put it back in its place on the tray. Only then carefully remove the protective covering.

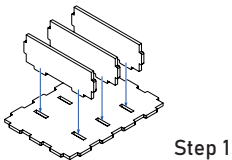

Step 1

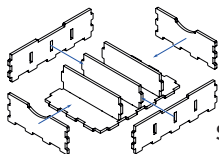

Step 2

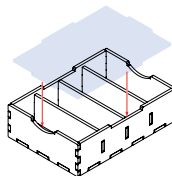

Step 3



ONE SMART BOX

Mansions of Madness® Organizer

MOMOR01

Compatible with Mansions of Madness® 2nd Edition board game with
Sanctum of Twilight and Beyond the Threshold expansions
Assembly Guide

Dice Tray



Intended for dice.

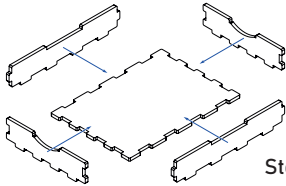
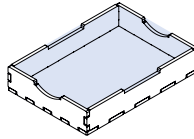

Step 1

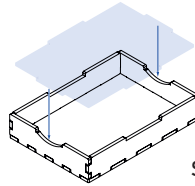

Step 2

Sheet 10,
Acrylic Sheet 1

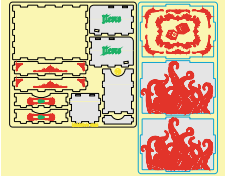

Until the glue has completely dried, make sure the lid fits the tray and can be easily removed. Put it back in its place on the tray. Only then carefully remove the protective covering.

Big Cardholder



Intended for item cards.

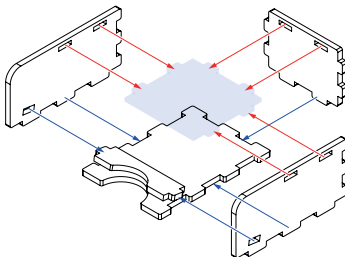
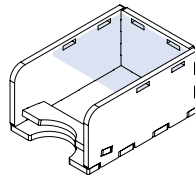

Step 1

Sheet 10,
Acrylic Sheet 3

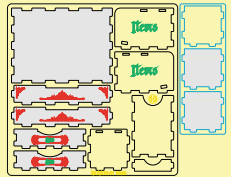



ONE SMART BOX

Mansions of Madness® Organizer

MOMOR01

Compatible with Mansions of Madness® 2nd Edition board game with
Sanctum of Twilight and Beyond the Threshold expansions
Assembly Guide

Medium Cardholder *3



Intended for damage, horror and spell cards.

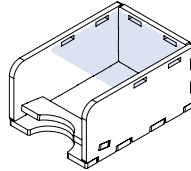

Sheet 11,
Acrylic Sheets 2, 3

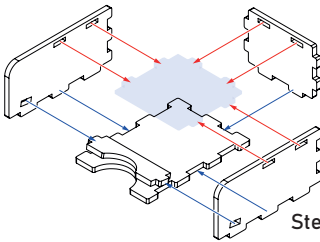
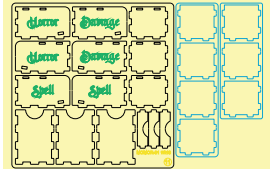

Step 1

Small Cardholder *3



Intended for unique item and condition cards.

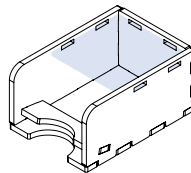

Sheet 12,
Acrylic Sheets 2, 3

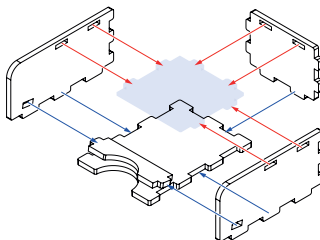
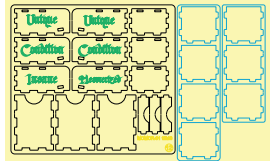

Step 1



ONE SMART BOX

Mansions of Madness® Organizer

MOMOR01

Compatible with Mansions of Madness® 2nd Edition board game with
Sanctum of Twilight and Beyond the Threshold expansions
Assembly Guide

Characters Holder

Intended for character mineatures.

Sheets 13, 14

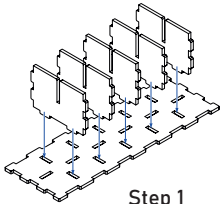
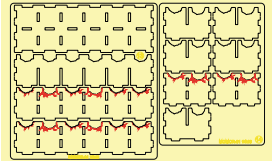
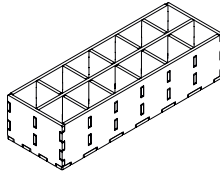

Step 1

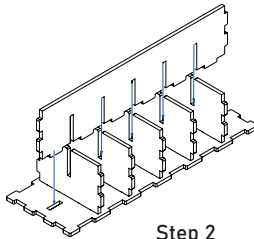

Step 2

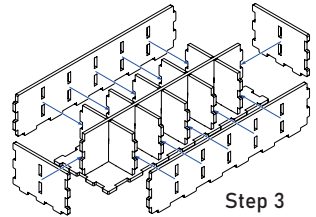

Step 3

Medium Monster Holder

Intended for riot and hunting horror monsters.

Sheets 15, 16

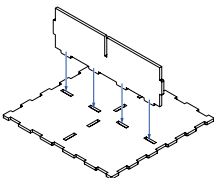
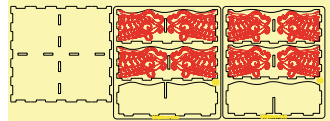
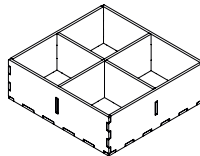

Step 1

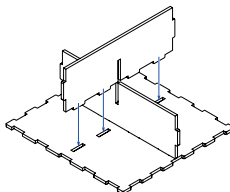

Step 2

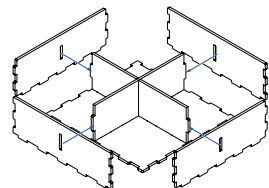

Step 3



ONE SMART BOX

Some other SMONEX products:
Spirit Island[®] Organizer SIOR01



Lords of Waterdeep[®] Organizer LWDOR01





ONE SMART BOX

Welcome to <https://smonex.com>.

If something is damaged or broken, please do not return the whole set. Contact us directly on email info@smonex.com or our website smonex.com.

Any questions or issues with the Smonex products, we'll do our best to help you. Your satisfaction of it is our top priority.

Thanks for choosing Smonex product. We would be grateful for your feedback, which inspires us and helps to develop further. We'll gladly help you on any matter if you contact us on info@smonex.com.

Share your photos with **#smonex** and follow us for all the updates:



<https://www.facebook.com/Smonexcom>

https://www.instagram.com/smonex_com/

https://twitter.com/Smonex_com

https://www.pinterest.com/smonex/_shop/

<https://www.youtube.com/c/SmonexSmartOneBox>



Scan QR-code to visit or follow Smonex.