



ONE SMART BOX Fallout® Organizer

FTOR01
Compatible with Fallout® and its expansions
Assembly Guide



<https://smonex.com>

Created for:

- Fallout
- Fallout: New California
- Fallout: Atomic Bonds

NOT A CHILDREN TOY
AGE 14+

Fallout® is a registered trademark of Interplay Entertainment. Any mention of Fallout® is for reference purposes only. ALL RIGHTS RESERVED by their respective trademark holders. No challenge to any intellectual property rights is intended or implied by representations of compatibility and no endorsements of any of our products by any other company is implied or represented.



ONE SMART BOX

Fallout® Organizer

FTOR01
Compatible with Fallout® and its expansions
Assembly Guide

Tips and tricks

- To assemble each tray you need a wood glue for extra strength. (We recommend Titebond 2 Wood Glue or Beacon 527)
- Please make sure you assembled each tray correctly before gluing it together.
- Use stationery knife to cut the bits that connect details to the frame.
- Remove the details from the frame with a rotational motion along the axis formed by the bits you just cut.
- Use stationery knife and sandpaper to remove all the remaining connection bits.
- You may fix the box with rubber bands after gluing it. This will save you time and simplify the assembly.
- Use a hairdryer for easier removal of the protective covering from acrylic details. Just heat the acrylic surface a little to remove the covering much easier!
- Leave your finished insert overnight to dry completely.

Assembly Supplies



Wood-glue



Stationery knife



Hammer



Cotton swab



Rubber bands



Hairdryer

If something is damaged or broken, please do not return the whole set. Contact us directly on email info@smonex.com or our website smonex.com. Any questions or issues with the Smonex products, we'll do our best to help you. We want our customers to be completely satisfied.

IMPORTANT: Assemble each tray one by one. Please DO NOT take out all the parts from the sheets and mix them. Even though some parts look similar, they are not interchangeable.



ONE SMART BOX Fallout® Organizer

FTOR01
Compatible with Fallout® and its expansions
Assembly Guide

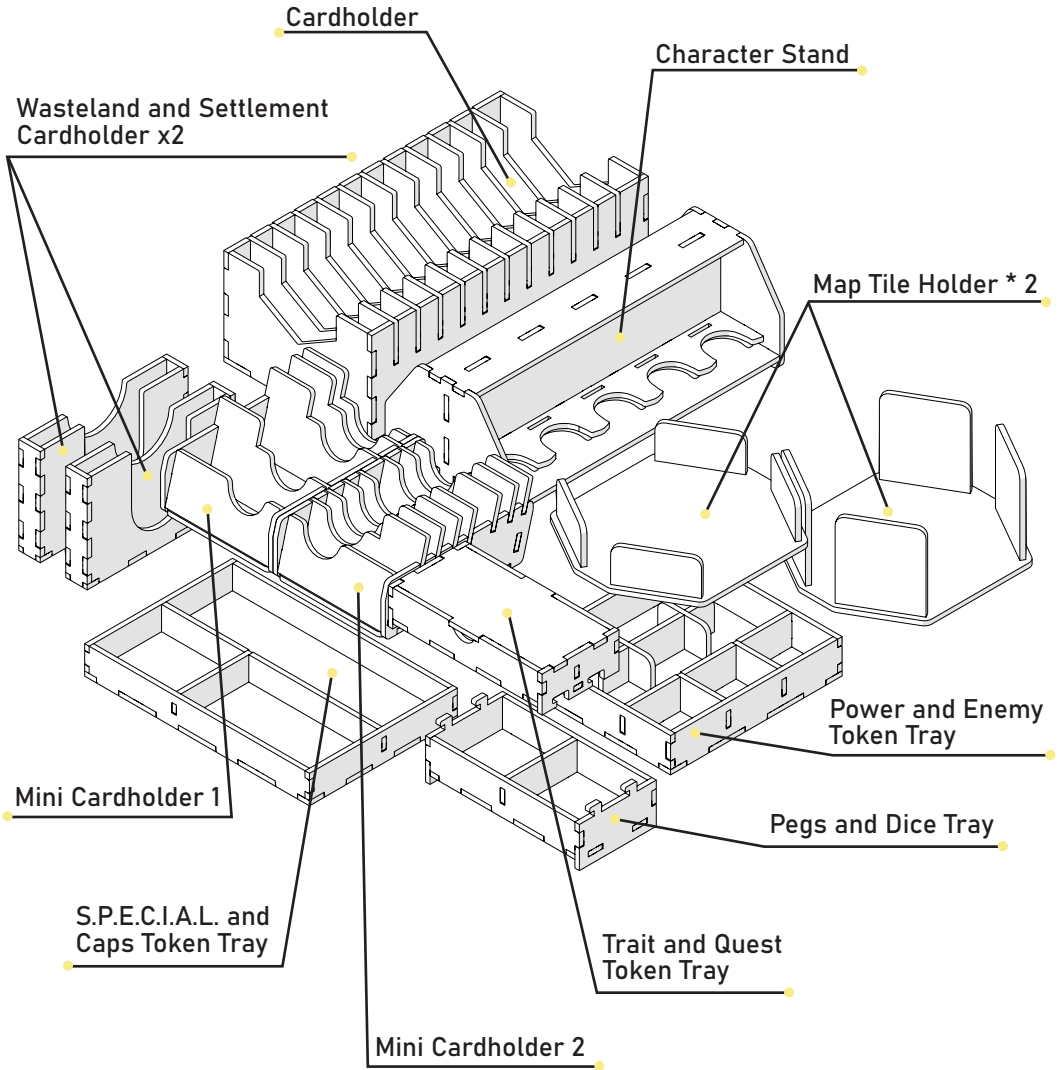



ONE SMART BOX Fallout® Organizer

FTOR01
Compatible with Fallout® and its expansions
Assembly Guide

- Brief assembly instructions:**
1. Unpack and arrange the sheets in order.
 2. Compare details on the sheets with details in the pictures of the guide.
 3. Study the pictures of unassembled product.
 4. Start your assembly, taking the necessary parts out of the sheets in a certain order.

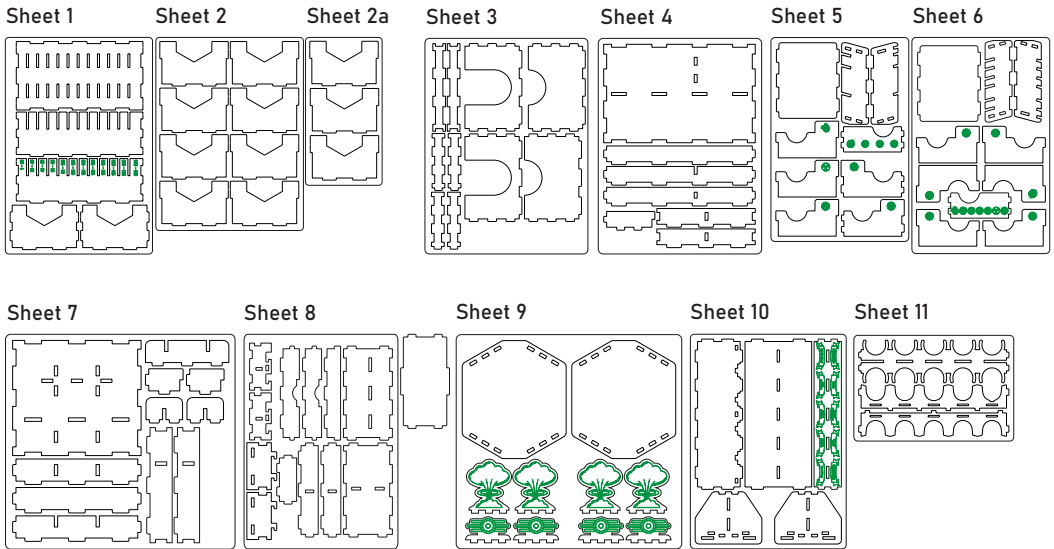

Legend:

- Details to be extruded
- Details not used in this assembly
- Details to be glued
- Details to be connected without glue

Components:

- 12 sheets extrusion molds
- 1 acrylic piece
- 1 sandpaper for stripping parts
- Assembly guide



ONE SMART BOX Fallout® Organizer

FTOR01
Compatible with Fallout® and its expansions
Assembly Guide

Cardholder

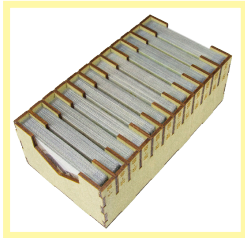

Intended for big cards.

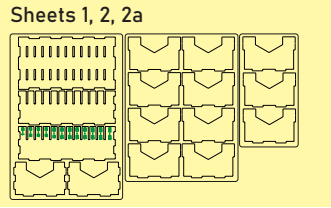
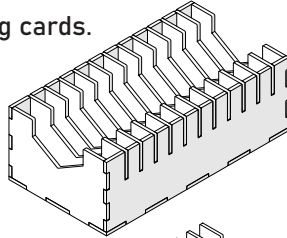

Sheets 1, 2, 2a

Please note that the engraving must be on the outside of the box.

Step 1

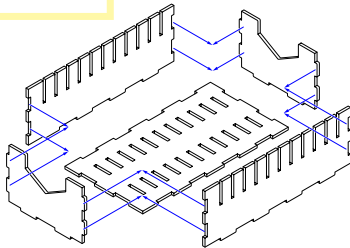

Step 2

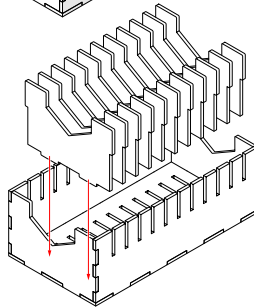

Wasteland and Settlement Cardholder x2



Intended for Wasteland Cards
and Settlement Cards.

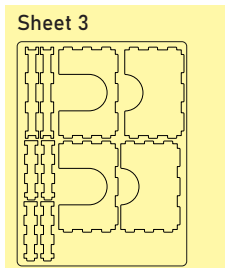
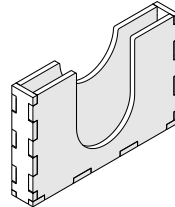

Sheet 3

Step 1

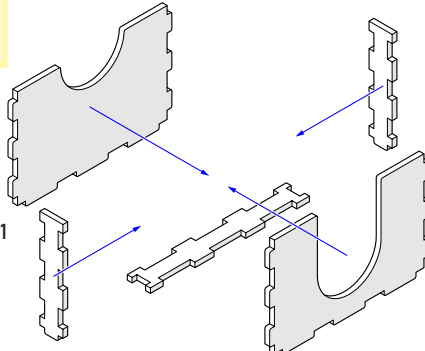



ONE SMART BOX Fallout® Organizer

FTOR01
Compatible with Fallout® and its expansions
Assembly Guide

S.P.E.C.I.A.L. and Caps Token Tray



Intended for S.P.E.C.I.A.L.
Tokens and Caps Tokens.

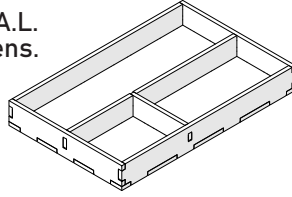

Sheet 4

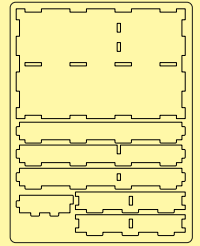

Step 1

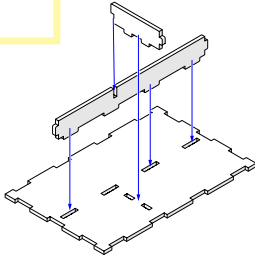

Step 2

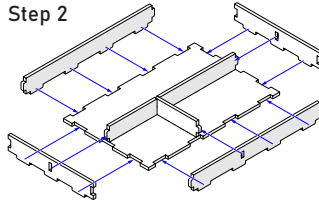

Mini Cardholder 1



Intended for Mini Cards.
Follow engraved symbols.

Sheets 5,6

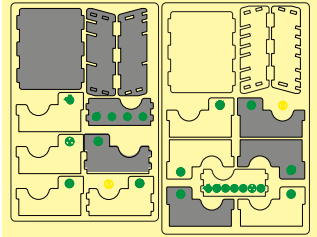

Step 2

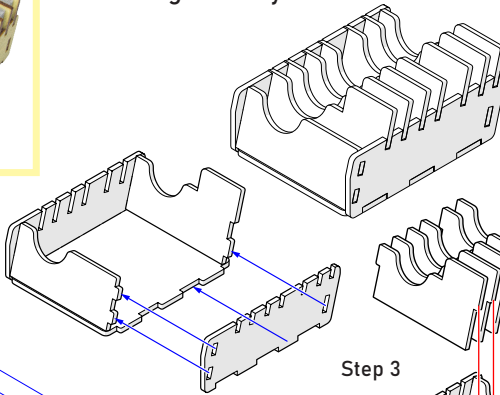

Step 1

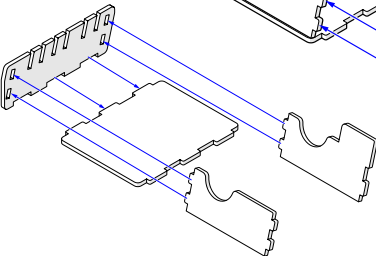

Step 3

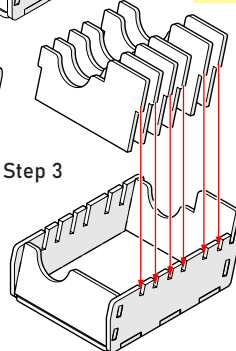

Please note that the
engraving must be
on the outside of
the box.



ONE SMART BOX Fallout® Organizer

FTOR01
Compatible with Fallout® and its expansions
Assembly Guide

Mini Cardholder 2



Intended for Mini Cards.
Follow engraved symbols.

Sheets 5,6

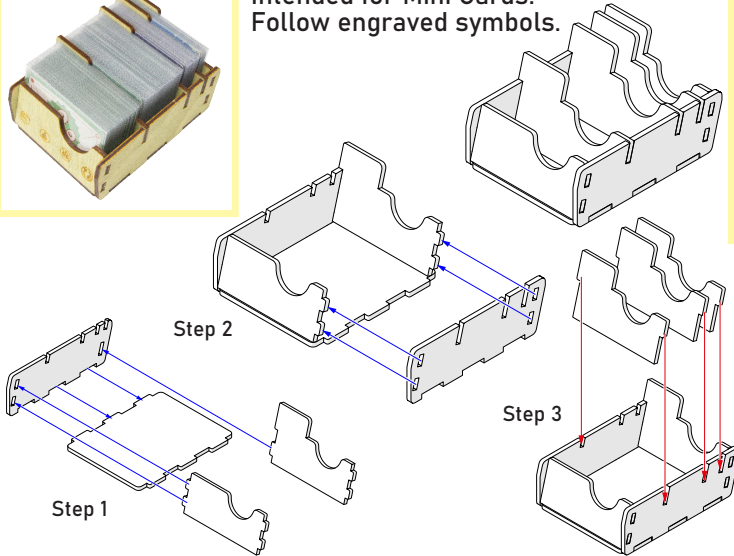
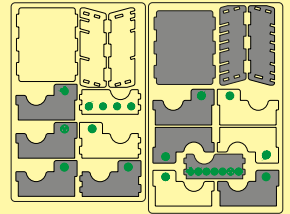

Please note that the engraving must be on the outside of the box.

Map Tile Holder *2



Intended for Map Tiles.

Sheet 9

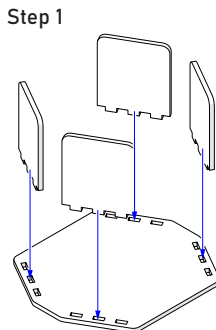
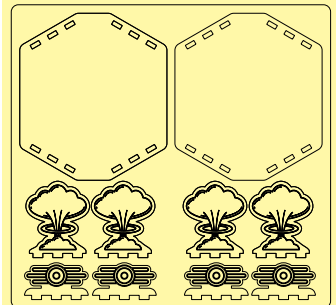

Please note that the engraving must be on the outside of the box.



ONE SMART BOX Fallout® Organizer

FTOR01
Compatible with Fallout® and its expansions
Assembly Guide

Power and Enemy Token Tray

Intended for Power, Enemy
and C.A.M.P. Tokens.

Sheet 7

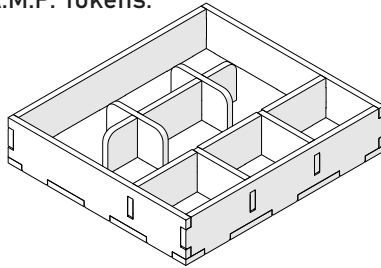
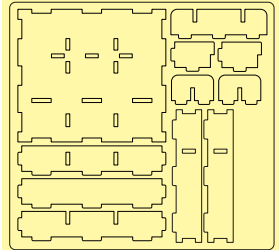

Step 1

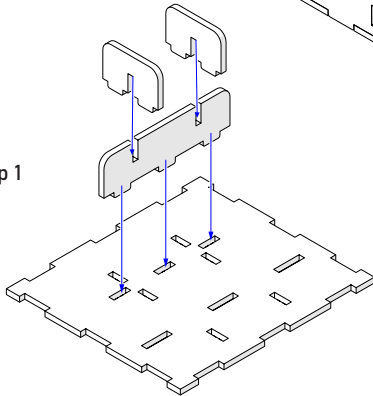

Step 2

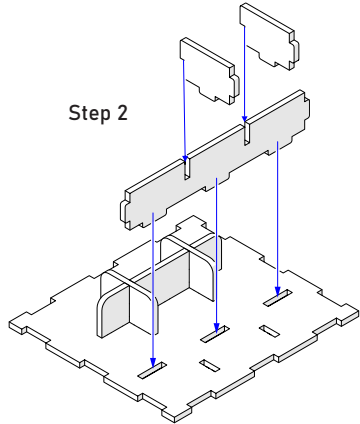

Step 3

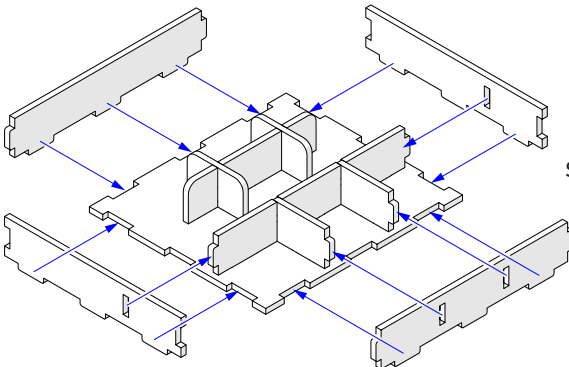



ONE SMART BOX Fallout® Organizer

FTOR01
Compatible with Fallout® and its expansions
Assembly Guide

Trait and Quest Token Tray (top)

Intended for Trait Tokens
and Quest Tokens.

Sheet 8

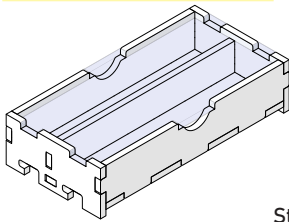
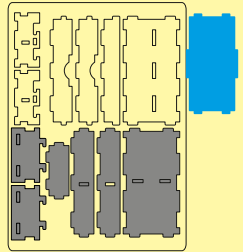

Step 1

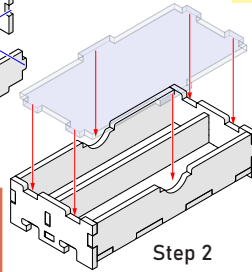
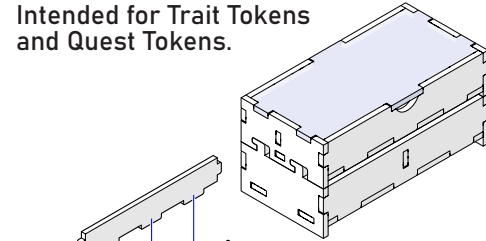

Step 2

Please note
that the mounts
must point to
one side as two
trays are held
together for
easy storage.

Until the glue has completely dried, make sure
the lid fits the tray and can be easily removed.
Put it back in its place on the tray. Only then
carefully remove the protective covering.

Pegs and Dice Tray (bottom)

Intended for Pegs
and V.A.T.S. Dice.

Sheet 8

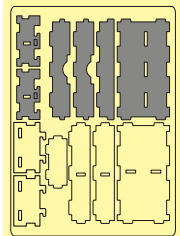

Step 1

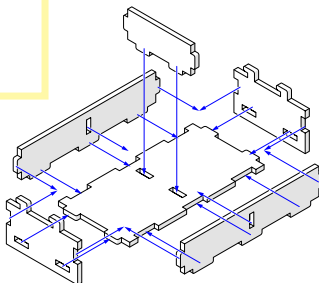

Please note that the
mounts must point
to one side as two
trays are held
together for
easy storage.



ONE SMART BOX Fallout® Organizer

FTOR01
Compatible with Fallout® and its expansions
Assembly Guide

Character Stand



Intended for Character Miniatures
and Character S.P.E.C.I.A.L. Tokens.

Sheets 10,11

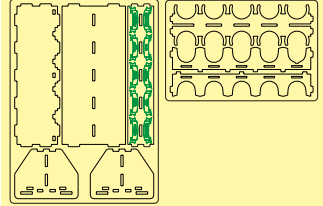

Step 1

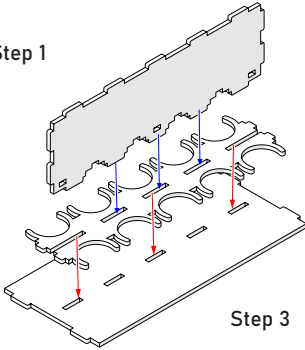

Step 2

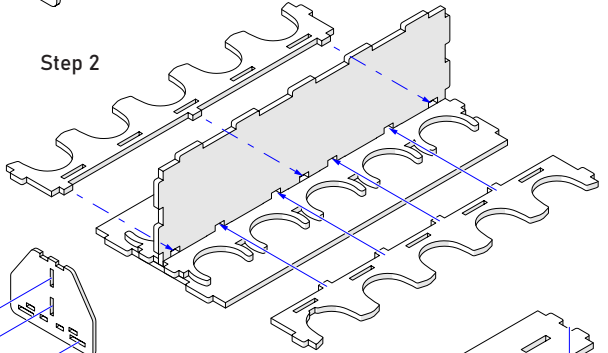

Step 3

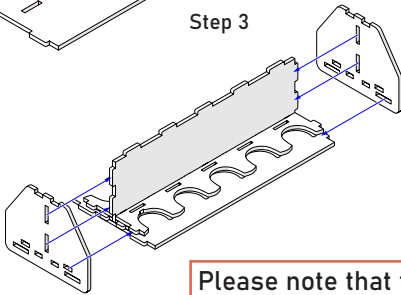

Step 4

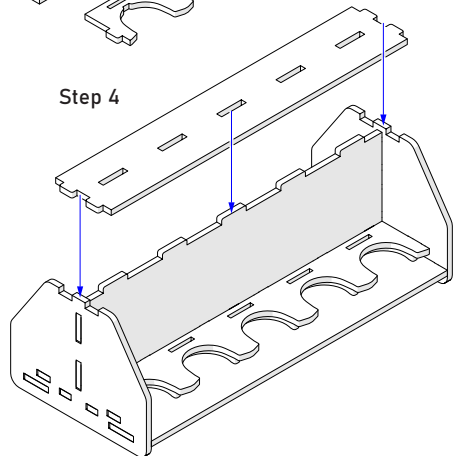

Please note that the engraving must be on the outside of the box.

Please note that there is a specific place for Mister Handy miniature with a special recess for his hand.



ONE SMART BOX

Some other SMONEX products:

XIA XAOR01



Scythe SEOR01





Welcome to <https://smonex.com>.

If something is damaged or broken, please do not return the whole set. Contact us directly on email info@smonex.com or our website smonex.com.

Any questions or issues with the Smonex products, we'll do our best to help you. Your satisfaction of it is our top priority.

Thanks for choosing Smonex product. We would be grateful for your feedback, which inspires us and helps to develop further. We'll gladly help you on any matter if you contact us on info@smonex.com.

Share your photos with [#smonex](https://twitter.com/Smonex_com) and follow us for all the updates:

 <https://www.facebook.com/Smonexcom>

 https://www.instagram.com/smonex_com/

 https://twitter.com/Smonex_com

 https://www.pinterest.com/smonex/_shop/

 <https://www.youtube.com/c/SmonexSmartOneBox>



Scan QR-code to visit or follow Smonex.