



Betrayal at House on the Hill® Organizer

BLOR01

Compatible with Betrayal at House on the Hill®
Assembly Guide



<https://smonex.com>

NOT A CHILDREN TOY
AGE 14+

Created for:

- Betrayal at House on the Hill
- Betrayal at House on the Hill: Widow's Walk
- Promo Cards

Betrayal at House on the Hill® is a registered trademark of Wizards of the Coast LLC. Any mention of Betrayal at House on the Hill® is for reference purposes only. ALL RIGHTS RESERVED by their respective trademark holders. No challenge to any intellectual property rights is intended or implied by representations of compatibility and no endorsements of any of our products by any other company is implied or represented.



Betrayal at House on the Hill® Organizer

BLOR01
Compatible with Betrayal at House on the Hill®
Assembly Guide

Tips and tricks

- To assemble each tray you need a wood glue for extra strength. (We recommend Titebond 2 Wood Glue or Beacon 527)
- Please make sure you assembled each tray correctly before gluing it together.
- Use stationery knife to cut the bits that connect details to the frame.
- Remove the details from the frame with a rotational motion along the axis formed by the bits you just cut.
- Use stationery knife and sandpaper to remove all the remaining connection bits.
- You may fix the box with rubber bands after gluing it. This will save you time and simplify the assembly.
- Use a hairdryer for easier removal of the protective covering from acrylic details. Just heat the acrylic surface a little to remove the covering much easier!
- Leave your finished insert overnight to dry completely.

Assembly Supplies



Wood-glue



Stationery knife



Hammer



Cotton swab



Rubber bands



Hairdryer

IMPORTANT: Assemble each tray one by one. Please DO NOT take out all the parts from the sheets and mix them. Even though some parts look similar, they are not interchangeable.



Betrayal at House on the Hill® Organizer

BLOR01
Compatible with Betrayal at House on the Hill®
Assembly Guide

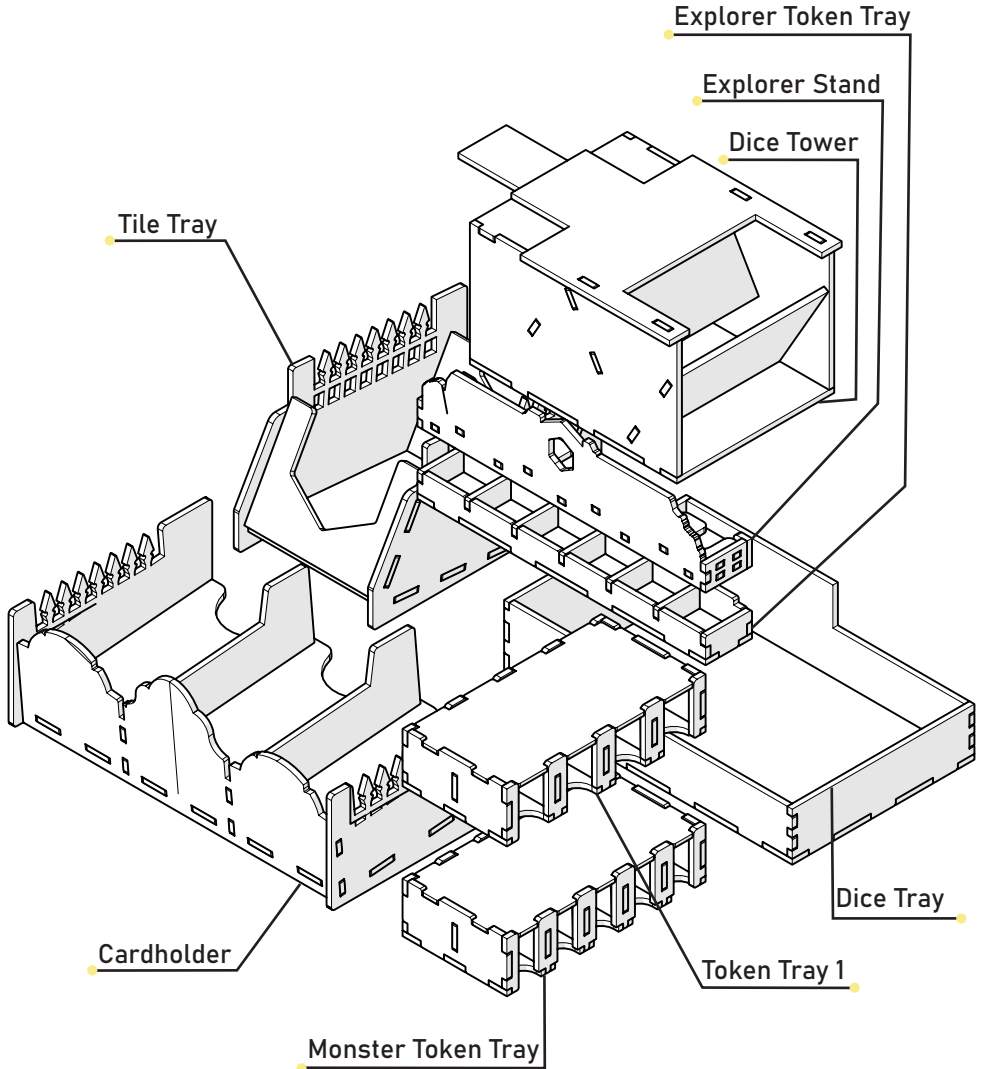

This is a non-licensed product. ALL RIGHTS RESERVED by their respective trademark holders. No challenge to any intellectual property rights is intended or implied by representations of compatibility and no endorsements of any of our products by any other company is implied or represented.



Betrayal at House on the Hill® Organizer

BLOR01
Compatible with Betrayal at House on the Hill®
Assembly Guide

- Brief assembly instructions:**
1. Unpack and arrange the sheets in order.
 2. Compare details on the sheets with details in the pictures of the guide.
 3. Study the pictures of unassembled product.
 4. Start your assembly, taking the necessary parts out of the sheets in a certain order.

Sheet 1

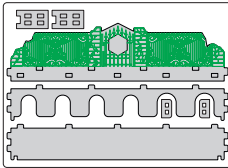

Sheet 2

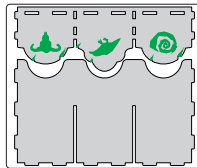

Sheet 3

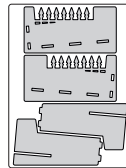

Sheet 4

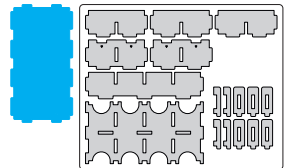

Sheet 5

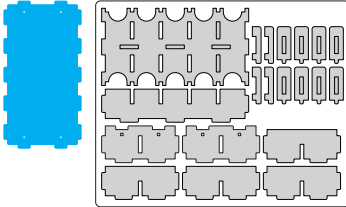

Sheet 6

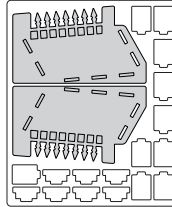

Sheet 7

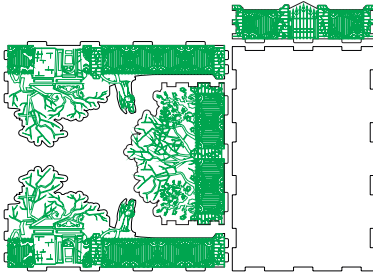
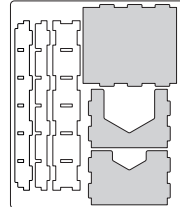

Legend:

- Highlighted details to be extruded
- Details not used in this assembly
- Details to be connected without glue
- Details to be glued

Components:

- 6 sheets extrusion molds
- 13 separate pieces
- 2 acrylic lids
- 1 sandpaper for stripping parts
- Assembly guide

This is a non-licensed product. ALL RIGHTS RESERVED by their respective trademark holders. No challenge to any intellectual property rights is intended or implied by representations of compatibility and no endorsements of any of our products by any other company is implied or represented.



Betrayal at House on the Hill® Organizer

BLOR01
Compatible with Betrayal at House on the Hill®
Assembly Guide

Explorer Stand

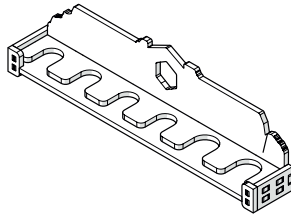

Sheet 1

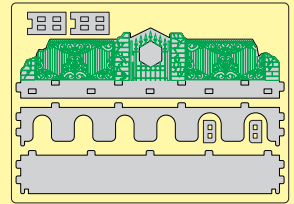

Step 1

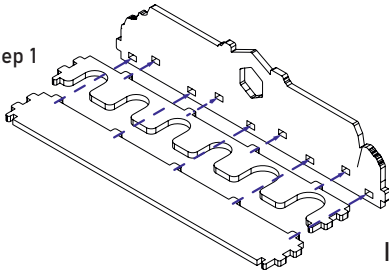

Step 2

Intended for plastic explorer figures.

Cardholder

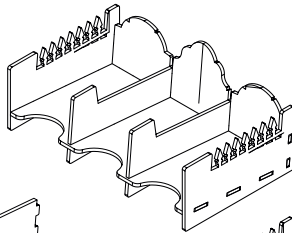
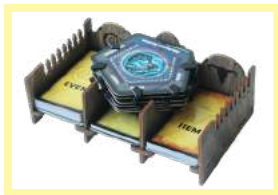

Sheet 2,3

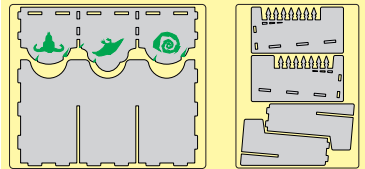

Step 1

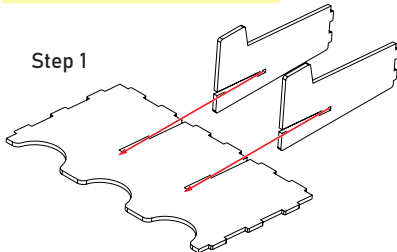

Step 2

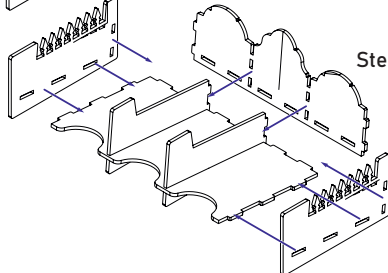

Intended for all the cards in the game:
two-sided character cards with plastic clips, omen, item and event cards.

This is a non-licensed product. ALL RIGHTS RESERVED by their respective trademark holders. No challenge to any intellectual property rights is intended or implied by representations of compatibility and no endorsements of any of our products by any other company is implied or represented.



Betrayal at House on the Hill® Organizer

BLOR01
Compatible with Betrayal at House on the Hill®
Assembly Guide

Token Tray 1

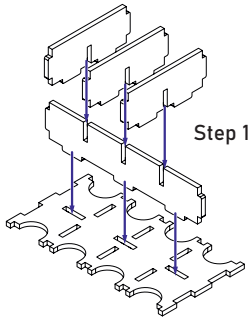
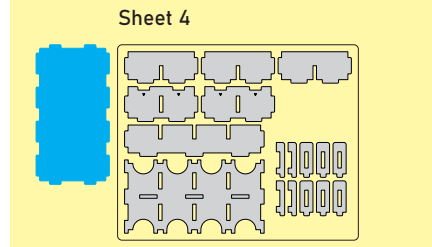
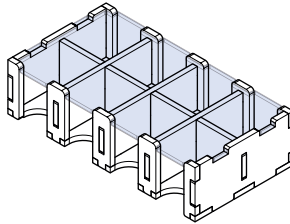

Step 1

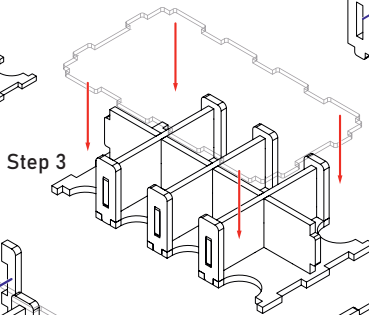

Step 3

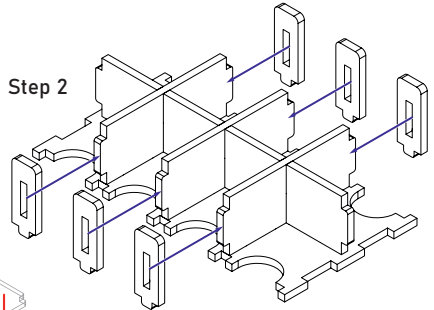

Step 2

Intended for square event and room tokens, pentagonal item tokens, triangular trait roll tokens, large circular monster tokens.

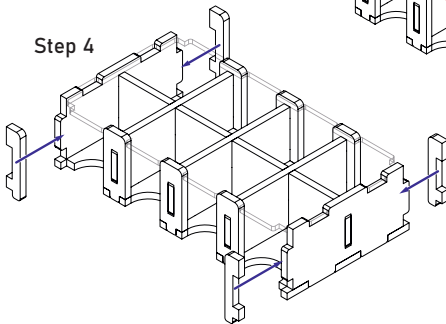

Step 4

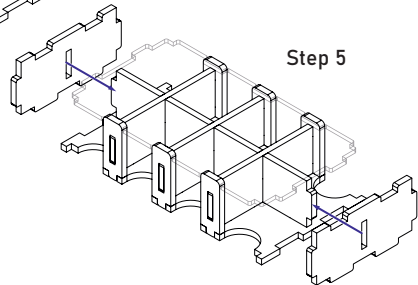

Step 5

Attention: Until the glue has completely dried, make sure the lid with triangle cutouts fits the tray and can be easily removed. Put it back in its place on the tray. After all remove the protective covering.

This is a non-licensed product. ALL RIGHTS RESERVED by their respective trademark holders. No challenge to any intellectual property rights is intended or implied by representations of compatibility and no endorsements of any of our products by any other company is implied or represented.



Betrayal at House on the Hill® Organizer

BLOR01
Compatible with Betrayal at House on the Hill®
Assembly Guide

Monster Token Tray

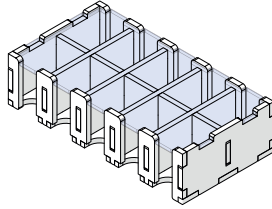

Sheets 5, 6

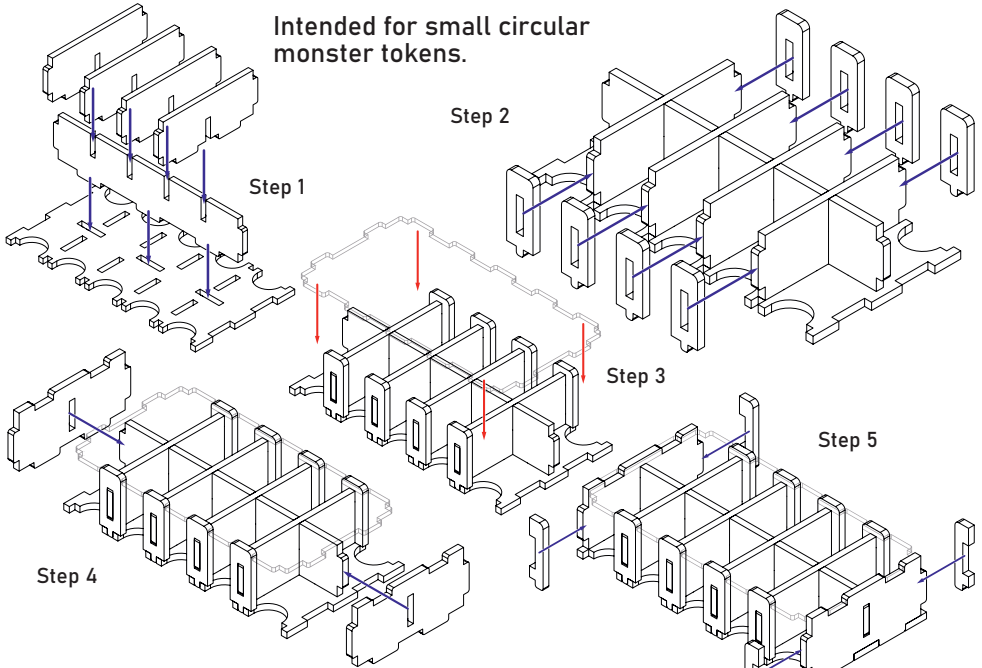
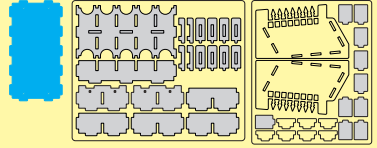

Pieces from sheet 6 should be placed at the bottom of each cell for easier token retrieval.

Attention: Until the glue has completely dried, make sure the lid with square cutouts fits the tray and can be easily removed. Put it back in its place on the tray. After all remove the protective covering.

This is a non-licensed product. ALL RIGHTS RESERVED by their respective trademark holders. No challenge to any intellectual property rights is intended or implied by representations of compatibility and no endorsements of any of our products by any other company is implied or represented.



Betrayal at House on the Hill® Organizer

BLOR01
Compatible with Betrayal at House on the Hill®
Assembly Guide

Tile Tray



Intended for room tiles.

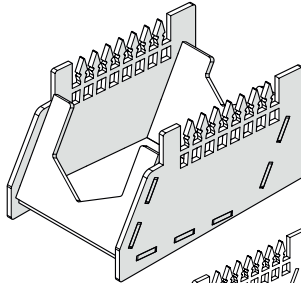

Sheets 6,7

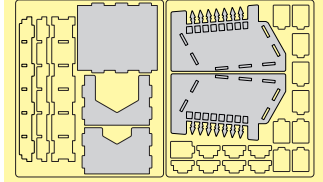

Step 1

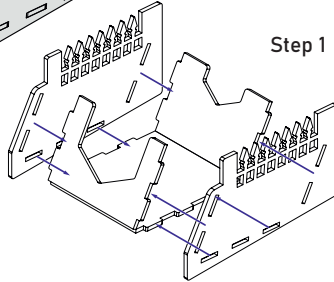

Explorer Token Tray



Intended for small circular explorer tokens.

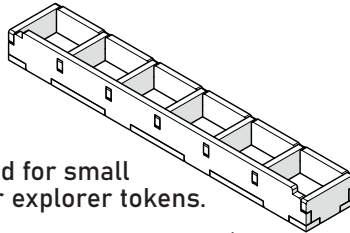

Sheets 6,7

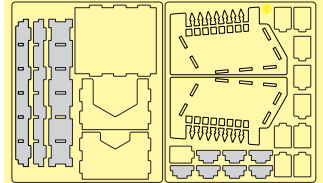

Step 2

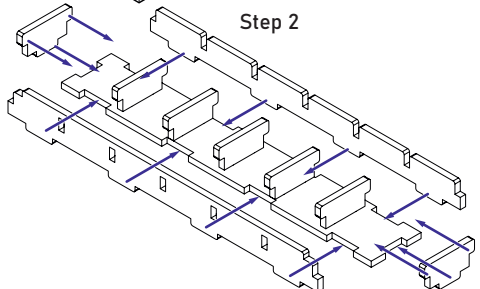
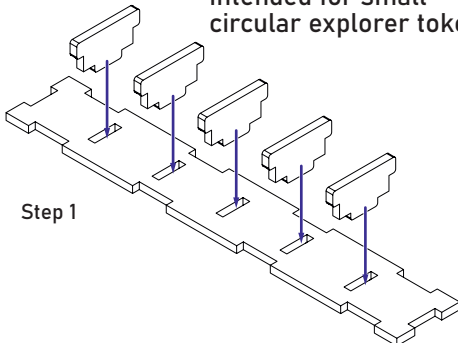

This is a non-licensed product. ALL RIGHTS RESERVED by their respective trademark holders. No challenge to any intellectual property rights is intended or implied by representations of compatibility and no endorsements of any of our products by any other company is implied or represented.



Betrayal at House on the Hill® Organizer

BLOR01
Compatible with Betrayal at House on the Hill®
Assembly Guide

Dice Tower and Tray



Intended for dice rolling.

Dice Tray

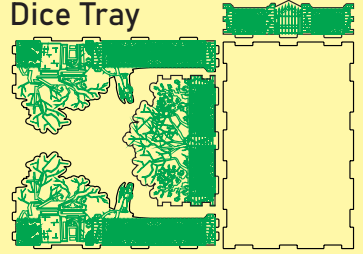

Step 1

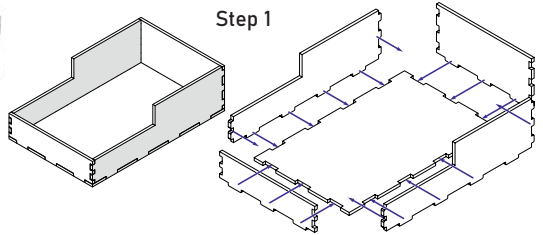

Dice Tower

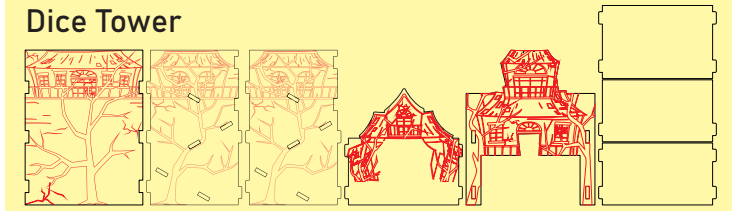

Step 1

Step 2

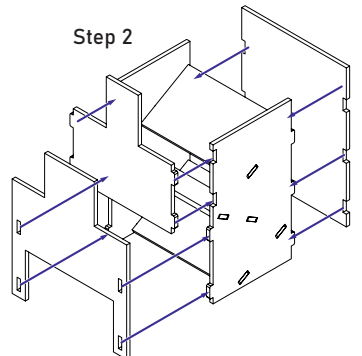
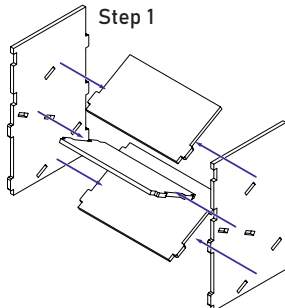
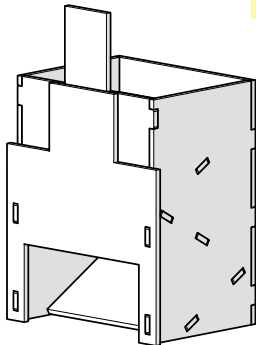

This is a non-licensed product. ALL RIGHTS RESERVED by their respective trademark holders. No challenge to any intellectual property rights is intended or implied by representations of compatibility and no endorsements of any of our products by any other company is implied or represented.



ONE SMART BOX

Some other SMONEX products:

Terraforming Mars Organizer TMOR01



Gloomhaven Organizer GNOR01



If something is damaged or broken, please do not return the whole set. Contact us directly on email info@smonex.com or our website smonex.com. Any questions or issues with the Smonex products, we'll do our best to help you. Your satisfaction of it is our top priority.

Welcome to <https://smonex.com>.

Thanks for choosing Smonex product. We would be grateful for your feedback, which inspires us and helps to develop further. We'll gladly help you on any matter if you contact us on info@smonex.com.

Share your photos with #smonex and follow us for all the updates:

 <https://www.facebook.com/Smonexcom>

 https://www.instagram.com/smonex_com/

 https://twitter.com/Smonex_com

 https://www.pinterest.com/smonex/_shop/

 <https://www.youtube.com/c/SmonexSmartOneBox>



Scan QR-code to visit or follow Smonex.

This is a non-licensed product. ALL RIGHTS RESERVED by their respective trademark holders. No challenge to any intellectual property rights is intended or implied by representations of compatibility and no endorsements of any of our products by any other company is implied or represented.