



ONE SMART BOX

Architects of the West Kingdom Organizer

Compatible with Architects of The West Kingdom®
including Age of Artisans expansion + All Promo Packs
Assembly Guide



<https://smonex.com>

NOT A CHILDREN TOY
AGE 14+

Created for:

- Architects of The West Kingdom
- Architects of The West Kingdom: Age of Artisans
- All Promo Packs

Architects of The West Kingdom® is a registered trademark of Garphill Games. Any mention of Architects of The West Kingdom® is for reference purposes only. ALL RIGHTS RESERVED by their respective trademark holders. No challenge to any intellectual property rights is intended or implied by representations of compatibility and no endorsements of any of our products by any other company is implied or represented.



ONE SMART BOX

Architects of the West Kingdom Organizer

Compatible with Architects of The West Kingdom®
including Age of Artisans expansion + All Promo Packs
Assembly Guide

Tips and tricks

- To assemble each tray you need a wood glue for extra strength. (We recommend Titebond 2 Wood Glue or Beacon 527)
- Please make sure you assembled each tray correctly before gluing it together.
- Use stationery knife to cut the bits that connect details to the frame.
- Remove the details from the frame with a rotational motion along the axis formed by the bits you just cut.
- Use stationery knife and sandpaper to remove all the remaining connection bits.
- You may fix the box with rubber bands after gluing it. This will save you time and simplify the assembly.
- Make sure to remove the protective covering from both sides of the acrylic pieces. Use a hairdryer for easier removal of it if necessary. Just heat the acrylic surface a little to remove the covering much easier!
- Leave your finished insert overnight to dry completely.

Assembly Supplies



Wood-glue



Stationery knife



Hammer



Cotton swab



Rubber bands



Hairdryer

If something is damaged or broken, please do not return the whole set. Contact us directly on email info@smonex.com or our website smonex.com. Any questions or issues with the Smonex products, we'll do our best to help you. We want our customers to be completely satisfied.

IMPORTANT: Assemble each tray one by one. Please DO NOT take out all the parts from the sheets and mix them. Even though some parts look similar, they are not interchangeable.



ONE SMART BOX

Architects of the West Kingdom Organizer

Compatible with Architects of The West Kingdom®
including Age of Artisans expansion + All Promo Packs
Assembly Guide

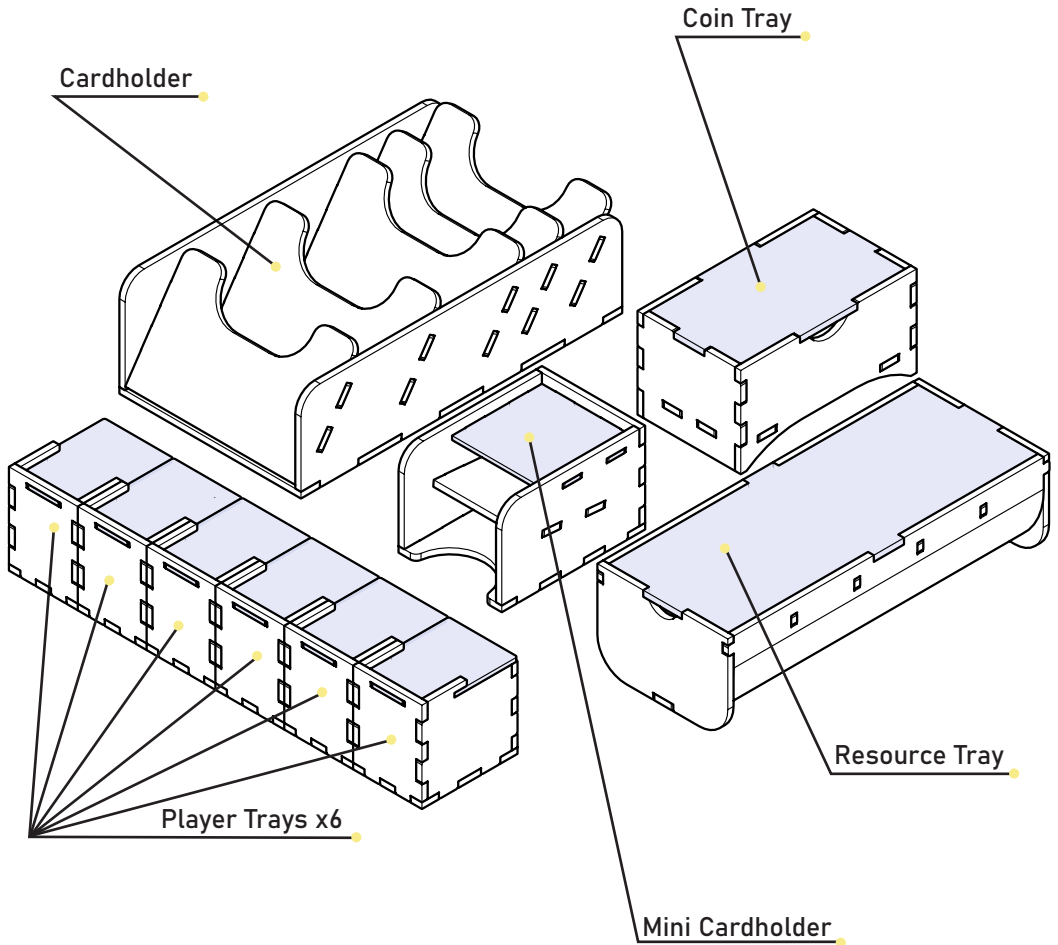



ONE SMART BOX

Architects of the West Kingdom Organizer

Compatible with Architects of The West Kingdom®
including Age of Artisans expansion + All Promo Packs
Assembly Guide

- Brief assembly instructions:**
1. Unpack and arrange the sheets in order.
 2. Compare details on the sheets with details in the pictures of the guide.
 3. Study the pictures of unassembled product.
 4. Start your assembly, taking the necessary parts out of the sheets in a certain order.

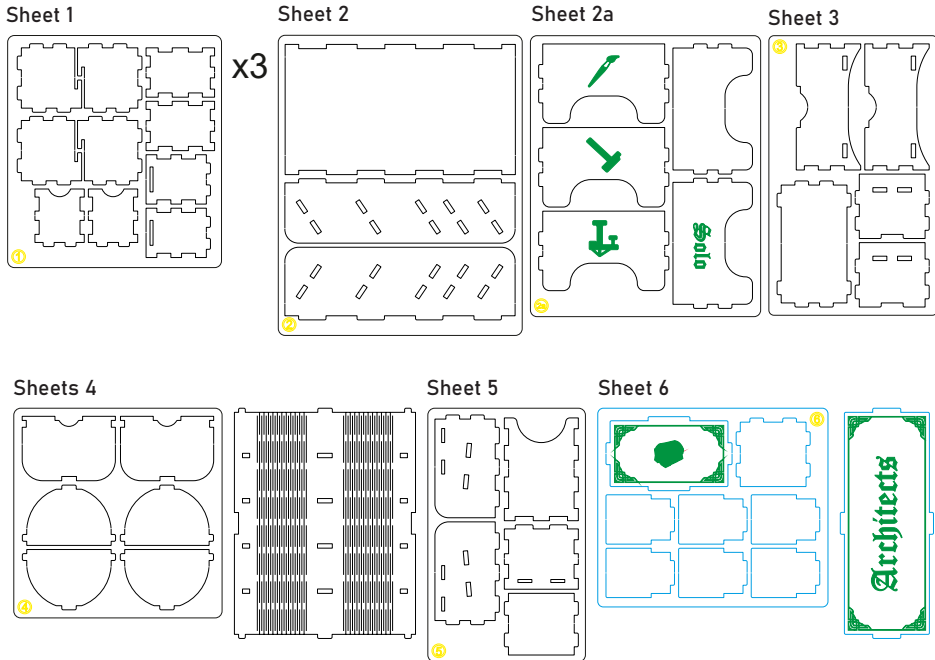

Legend:

- Highlighted details to be extruded
- Details not used in this assembly
- Details to be connected without glue
- Details to be glued

Components:

- 8 sheets extrusion molds
- 1 flexible sheet
- 1 acrylic sheet extrusion molds
- 1 large acrylic cover
- 1 sandpaper for stripping parts
- Assembly guide



ONE SMART BOX

Architects of the West Kingdom Organizer

Compatible with Architects of The West Kingdom®
including Age of Artisans expansion + All Promo Packs
Assembly Guide

Player Tray x6

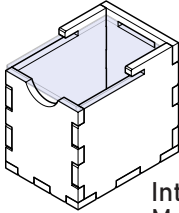

Intended for Player
Markers and Workers.

Sheets 1, 6

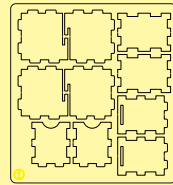

x3

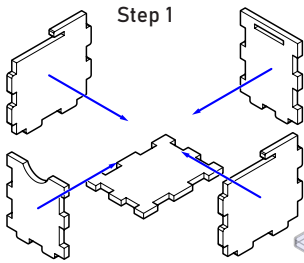
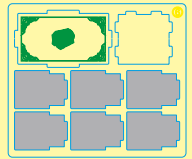

Step 1

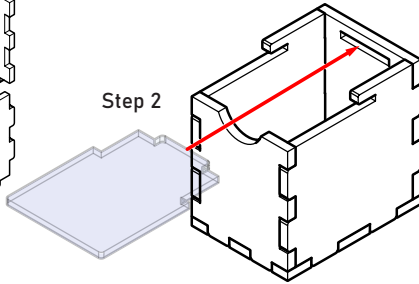

Step 2

Until the glue has completely dried, make sure the lid fits the tray and can be easily removed. Put it back in its place on the tray. Only then carefully remove the protective covering.

Cardholder

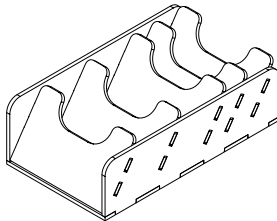
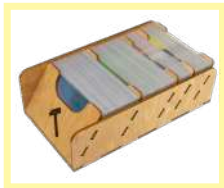

Sheets 2, 2a

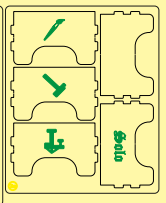
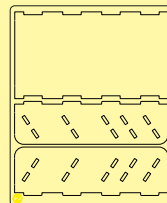

Step 1

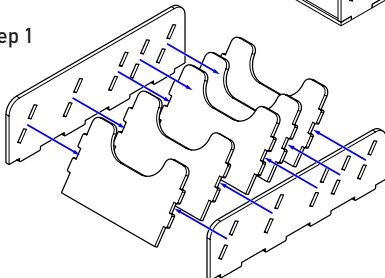

Step 2

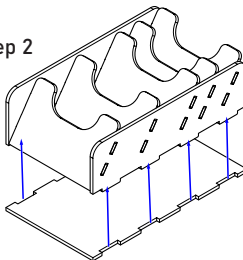

Intended for Apprentice
Cards and Building Cards.



ONE SMART BOX

Architects of the West Kingdom Organizer

Compatible with Architects of The West Kingdom®
including Age of Artisans expansion + All Promo Packs
Assembly Guide

Coin Tray

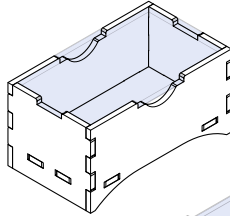

Intended for
Silver Coins.

Sheets 3, 6

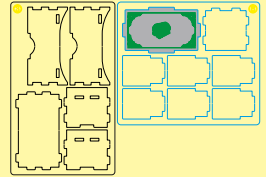

Step 1

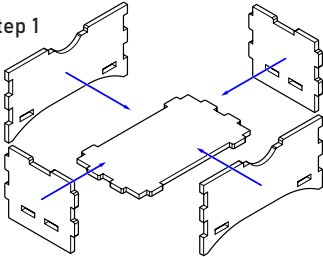

Step 2

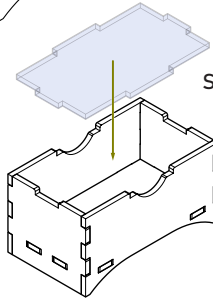

Until the glue has completely dried, make sure the lid fits the tray and can be easily removed. Put it back in its place on the tray. Only then carefully remove the protective covering.

Mini Cardholder



Intended for Black Market, Debt,
Reward and Multiplier Cards.

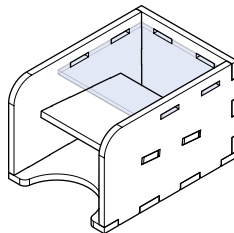

Sheets 5, 6

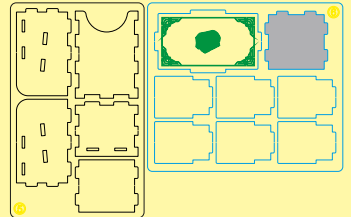

Step 1

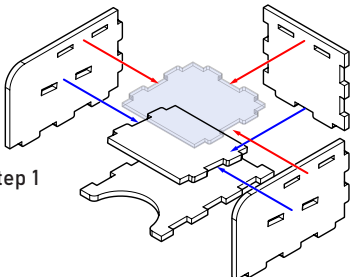

Until the glue has completely dried, make sure the lid fits the tray and can be easily removed. Put it back in its place on the tray. Only then carefully remove the protective covering.



ONE SMART BOX

Architects of the West Kingdom Organizer

Compatible with Architects of The West Kingdom®
including Age of Artisans expansion + All Promo Packs
Assembly Guide

Resource Tray

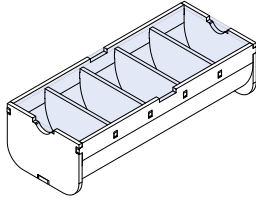

Sheets 4, Flexible sheet, Large Acrylic Cover

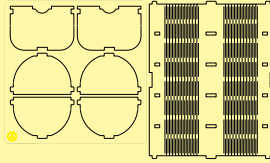

Architects

Step 1

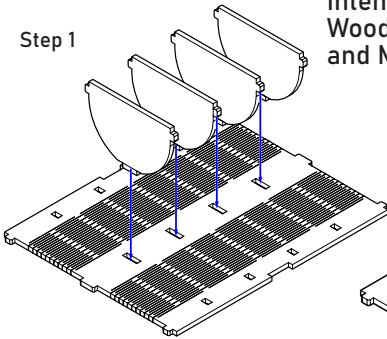

Intended for Clay,
Wood, Stone, Gold
and Marble Tokens.

Step 2

Bend the flexible
sheet carefully
according to the
scheme.

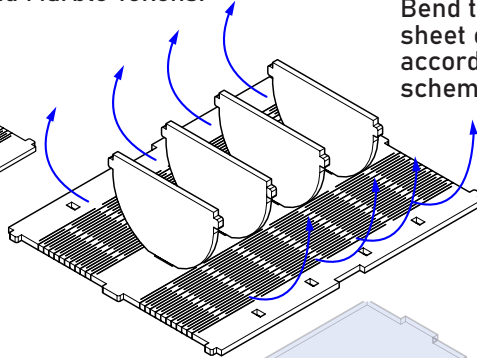

Step 3

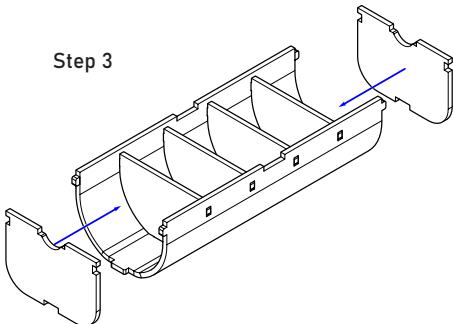

Step 4

Until the glue has completely
dried, make sure the lid fits the
tray and can be easily removed.
Put it back in its place on the
tray. Only then carefully remove
the protective covering.



ONE SMART BOX

Some other SMONEX products:

Settlers of Catan®
Game Board Set CNOR01

The Castles of Burgundy®
(20th Anniversary Edition)
Organizer CBOR01



Welcome to <https://smonex.com>.

If something is damaged or broken, please do not return the whole set. Contact us directly on email info@smonex.com or our website smonex.com.

Any questions or issues with the Smonex products, we'll do our best to help you. Your satisfaction of it is our top priority.

Thanks for choosing Smonex product. We would be grateful for your feedback, which inspires us and helps to develop further.

We'll gladly help you on any matter if you contact us on info@smonex.com.

Share your photos with #smonex and follow us for all the updates:

<https://www.facebook.com/Smonexcom>

https://www.instagram.com/smonex_com/

https://twitter.com/Smonex_com

https://www.pinterest.com/smonex/_shop/

<https://www.youtube.com/c/SmonexSmartOneBox>



Scan QR-code to visit or follow Smonex.