



Item # _____
 Model # _____
 Quantity _____
 Project # _____

SPECIFICATIONS & FEATURES

Model PSE-2004LA

Large Commercial Four Deep Basin Sink

Monsam's Large Commercial Four Deep Basin Portable Sink helps you combine a busy cleaning schedule with handwashing requirements.

The PSE 2004LA is uniquely designed with a separate handwashing station that meets health and hygiene standards. With drain boards and a backsplash and available in a variety of colors, this sturdy model can be used indoors or outdoors.



Features

- Designed for cleaning utensil and cooking equipment and hand-washing requirements
- Contains one 5 gallon tank for fresh water, and one 7 gallon tank for waste water.

PLUS AN EXTRA FREE SET OF TANKS

- Contains three 12" deep basins to wash, rinse and sanitize cooking utensils
- Includes two 18" x 18" drain boards
- Features an 11" backsplash
- Equipped with a 4.5 gallon adjustable heater that can be set from 95 degrees Fahrenheit to 155 degrees Fahrenheit
- **ALSO AVAILABLE WITH PROPANE WATER HEATER**
- Comes with six swivel casters with locking brakes
- Built with a sturdy aluminum bar frame and heavy duty solid plastic panels
- Available in 6 colors: Black, White, Grey, Red, Blue, or Maple
- Three Years Warranty

This item has met the following Certifications & Approvals

NSF Stainless Steel Sink is NSF Certified

NSF, CSA Water Pump

UL Water Heater



Note: Dimensions and specifications subject to change without notice.

Monsam Enterprises, Inc • 2685 Pittsburg/Antioch Hwy • Antioch, CA 94509
 Phone: 925-757-3924 or 800-513-8562 • Fax: 925-757-3681 • Email: sales@portablesink.com

www.portablesink.com



Item # _____
 Model # _____
 Quantity _____
 Project # _____

DIMENSIONS & SPECIFICATIONS

Model PSE-2004LA

Large Commercial Four Deep Basin Sink

Available Colors (Outside panels)
 White • Black • Grey • Maple • Red • Blue

Shipping Dimensions: 106.75 in. x 24 in. x 50 in.
 Shipping Weight: 450 lbs.

Approvals: NSF Stainless Steel Sink is NSF Certified
 NSF, CSA Water Pump, UL Water Heater

Electrical: 110 Volt, 13 Amps

Basin Measurements		
	(3 Basins)	(Handwashing)
Width:	18"	18"
Length:	18"	18"
Depth:	12"	5"

- Options:**
- Electric Foot Switch
 - Garden Hose Connector
 - Cutting Board

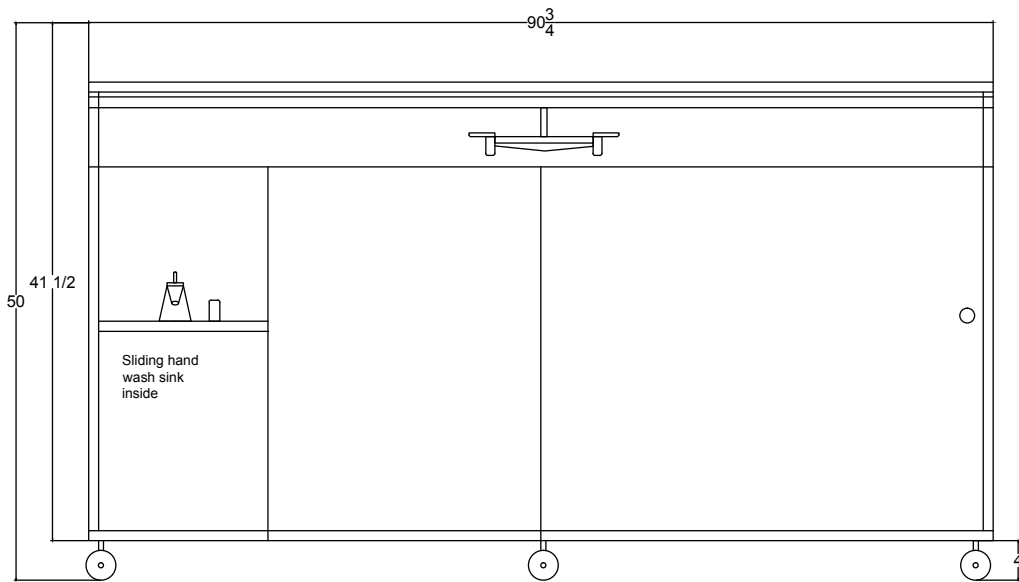

Front View
 Model: PSE-2003LA

Note: Dimensions and specs subject to change without notice.

Monsam Enterprises, Inc • 2685 Pittsburg/Antioch Hwy • Antioch, CA 94509
 Phone: 925-757-3924 or 800-513-8562 • Fax: 925-757-3681 • Email: sales@portablesink.com

www.portablesink.com