

Tarping Systems, Inc.

Crank and Pull

Cab Level Crank Manual Tarp System Installation Instructions



We would like to congratulate you on your purchase of your new Tarping System, Inc. tarp system. Our products are constructed of the highest quality materials. If you need support at any time through the installation process feel free to contact your rep at **888-838-3229**.

WARNING:

- Never operate tarp system while moving.

CAUTION:

- Read through instructions for entire system and follow directions thoroughly to ensure the system functions properly.

TOOLS REQUIRED:

- Ratchet
- 3/8", 1/2", 9/16", and 3/4" Sockets and Wrenches
- Welder- Steel and Aluminum (**optional**)
- Drill
- 3/8" and 1/2" Drill
- 1-1/2" Hole Saw
- Alan Wrench set

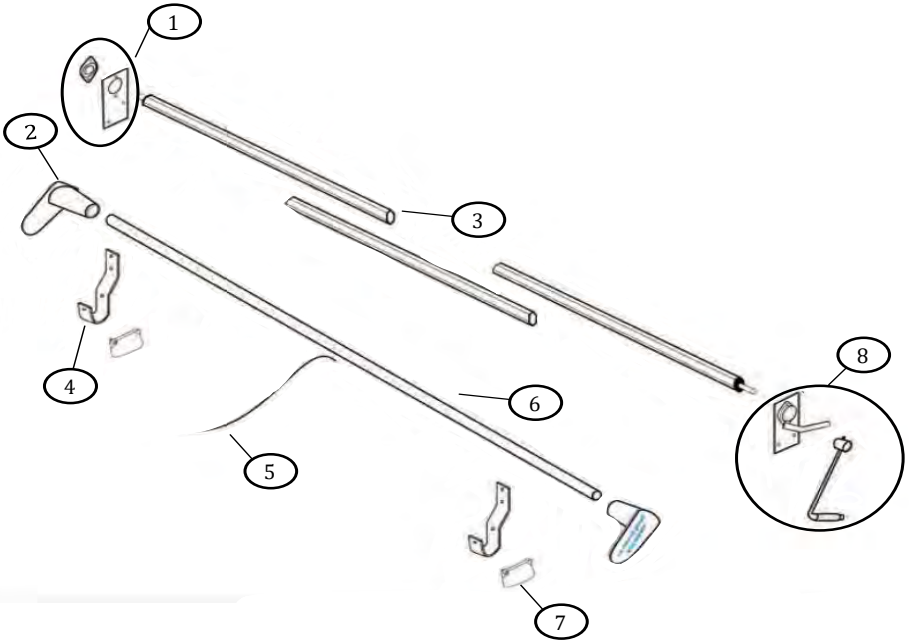

CAB LEVEL CRANK

NUMBER	PART NUMBER	QUANTITY REQUIRED	DESCRIPTION	COST
1	T-CABDSBA	1	DRIVER SIDE CAB LEVEL BRACKET AND HARDWARE	
2	T-AEFC	2	ALUMINUM END FOOT CAP	
3	T-CABLATA	1	CAB LEVEL ALUMINUM TARP AXLE	
4	T-RETAIN01	2	SINGLE RETAINER	
5	T-RETURN01	1	12' OF RETURN ROPE	
6	T-SCLPB	1	STEEL CAB LEVEL PULL BAR (94" OR 98" LONG)	
7	T-PIN01	2	SNAPPER PIN	
8	T-CABPSBA	1	PASSENGER SIDE CAB LEVEL BRACKET ASSEMBLY	

1. Determine the location of the tarp roller. The tarp roller should be mounted on top at the front of the trailer or above the cab on the dump body's cab guard. To prevent damage from loads being dumped into the body, the tarp roller should be mounted outside of the dump body's load area. Also, verify the location is accessible for winding the tarp up. (Figure 1)

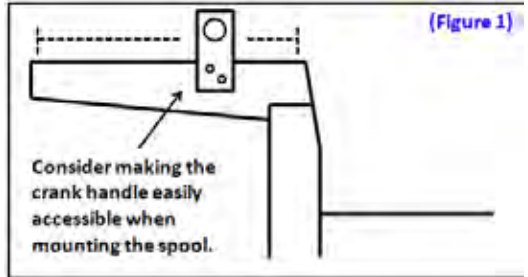

2. Clamp the bearing bracket assemblies (item 4&5) to the dump body in the locations determined in step 1. The bearing bracket assembly with the detent lever (item 1) is to be mounted on the driver's side of the dump body. Make sure the brackets are aligned vertically as well as from front to back by measuring from a common point on each side of the body. Verify the bearing bracket assemblies are mounted high enough to accommodate the tarp when rolled onto the roll bar assembly.

3. Mark the bearing bracket mounting hole's locations onto each side of the dump body. Remove the brackets and drill 13/32" holes in the four marked locations.

4. Assemble the bearing brackets to the dump body using the four 3/8-16 x 1 cap screws, lock washers and nuts supplied. Do not tighten fasteners at this time, just hand tighten to hold brackets in position.

5. Locate the inner hex tube (item 3) and make a pencil mark in the center of the tube's length. Insert the inner hex tube half way into the driver's side roll tube assembly. Insert the passenger's side roll tube assembly onto the opposite end of the inner hex tube. Measure the distance between the inside of the mounted bearing brackets (for measurements less than 81.75": The driver's and passenger's side roll tube assemblies will need to be shortened by an equal amount to obtain the proper width). Separate the roll tubes, so the length of the

of the complete roll tube assembly from adaptor to adaptor is 1/4" less than the distance between mount brackets. Locate the pencil mark, and verify that the inner hex tube is centered inside the outer roll tube assemblies. Screw each roll tube assembly to the inner hex tube using one 1/4" x 1" self drilling and taping screw 2" from the end of the outer tube.

6. Align the short end of the tarp that has the grommets only with the tarp axle. Verify that the webbing in the seams of the tarp will be on the bottom when installed. Note: The roll tube end of the tarp only has one row of webbing with grommets. (no pocket)

7. Center the tarp on the roll tube assembly, holding the tarp tightly. Place the 1/4" x 1" self tapping screws and fender washers. Make sure the screws are centered in the hex tube and thru the grommets. Be careful not to screw into the shaft adapters on each end.

8. Remove one of the bearing bracket assemblies and slide the tarp roll assembly in to the remaining bearing. Slide removed bearing bracket over shaft and reassemble to the dump body. Tighten 3/8" bracket mounting bolts at this time.

9. Center the tarp roll assembly between the mounting brackets and tighten set screws in each bearing race.

10. Assemble sprocket onto the 1" shaft of the driver's side roll tube assembly (item 1). With the detent lever in the open position, slide the sprocket down the shaft until it is tight against the bearing. **MAKE SURE ALL FASTENERS ARE TIGHT ON THE CRANK HANDLE.**

11. Assemble crank handle assembly (item 1) onto the driver's side roll tube shaft using the 1/4" X 2" screw and lock nut provided.

12. Assemble pull rope assembly to the center grommet on the rear of the tarp. (See figure 3.)

13. Assemble two rope storage hooks to the dump body tailgate to wrap the pull rope for storage when tarp is covering the body. The hooks should be mounted horizontally and may be bolted (bolts not included) or welded to the dump body. The recommend distance between the hooks is 15-17". (See figure 3.)

14. Assemble two rope storage hooks (item 3) to the side dump body near the crank handle

assembly to wrap the pull rope for storage when tarp is retracted. The hooks should be mounted vertically and may be bolted (bolts not included) or welded to the dump body. (See figure 2.)

Optional Accessory

Optional Pull Bar Kit Installation [T-CABLCK294 (94" LONG PULL BAR) T-CABLCK298 (98" LONG PULL BAR)] *Note: For tarps narrower than 6 feet the center tube will need to be shortened and re-drilled.*

1. Slide rear pull bar (item 6) into the pocket in the rear of the dump body tarp. Center the bar in the tarp. The same amount of bar should be exposed on each side of the tarp.

4. After the rear bar is centered to fit the tarp, the excess bar may be cut off to limit the amount of bar protruding outside the body. If the rear bars are cut, the cut ends should be painted to prevent premature rusting.

3. Attach the Aluminum End Foot Caps (ITEM 2) to both sides of the pull bar to complete the assembly

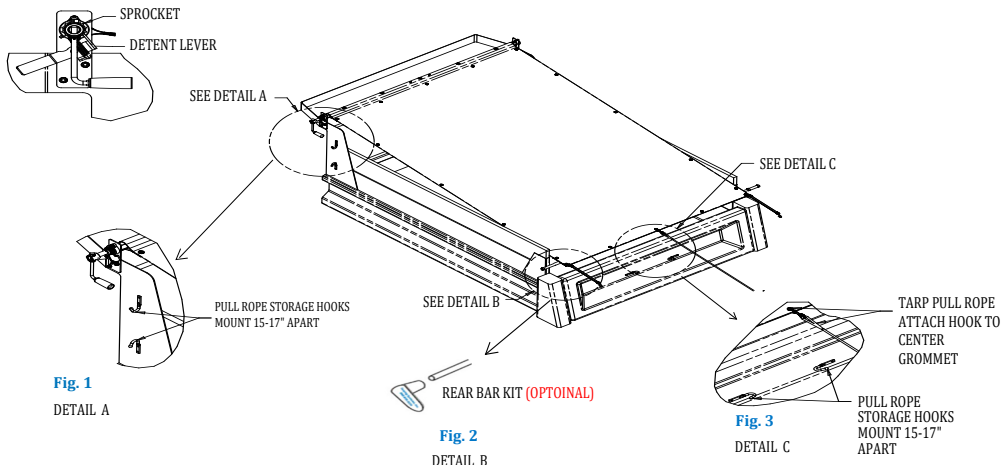

PLEASE MAKE SURE ALL BOLTS AND FASTENERS ARE FASTENED PROPERLY TO ENSURE SAFETY. EVEN ON PREASSEMBLED ITEMS.

MANUAL – CRANK ASSEMBLY INSTALLATION

INSTALLATION INSTRUCTIONS

STEP 5: ATTACHING THE CRANK BOX AND CHAIN

1. Choose a comfortable position that the crank handle can be operated from the ground. Mark this location. **Note: The crank box does not need to be directly below the sprocket.**
2. Wrap the #40 chain over the sprocket of the tarp spool and pull it through the center point of the area you marked as the location for the crank box. Trace a 6" line along the edge of the chain from the center point of the crank box toward the tarp spool.
3. Place the crank box back over the center point and angle it so the line is exiting the top of the box. **Note: If the box cannot be mounted because it extends past the edge of the box, repeat step 5-1 and 5-2.** Drill and mount the crank box.
4. Release the master link of the #40 chain, adjust the length of the chain, install the chain on both the crank box and the spool's sprocket bar.
5. Install the optional chain guard at this time.

OPTIONAL

