



# AutoEgg Litter Box Quick Start Guide

**PLEASE READ THIS ENTIRE GUIDE BEFORE BEGINNING**  
chillx.co



**We're constantly eveloving the AutoEgg,**  
get the latest quick start guide with videos at [support.chillx.co](https://support.chillx.co)

Follow our official Facebook Page (@ChillX.co)  
to get updates and responsive customer service  
**[fb.com/chillx.co](https://fb.com/chillx.co)**



Thank you  
for purchasing  
the ChillX AutoEgg  
self-cleaning litter box.

Finally, a Chill Pill that Works!

At ChillX, we aim to bring your more inner chill by  
resolving your everyday pain points with modern design.

This guide will help you get the most out of your  
AutoEgg. We will guide you through the setup process,  
as well as provide essential tips and advice.

Enjoy your ChillX AutoEgg, and have a ChillX day!

**#gotchillx**

## Package Includes

- x1 ChillX AutoEgg Base
- x1 ChillX AutoEgg Top Cover
- x1 5V/2A USB Wall Charger with Type-C Cable
- x1 Litter Scooper
- x1 Waste Drawer Liner Roll

## Get to Know Your ChillX AutoEgg

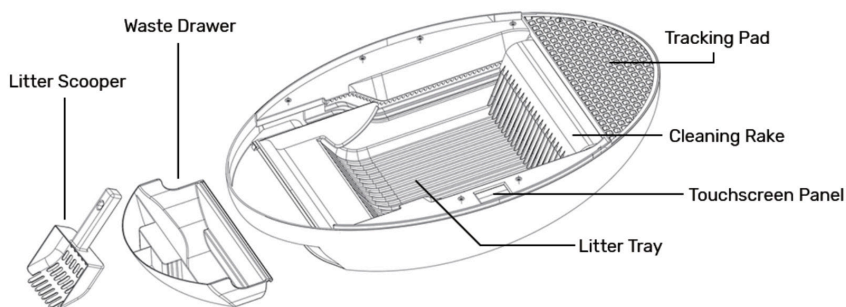

## Main Features

- **Automatic Self-Cleaning:** 5 mins after detecting the presence of 5+ g (0.17+ oz) of excretion; Plus, self-clean every day at 3 & 9 A.M., and 3 & 9 P.M. in automatic mode
- **Weight Log:** Records a log of date, time, duration, weight, and waste data for the last seven days on the touchscreen panel
- **Odor-Seal:** Traps litter in the waste drawer
- **Ultra-Silent:** Chill or sleep without disruptions

## Specifications

**Cat Supported:** 2 kg (4.4 lb.) to 7 kg (15.4 lb.)

**Maximum Load:** 20 kg (44 lb.)

**Gravity Sensor Accuracy:** 1 g (0.03 oz)

**Waste Drawer Capacity:** 2 L (122 ci)

**Eco-Friendly Material:** PP/ABS

**Power Adapter:** 5V/2A USB Type-C

**Product Weight:** 5 kg (11 lb.)

*Watch the video guide at [support.chillx.co](https://support.chillx.co)*

## 1. Remove Foam Spacers

Remove the anti-shock foam spacers from the AutoEgg base and rails.

## 2. Ensure Sturdy Placement

Find a firm and level floor surface for the AutoEgg near an electrical outlet.

**Avoid soft carpeted surfaces** – the automatic self-cleaning function fully relies on four gravity sensors on the bottom of AutoEgg. If you have to put the AutoEgg on carpet, please place a hard mat completely underneath the unit.

## 3. Plug the Type-Cable into the Base

Plug the USB Type-C cable into the socket on the bottom of the AutoEgg base. **DO NOT** plug the AC/DC adapter into a wall outlet yet.

## 4. Add Litter

Add clumping litter into the litter tray. For the best tracking control and litter saving, remain **in the middle of “Min” & “Max” line**. Never overfill.

**DO USE** fast- and hard-clumping clay cat litter with small particles.

**NEVER USE** silica gel crystals, recycled paper, tofu, pine, corn, or wheat litter.

## 5. Install the Liner

Put the litter drawer liner on the waste drawer drawer.

## 6. Attach the Top Cover

Align the tail end of the cover with the rear slot of the base.

Press downwards and inwards at the convex buckle.

## 7. Power the AutoEgg On

Plug the AC/DC adapter into a wall outlet. The cleaning rake of the AutoEgg will be reset to the starting positing automatically.

**Warning:** Whenever you add litter or move your AutoEgg, please unplug the power plug for five seconds and then plug it back in to re-activate the automatic self-cleaning function.

### Automatic Clean Cycle

The automatic self-cleaning cycle works for cats **weighing from 2 kg (4.4 lb.) to 7 kg (15.4 lb.)**.

We recommend the use of **one AutoEgg unit per cat**. Each AutoEgg **cannot support** more than two cats.

The AutoEgg has four high-precision gravity sensors on the bottom. The gravity sensors support a weight of **up to 20 kg (44 lb.)** with an **accuracy of 1 g (0.03 oz)**.

**DO NOT** place the AutoEgg near air vents or high-power appliances.  
**DO NOT** drag the AutoEgg on the ground when moving.

The AutoEgg is a smart device that will not perform self-cleaning if your cat only steps inside but does not defecate. The device will automatically clean **after 5 minutes** after detecting the presence of **5+ g (0.17 oz) of excretion**.

In Automatic mode, the AutoEgg will self-clean every day at 3:00 A.M., 9:00 A.M., 3:00 P.M., and 9:00 P.M. It makes the AutoEgg work for smaller kittens.

Do not worry about the noise. The AutoEgg **ultra-quiet** when cleaning. Each clean cycle runs for about **5 minutes**.

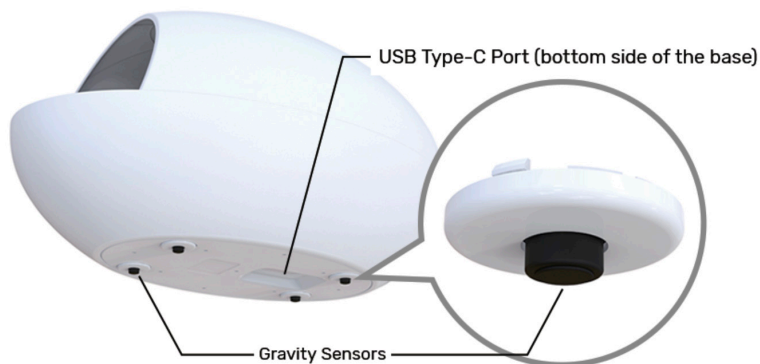

## Automatic Cat-Stuck Prevention

In Automatic mode, if the AutoEgg detects sudden **weight above 0.5 kg (1.1 lb.)**, the Cat-Stuck Prevention function will be enabled, and the self-cleaning will pause immediately.

If the sudden weight disappears

- within five seconds, the AutoEgg will immediately resume self-cleaning.
- after five seconds, the AutoEgg will wait for **5 minutes** before resuming.

## How Often to Replace the Waste Drawer Liner?

We recommend replacing the liner every three to five days, depending on your cat's excretion amount.

## AutoEgg Touchscreen Display Panel Setting

- Time: Set time (the automatic clean cycle runs four times per day at 3:00 A.M., 9:00 A.M., 3:00 P.M., and 9:00 P.M.)
- Mode: Switch between Automatic and Manual mode.
- Sensor: Restart and check the gravity sensors if they perform abnormally, or the weight log does not clear.
- Language: Select your preferred language.

## Rake

Press the Rake button to reset the position of the cleaning rake.

- Press once to move the rake to one end and press again to move it to the other end.
- When the rake's moving, press once to pause the movement and press again to resume the movement.

## Log

The AutoEgg records a log of **date, time, duration, weight, and waste data** for the last seven days.\*

If the cat's waste is **less than 5 g (0.18 oz)**, the data line will be displayed in **red** to show the abnormal situation.

If red data appears frequently, take your cat to a veterinarian to check the cat's excretory system.

\*All data is for reference only. Waste data of 0 g may be recorded if the cat plays inside the AutoEgg.

# How to Disassemble for Cleaning?

7

*Watch the disassembly video guide at [support.chillx.co](https://support.chillx.co)*

The litter box can be removed and washed. We recommend replacing the litter completely and cleaning the litter tray every 15 days.

## **1. Take off the top cover**

## **2. Press “rake” in the display panel**

to move the rake to the end of the autoegg

## **3. Rotate and remove the waste drawer**

## **4. Remove the litter residue on the rake with the litter scooper**

## **5. Remove the rake from the base**

With one hand, press on the side of the top flap. With the other hand, gently pull the rake rails out of the two snaps. (There are two snaps between the rake and the base)

## **6. Remove the tracking pad and litter tray**

## **7. Clean AutoEgg**

DO NOT soak and wash the autoegg base. Wash the removable parts

## **8. Dry removable parts completely**





*Watch the reassembly video guide at [support.chillx.co](https://support.chillx.co)*

**1. Insert The Litter Tray From The Right-Angled Edge**



**2. Align The Cleaning Rake With Three Holes, Insert, And Press Down**

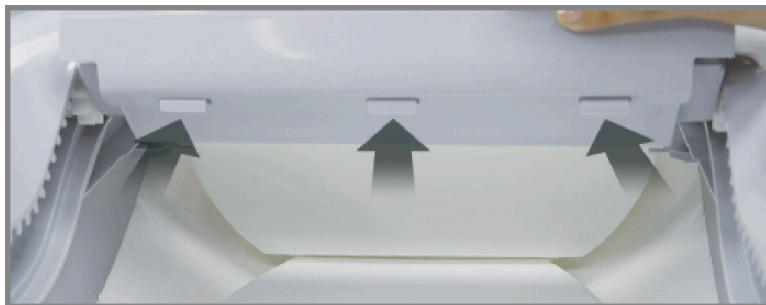

**3. Connect The Two Snaps Between The Rake And The Base**

**4. Insert The Waste Drawer Cover On An Angle**

**5. Put On The Litter Tracking Pedal**

### **Why did my new AutoEgg come with existing log? Is it a used unit?**

Your unit is **brand new**. We test and record data one or two times in the factory for quality control purposes.

### **What if my cat is reluctant to use the AutoEgg?**

We recommend that you place the AutoEgg in the **same location** as your previous litter box. You can leave the old litter box near the AutoEgg for a short time. You can start by taking **a cup of litter from the old litter box** and adding it to the clean litter in the AutoEgg.

### **Why won't my AutoEgg perform automatic self-cleaning?**

1. Check your cat's weight. The automatic cleaning after each excretion only works for cats **above 2 kg (4.4 lb.)**. \*If you have a kitten that weighs less than 4.4 lbs, power on your AutoEgg, then place any object above 4.4 lbs for 15 seconds to activate the four-time automatic cleaning throughout the day.
2. Make sure the AutoEgg is placed on a **hard and flat surface**, is not touching a wall or other objects, and is a safe distance from air vents.
3. Make sure to unplug and re-plug the power cord to reset the weight sensors whenever after you touch the AutoEgg (**add litter, move the AutoEgg, or enclose the hood, etc**).
4. Check the two rake position limit triggers to make sure they are **clickable**.
5. Check that the cleaning mode is set to "Automatic" and not "Manual" in the settings menu.
6. Press the "Sensor" button in the settings to reset the weight sensors.

### **Why is the touchscreen unresponsive?**

1. There may be some **litter stuck in the display panel**. Use a needle, thin strip of plastic, or a thin toothpick to remove the litter from the perimeter of the screen.
2. Then, gently **press down on the four corners** of the screen panel until the touchscreen functionality returns.

## Returns & Replacements

Try the ChillX AutoEgg self-cleaning litter box in your home. If you or your cats are not completely satisfied for any reason, return or replace it **within 30 days from the purchase date** for a full refund. Please note that the **re-conditioned unit is not eligible for a refund**, but we stand behind with the same 12-month warranty as our new products.

Please note that you are **responsible for return shipping costs**.

To return the AutoEgg, please make sure the AutoEgg is **clean** (which allows us to extend the lifespan of our products and support local rescues and shelters) and **carefully packed in the original carton and packaging materials** to avoid damage during shipment.

**10%-25% cleaning fee** will be deducted if it's **not thoroughly cleaned**.

You **must obtain an RMA** (Return Merchandise Authorization) number. We do not accept responsibility for return shipments without an RMA number. To request one, contact us with your **order number** and **reason** at **support@chillx.co**.

## One Year Non-Transferable Limited Warranty

### What Is Covered

We cover labor and parts for the **first year** of ownership from the purchase date. We warrant to the **original retail purchaser** and no other purchaser or subsequent owner that the product, when **subjected to normal and proper residential use**, will be free from defects in material or workmanship for a period of one year from the purchase date.

### What Is Excluded

Accidental damage due to **cat or dog scratches, chewing, urination, lightning damage, neglect, alteration, misuse, and mis-repair** are **not covered** under our warranty. We do not provide refunds, replacements, or upgrades for change of mind or any other reason outside of these warranty terms.

After the expiration of the warranty period, the user can still receive **paid** repair services provided by the company.

Any claim made under this warranty should be made directly to the company on Facebook Messenger (@chillx.co) or by email at support@chillx.co.



**Finally, A Chill Pill that Works!**

Designed with love and chill in Los Angeles

