



The Kupoli Coffee Table is a distinctive piece from the Kupoli Collection, Cameron Design House's debut collection of statement sculptural furniture. Designed to captivate, the Kupoli Collection seamlessly merges artistry and craftsmanship with functionality. Each piece features a mesmerising body of domed steel tubes, finished with a glass top.

## Kupoli Coffee 12

### Dimensions

Standard dimensions:  
 OD 983mm / 35.7"  
 Height 400mm / 15.7"  
 Weight 86kg

### Maintenance

Clean with smooth and dry cloth. Do not use any ammonia, solvents or abrasives. No user serviceable components. Contact Cameron Design House for further information.

### Other

Bespoke options and design service available. All fittings and installation instructions are provided.

Contact CDH for further technical details/downloads:  
[technical@camerondesignhouse.com](mailto:technical@camerondesignhouse.com)  
[camerondesignhouse.com](http://camerondesignhouse.com)

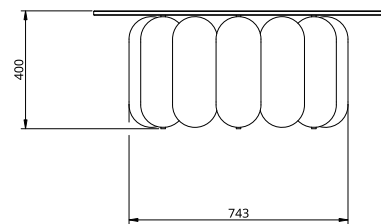
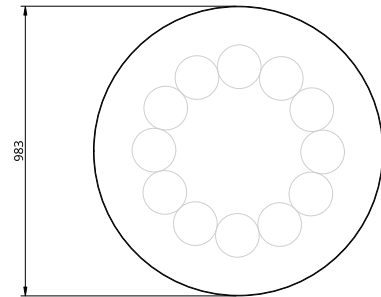

### Metal Finishes

#### P Chrome



\*Custom Colours available on request