

# NPP-4840-FP-E6OD-FDA

## 48x40 (Standard) Plastic Industrial Pallet



### Technical Data

Dimensions 48x40x6.1 inches (1219x1016x155 mm)  
Weight 34.0 lbs

#### Load Capacities

Static 8800 lbs  
Dynamic 4400 lbs  
Racking 2200 lbs

Entry 4-way  
Pallets per Stack 17  
Truckload Qty 510

Available in Truckload or LTL quantities. Minimum quantity required. We reserve the right to change any stated information without prior notice. Not responsible for typographical errors.

### Handling Data

**Nestable**  
No

**Reusability**  
Multi-Trip

**ISPM-15 Exempt**  
Yes

**Stackable**  
Yes

**Destination**  
Captive

**Food Grade**  
FDA Approved

**Rackable**  
Yes

**Airfreight**  
Yes

**Pharmaceutical**  
Yes

### Materials and Colors

**Condition**  
New

**Material** HDPP **Color** Blue

(Virgin)

### Deck Specs

**Top Deck**  
Open

**Bottom Deck**  
6 Runner - Perimeter+2 Cross  
(cruciform perimeter base)

**Available Options:**  
RFID Transponders  
Individual Markings  
Anti-Slip Bottom Grommets  
ESD Prevention for Anti-Static  
FDA Version with Freezer Additives  
Rod Inserts for Increased Performance.

### Features

Ideal for closed loops or distribution chains across industry sectors including Food, Retail, Medical and Pharmaceutical.

- High performance at low cost
- Top Safety Rim
- Open deck flow-thru design
- Allows for safe double stacking
- Sanitary choice for strict drug manufacturing requirements
- Impervious to acids, fats, solvents and odors
- Resists water absorption & bacteria growth
- Inert to infestation, mold and mildew
- Consistently dimensionally accurate
- Exempt from ISPM 15 shipping regulations

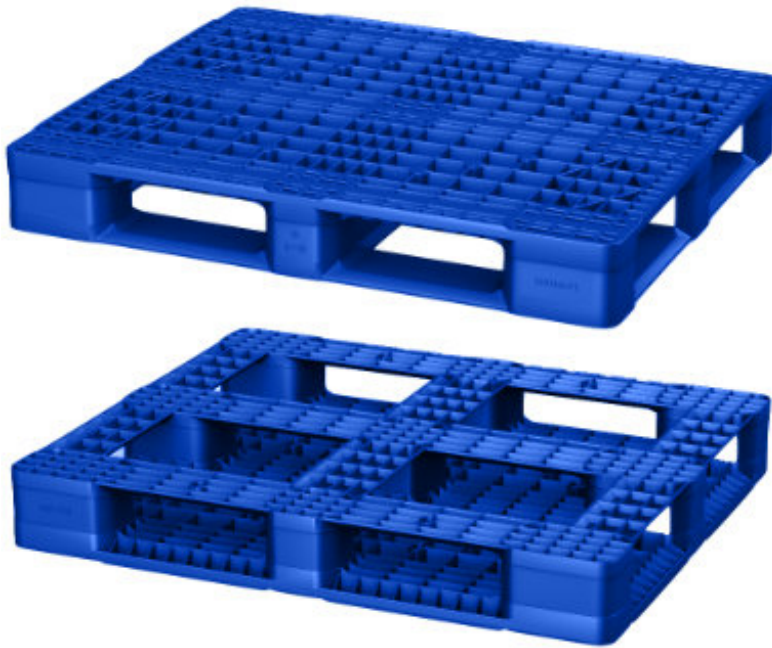

Spec Sheet Generated On: 1/17/2023

Specifications subject to change without notice.

Contents of this document are presented for general informational purposes only. Technical data are guideline values based on experience and tests under defined conditions. The data may vary based on intended use, product features, raw materials used and environmental influences. Nothing in this document shall be construed as warranties or guarantees, express or implied, regarding the products or their use, application, performance or otherwise.

**Presented By:**  
Source 4 Industries Sales  
702-734-8848  
4436 Lawrence St., Ste. A/B  
North Las Vegas, NV 89081

# NPP-4840-FP-E6OD-FDA

48x40 (Standard)  
Plastic Industrial Pallet



## Technical Drawings

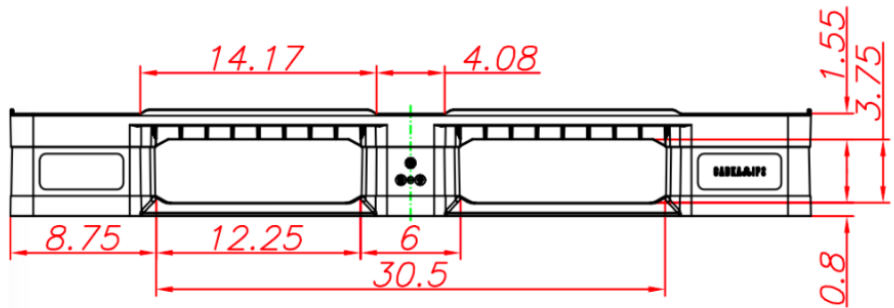
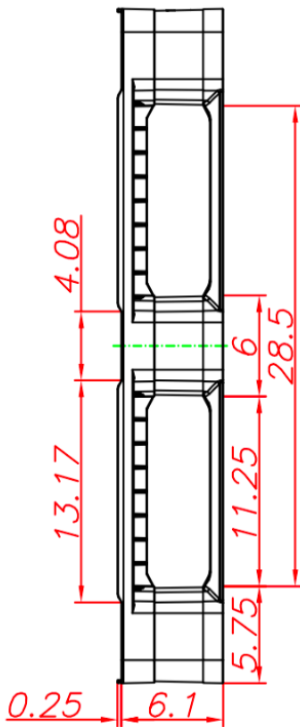
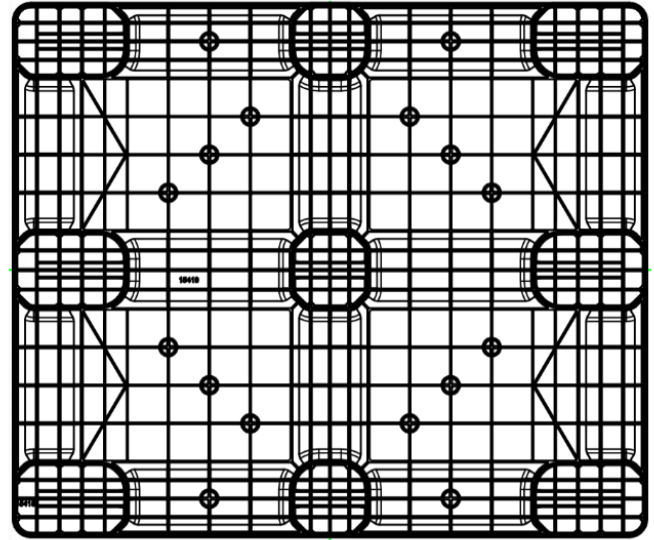
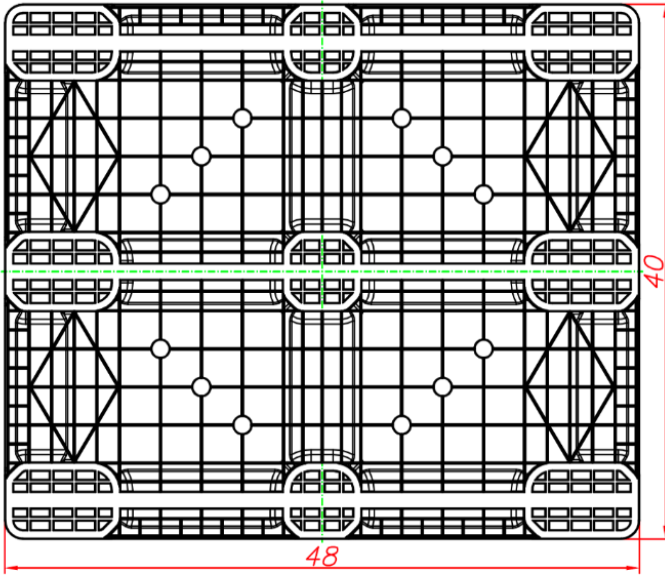

Tech Sheet Generated On: 1/17/2023  
Specifications subject to change without notice.  
Contents of this document are presented for general informational purposes only. Technical data are guideline values based on experience and tests under defined conditions. The data may vary based on intended use, product features, raw materials used and environmental influences. Nothing in this document shall be construed as warranties or guarantees, express or implied, regarding the products or their use, application, performance or otherwise.

**Presented By:**  
Source 4 Industries Sales  
702-734-8848  
4436 Lawrence St., Ste. A/B  
North Las Vegas, NV 89081